

EMERALD

CUBICLE COLLECTION

Installation Guide





Tools Needed for Installation

(Professional Assembly Recommended)



Drill Bits



1/4 Driver



Clamp



Mallet



Screw Gun



Allen Keys



Chop Saw



Level



Pry Bar

Quick Tips

1. Unpack all product before assembly
2. 3 person installation
3. Make sure all panels are level
4. Frame entire office before installing tiles.
5. Professional installation recommended.
6. **If your floor plan does not fit exactly with our sizes we suggest the following: A contractor may be hired to build out wall to meet measurements. This is called a knee wall and very common in the industry when odd measurements are left. This will make a finished look.



Panel to Panel Connector

39" high and 52" High

VIEW VIDEO for Panel to Panel Connector:

http://www.youtube.com/watch?feature=player_embedded&v=5s4Zwoa9U7c#at=43

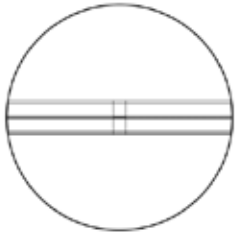

EMERALD INSTALLATION:

Panel to Panel "PP" Connector
39" High

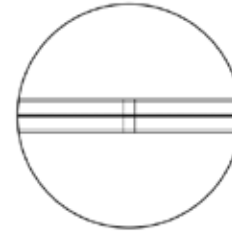

EMERALD INSTALLATION:

Panel to Panel "PP" Connector
52" High

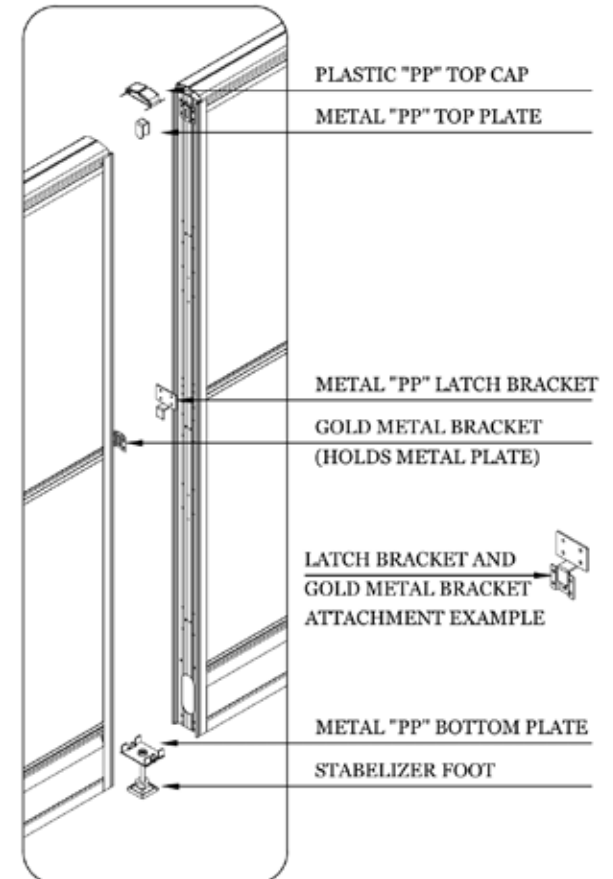
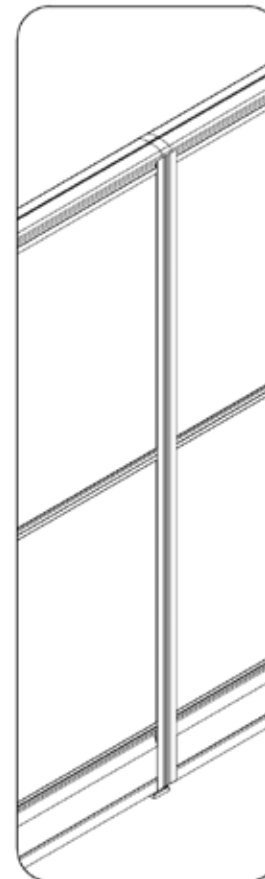
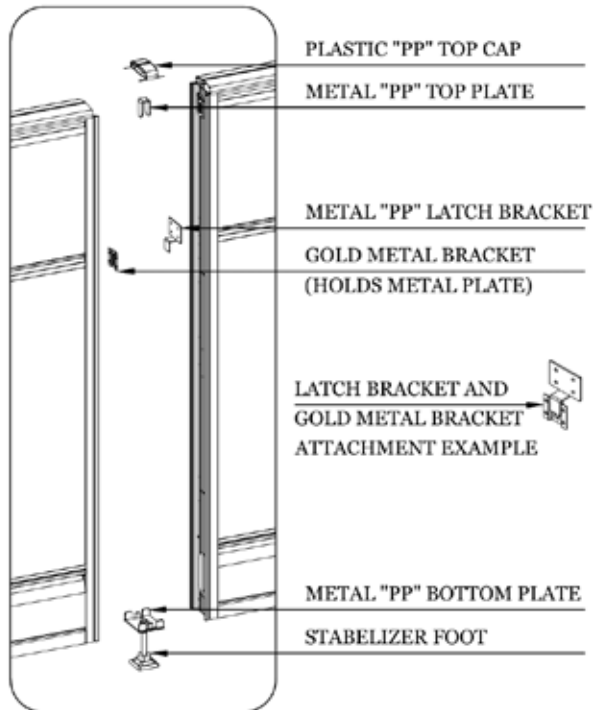
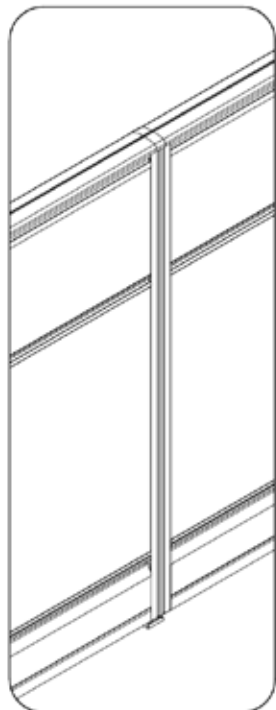

65" High

VIEW VIDEO for Panel to Panel Connector:

http://www.youtube.com/watch?feature=player_embedded&v=5s4Zwoa9U7c#at=43

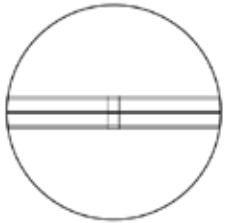

EMERALD INSTALLATION:

Panel to Panel "PP" Connector
65" High

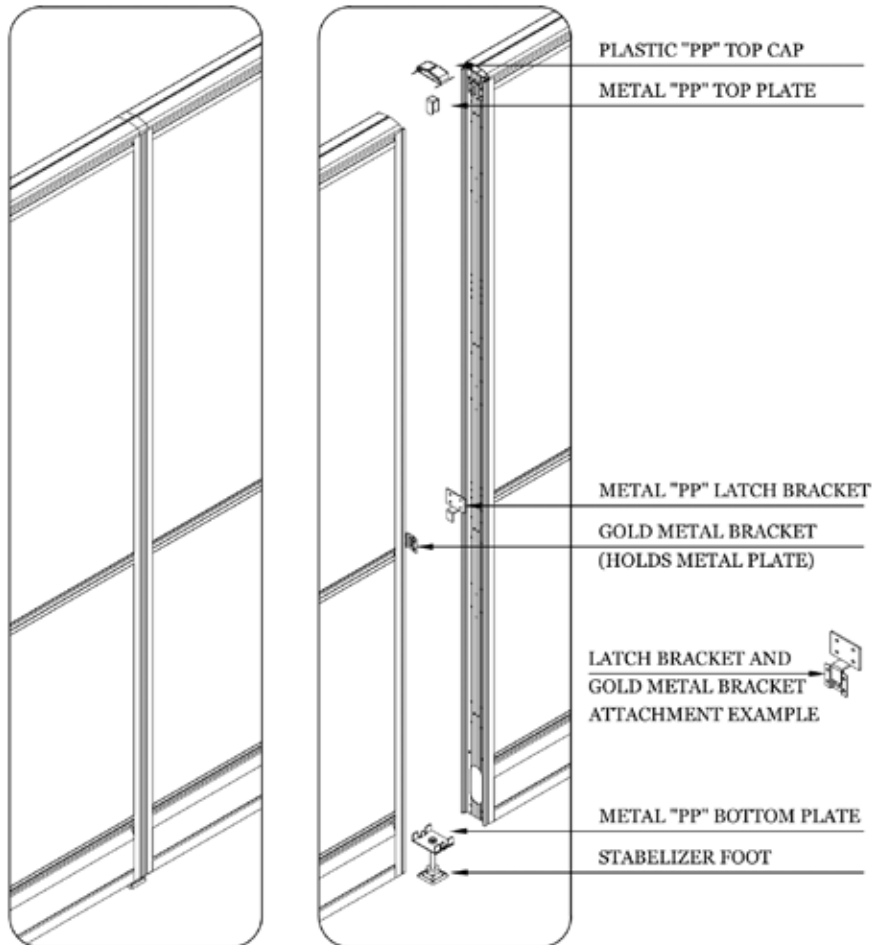

A

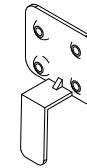

Mid-Panel Clip

B



Panel-to-Panel Small Clip

C

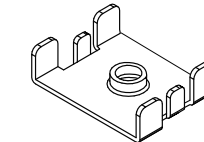

Panel-to-Panel Foot

D

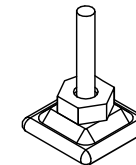

Foot

E



Panel-to-Panel Straight
Top Connector

VIEW VIDEO for T-Connector:

http://www.youtube.com/watch?feature=player_embedded&v=o_LeoWw78Fo

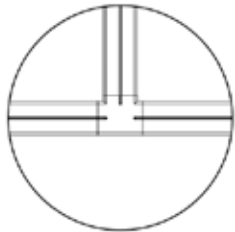

EMERALD INSTALLATION:

3 Way "T" Connector
39" High

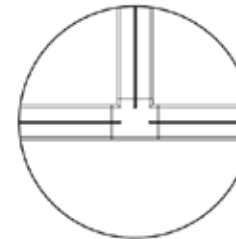

EMERALD INSTALLATION:

3 Way "T" Connector
52" High

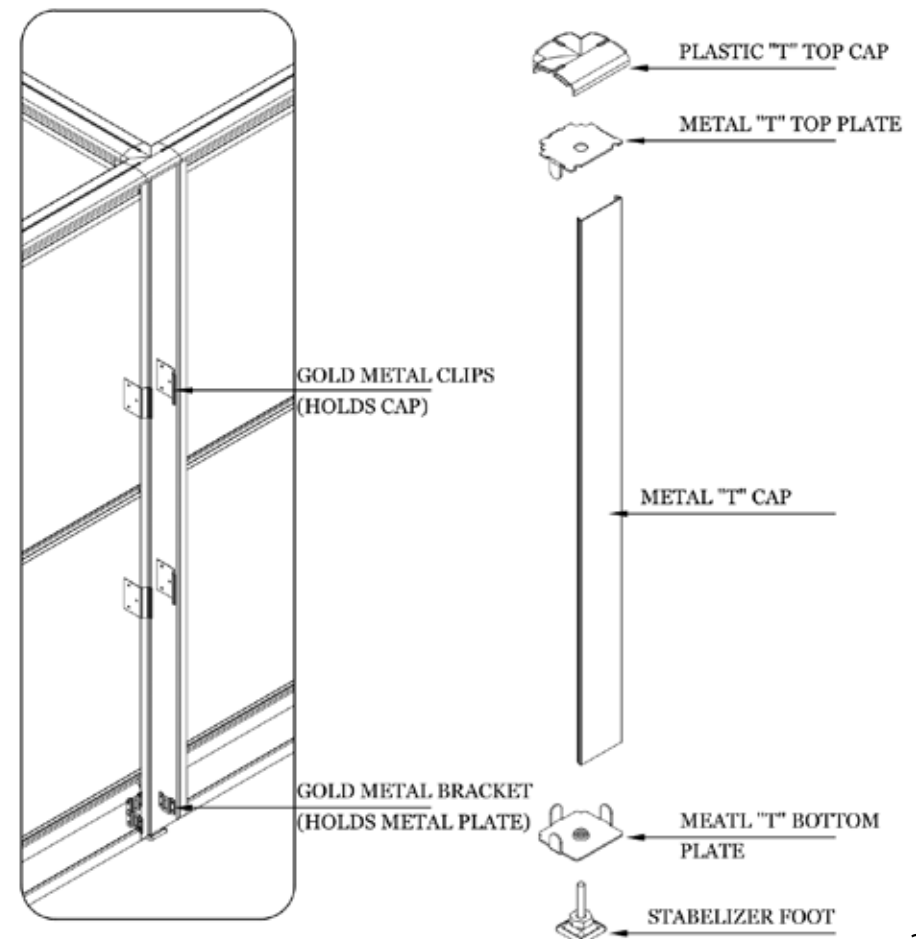
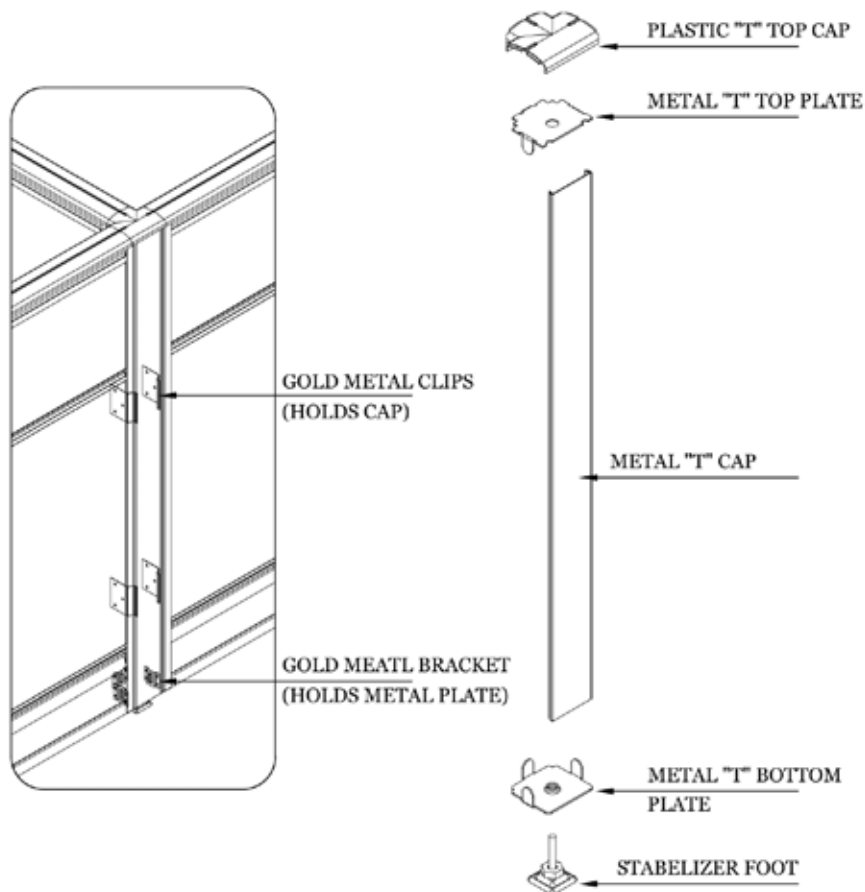

VIEW VIDEO for T-Connector:

http://www.youtube.com/watch?feature=player_embedded&v=o_LeoWw78Fo

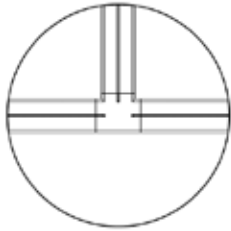

EMERALD INSTALLATION:

3 Way "T" Connector
65" High

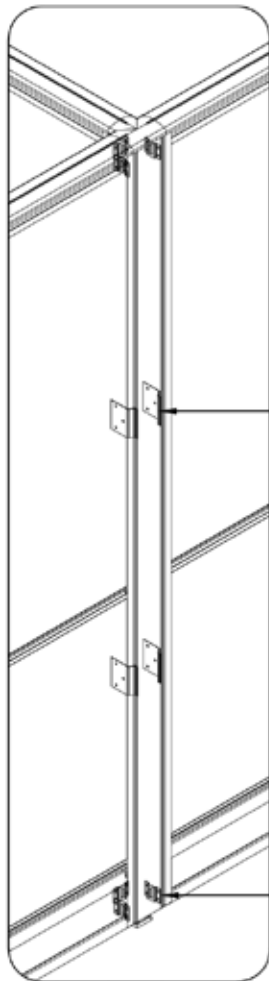

GOLD METAL CLIPS
(HOLDS CAP)

GOLD METAL
BRACKET (HOLDS
METAL PLATE)

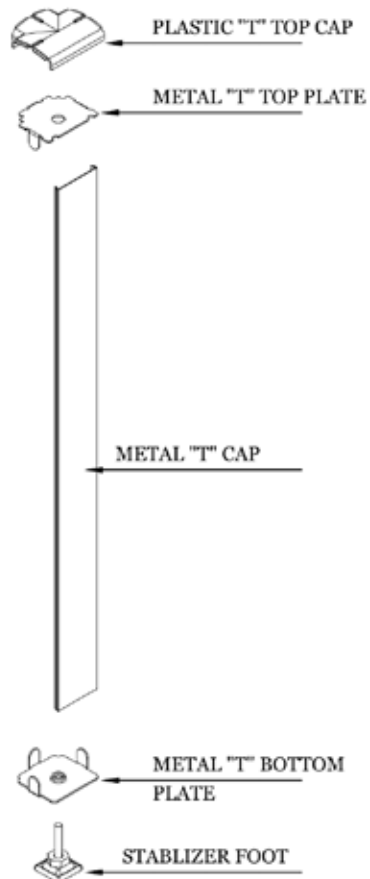

A

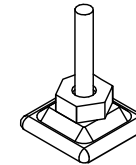

Foot

B

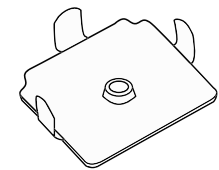

3 Way T Bottom
Connector

C

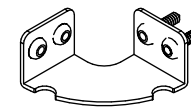

2 Way Mounting
Support

D

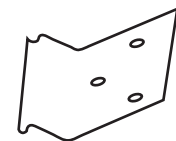

Bracket

E

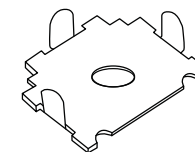

3 Way T Top
Connector

VIEW VIDEO - L-Connector:

http://www.youtube.com/watch?feature=player_embedded&v=I9BKmo7nHT4

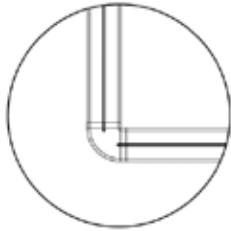

EMERALD INSTALLATION:

2 Way "L" Connector
39" High

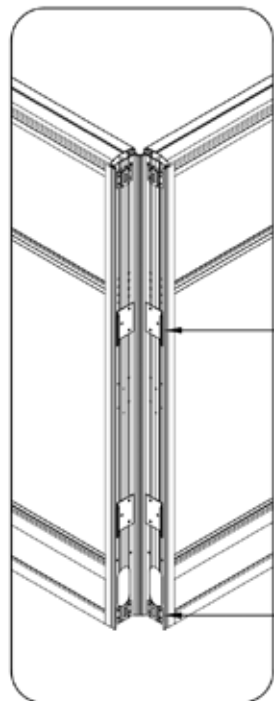
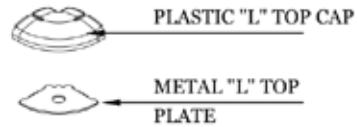

GOLD METAL CLIPS
(HOLDS CAP)

GOLD METAL BRACKET
(HOLDS METAL PLATE)

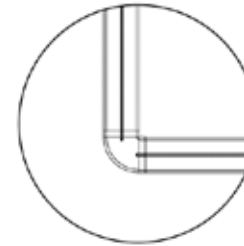

EMERALD INSTALLATION:

2 Way "L" Connector
52" High

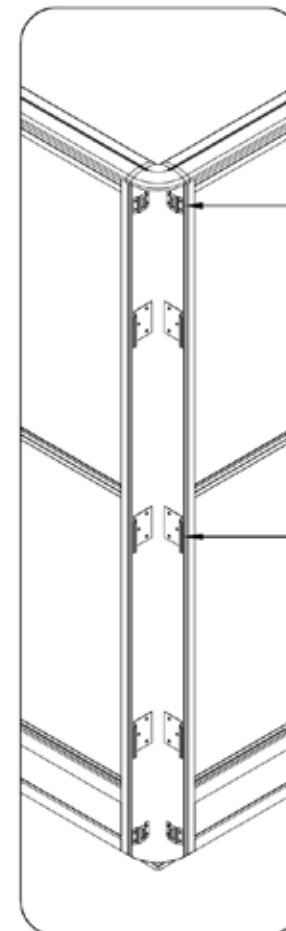
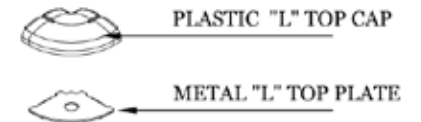

GOLD METAL BRACKET
(HOLDS METAL PLATE)

GOLD METAL CLIPS
(HOLDS CAP)



VIEW VIDEO - L-Connector:

http://www.youtube.com/watch?feature=player_embedded&v=I9BKmo7nHT4

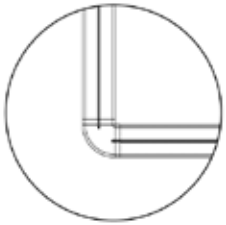

EMERALD INSTALLATION:

2 Way "L" Connector
65" High

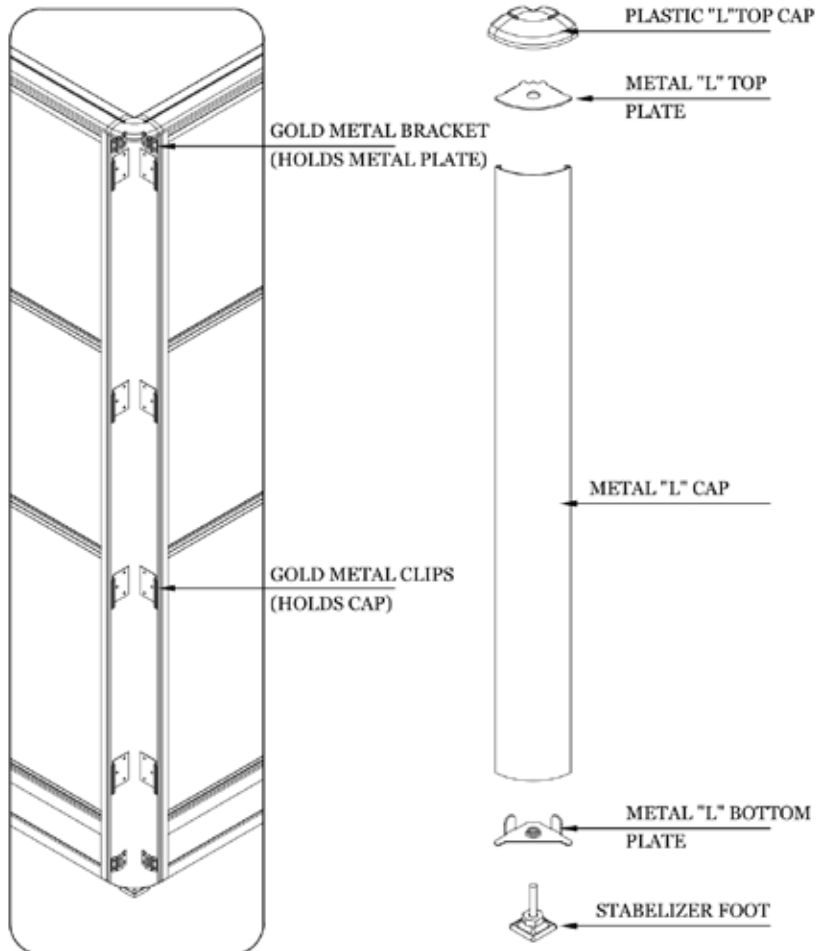

A

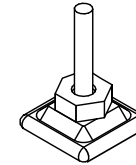

Foot

B

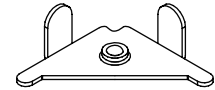

2 Way L Bottom
Connector

C

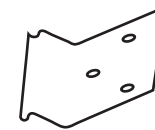

Bracket

D

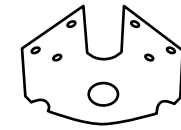

L-Bracket

E



2 Way L Top
Connector

VIEW VIDEO - X-Connector:

http://www.youtube.com/watch?feature=player_embedded&v=oU8zZM4fYo8#at=48

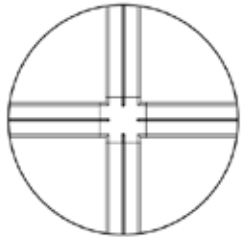

EMERALD INSTALLATION:

4 Way "X" Connector
39" High

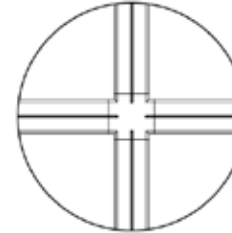

EMERALD INSTALLATION:

4 Way "X" Connector
52" High

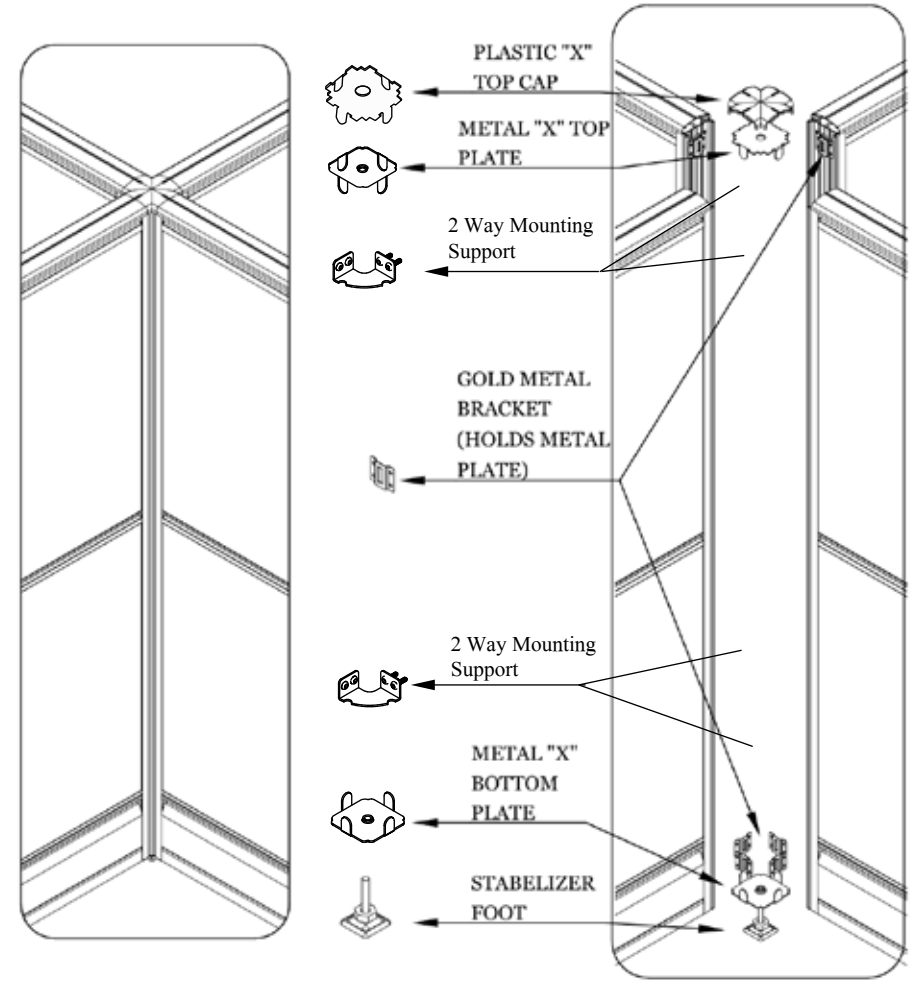
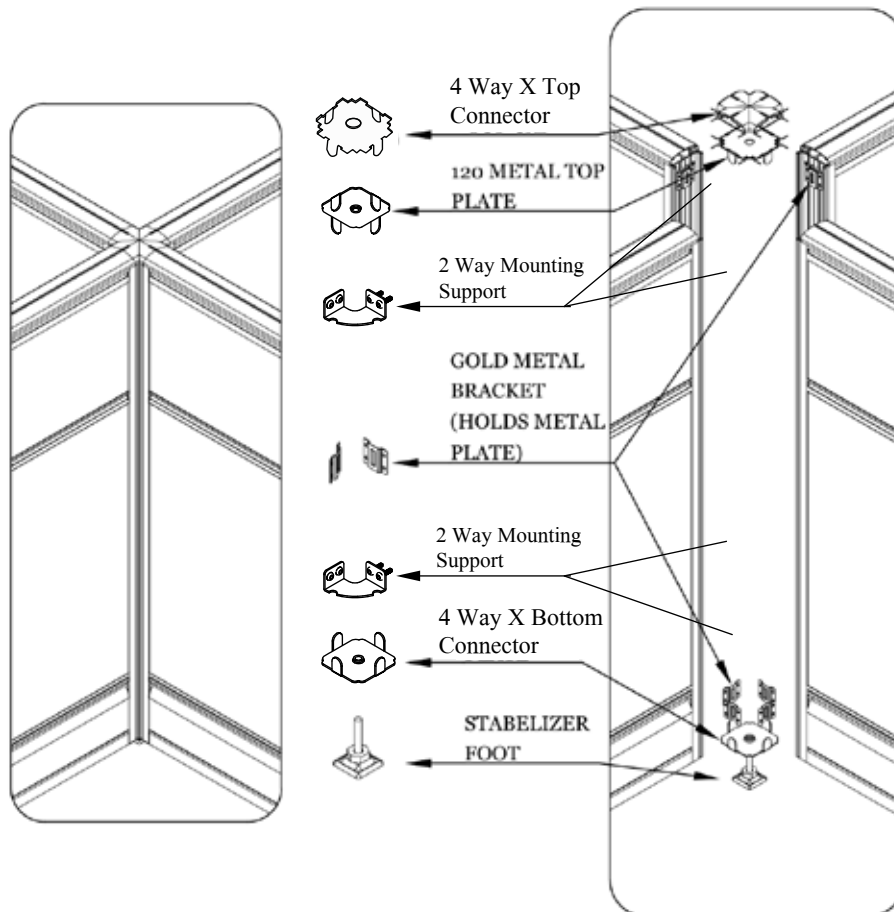

VIEW VIDEO - X-Connector:

http://www.youtube.com/watch?feature=player_embedded&v=oU8zM4fYo8#at=48

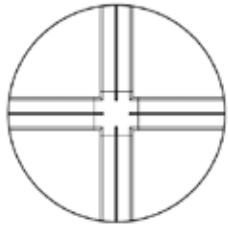

EMERALD INSTALLATION:

4 Way "X" Connector
65" High

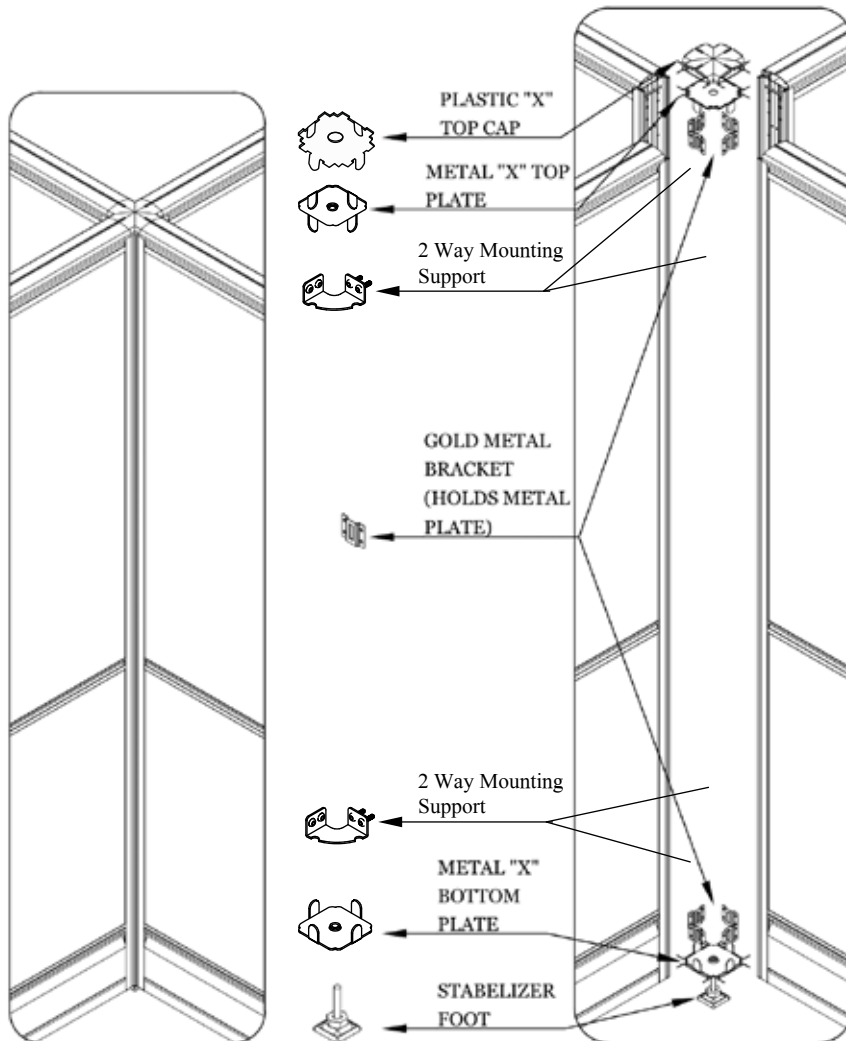

A

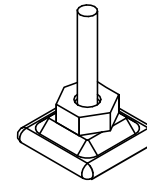

Foot

B

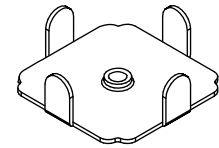

4 Way X Bottom Connector

C

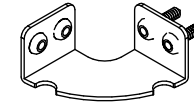

2 Way Mounting Support

D

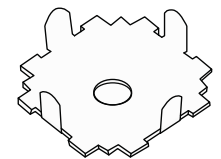

4 Way X Top Connector

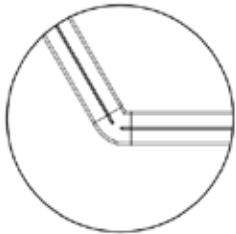

EMERALD INSTALLATION:

120 Degree 2 Way Connector
39" High

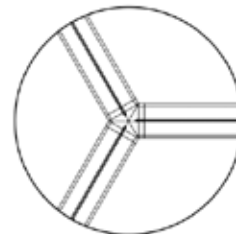

EMERALD INSTALLATION:

120 Degree 3 Way Connector
39" High

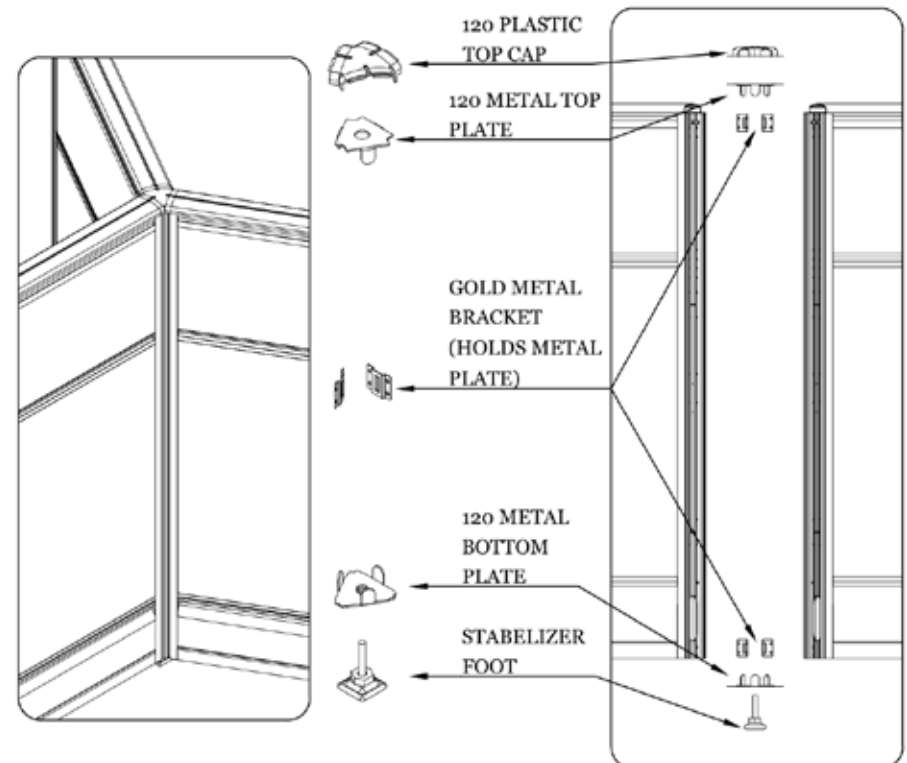
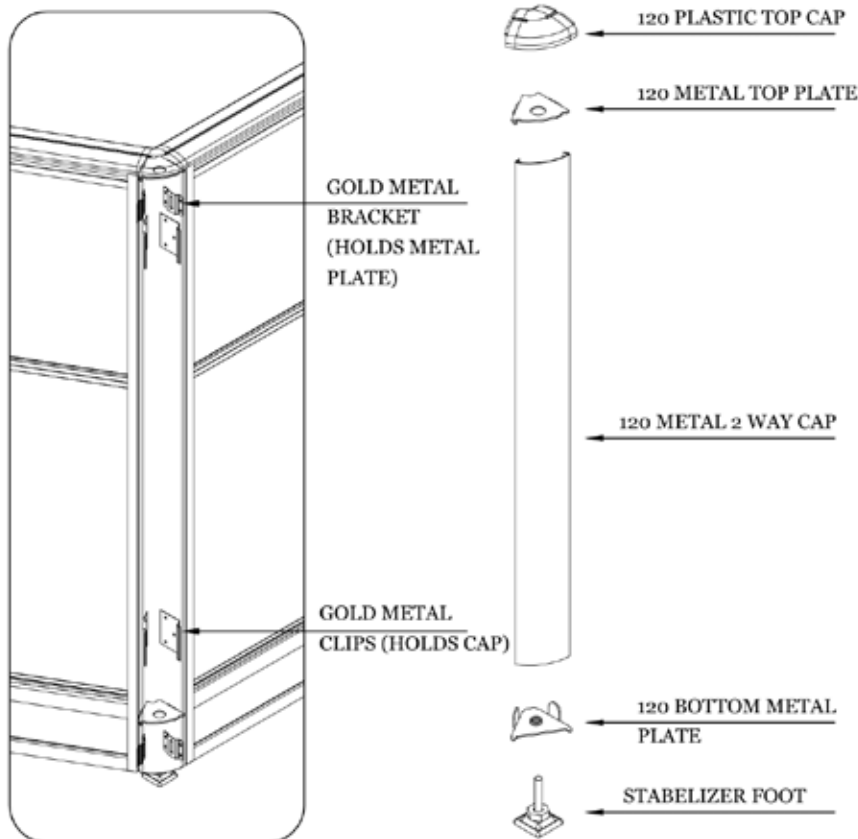

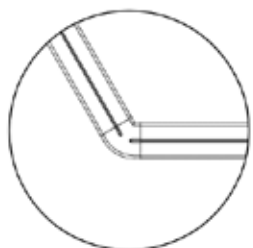

EMERALD INSTALLATION:

120 Degree 2 Way Connector
52" High



GOLD METAL
BRACKET
(HOLDS METAL
PLATE)

GOLD METAL
CLIPS
(HOLDS CAP)



120 PLASTIC TOP CAP



120 METAL TOP PLATE



120 METAL 2 WAY CAP



120 BOTTOM METAL
PLATE



STABELIZER FOOT

EMERALD INSTALLATION:

120 Degree 3 Way Conector
52" High

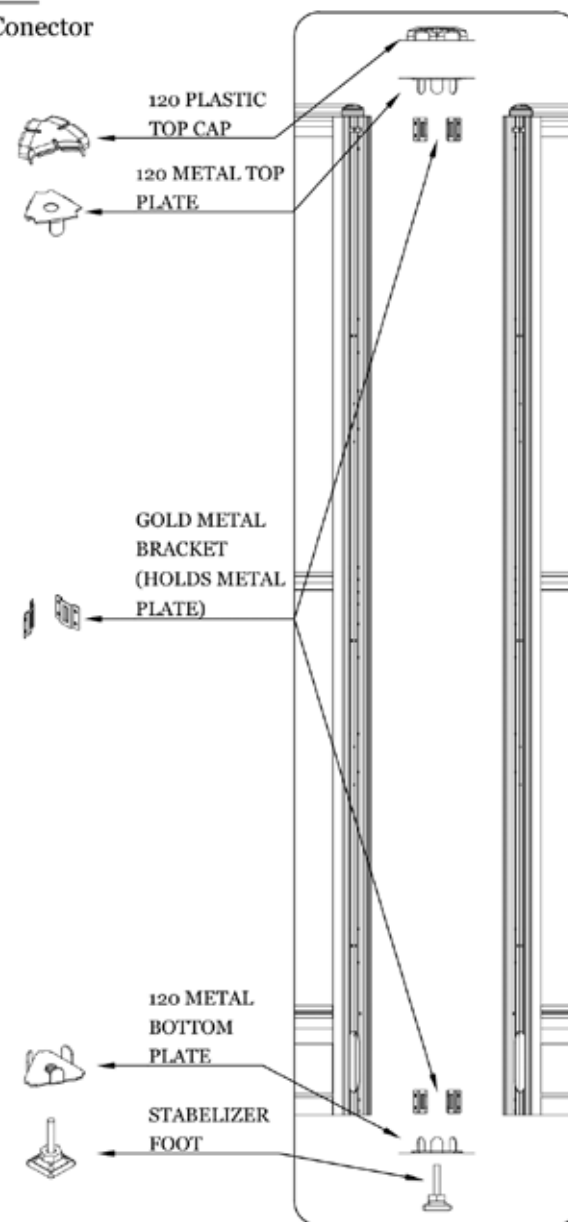
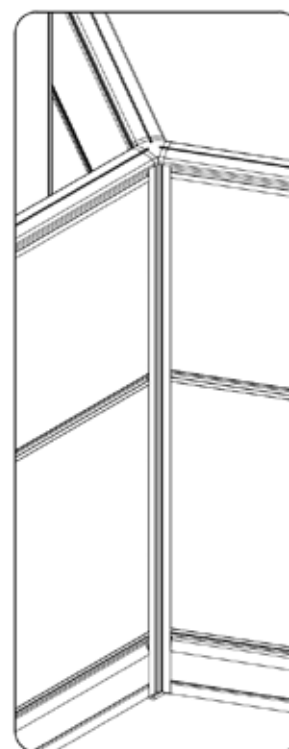
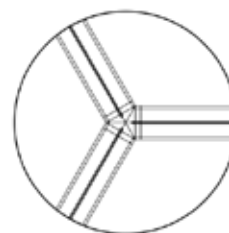

120 PLASTIC
TOP CAP

120 METAL TOP
PLATE

GOLD METAL
BRACKET
(HOLDS METAL
PLATE)

120 METAL
BOTTOM
PLATE

STABELIZER
FOOT

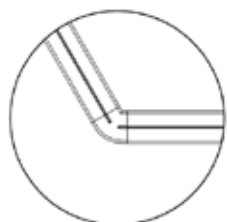

EMERALD INSTALLATION:

120 Degree 2 Way Connector
65" High

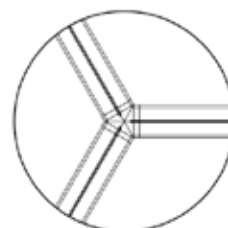
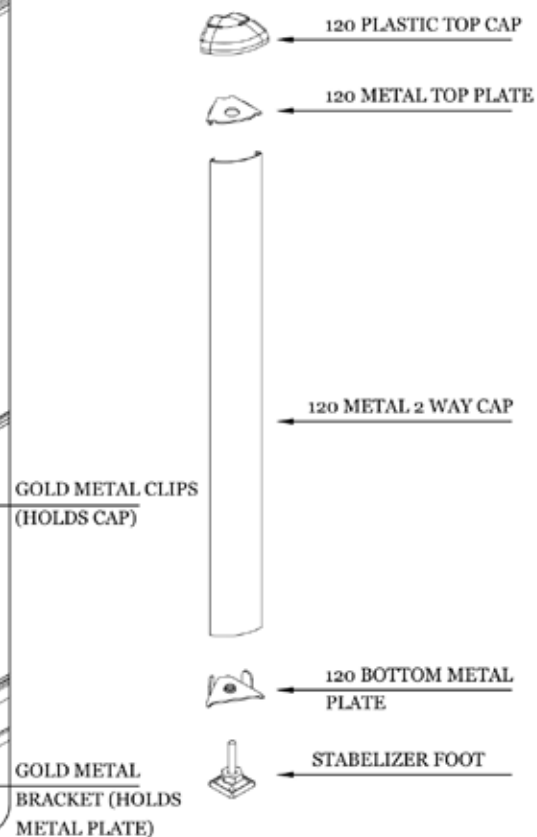

EMERALD INSTALLATION:

120 Degree 3 Way Connector
65" High

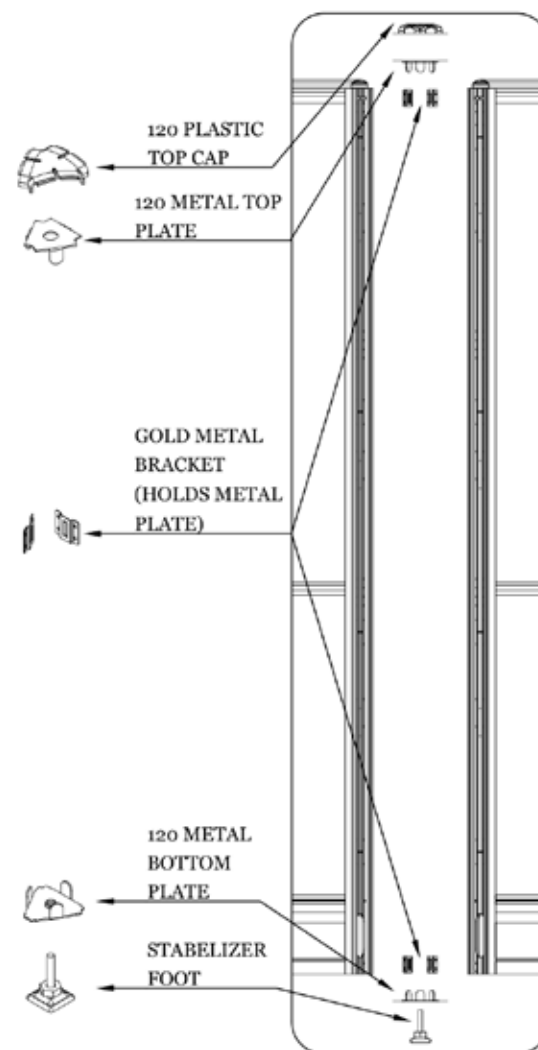
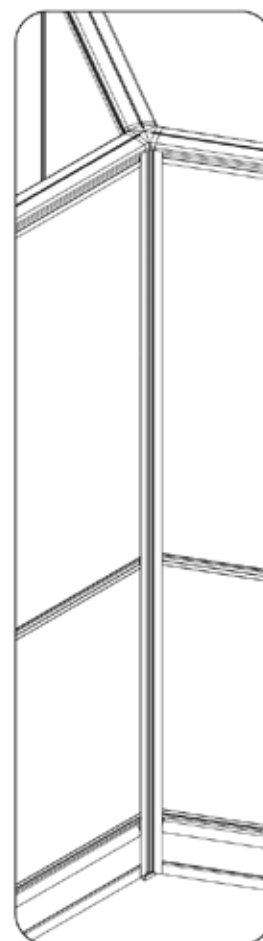

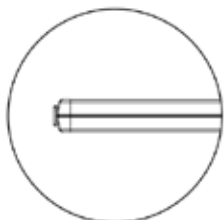

EMERALD INSTALLATION:

End Trim
39" High

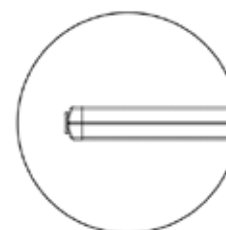
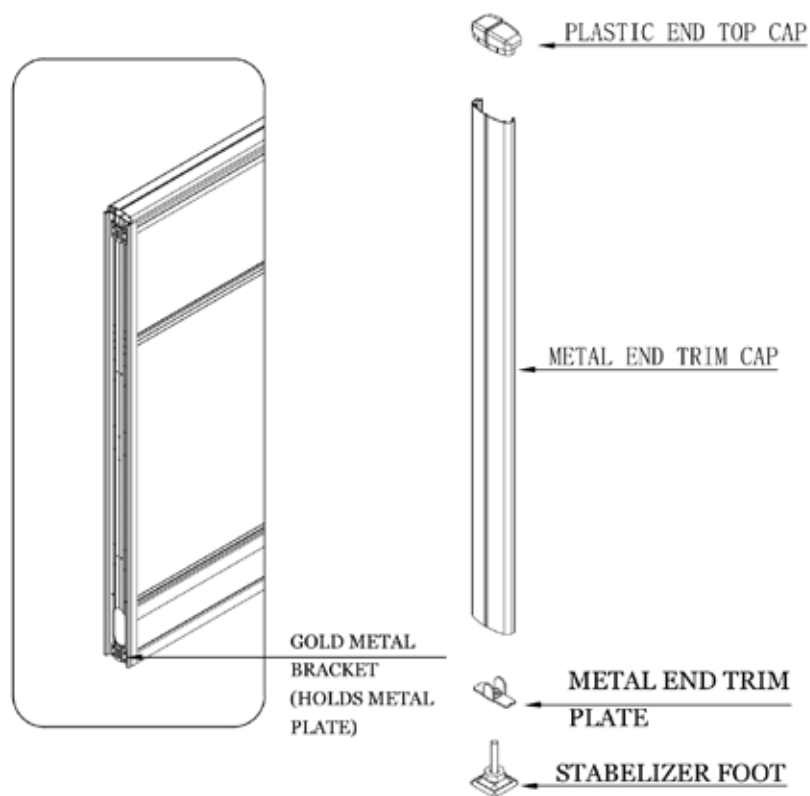

EMERALD INSTALLATION:

End Trim
52" High

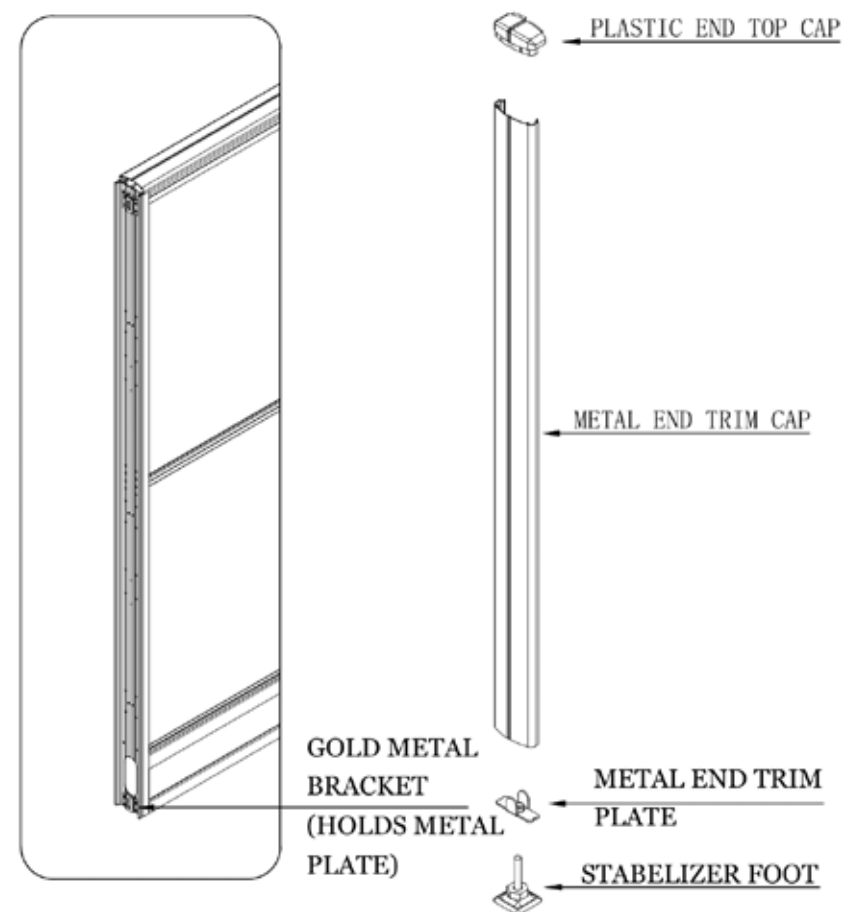

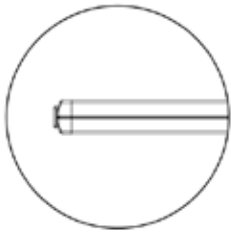

EMERALD INSTALLATION:

End Trim

65" High

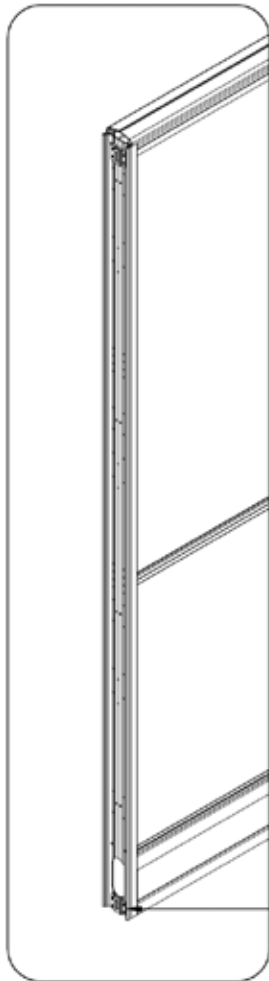

← PLASTIC END TOP CAP



← METAL END TRIM CAP



← METAL END TRIM
PLATE



← STABILIZER FOOT

GOLD METAL
BRACKET
(HOLDS
METAL
PLATE)

SUPPORT INSTALLATION:

Modesty Panel

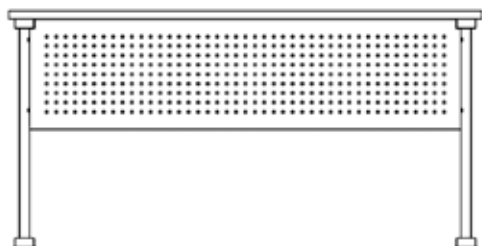
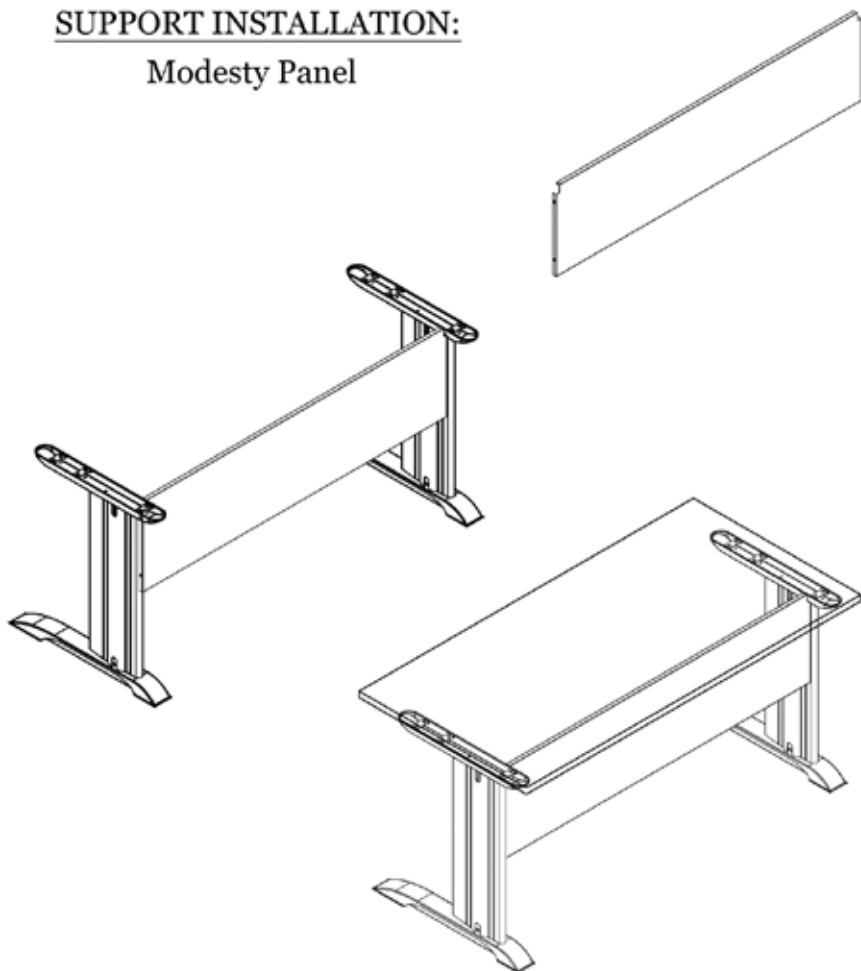

(A)

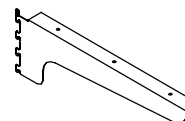

(Left) Single Cantilever

(B)

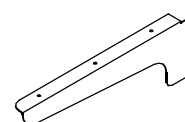

(Right) Single Cantilever

(C)

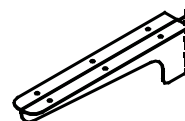

Double Cantilever

(D)

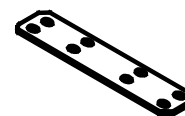

Flat Bracket

(E)

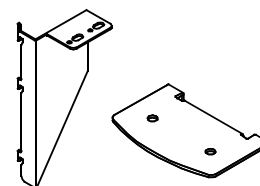

Corner Worksurface Support
(2 Styles)

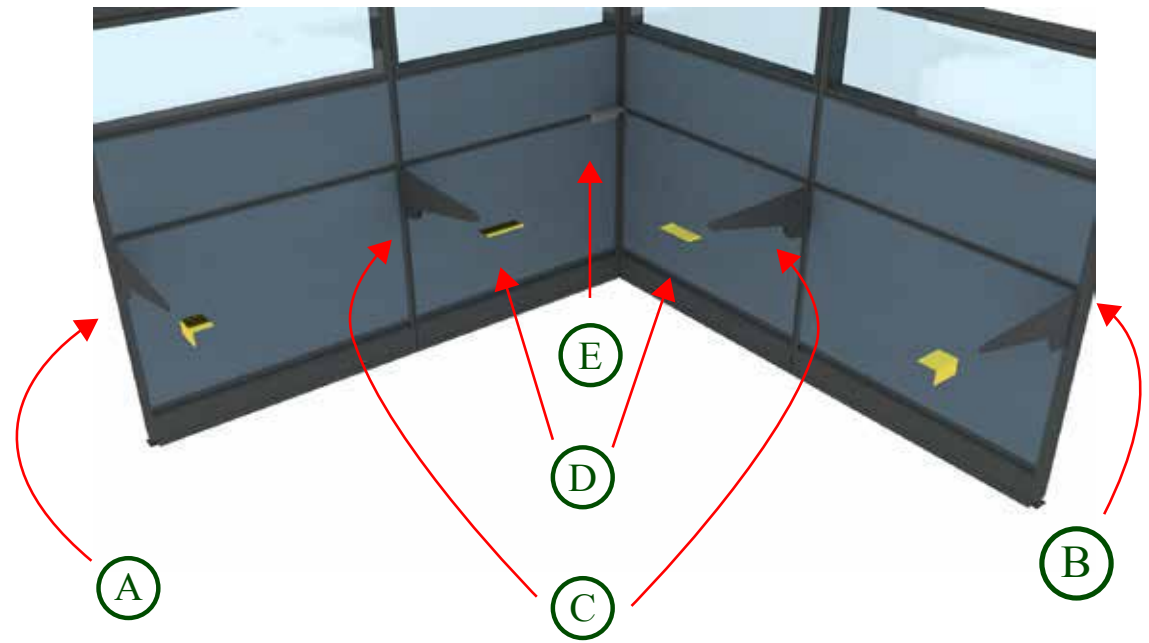
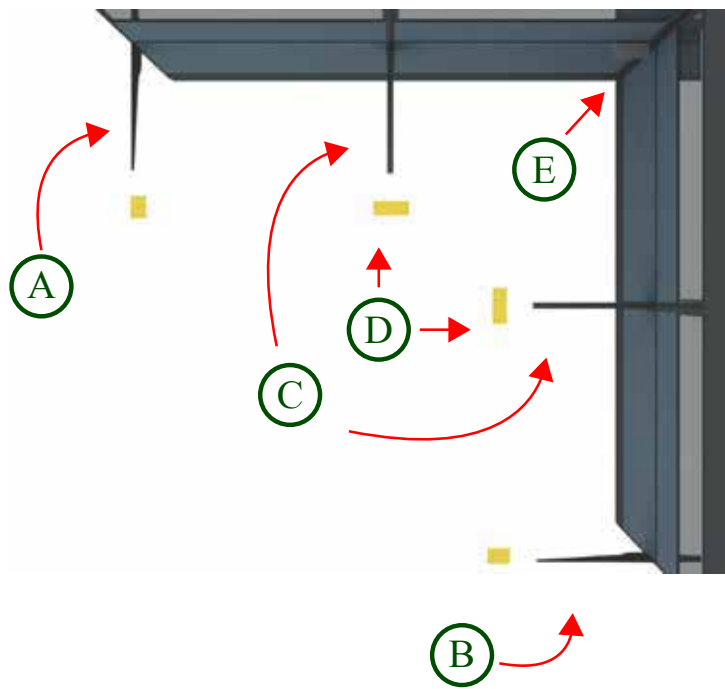

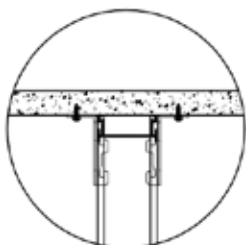

RIGHT COUNTER TOP
BRACKET



LEFT COUNTER TOP
BRACKET

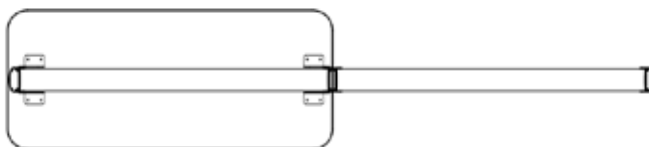
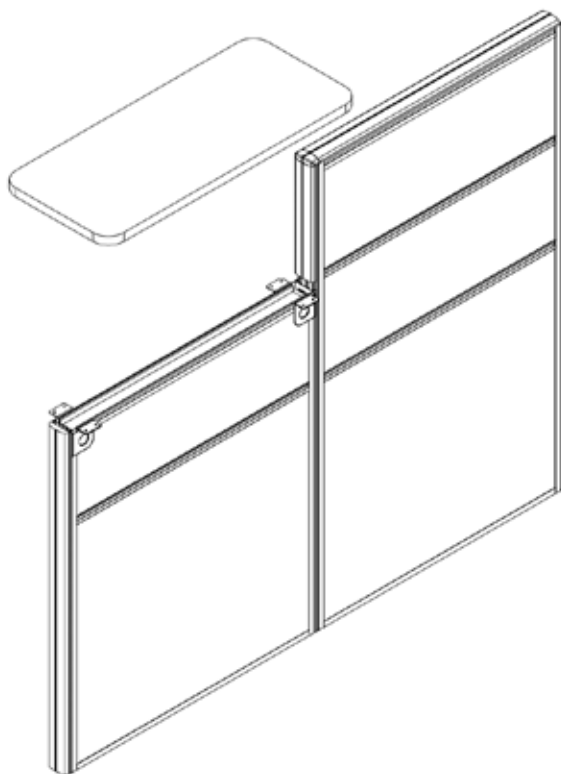

1. Remove Top Caps from Panels.

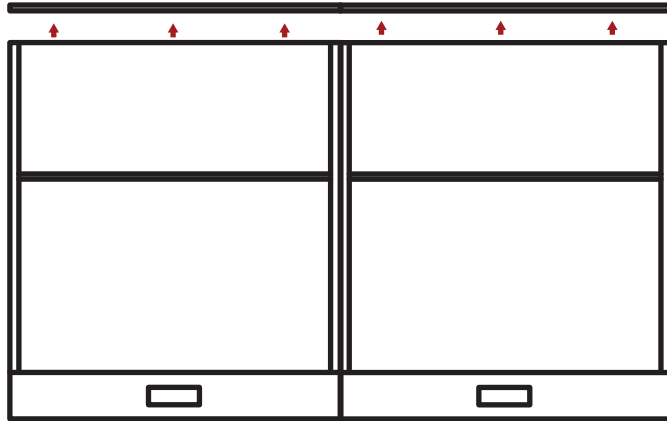

2. Install Transaction Top Support Brackets. (Front and Back of Panels)

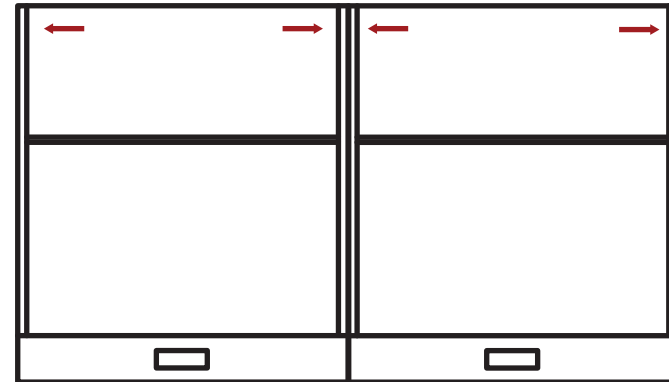

3. Center and Place Transaction Top(s)

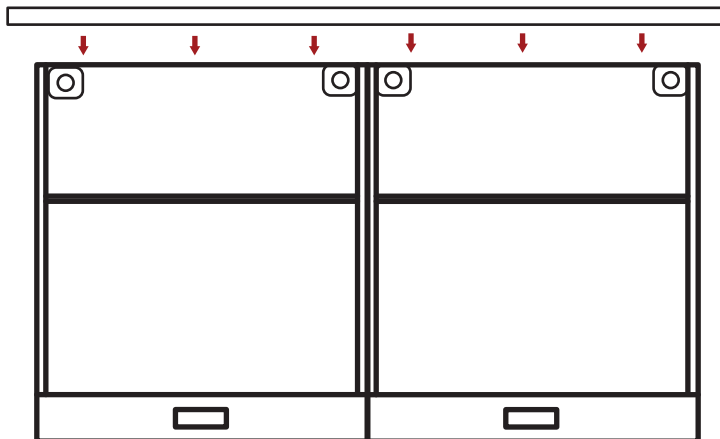

4. Secure Transaction Top(s) by screwing through holes in brackets into Top from underneath.

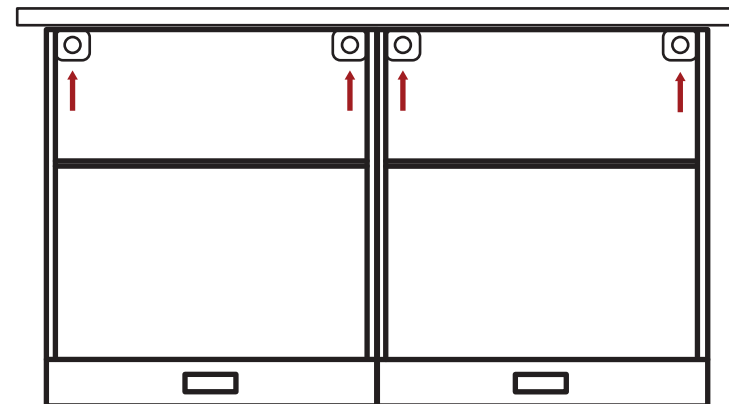

Top View

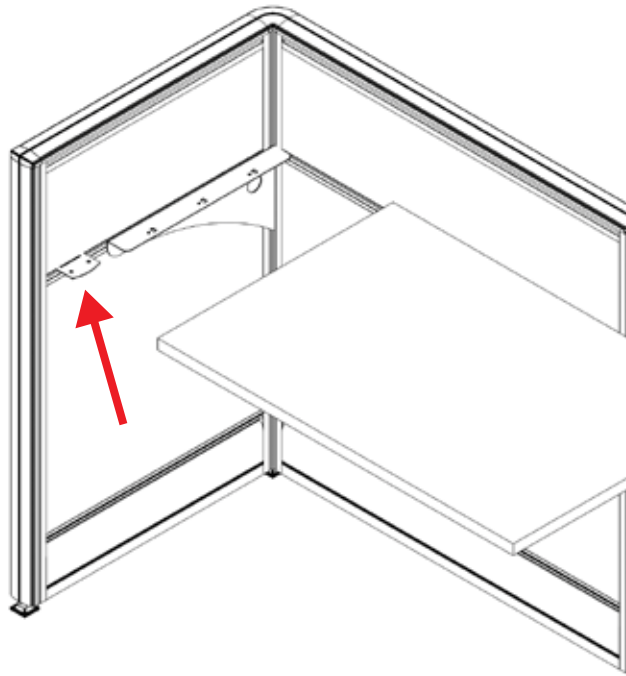

Top View Shown Through Worksurface

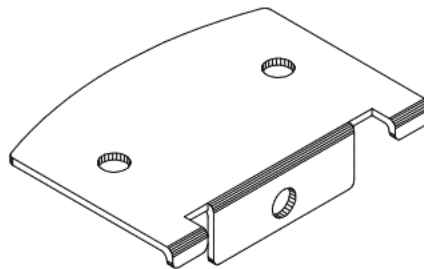
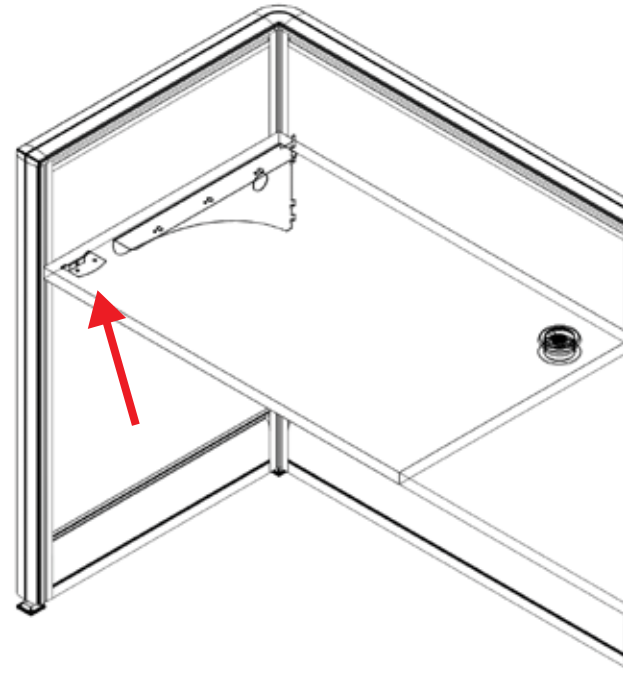

Wing Panel Bracket

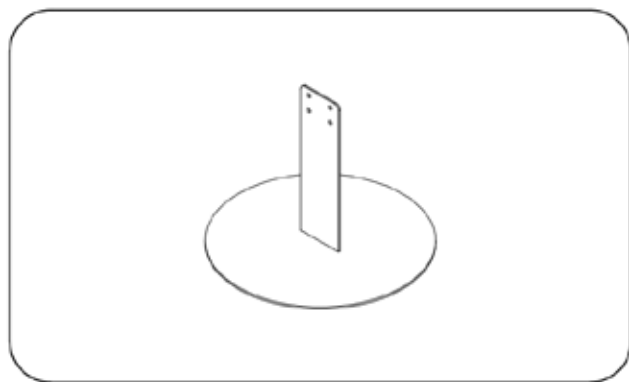

SUPPORT
INSTALLATION:
Round Foot

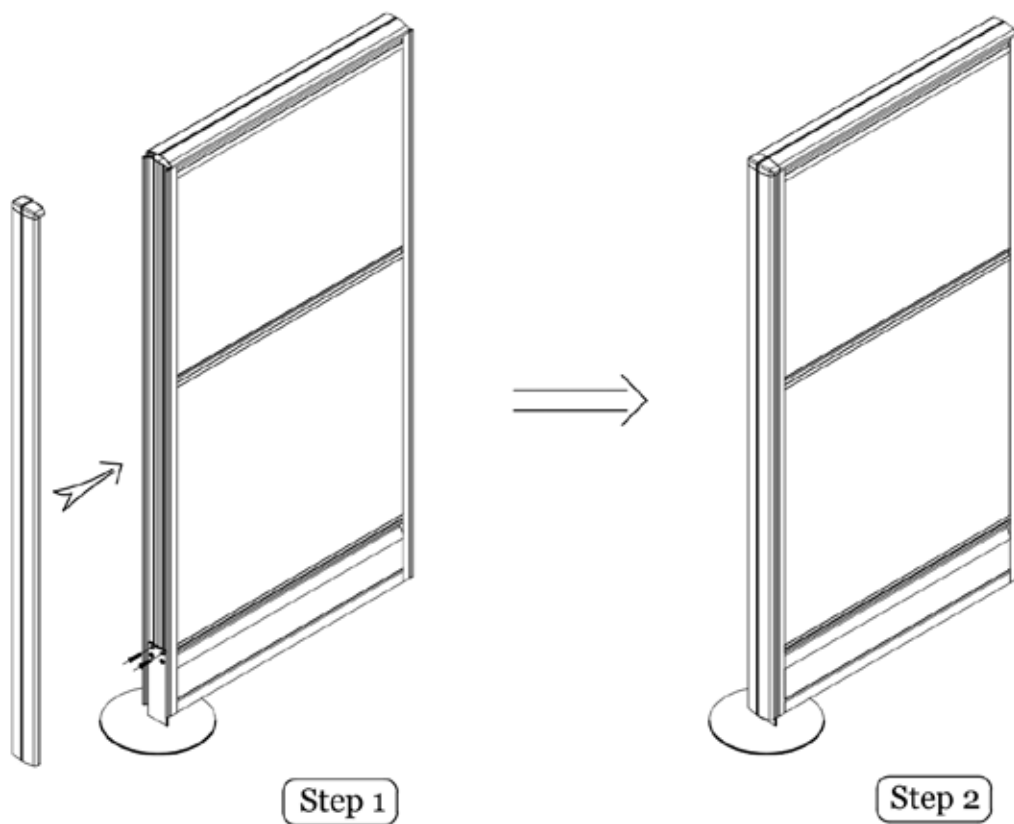

VIEW INSTALLING a Rolling or Stationary Panel:

http://www.youtube.com/watch?feature=player_embedded&v=DMwHR4UpBoM#at=20

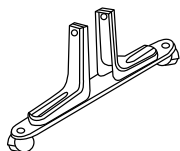
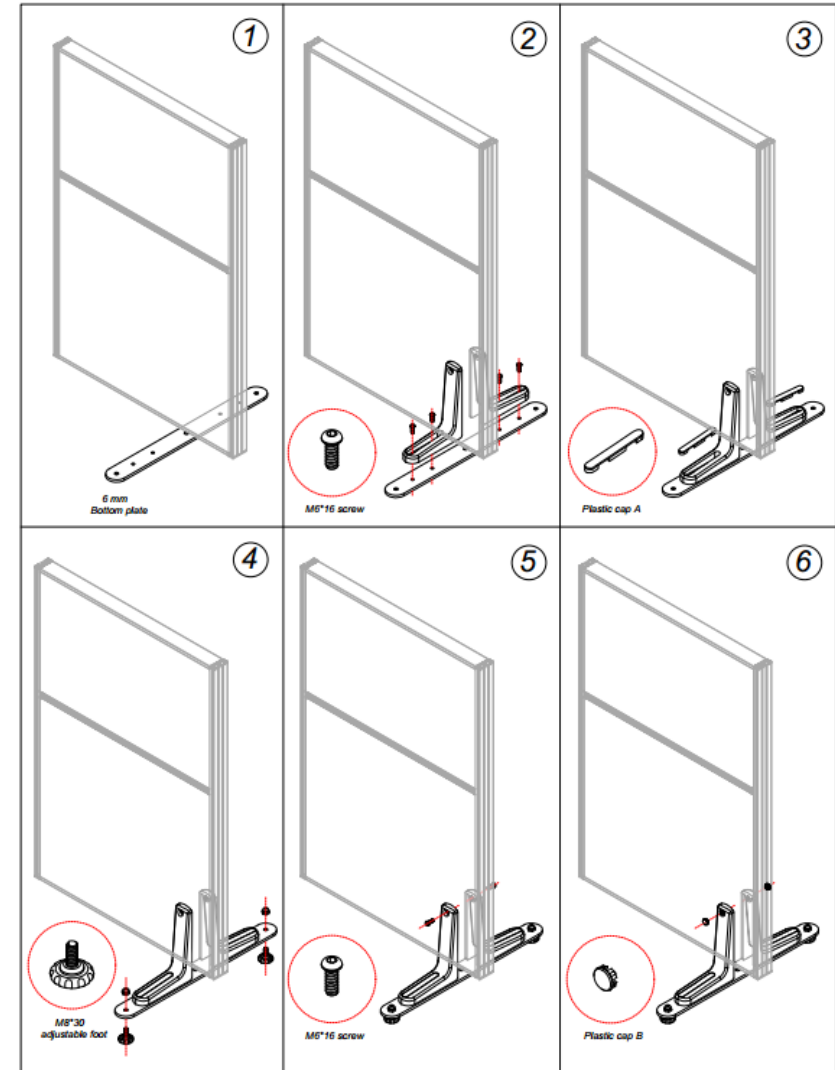

Panel Support Legs With Casters

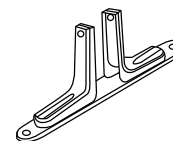

Panel Support Legs Without Casters

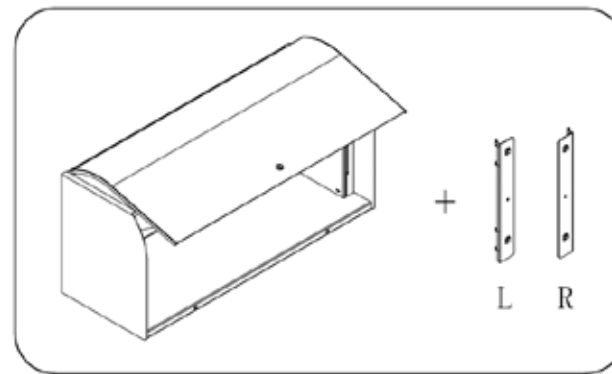

STORAGE
INSTALLATION:
Overhead Bin

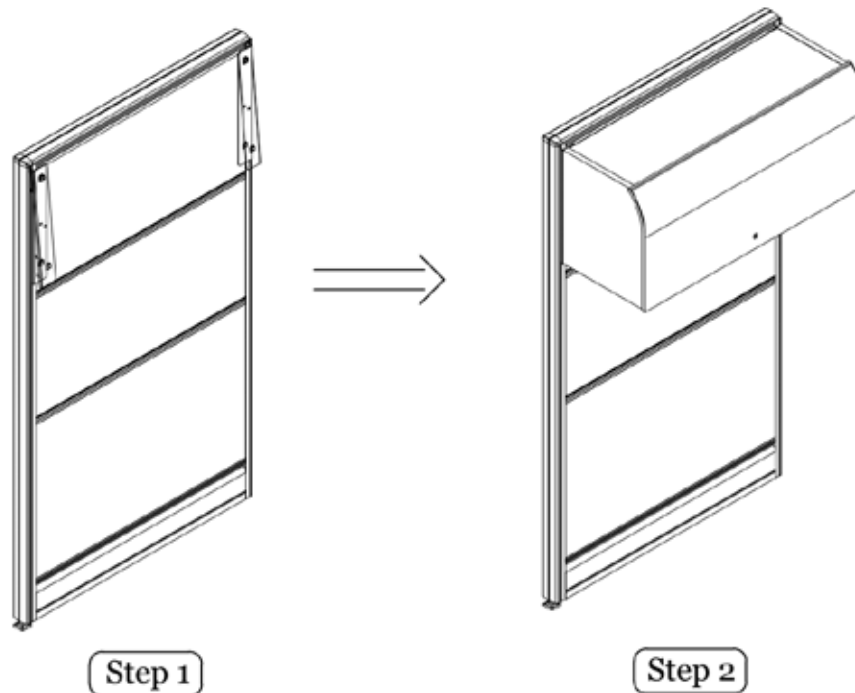



The Power System is an eight wire system consisting of four individual circuits (see Fig. 1). Each Circuit is rated at 20amps/120 volts maximum. Circuit 1 (black), Circuit 2 (red) and Circuit 4 (pink), are served by a system neutral (white) and an equipment ground (green). Circuit 3 (blue) uses an isolated neutral (gray), and an isolated ground (green/yellow). The system may be supplied by a three phase power system with four individual Circuits rated at 20amps/120 volts maximum, or as permitted by local code.

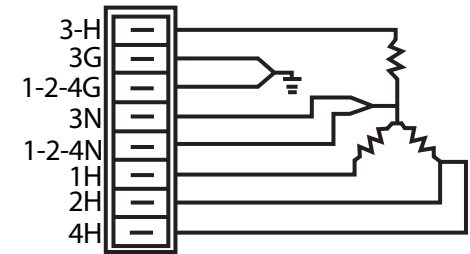
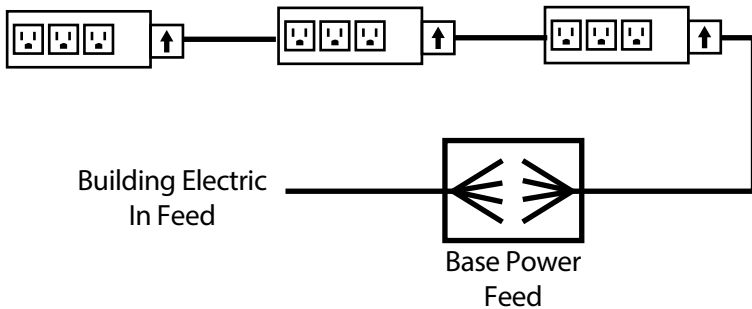

FIG 1



When connecting electric pass throughs to power moduals, please make sure ARROW is up!



FINAL CONNECTION IS DONE BY A LICENSED ELECTRICIAN.

WARNING: Risk of Fire or Electrical Shock. As with all non-directional systems, Do Not electrically connect panel to more than one supply source. Always determine that the panel is electrically connected to one and only one source of supply. Before using any equipment, check the entire system for polarity, continuity, and grounding integrity.



Panel Shown Without Electric Hinged Racetrack door open to show area for electric and wired management



Shown with Electric Module



Panel Shown with Electric (you can order 1, 2, or 3 and dedicated outlets)



Show with Data and Phone (additional jacks can be added up to 4 slots)

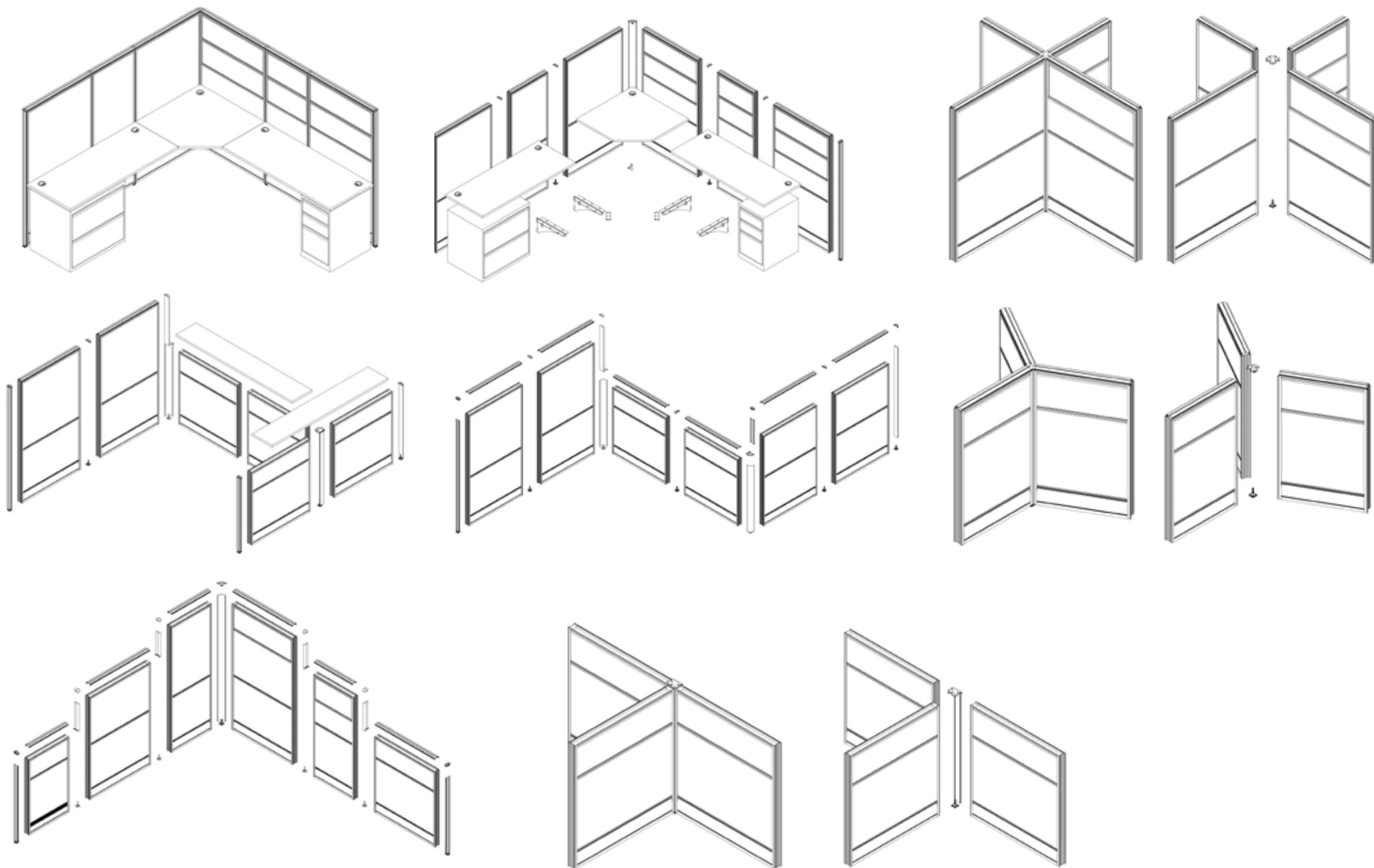

L stepdown 52-39

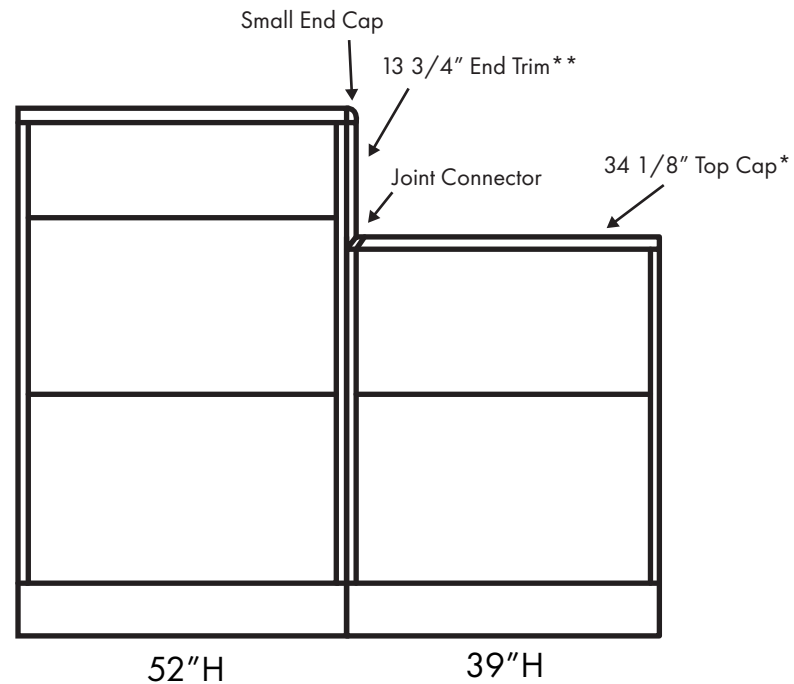
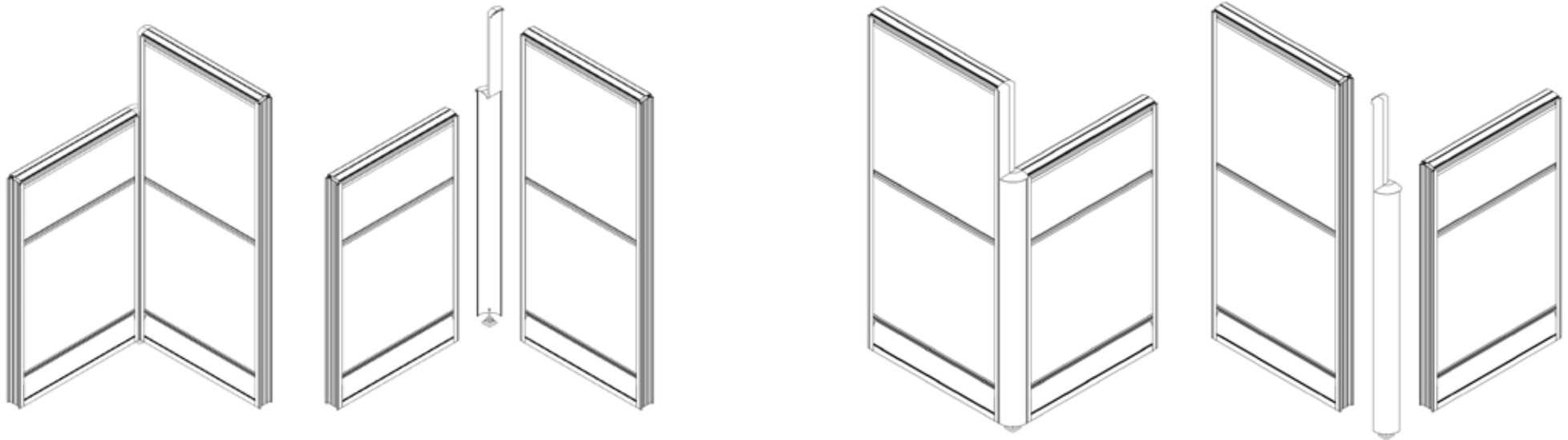

VIEW INSTALLING a Wall Mount Video:
<http://www.youtube.com/watch?v=5d8EOlx2CBw>

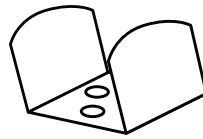

Wall Mount Connector

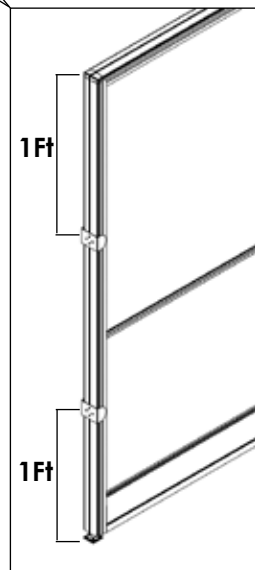
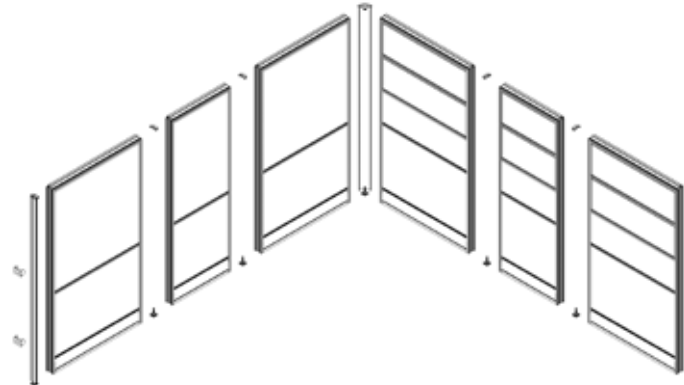
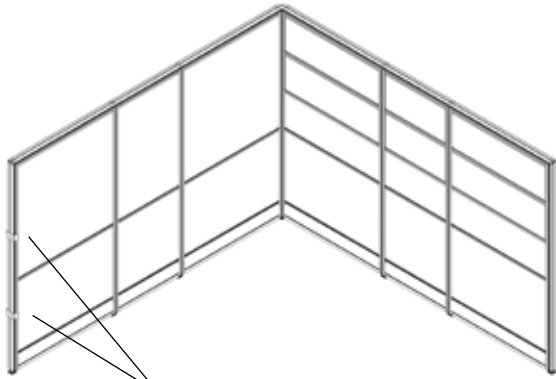

***Wall mount connector placement:**

One wall mount will be placed one foot from the floor. The second wall mount will be placed one foot from the top of the panel.

- Use two (2) brackets. Please install end trim.
- Push panel against bracket.
- The weight of the panel will hold panel in place.

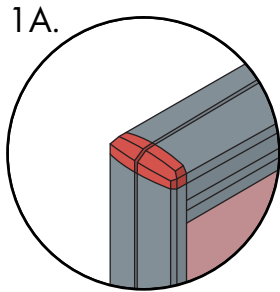

End Cap

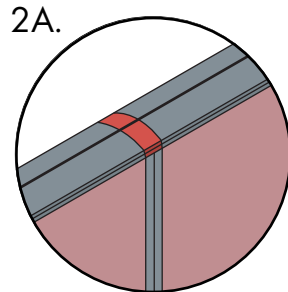

Straight Connector

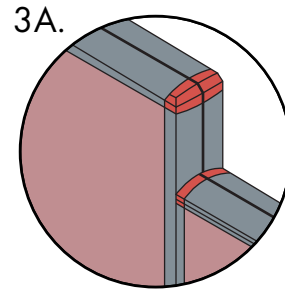

Straight Step
Down Connector

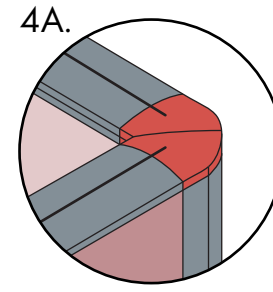

2 Way Connector

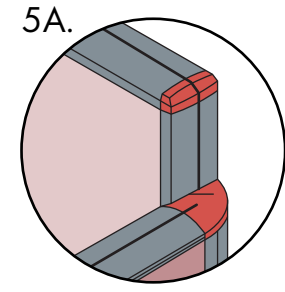

2 Way Step Down
Connector

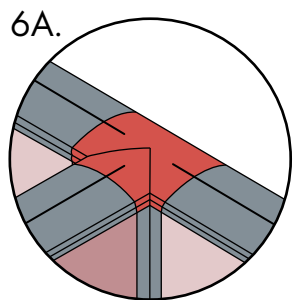

3 Way Connector

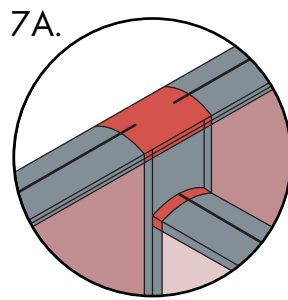

3 Way Step Down
Interior Connector

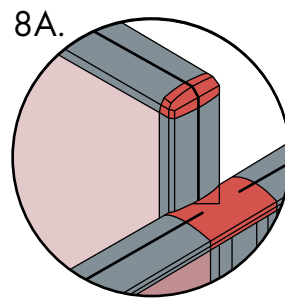

3 Way Step Down
Exterior Connector

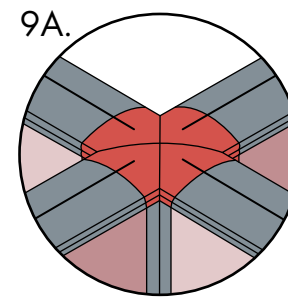

4 Way Connector

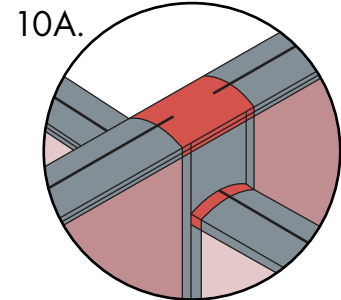

4 Way Step Down
Connector