

Stackable Cubes General Assembly Instructions

⚠ Note: the assembly instructions below are just an example to assemble 2 cubes together, but suitable for all the interlocking cube organizers we sold. Please follow the steps and start assembling from the bottom tier and gradually building the structure up.

Step 1

Let's build the base: connect 2 panels together with 2 connectors. Add 4 more connectors to the corners (a total of 6 connectors used, as shown in the image); make sure all connectors are placed in the correct direction, with the brand name "LANGRIA" in the front or the back, not facing the sides.

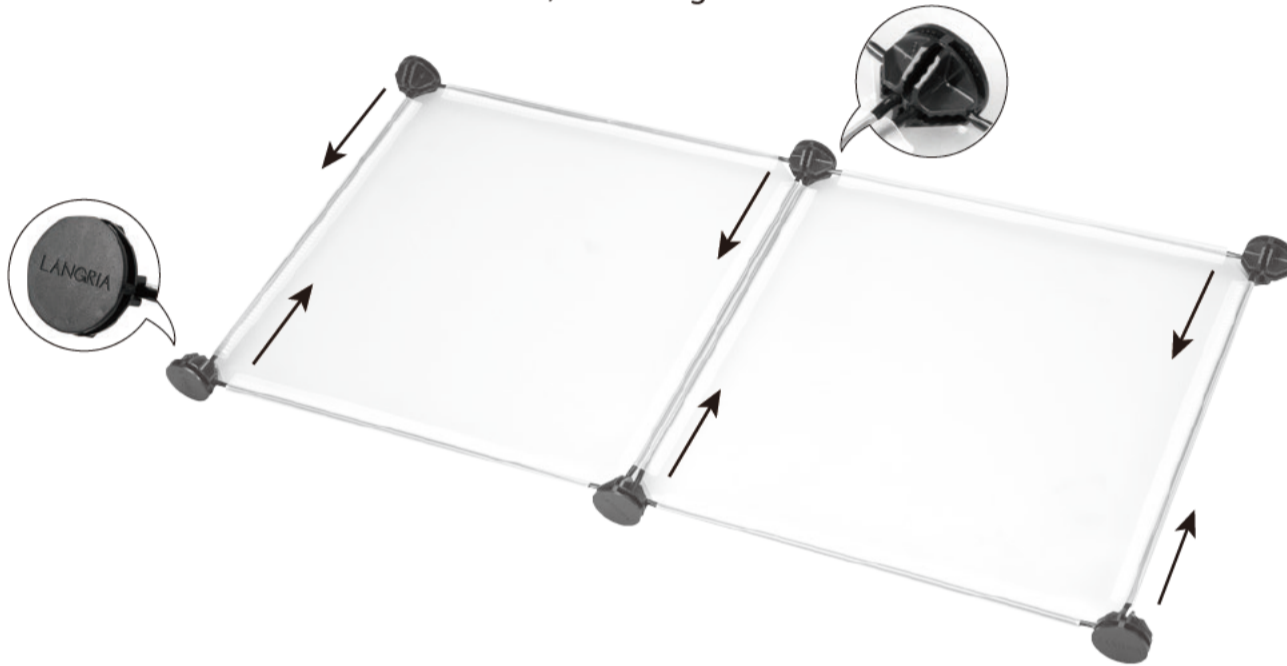

Step 2

Insert the side and back panels from the top, as indicated by the arrows in the image.

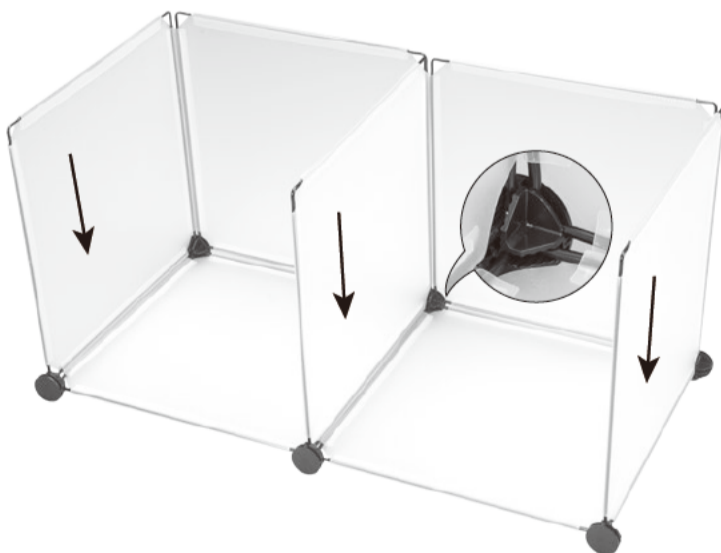

Step 3

Insert the side panel of two adjoining cubes into the slots of the connectors. Make sure all panels reach deep into the slots until a click is heard and almost no gap is found between them.

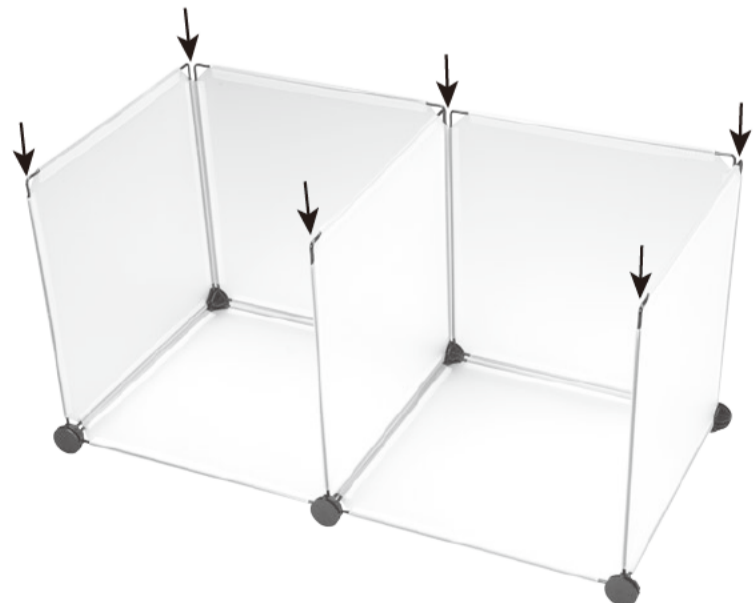

Step 4

Insert the upper panels from the front to the back, in the direction indicated by the arrows, and attach connectors to the front. Make sure all the connectors are facing the correct direction.

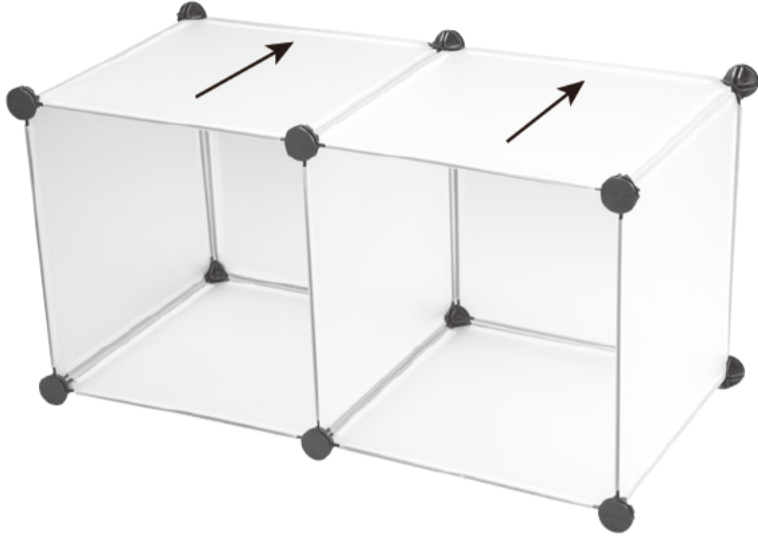

Step 5

Insert the front door panel into the connectors for each cube to complete the bottom tier assembly.



Step 6

Repeat the process to assemble the remaining tiers of your cube organizer.

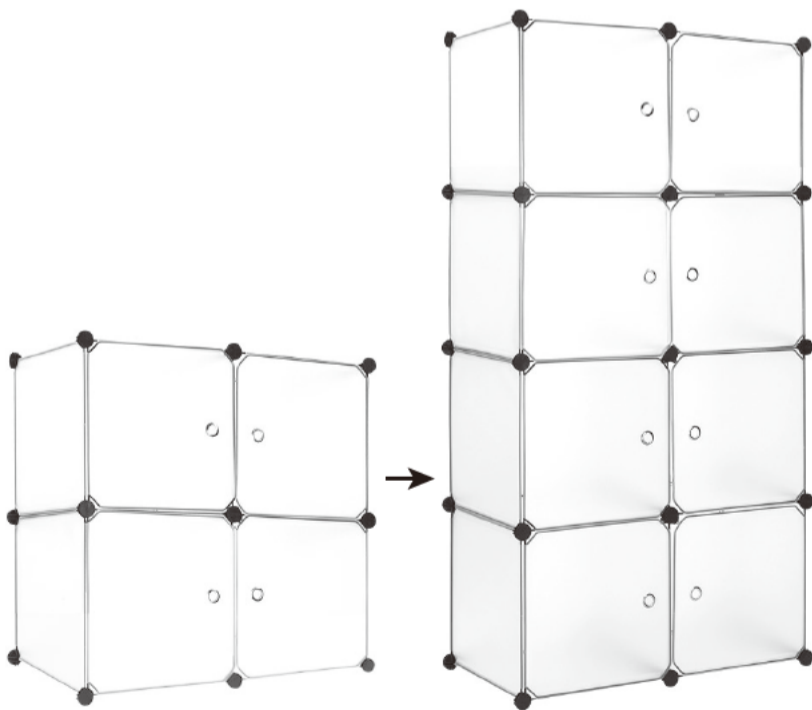

Step 7

When the assembly process is finished, press the connectors on the sides of the unit and make sure again that all panels reach deep into the slots and that there is almost no gap between the panels.

