

Installation & Assembly

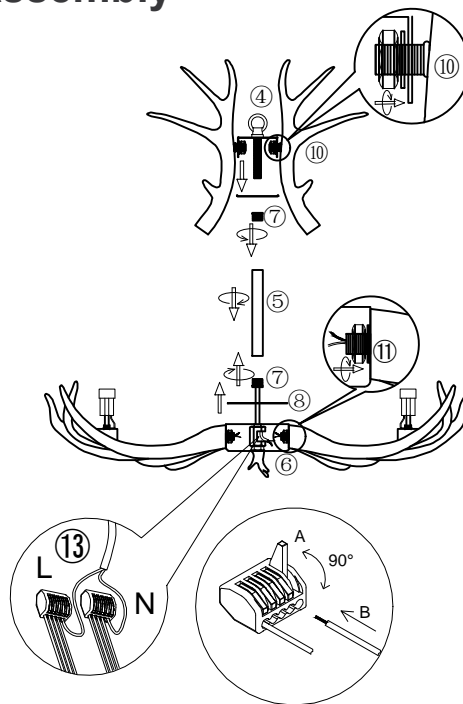

1. Loosen threaded rod ⑦ to remove out the cover ⑧ from resin box ⑥, install the antler light arm ⑪ to the box ⑥ with lock nut and teeth lock washer.
2. Connect all the wires by parallel with connectors ⑬ (all live line-L use one connector, and neutral Line-N use another connector), close the cover plate ⑧ on the box ⑥ with thread rod ⑦.
3. Let the wire go through the hanging tube ⑤, rotate to fasten the tube ⑤ to the fixture.
4. Loosen the threaded rod ⑦ of metal box ④ to remove out the cover plate, install the antler ⑩ to the box ④ with lock nut and teeth lock washer, close the cover plate to the metal box ④ with threaded rod ⑦.
5. Let the wire of the fixture go through the metal box ④, rotate to install the box to the fixture.

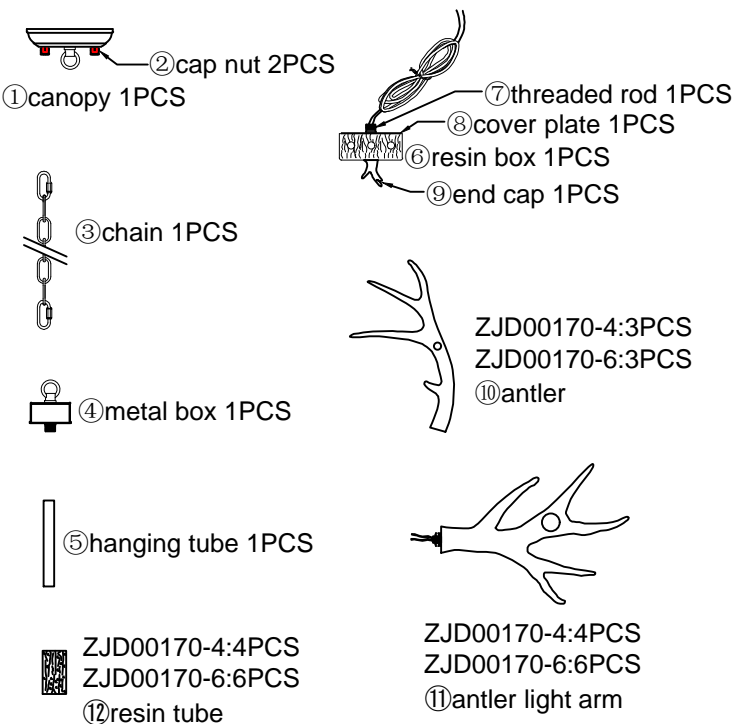
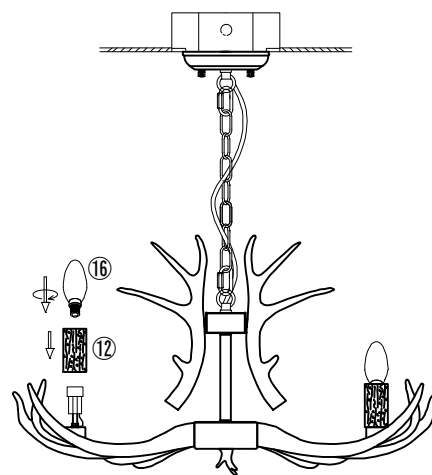
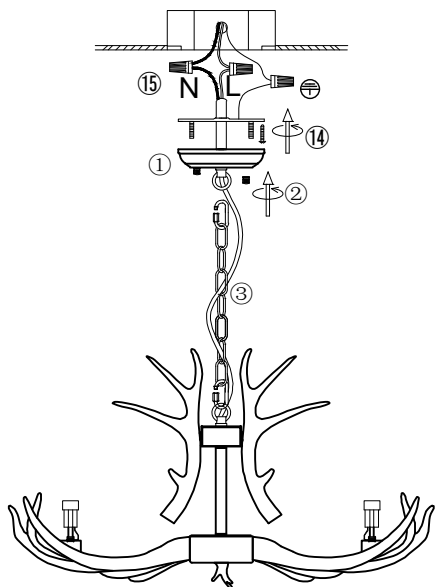
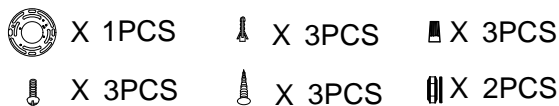

6. Hang the fixture to the canopy ① with chain ③, let the wire go through the chain ③ and canopy ①.
7. Install the bracket to the ceiling junction box with screw ⑭.
8. Connect the wire to the home line with cap connector ⑮.
9. Install the fixture to the bracket with cap nut ②.

10. Put the resin tube on top of bulbholder.
11. Install the bulb ⑯.

Please read carefully before installation!!!

Note : Please make sure that the electricity is powered off during installation !
Only a professional electrician should install this kind of product !