

# Instruction Sheet

SAVE ALL PACKAGING MATERIALS UNTIL PRODUCT IS FULLY ASSEMBLED. HARDWARE AND SMALL PIECES MAY NOT BE SEEN AND BE ACCIDENTALLY DISCARDED WITH PACKAGING MATERIALS.

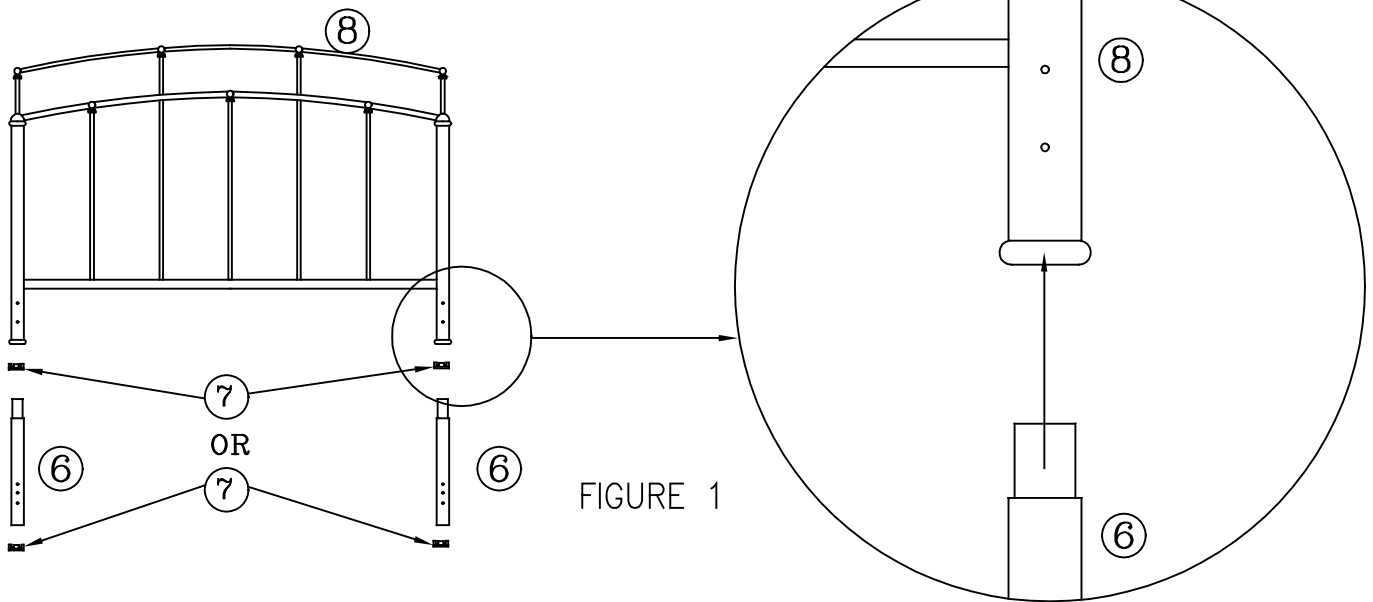

FIGURE 1

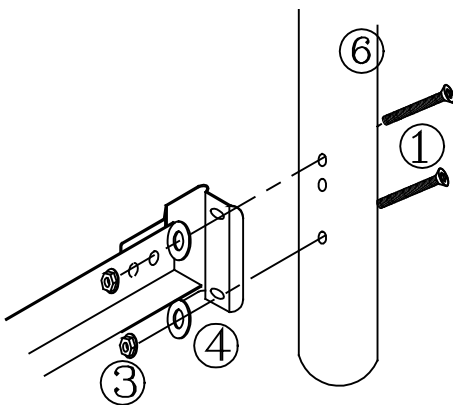

FIGURE 2

NOTE: This product can be used as Headboard only or as Headboard/Footboard bed. Insert plastic glide (7) into leg extension (6) for headboard assembly. For footboard assembly insert plastic glide (7) into bottom of panel (8) posts. See Figure 1

## Step 1 Headboard assembly

- Align top reduction of extension legs (6) with bottom of headboard posts. (See Figure 1) Make sure the 3 holes on extension legs are perpendicular to headboard panel.
- Now carefully insert extension legs (6) into bottom of panel (8) posts.

## Step 2

- Place headboard and frame in desired location in room.
- Place 2 screws (1) through holes located in leg (6). (See Figure 2)
- Align bed frame bracket over screws.
- Place a flat washer (4) first and then a nut (3) on each screw. Hand-tighten, DO NOT TIGHTEN screws all the way.
- Repeat on other side of headboard.
- Tighten all screws securely using the Allen wrench.

## Step 3 Footboard Assembly

- Discard Leg extension (6) for footboard attachment to frame.
- Position footboard panel and align holes in the panel (8) post with holes in the frame bracket. See figure 3
- Place flat washer (4) on each screw (2). Insert through bracket and into post. Hand-tighten, DO NOT TIGHTEN screws all the way.
- Repeat on other side of footboard panel.
- Tighten all screws securely using the Allen wrench.

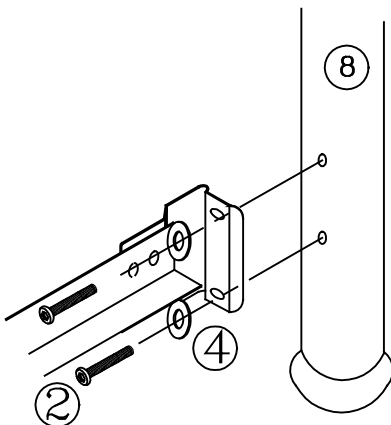

FIGURE 3