

Storage Bench

A line drawing of a rectangular box, possibly a storage container or a piece of furniture. The top surface is divided into a grid of rectangular sections by lines, suggesting a tufted or quilted design. The front and side edges of the box are decorated with a border of small, evenly spaced circles, resembling rivets or a decorative trim. The box is shown from a three-quarter perspective, highlighting its rectangular shape and the details of its top and edges.



- ① Bolts x 8 ② Plastic Washers x 4 ③ Flat Washers x 8 ④ Spring Washers x 8 ⑤ Allen Key x 1

Step 2

Close the storage and upside down the bench, then attach the wooden legs (C) to the bottom of armrest with plastic washers (2), turn and tighten the legs one by one, adjust all the 4 legs to the same level finally.

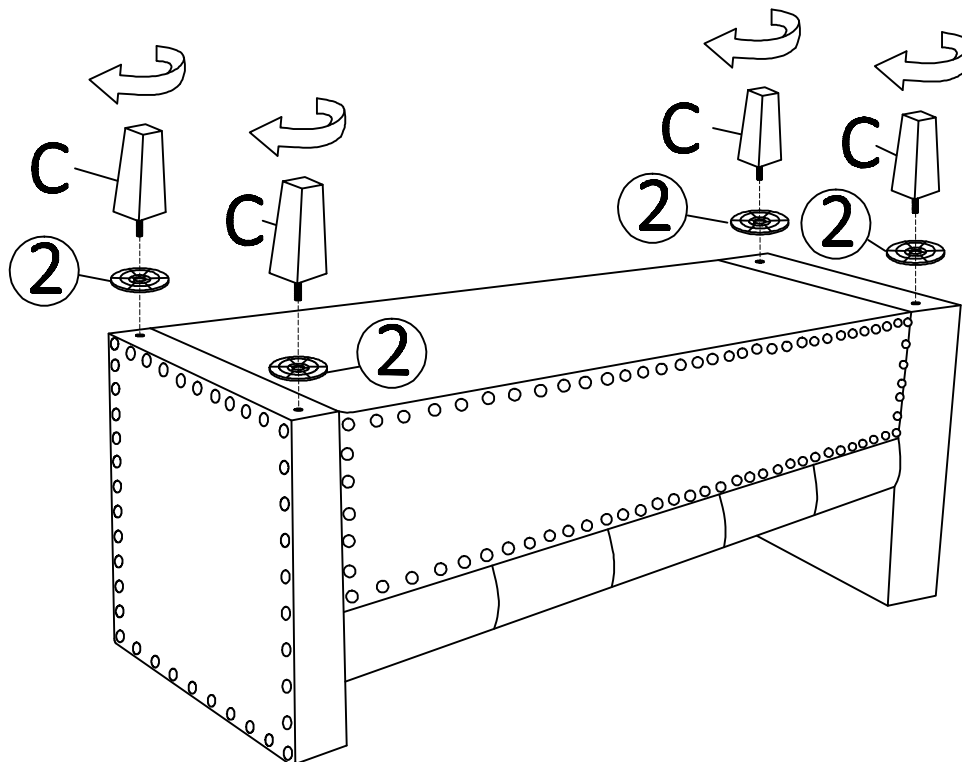

Step 3 Place the bench upright on the level floor, then the assembly is complete.

