

Assembly Instructions

⚠ Before you throw the carton, please ensure that you have all the parts needed for the assembly.

⚠ **Hardware Note:**

1. For each step please don't fully tighten all the screws at first, when they all align to the holes you can fully tighten them.

2. All the bolts should be assembled **vertically** to the holes.

⚠ **Spare parts** can be found in the hardware box if you do not have enough bolts for assembly.



2pcs

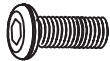

4pcs

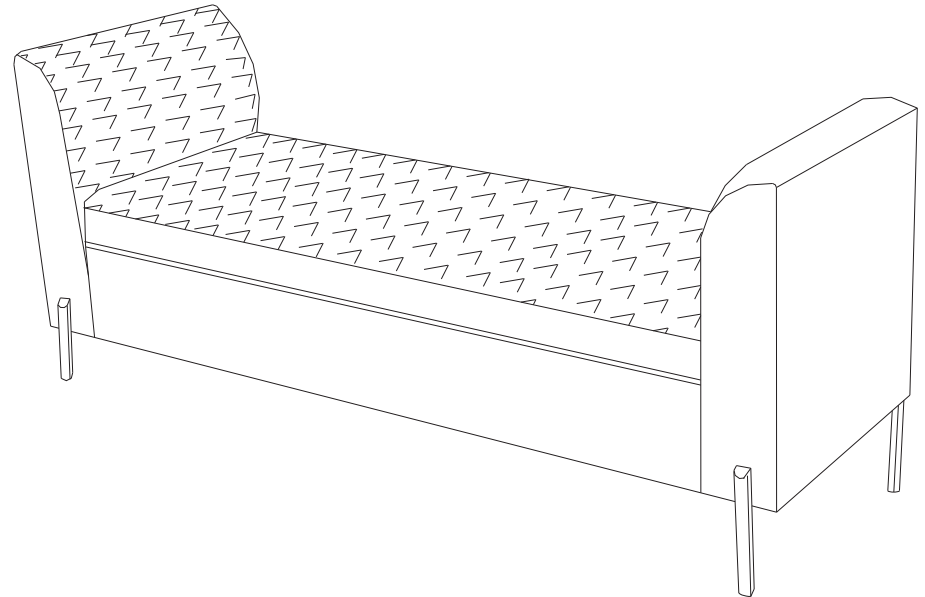

⚠ THIS INSTRUCTION BOOKLET CONTAINS IMPORTANT SAFETY INFORMATION. PLEASE READ AND KEEP FOR FUTURE REFERENCE.

Assembly Instructions

Parts and Hardware

Please check to make sure you have all parts and hardware before starting assembly process.

A

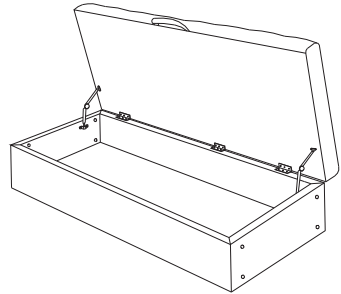

Seat Cushion 1pc

B

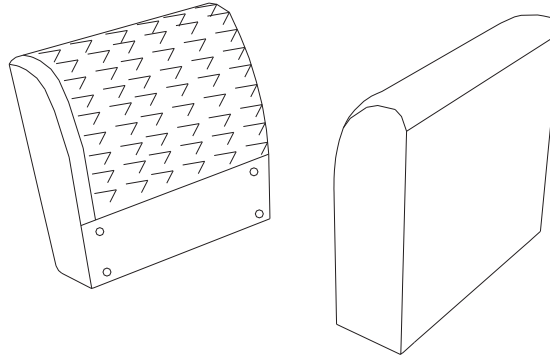

Arms 2pcs

C

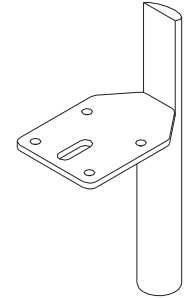

Legs 4pcs

1



Long Bolts
8pcs

2



Short Bolts
16pcs

3

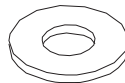

Flat washers
8pcs

4



Spring washers
8pcs

5

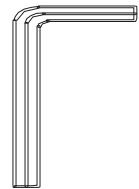

Wrench 1pc

Assembly Instructions

Assembly Instructions

Step 1: Connect 2 arms to seat using bolts ①, spring washers ④ and flat washers ③. Half tighten the bolts one by one, when they all align to the holes, fully tighten them by the short side of wrench.

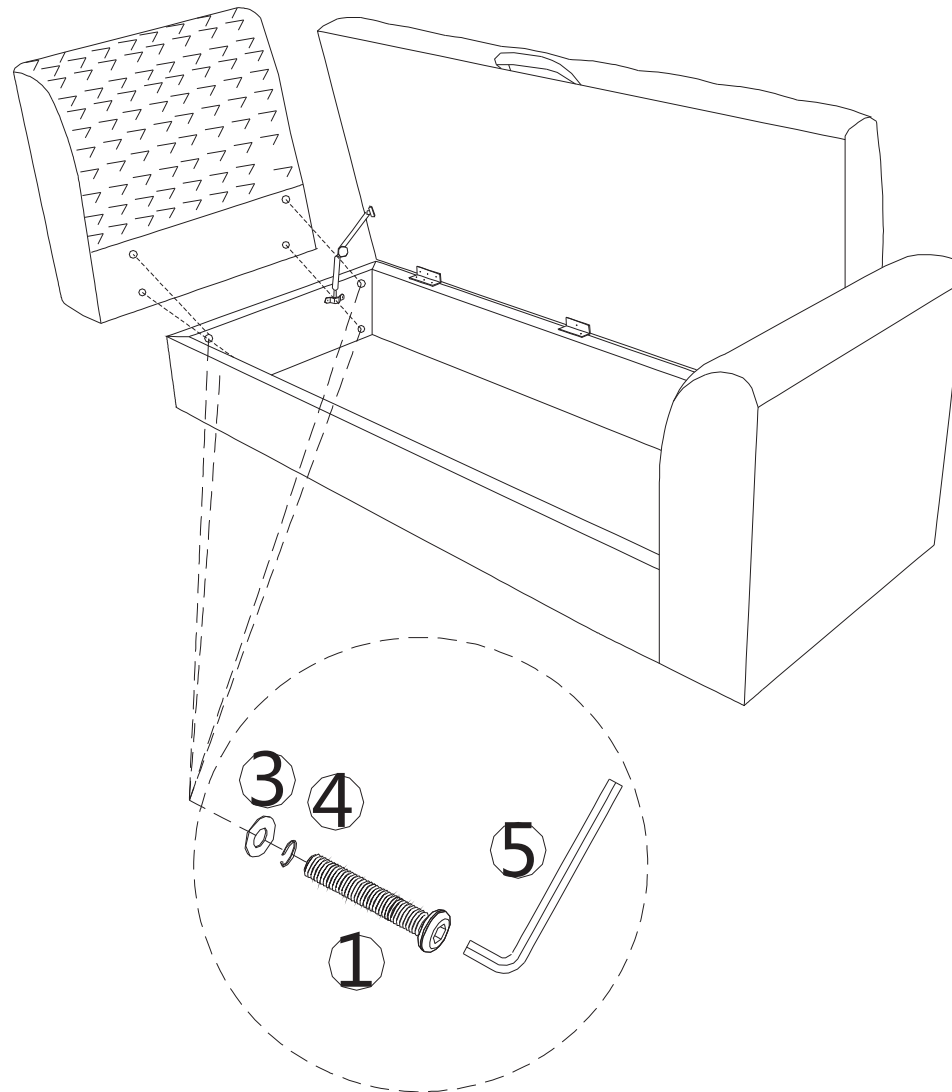

Assembly Instructions

Assembly Instructions

Step 2: Assemble 4 legs to the bottom of bench. Half tighten the bolts one by one until all of them are align to the holes then fully tighten them by the short side of wrench.

