

1. Install the arms 2 to the plate 3 with nut 1, adjust the arms to the suitable position.

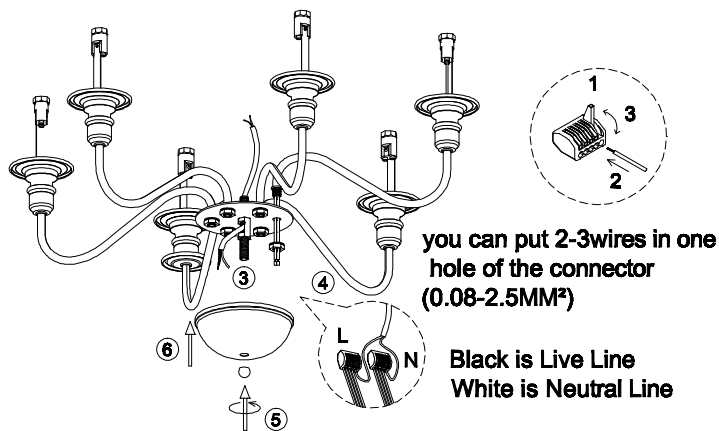

2. Connect all the wires by parallel with connectors 4 (all live line-L use one connector, and neutral Line-N use another connector).  
 3. Install the box 6 to the fixture with nut 5.

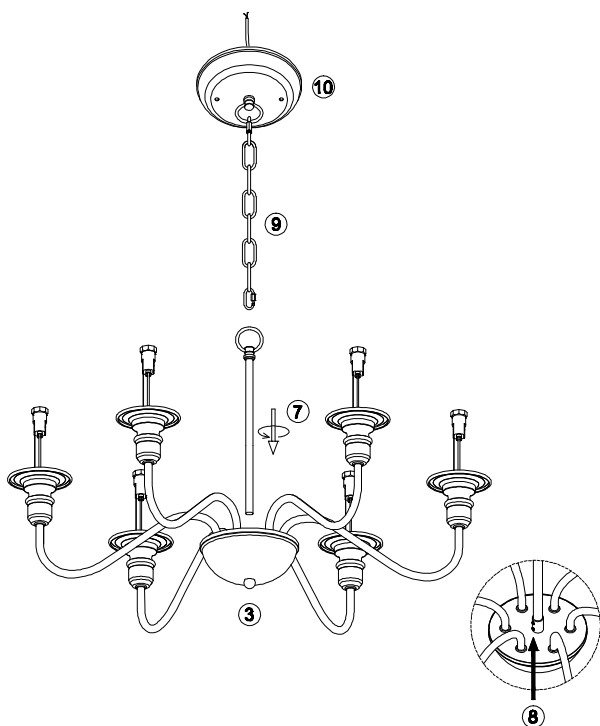

4. Let the wire go through the tube 7 and lock it on the fixture with screw 8.  
 5. Connect the fixture 7 and the canopy 10 with chain 9.

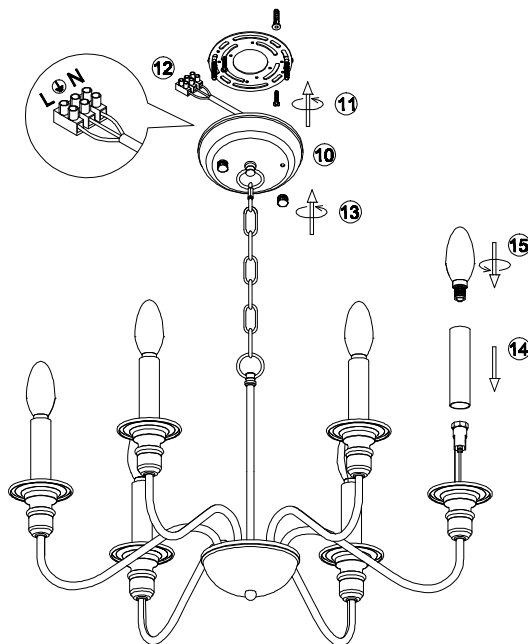

6. Install the bracket on the ceiling with screw and explore tube 11.  
 7. Connect the wire with connector 12 to your home line.  
 8. Install the fixture to the bracket with nut 13.  
 9. Put the tube 14 on the bulbholder and install the bulb 15.

**Please read carefully before installation!!!**

**Note : Please make sure that the electricity is powered off during installation !  
 Only a professional electrician should install this kind of product !**