

# Coat Hooks with Tray

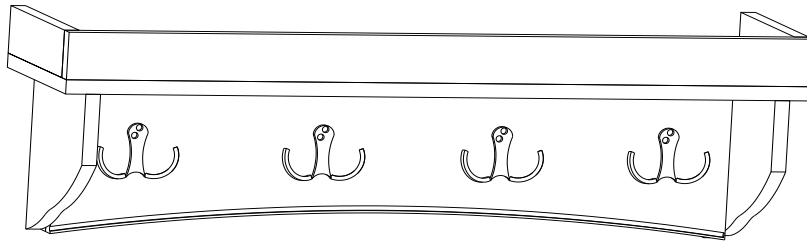

Thank you for purchasing our Coat Hooks with Tray. Assembly of this product requires a screwdriver. **We have found it helpful to have a second person present in at least one step of the assembly.**

## Coat Hooks with Tray Assembly Instructions

Lay out all parts on a "non-abrasive" surface to avoid scratching furniture.

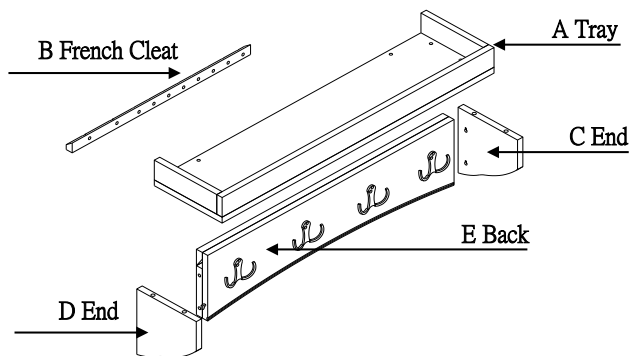

NO.	Drawing	Description	Qty.	NO.	Drawing	Description	Qty.
A		Tray	1	F		Hex Bolt-30mm	8
B		French Cleat	1	G		Wood Screw	4
C		End-1	1	H		Hex Wrench	1
D		End-2	1				
E		Back	1				

### PARTS

#### Step 1

Read through these instructions thoroughly before beginning assembly. We have found this to be of great value when first assembling this product.

### Step 2

Remove all parts and hardware from packing material. Wooden pieces should be placed on a non abrasive surface (like the carton or carpet) to prevent damage to the finish. Note the French Cleat (B) is pre-installed on the back of the Back (E) with 2 of the Wood Screws (G).

### Step 3

Remove the French Cleat (B) from the back of the Back (E) by unscrewing 2 of the pre-installed Wood Screws (G) on the top of the Back (E). Locate studs behind drywall in desired location. Attach French Cleat (B) to wall studs with 2 Wood Screws (G).

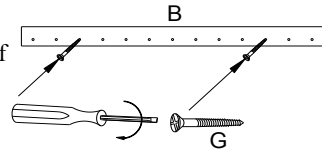

### Step 4

Align through holes in the cleat on Back (E) and inserts in End (C). Secure Back to End using Hex Bolt (F). Tighten Hex Bolt (F) using Hex Wrench (H).

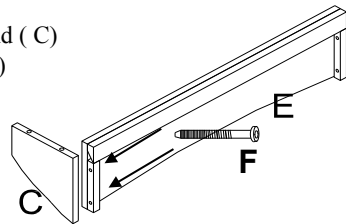

### Step 5

Attach the other End (D) by aligning thru holes in cleat of Back (E) to inserts in End (D). Thread Hex Bolt (F) into threaded inserts in End (D). Tighten Hex Bolts using Hex Wrench (H).

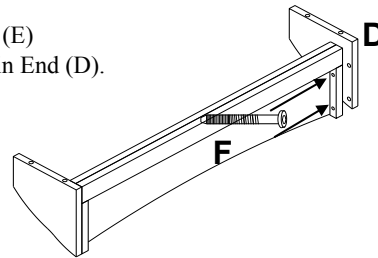

### Step 6

Seat Tray (A) down firmly. Align Thru holes in top of Tray (A) to inserts in End (C) and (D). Thread Hex Bolts (F) into threaded inserts in End (C) and (D). Tighten Hex Bolts using Hex Wrench (H).

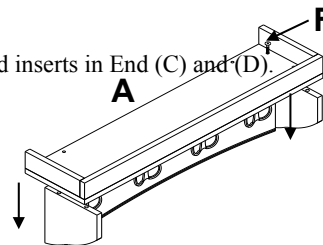

### Step 7

Set Hooks Tray on French Cleat (B) and attach with 2 Wood Screws (G).

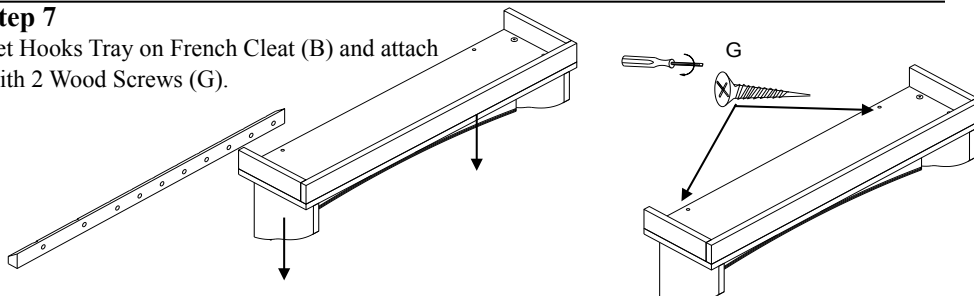

### CARE

Clean with mild soap and wipe dry.

**Thank You!**