

4' Asheville Fir Artificial Christmas Potted Tree
Pre-Lit w/ 100 ct. Clear Mini Incandescent Lights



IMPORTANT, RETAIN FOR FUTURE REFERENCE: READ CAREFULLY.

PARTS LIST

- 1 EA. TREE POT
- 1 EA. TREE BOTTOM SECTION "A"
- 1 EA. TREE TOP SECTION "B"
- 1 EA. SPARE BULB/FUSE PACK

ASSEMBLY

Carefully remove the contents from the carton and keep the carton for future storage. Be sure to untangle any wires that may be tangled with other items. (Please DO NOT forcibly remove any contents.)

Step 1: Locate the Tree Pot and place it where you are going to set up the tree – ensure that it is on a level surface and near a dedicated power source. **THIS PRODUCT IS SUITABLE FOR INDOOR AND OUTDOOR USE.**

Step 2: Locate the Tree Bottom Section “A” which is tagged with the letter “A”. Remove any plastic protective pole cap that is on the bottom of the pole (it can be saved and reused for storage if desired). Insert Tree Section “A” into the Tree Pot. Do not force the pole. It will slide down to its correct position. Make sure the pole is firmly seated and standing straight.

Step 3: Locate Tree Top Section “B” which is tagged with the letter “B”. Insert it into the top of Tree Section “A”.

Step 4: Connect the plug(s) from each tree section into the section below securely. The light sets each have a male and/or female end connection with “Please plug in here” tags, so that you can find the corresponding connection easier. Once all the light sets are connected in the tree, locate the male power plug and insert it into a 120-volt power outlet in your home or into a UL approved extension cord or power strip (not included). The tree should now be lit. If some bulbs do not light, please go to the **TROUBLESHOOTING GUIDE FOR LIGHT SETS** for steps.

SHAPING

1. Plug in the lights as you are shaping the tree. It is easier to see how the tree looks.
2. Remove any packing strap or other packing material that is around the tree section(s) and allow the branches to fall into place.
3. Shape by section and layer, starting at the bottom of the tree and working your way up to ensure all branches are shaped.
4. Slowly pull down each branch to an approximate 90° angle to the floor on the lower sections and about a 45° angle on the upper sections. While doing so, shape the tips on each individual branch by fanning out the tips to fill any spaces. Offset the branches from one another to hide the tree’s pole and fill spaces. Continue spreading the tips until they resemble that of a real tree.
5. After shaping the whole tree, step back and take an overall look. Shift branches to fill any gaps. Your tree is now ready to decorate and enjoy!

CLEANING & CARE

As you will be using the artificial Christmas tree every year, it is essential to keep it in good condition and clean.

- Dust gently using a soft cloth or fabric duster.
- Do NOT use any chemicals or solvents to clean.
- Handle the light sets gently. Do NOT pull or tug light sets as this may inadvertently loosen the bulb.
- Follow all Storage and Safety Instructions.

STORAGE

1. Unplug the tree from the power source in your home and disconnect the plug connection between the tree sections.
2. Remove any ornaments and decorations that were added by you and did not come with the tree.
3. After the tree is used outdoors, allow the tree to dry thoroughly prior to packing.
4. Starting with the top, separate each tree section and pot gently, being sure not to roughly handle as it could cause damage to the parts and could loosen or break bulbs.
5. Compress each tree section by turning it upside down and squeezing the branches together so that it will fit more easily into the storage box or container. You can also tie a ribbon or cord around the sections to secure the branches closer together for storage.

- Place all the parts gently back into the storage box. The box will help prevent the tree from being damaged should it get bumped in your garage, basement, or other storage location. Tape the box shut to keep out any dust or insects. When packing up the tree, please ensure that there is no undue strain or stress on the light sets to ensure they do not get cut, frayed, or damaged.
- Be sure to store the tree in a cool, dry area free of water and moisture to prevent mold and mildew from accumulating and a musty odor developing. Exposing your tree to excessive heat or humidity may damage your tree. **DO NOT STORE TREE IN A DAMP AREA OR IN AN AREA WHERE THE TEMPERATURE EXCEEDS 100°F. STORE THE CARTON FLAT AND NOT UPRIGHT ON ITS SHORT END.**

TROUBLESHOOTING GUIDE FOR LIGHT SETS

If your lights are not working, following are some troubleshooting steps to try:

- Check that the light set plugs are properly connected to your home wall outlet or other power source.
- Check that there is power to the wall outlet or power source.
- Check that all the plugs within the tree are securely connected and positioned correctly.
- Check for loose bulbs or poor contacts in bulb sockets. Follow along the non-working light set and ensure each bulb is seated firmly inside each socket with its tab securely "locked". **DO NOT TWIST BULBS.**
- Look for any broken, burned out, or missing bulbs and replace as needed.
- Replace non-working, missing, or broken bulbs as soon as discovered to avoid reducing the longevity of the light set. Not replacing bulbs promptly will cause too much voltage to go to the remaining lit bulbs.
- Replace only with bulbs that came with the product or recommended by the manufacturer. Spare bulbs were included with your purchase.

To Remove a Bulb: Undo bulb locking tab located on one side of the socket (See **Fig. 1**). Gently grasp the plastic base of the bulb. Do not pull on the glass bulb section. Pull up and out from socket. **NOTE:** Some lights may not have a locking tab.

To Replace a Bulb: Align base of bulb and locking tab to socket. Push in until firmly seated. Lock tab securely. **DO NOT TWIST BULB.**

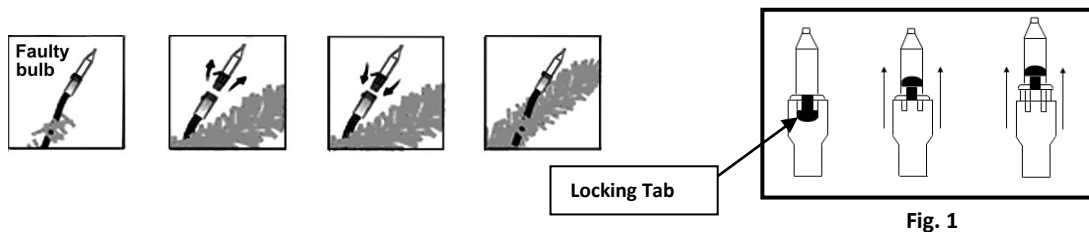

- If none of the lights are working, check the fuses in the light set plug. If the fuse(s) are blown (usually has darkened glass), replace the blown fuse(s) by following the steps in the following diagram. There are spare fuses included for easy replacement.

To Remove a Fuse: Gently slide the plug cover open. Lift blown fuse out of the socket.

To Replace a Fuse: Place the new fuse into empty socket. Gently close cover.

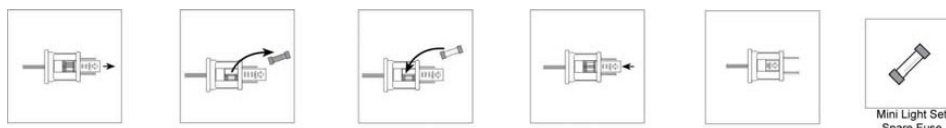

IMPORTANT SAFETY

PLEASE READ AND FOLLOW ALL SAFETY INSTRUCTIONS AND WARNING TAGS INCLUDED WITH THIS TREE.
SAVE FOR FUTURE USE.

THIS TREE IS SAFE FOR INDOOR & OUTDOOR USE.

- When products are used in outdoor applications, connect the product to a Ground Fault Circuit Interrupter (GFCI). If you do not have one, contact a qualified electrician for proper installation.
- Do not operate this product if the power cord or plug is damaged. Always inspect light sets and electrical cords for signs of damage or wear. If there are any observable defects, immediately dispose of them and replace it with one that is in working order.

- Do not immerse the tree or any of its components in water or other liquids. Do not use in a bathroom or within 10 feet of a pool.
 - This is an electrical product - not a toy! To avoid risk of fire, burns, personal injury and electric shock, it should not be played with or placed where small children can reach it.
 - Be careful not to overload electrical circuits and do not string more than the manufacturer recommended number of light sets together.
 - This seasonal use product is not intended for permanent installation or use.
 - This product is not intended for commercial purposes.
 - Do not secure the wiring of this product with staples or nails or place on sharp hooks or nails.
 - Do not alter the construction of the wiring in anyway.
 - Unplug the product when leaving the house, retiring for the night or if left unattended.
 - Do not use this product for anything other than its intended use.
 - Do not hang ornaments or other objects from the cord, wire, or light string.
-
- Do not close doors or windows on the product or extension cords as this may damage the wire insulation.
 - Do not cover the product with cloth, paper, or any material not part of the product when in use.
 - Do not mount or support strings in a manner that can cut or damage the wire insulation.
 - Do not mount or place near gas or electric heaters, fireplaces, candles, or other similar sources of heat.
 - Do not place your tree where it is likely to wobble due to uneven floors or thick carpeting. Place tree on a level, hard, flat surface.
 - Use only manufacturer specified replacement bulbs.
- 