

Caster-Base Instructions

Instructions:

- (1) Place Caster-Base on a level floor and lock the casters ****FOR SAFETY****.
- (2) Using two people,  lift the unpackaged cabinet and set it in the caster-base so the two locking casters are along the front of the cabinet.
- (3) This completes the installation. Your mobile cabinet is ready to use. Unlock the casters and move to the preferred location.

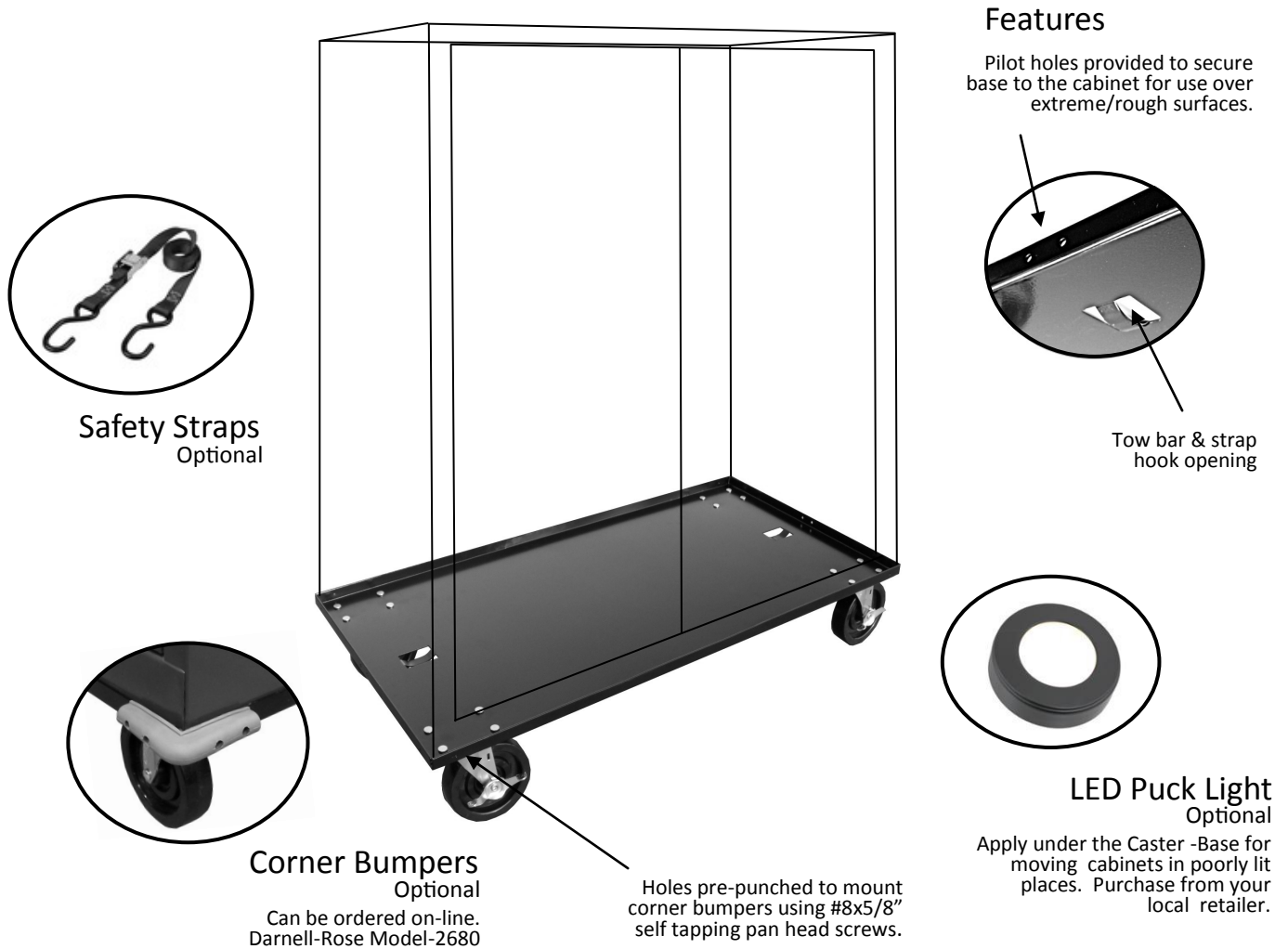

For extreme conditions, like steep inclines and severely rough surfaces, we provide two options to secure the cabinet to the base.

Option 1 (Not Required For Normal Use) - Screw the Caster-Base to the Cabinet

Two pilot holes are provided on each end of the caster-base (See Diagram) to allow you to secure the Base to the cabinet. Use a power drill and four #10-16x5/8" self-tapping screws. All four screws must be used. (Purchase screws from local retailer.)

Option 2 (Not Required For Normal Use) - Safety Straps (Purchase from local retailer.)

Estimated length of strap for cabinet size:

36"Wx42"H cabinets, 12 ft straps
36"Wx72"H cabinets, 16 ft straps
36"Wx78"H cabinets, 18 ft straps

46"Wx42"H cabinets, 14 ft straps
46"Wx72"H cabinets, 18 ft straps
46"Wx78"H cabinets, 18 ft straps