



HPZTM Pet Rover ***RUN***

Pet Stroller Owner's Manual



5-STAR
★★★★★
Customer Ratings



**3-Years Wheel
Protection**

Register your Pet Rover product online at PetRoverUSA.com to activate Life-time warranty



Scan QR code for more
product info & videos

For product support, return, exchange & warranty
CONTACT CUSTOMER SERVICE

Tel# (888) 265-0589

Email: customerservice@petroverusa.com

9am-9pm Pacific, 7 days

BEFORE YOU START...

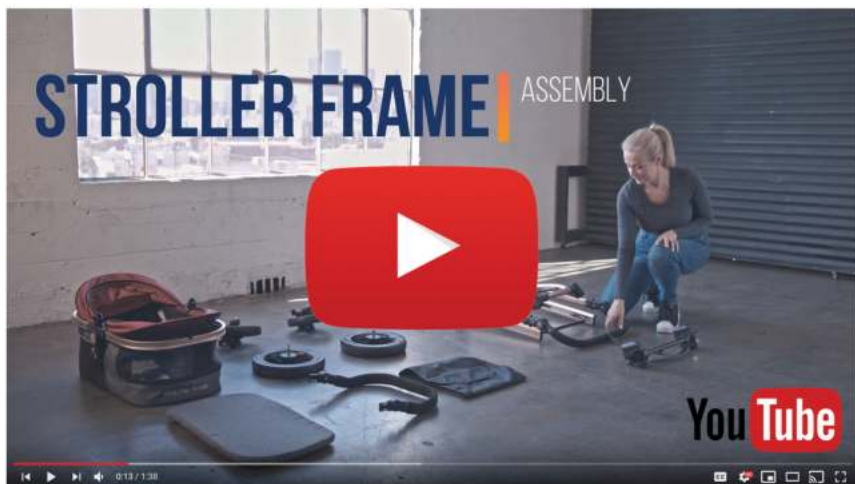

We strongly recommend you to watch our SETUP and HOW TO videos on our Youtube channel before you assemble and use the product.

Please scan the QR code below with your phone or visit <https://petroverusa.com/pages/product-manuals> to watch the videos.



PARTS LIST



Stroller Frame



Rear Wheel Axle



Rear Wheel Reflectors



Tire Air Pump

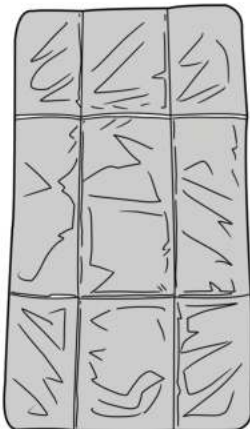

2x pads



1x Front Wheel
2x Rear Wheels

PARTS LIST



Stroller Frame



Rear Wheel Axle



Rear Wheel Install Hardware



Rear Wheel Reflectors



Tire Air Pump

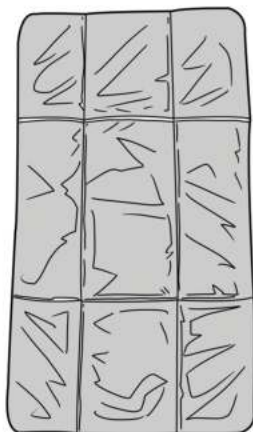

2x pads



1x Front Wheel
2x Rear Wheels

FEATURES

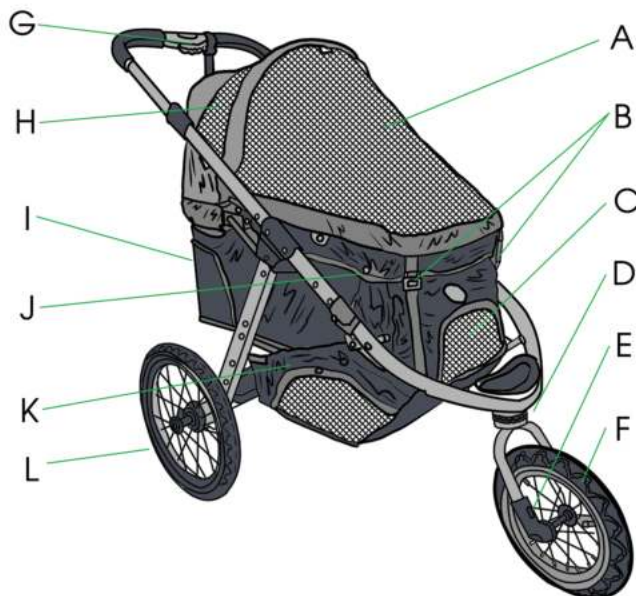

- A. multi-level stop canopy
- B. canopy locks
- C. front mesh window
- D. front wheel swivel lock
- E. front wheel release lock
- F. air-filled front wheel
- G. handlebar adjust button
- H. top mesh window
- I. storage pockets
- J. front lib open/close button
- K. under basket
- L. air-filled rear wheel

- M. hand strap
- N. fold/unlock trigger locks
- O. accessory pocket
- P. rear wheels brake bar

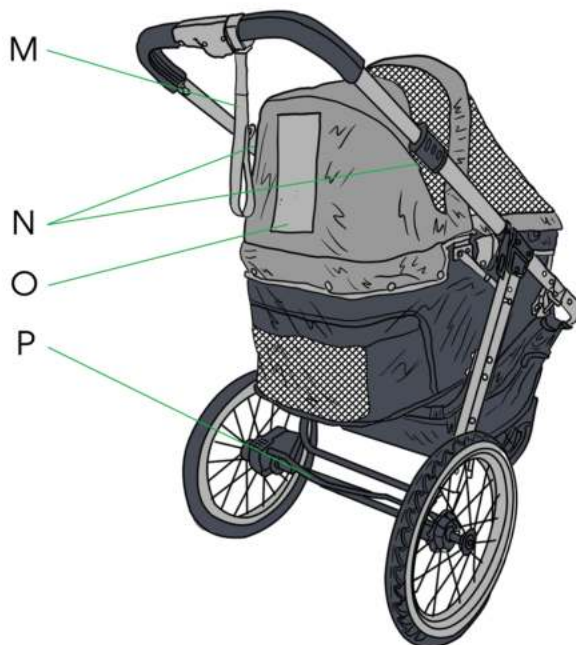

CANOPY INSTALLATION

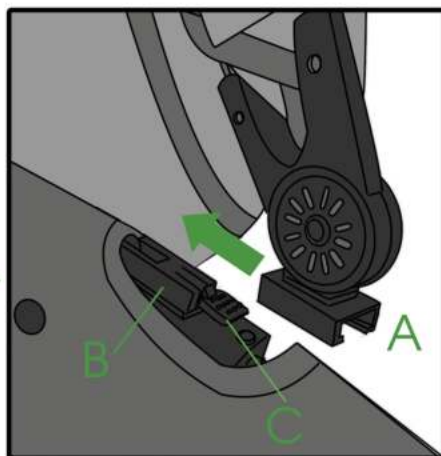
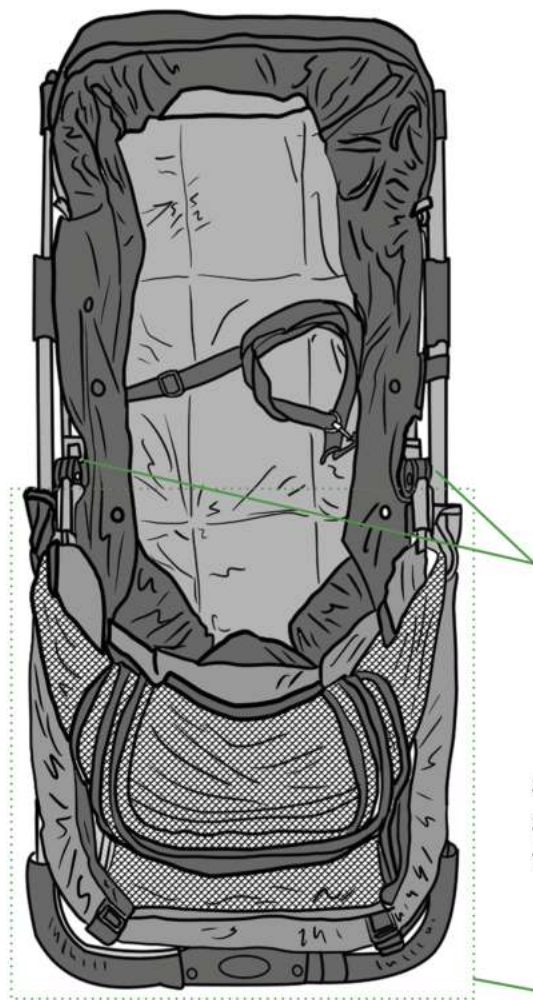

slide the canopy mount **A** to the stroller mounting base **B** until the tab **C** clicks to lock.

canopy

Slide the canopy from the front of the stroller to the stroller mounting base.

STROLLER ASSEMBLY

1. Make sure the folding lock is disengaged.
Pull triggers on the handlebar of both sides

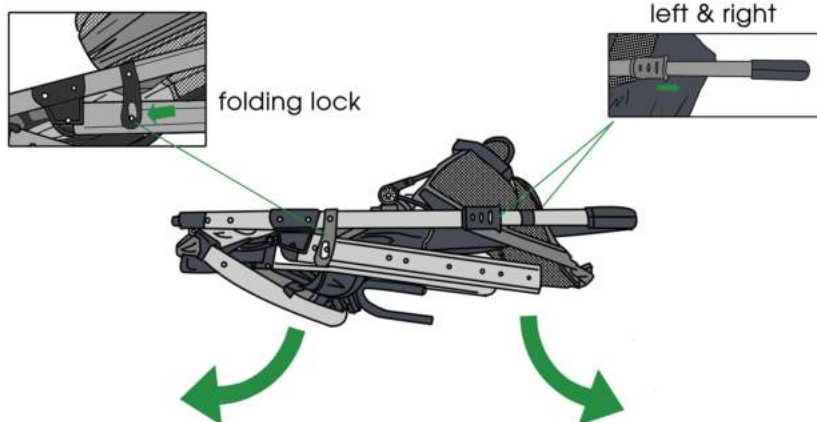

2. Unfold the stroller frame until it clicks to lock.

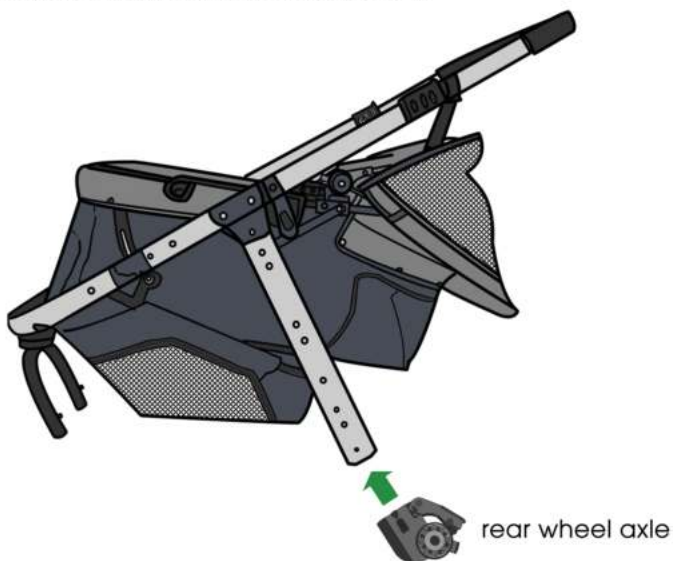

3. Insert the rear wheel axle to the stroller frame until it clicks to lock

FRONT WHEEL INSTALLATION



Insert the front wheel assembly to the axle until the tab and pin click to lock

REAR WHEEL INSTALLATION

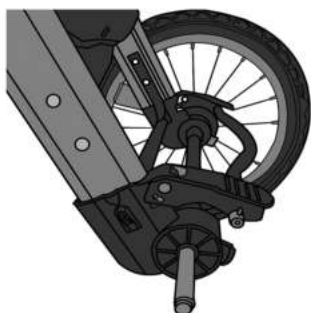

1. Insert the rear wheel to the rear axle assembly and press the metal tab until it clicks to lock. (Press the metal tab to detach the wheel.)



2. Attach the reflector to the wheel

LOWERING FRONT LIP

1. Push metal bar A (near the bottom) upward on both sides and then lower the front lid

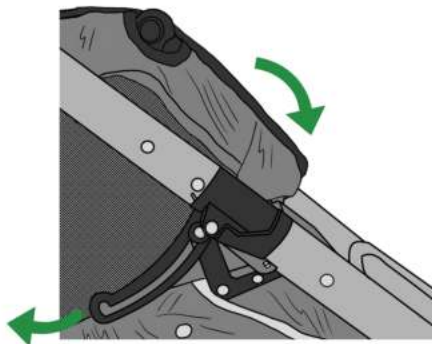
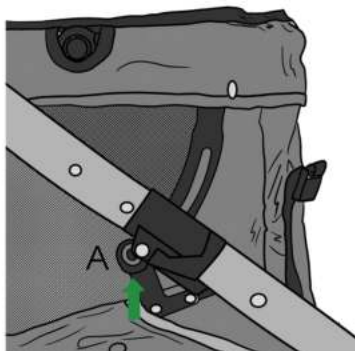

OPENING MESH SUNROOF

1. Unzip the mesh sunroof and roll up



2. Hold the sunroof with the button and tie

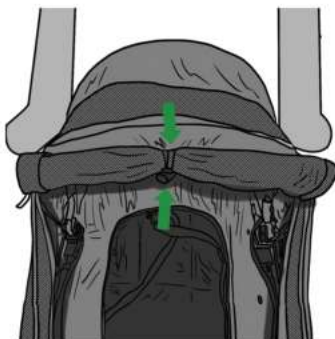

WHEEL OPERATIONS

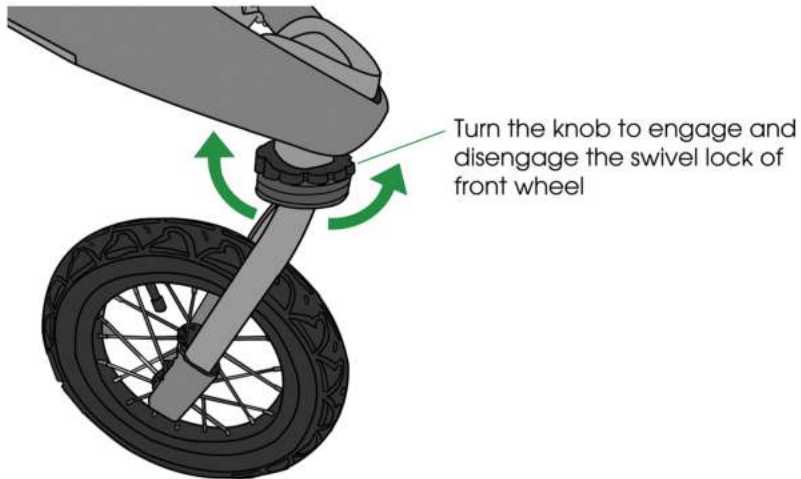

Use the red strap to prevent brake to engage unexpectedly during jogging or running



HANDLEBAR OPERATION

Push button to adjust handle bar height

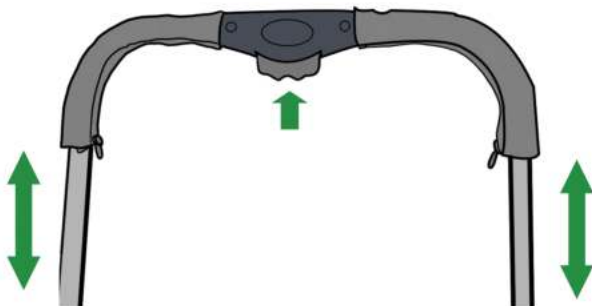

FOLD THE STROLLER

1. Push the button on the trigger.
2. Pull trigger up on both sides of the handlebar, push the handle bar down to fold the stroller

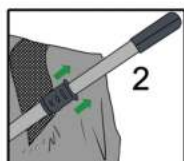

left & right



Make sure the folding lock is engaged

TIRE INFLATION

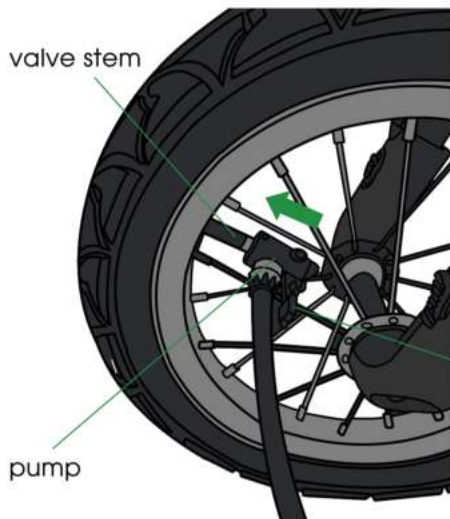

1. Remove the cap on the valve stem of the tire.
2. Insert the pump on the valve.
3. Snap the lever down into closed position

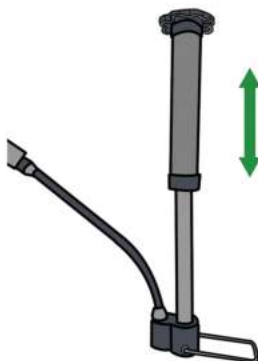
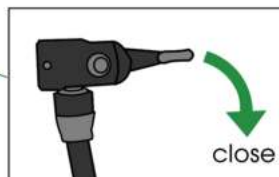

4. Inflat the tire by pushing and pulling the handle of the pump.

CLEANING & MAINTENANCE

*Before cleaning always refer to the fabric label for washing instructions.

PET COMPARTMENT, CANOPY, UNDER-BASKET. The fabrics are not detachable and non-washable, but can be wiped clean with a damp cloth.

PAD. The pad cover fabric is detachable and machine washable. The foam inside the pad fabric is non-washable and must be taken out before washing. The foam can be cleaned with a damp cloth. Insert the foam back in the pad fabric after cleaning before assembling the pad fabric back.

GRIPS. Handle grips are non-washable but can be wiped clean with a damp cloth.

FRAME. Clean with a soft towel and lukewarm water and wipe off any remaining water with a dry cloth. Use a soft brush to clean sand and dirt from the mechanisms of the chassis. Take care to brush away from any sliding joints.

WHEELS. Periodically, remove the wheels from the frame and brush off any dirt or sand in the inside axle of the wheel. Do not submerge the wheel bearings in water. Use a brush and water to clean dirt on the wheels. Lubricate moving parts (wheels, axles, & swivels) except brakes & locks with light machine oil.

WET CONDITIONS. Store your pet stroller and its accessories in a dry place and leave them to dry unfolded to prevent mold.

LIFE TIME LIMITED WARRANTY

WHAT DOES THIS WARRANTY COVER?

This warranty covers any defects in the frames, wheels, compartment, zippers, straps, seams in the covering, Velcro, and colorfastness of your HPZ product, with the exceptions stated below.

WHAT DOES THIS WARRANTY NOT COVER?

This warranty does not cover claims and damage from:

1. normal wear and tear,
2. misuse such as, but not limited to, improper storage and product care,
3. maintenance and use other than that indicated in the user guide,
4. failure to follow the instructions in the user guide,
5. abuse, neglect, carelessness, car accident or accident,
6. caused by the modification or alteration of the product,
7. air transportation or freight damage,
8. incorrect mounting or installation of third party parts that are incompatible with the product.

This warranty only covers damage and defects and does not extend to claims that you may have regarding dissatisfaction with the product in terms of its fit, weight, functionality, color or design. This warranty is limited to consumers - buyers of the product for their personal use or personal family or household purposes. This warranty does not extend to unauthorized purchasers of the product intended for resale or for purchasers who intend to use this product for commercial use such as rental of the product to others.

WHAT WILL WE DO TO CORRECT PROBLEMS?

We will repair your HPZ product at no cost to you, or if repair is not possible, replace the product. We will pay for transportation from and to the retailer that will service your HPZ product, as long as the repair or replacement is covered by this warranty. HPZ reserves the right to stop manufacturing a particular model, colour, fabric or accessory, and therefore it will replace a part with a similar product, colour or fabric during the period of this warranty.

To obtain service for your HPZ product, contact us via e-mail at customerservice@PetRoverUSA.com, or telephone at 1-888-265-0589 (9am to 9pm pacific, 7days).

SAFETY INFO & WARNINGS

- Do not carry additional bags, goods, or accessories in or on product except as recommended in the manufacturer's instructions.
- Recommend use of an approved safety restraint correctly fitted and adjusted.
- Do not leave pet(s) unsupervised in stroller.
- Before making adjustments to product, ensure that pet's body is clear of any moving parts.
- Do not hang bags from handles as this may cause the product to become unstable.
- Do not use on escalator or stairs; fold and carry instead.
- Put on brake whenever you park stroller.
- Ensure stroller is erected and check all locks are engaged before placing pet(s) in product.
- Do not overload as product may become unstable.
- Do not use attachment strap to lift the product.

ACCESSORIES & REPLACEMENT PARTS

Use only HPZ replacement parts and approved accessories available on www.PetRoverUSA.com or telephone at 1-888-265-0589 (9am to 9pm pacific, 7days).



RETURN & EXCHANGE FORM

Please call or email us for immediate help!
(888) 265-0589 / customerservice@petroverusa.com

In the event you're still not satisfied with your purchase. Please fill out this form and include it with the return item.

Order #: _____

Name: _____

E-mail: _____

Tel #: _____

You want to? ☐ Refund ☐ Exchange

Briefly explain your reason for return below:

WARNING

FOR PETS ONLY! DO NOT LEAVE PET UNATTENDED!

This product is not intended to be used as a restraining device for aggressive or dangerous animals that dig, chew or paw aggressively. HPZ is not liable for any damage caused by aggressive, destructive, immature or untrained animals. Do not use near an open or exposed flame. Failure to follow these warnings and instructions in this manual could result in serious injury or death.



Max Load **50 Lbs**
carga maxima
Charge maxi **23 kg**

Life Time Limited Warranty & 3-Years Wheels Replacement Coverage

Please go to www.petroverusa.com to register and activate the Life time Limited Warranty and 3-Years Free Wheels Replacement Coverage.

For Product Support, Issues & Return/Exchange Info

For any issue with your stroller or how to return/exchange this stroller, Please contact our Customer Service for immediate assistance.



Scan QR code for more product info & videos



HPZ Inc.
www.PetRoverUSA.com
2222 Foothill Blvd. #E509, La Canada, CA 91011, USA

Customer Care Contact
Toll Free (888) 265-0589
Email: customerservice@petroverusa.com

HPZ, Pet Rover and associated trademarks are owned by ©HPZ, Inc. 2018. All right reserved.