

# ASSEMBLY INSTRUCTION

## SKU# 97514

### Before beginning

- Unpack all parts and hardware to ensure you have all needed components for assembly.
- Read this guide cover before beginning assembly .
- Assemble this item on a soft surface such as carpet to protect finish.
- Proper assembly of this item requires 2 person & 20 minutes to assemble.

### CARE INSTRUCTIONS

Wipe with a soft and dry cloth. To protect finish, avoid the use of chemicals and household cleaners. Any liquid in the table should be cleaned up immediately with a damp cloth.

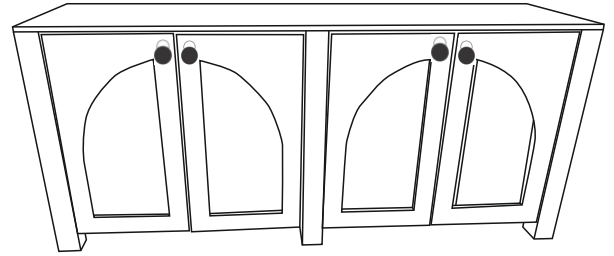

### Hardware & Tools required:

(A) Knob X4



(C) Screw Driver 1x

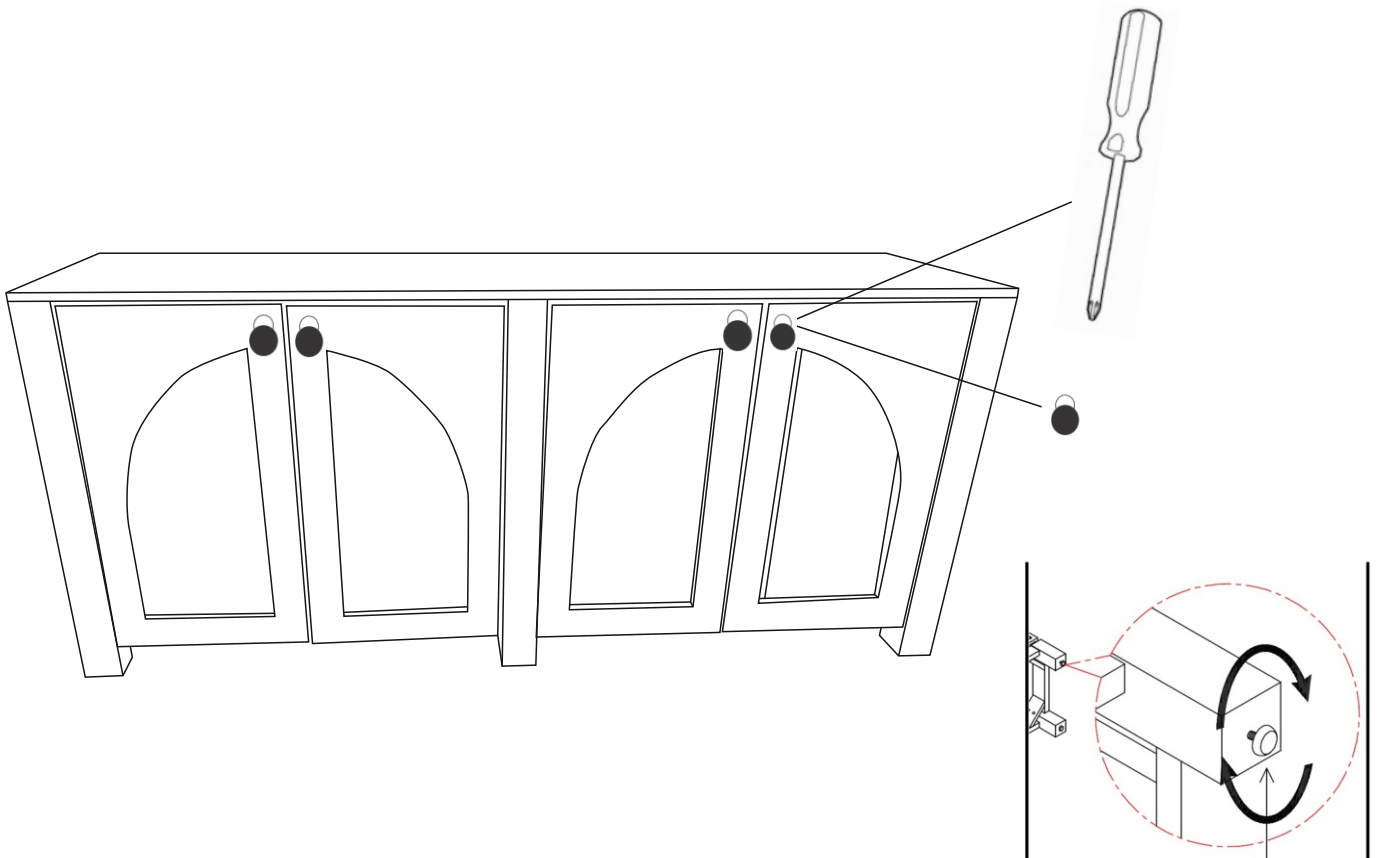

ADJUSTABLE LEVELERS