

SHOE BENCH

INSTRUCTION MANUAL



PART 01

Product parts and quantities



Kind Tips

- ▶ 1. Product includes all required parts and tools. It can be operated by one person.
- ▶ 2. Please carefully distinguish each plate (front or back) and parts before installation.
- ▶ 3. To avoid incorrect installation, do not tighten the screws until fully assembled to facilitate correction.
- ▶ 4. After complete assembly, tighten all screws and check that each unit operates smoothly.

Parts and Tools

Self-tapping screw

A × 20



4X40mm

B × 20



3.5X12mm

C × 6



3.5X14mm

D × 2



Eccentric
rod

E × 2



Eccentric
wheel

F × 2



Spring
shelf pin

G × 2



Skin file

H × 2



Straight arm
hinge

I × 1



Screwdriver

Panel

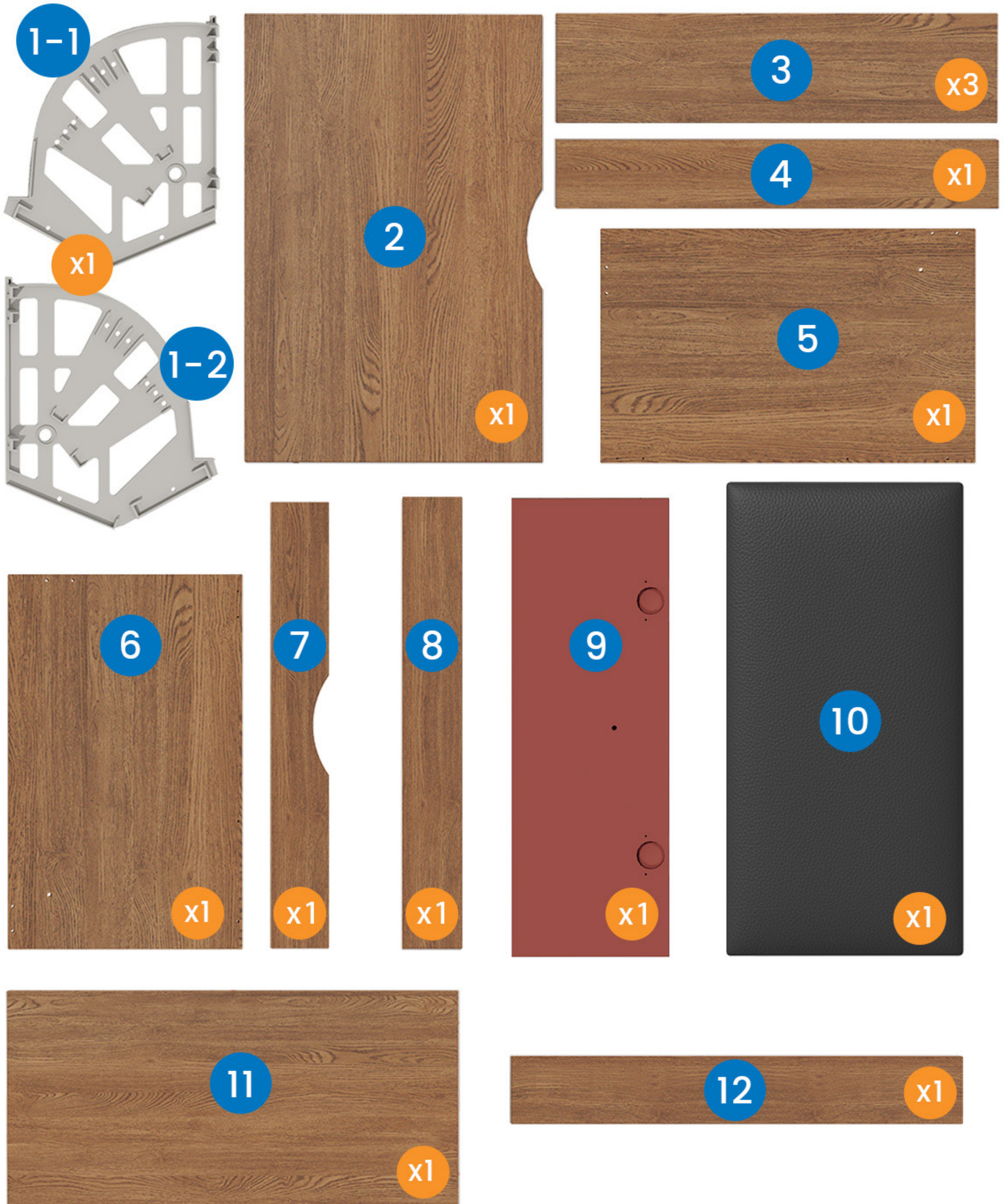

PART 02

Install clamshell drawer



Step 1

Place panels 1-1 and 1-2 on top of panel 2 and align the screw holes. Secure with screws C.

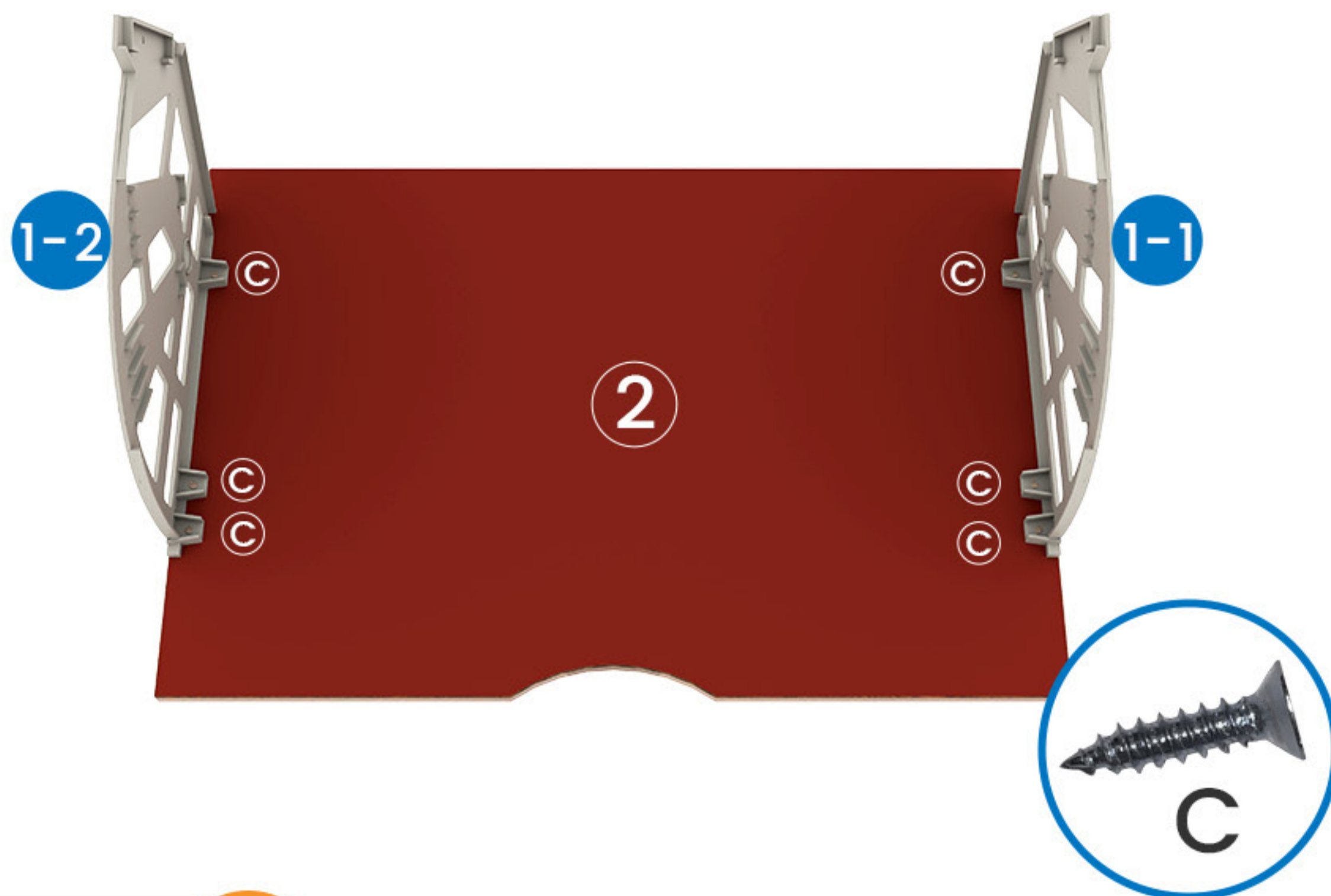

Step 2

Place panel 3 on the bottom of panel 2 and fix it with screws B on both sides.

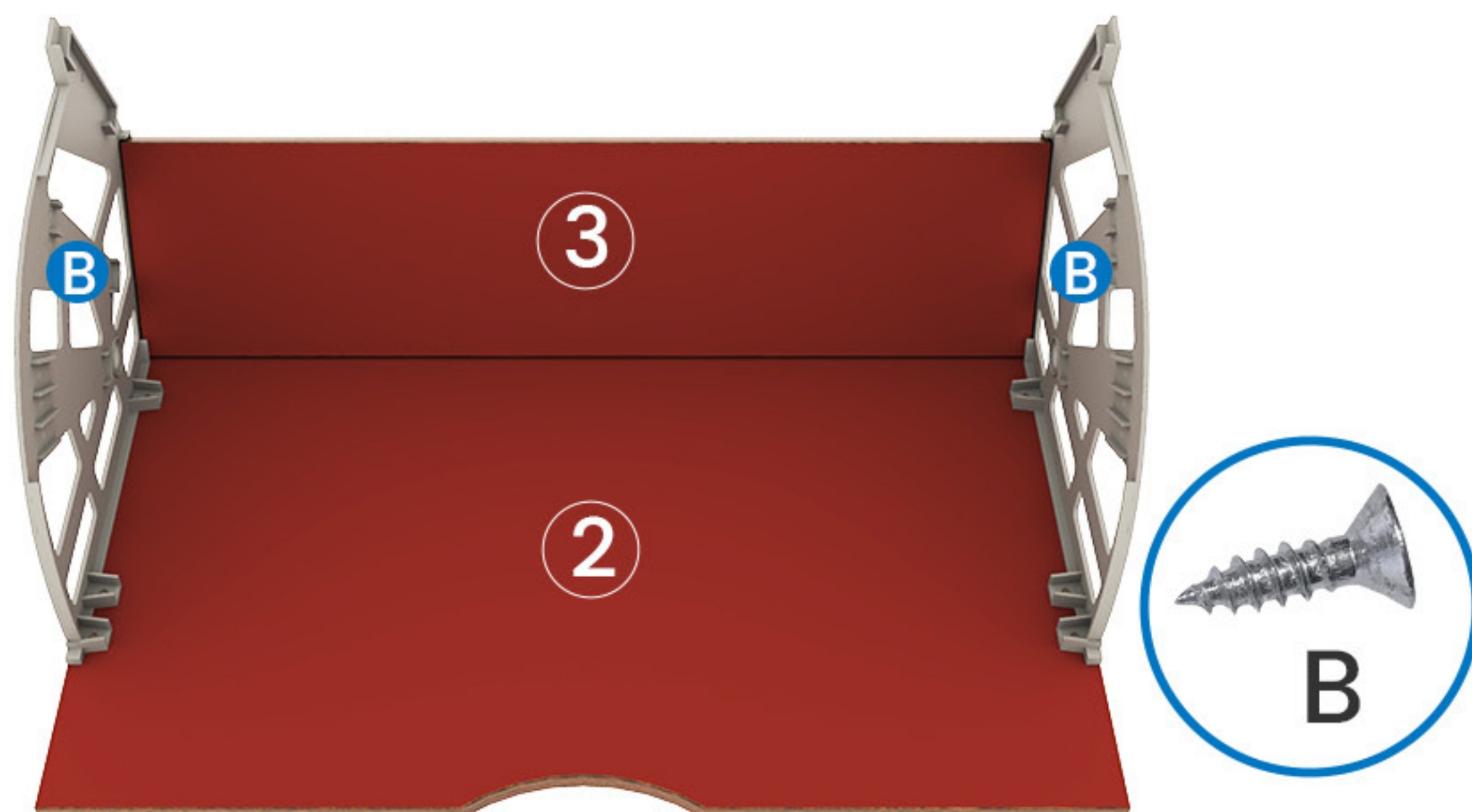

Step 3

Place the two panels 3 into the slots in the upper and middle parts of the plastic plate and secure them with screws B.

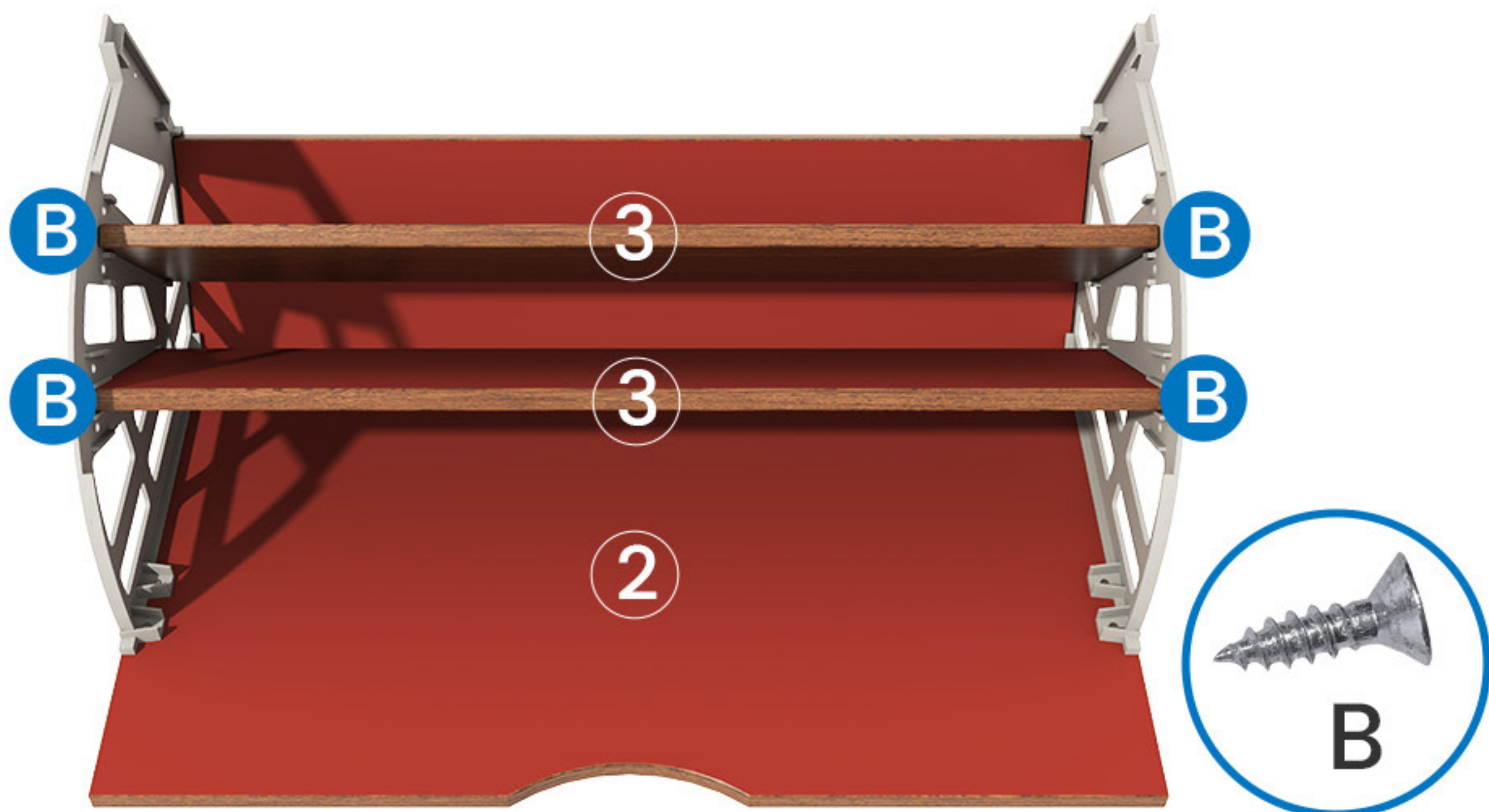

Step 4

Place panel 4 into the slot at the bottom of the plastic plate and secure it with screws B.

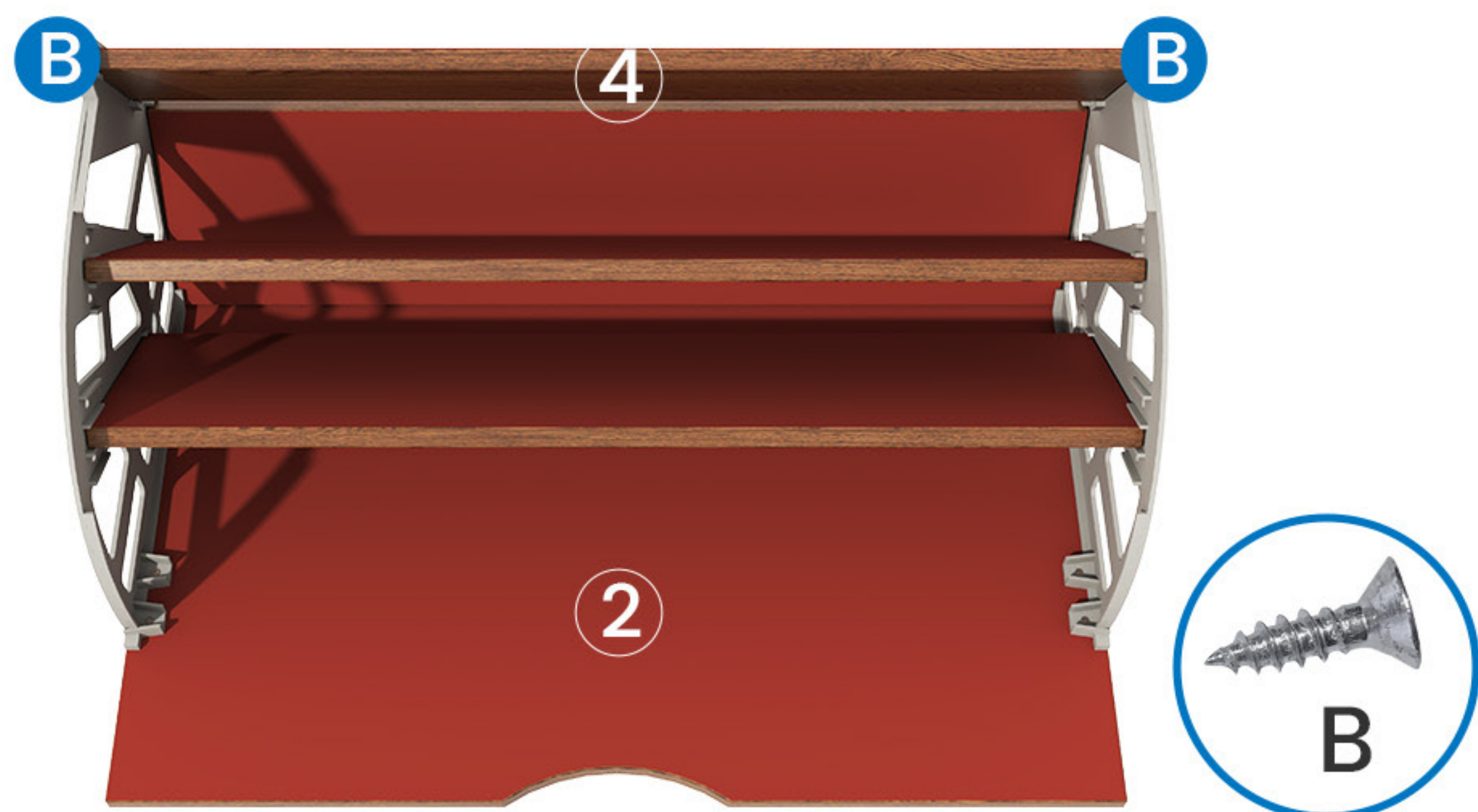

■ PART 03

Install the shoe cabinet outer box



Step 1

Place panels 8 and 12 between the bottom of panels 5 and 6 and secure with screws A.

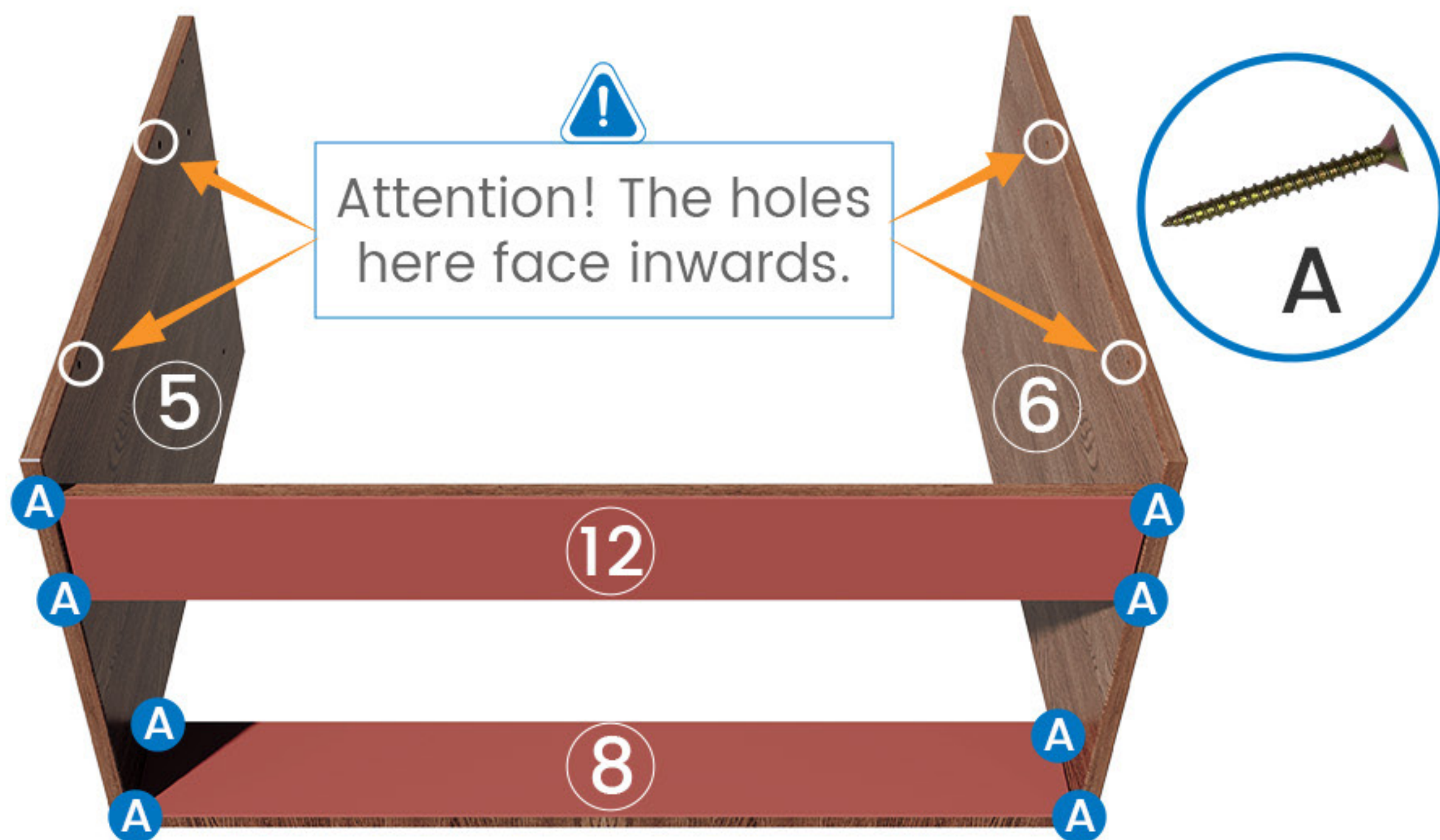

Step 2

Place panel 9 behind the upper part of panels 5 and 6 and secure with screws A.

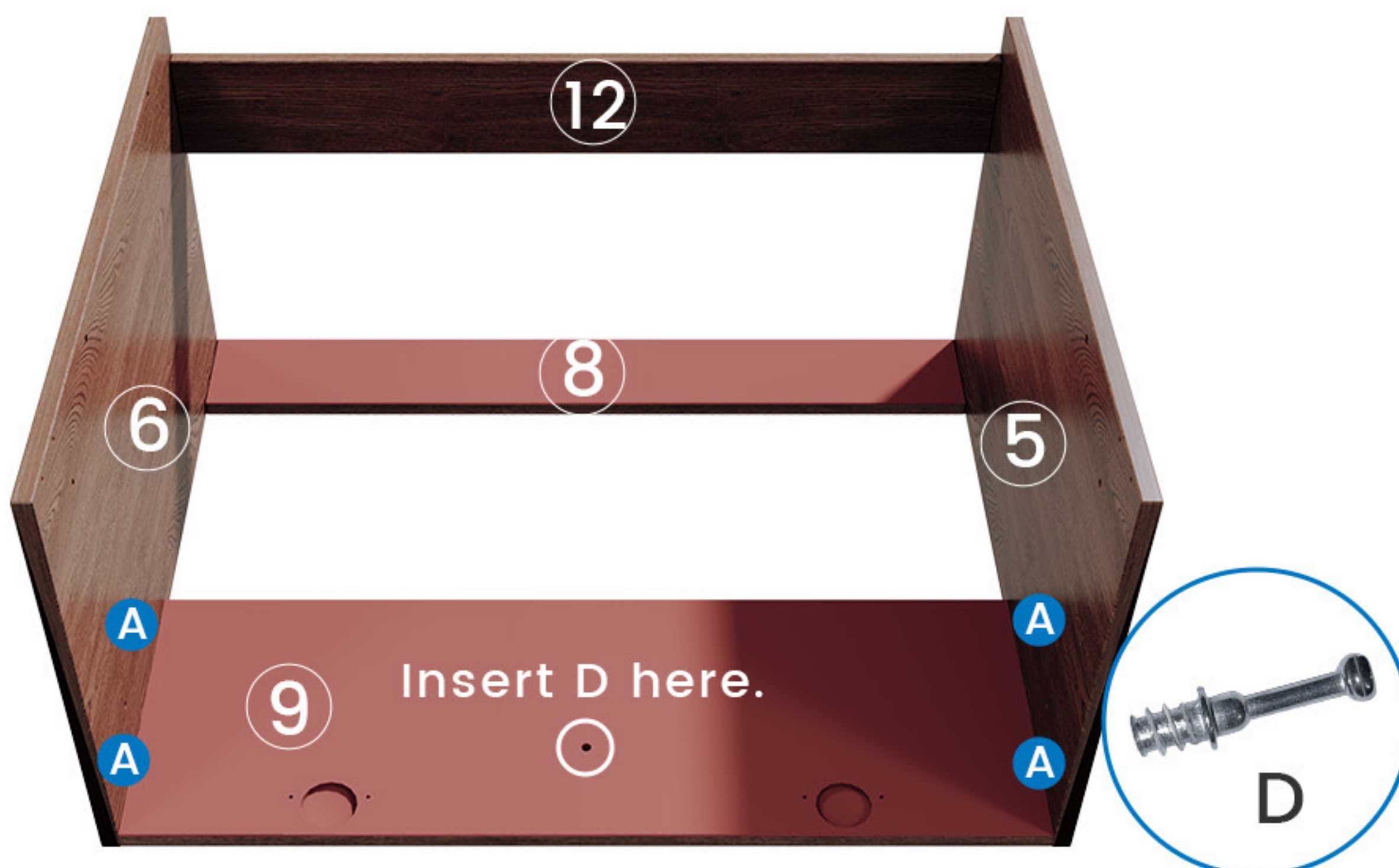

Step 3

Place panel 11 in the middle of the upper part of panels 5 and 6, connect it to D on panel 9, and secure it with screw A.

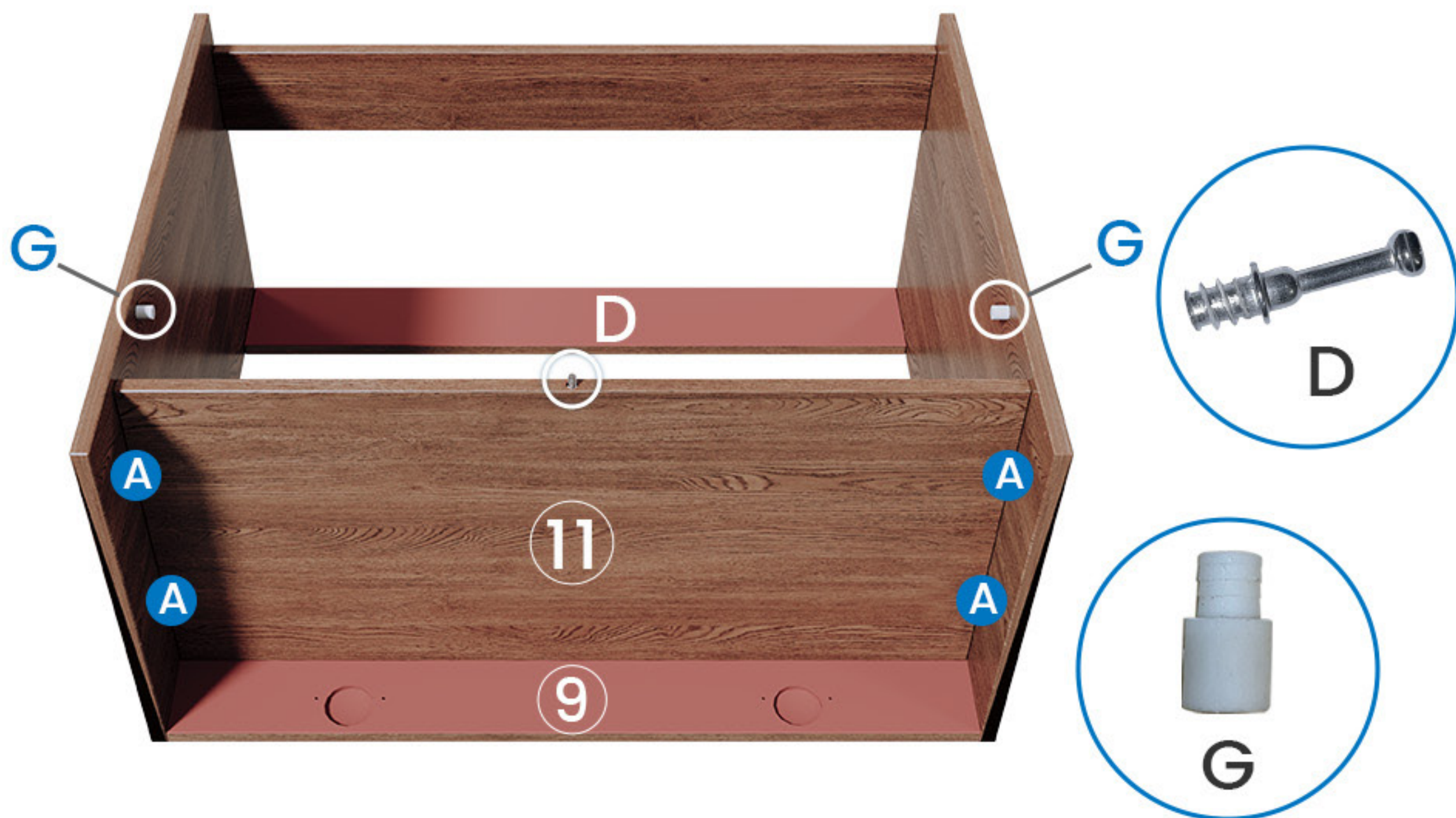

Step 4

Place panel 7 in front of the upper part of panels 5 and 6, connect it to D on panel 11, and secure it with screw A.



Step 5

Use E to adjust the angle and screw it into the groove.

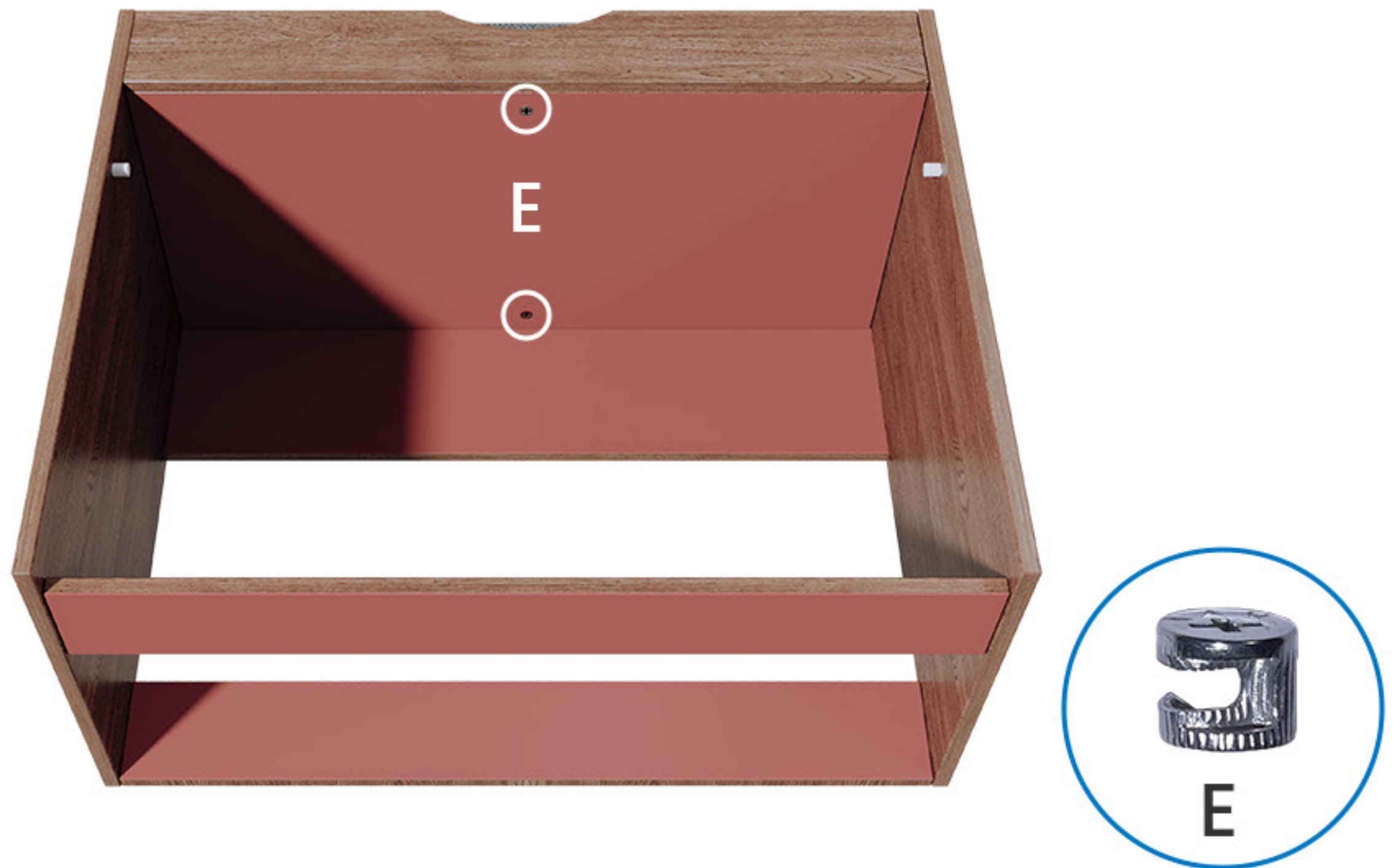

Step 6

Insert F into the holes on both sides of panel 2. Contract the spring of F, align it with the reserved hole in panels 5 and 6, and clamp the flip drawer between the panels 5 and 6.

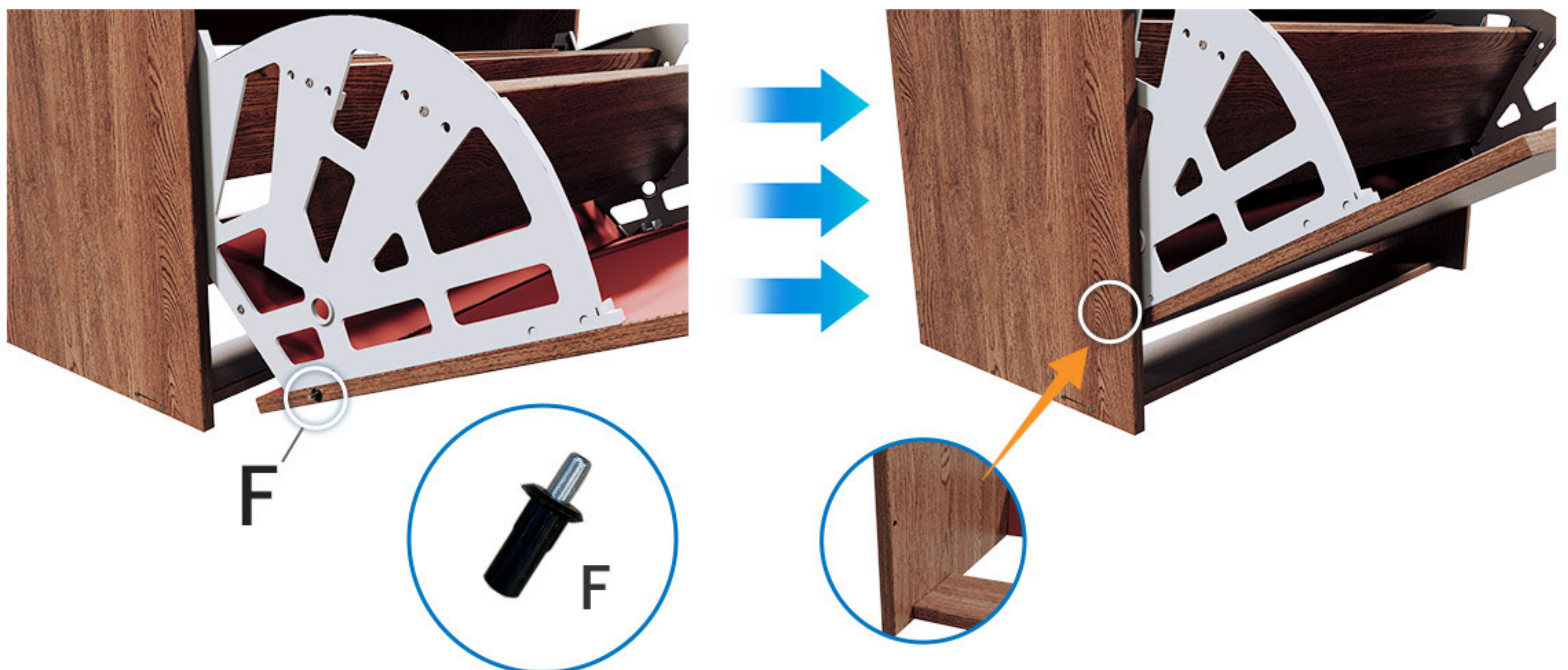

Step 7

Connect the upper side of H to panel 10, insert the lower side of H into the round hole of panel 9, and fix it with screw B.



