

Large order slot Instruction Manual



Product Components

<p>A: Nut M8 5PCS</p>	<p>B: Trim 4PCS</p>	<p>C: Long screw M8 4PCS</p>
		
<p>D:Wrench 1PCS</p>	<p>E: leg 4PCS</p>	<p>F:adjuster foot 4PCS</p>
		
<p>G: Shim 4PCS</p>	<p>H:Large pool 1PCS</p>	<p>I:a grille 1PCS</p>
		
<p>J: Pull type faucet 1PCS</p>	<p>K: Water leakage 1PCS</p>	
		

Installation Steps

Step 1



Firstly, connect the adjustable foot and leg together.

Step 2 :



Secondly, use protective plates, washers, and long screws to connect the legs and grille together with an Allen screwdriver. All four legs are connected together in this way.

Step 3:



Install gaskets and covers for the upper and lower water outlets.

Step 4:

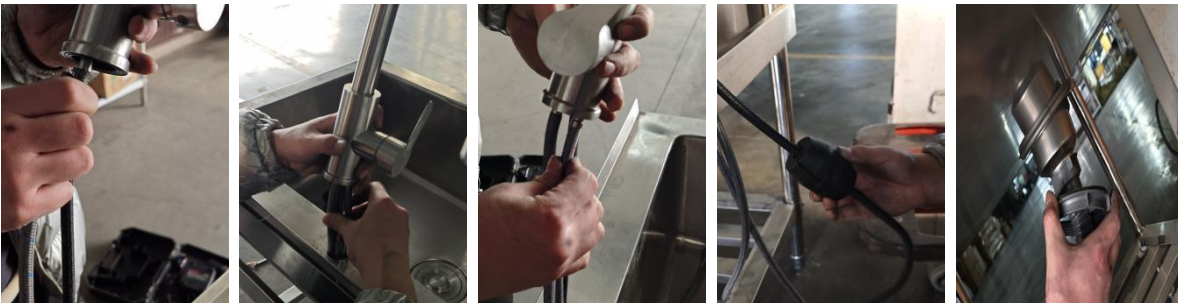

Finally, install the pull-out faucet at the circular hole position of the sink.

Step 5:

So the installation is complete.