

# 28"-48",48"-84" Installation Instructions

Tools needed:

Pencil, tape measure, power drill, 3/16-in. drill bit, No. 2 Phillips head screw driver

Parts included:

2 finials, rods, brackets, screws, and plastic anchors

Assembly Instructions:

1. Position mounting brackets at desired height above window. Mark mounting screw locations with pencil for each bracket.
2. On drywall or concrete, use plastic anchors provided and install by pre-drilling 3/16-in. hole for each plastic anchor.
3. If screws are going directly into wood trim or wall studs, drill a 1/8-in. pilot hole at pencil marks.
4. Mount each bracket with the screws provided.
5. Place drap(e)s on assembled rod and fit the rod on each bracket. Tighten the set screw on each bracket to hold the rod firmly in position.
6. Screw finials onto mounted rod.

Care Instructions:

Clean with soft cloth. Do not use abrasive cleaning agents, solvents, or polishes as they may damage the finish.

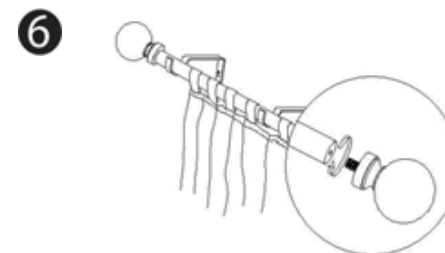
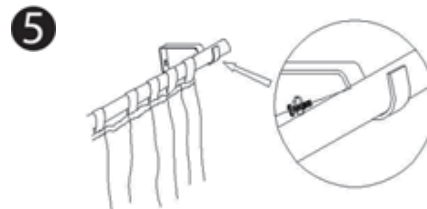
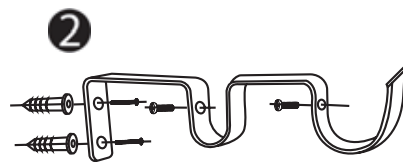

# 84 "-120" Installation Instructions

## Tools needed:

Pencil, tape measure, power drill, 3/16-in. drill bit, No. 2 Phillips head screw driver

## Parts included:

2 finials, 3 rods, 3 brackets, 6 screws, and 6 plastic anchors

## Assembly Instructions:

1. Position mounting brackets at desired height above window. Locate mounting brackets, one bracket at each end, and the other in the middle of the rod. Mark mounting screw locations with pencil for each bracket.
2. On drywall or concrete, use plastic anchors provided and install by pre-drilling 3/16-in. hole for each plastic anchor.
3. If screws are going directly into wood trim or wall studs, drill a 1/8-in. pilot hole at pencil marks.
4. Mount each bracket with the screws provided.
5. Insert rod A and rod C into rod B, with threaded ends exposed.
6. Place drape(s) on assembled rod and fit the rod through the ring on each bracket. Tighten the set screw on each bracket to hold the rod firmly in position.
7. Screw finials onto mounted rod.

## Care Instructions:

Clean with soft cloth. Do not use abrasive cleaning agents, solvents, or polishes as they may damage the finish.

