

# ASSEMBLY INSTRUCTIONS DINING CHAIR

**Thank you for purchasing this quality product. Be sure to check all packing material carefully for small parts that may have come loose inside the carton during shipment**

Parts Key				Hardware kit			
No		Qty	Description	No	Description	Qty	
1		1Pc	Chair Back	A	Hex nut M8	4 Pcs	
2		1Pc	Complete Seat	B	Lock washer Ø8.5x13mm	11 Pcs	
3		1Pc	Right Facing Front Leg	C	Flat washer Ø8.5x19mm	11 Pcs	
4		1Pc	Left Facing Front Leg	D	Long bolt Ø6 x 80mm	4 Pcs	
5		1Pc	Right facing side stretcher	E	Short bolt Ø6 x 40mm	3 Pcs	
6		1Pc	Left facing side stretcher	F	Allen key	1 Pc	
7		1Pc	Front Stretcher	G	Key wrench	1 Pc	
8		4Pcs	Floor Glide	I	Screw M4x40	6 Pcs	

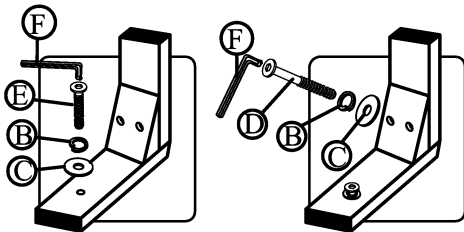

### STEP 1

- Carefully lay Chair Back flat on a smooth flat surface to prevent scratches.
- Attach Complete Seat (2) to Chair Back (1) by inserting a Flat Washer, Lock Washer and Short Bolt (E) into each of the hole on the back of the seat. Tighten screws with provided Allen Key by turning clockwise until secure. (See Detail A).
- Insert a Flat Washer, Lock Washer and Long Bolt (D) into each of 2 holes in the Complete Seat corners. Tighten screws with provided Key Wrench. (See Detail B).

#### DETAIL A

#### DETAIL B

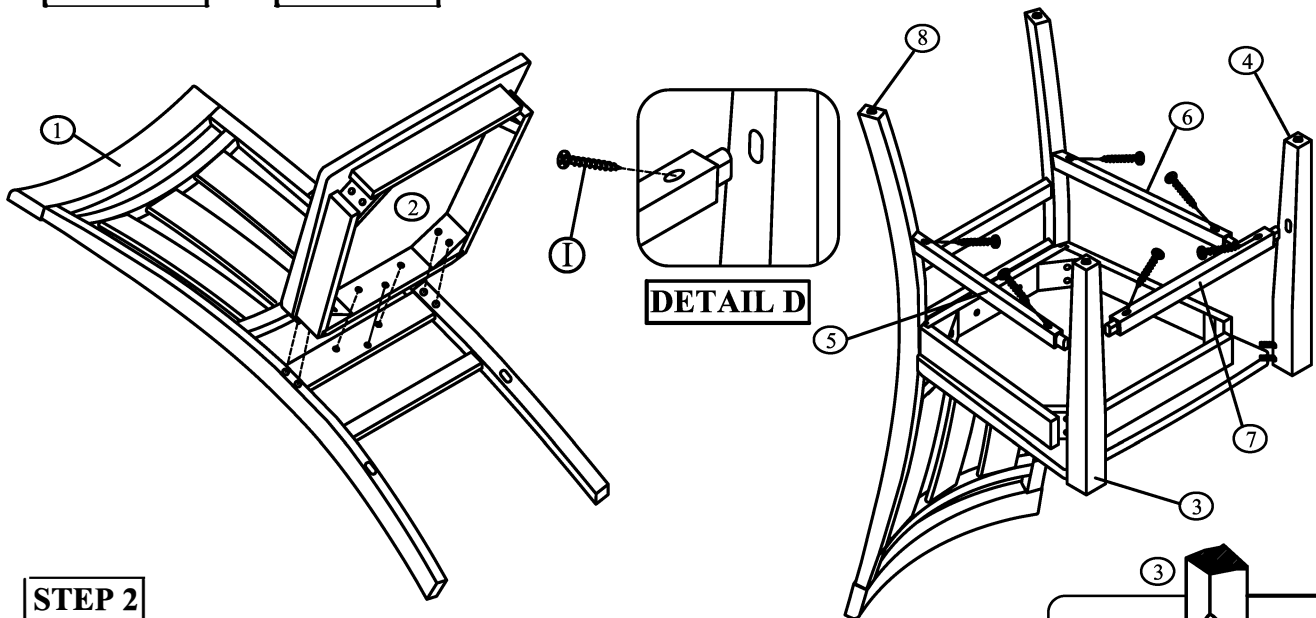

### STEP 2

- Carefully turn chair upside down and attach each Front Leg to the front corners of the Complete Seat (Keeping in mind of the right side and left side leg) with a Flat Washer (C), Lock Washer (B) and Nut (A). (See detail C). Keep nut loose at this point. Insert right side stretcher and left side stretcher between the Front and Back Legs, then insert the Front Stretcher between the two Front Legs. (Make sure that the side stretchers are not at an angle as the front legs are on the wrong side). Fasten stretchers to legs with Screws (I) using a Screwdriver (not provide).
- Be sure to level the chair prior to tightening front leg nuts with wrench provided (G).

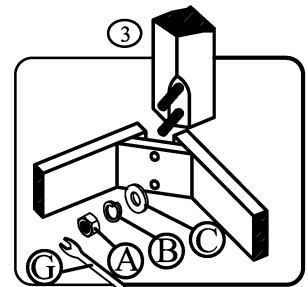

#### DETAIL C