

Assembly Instruction

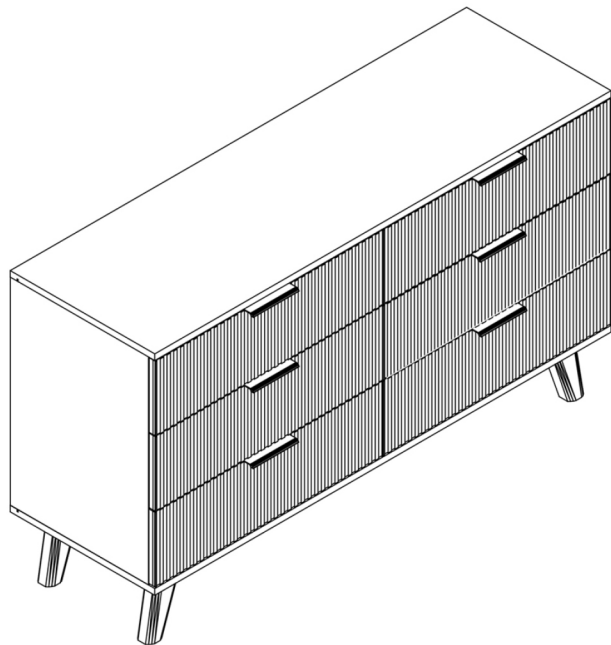

Drawers Dresser





Before You Start



- ✓ Read through each step carefully and follow the proper order
- ✓ Separate and count all your parts and hardware, If Parts are missing defective or having wrong parts in package, or Board Surface is broken, scratched or lack of some screw holes. You can contact us and we will get back to you within 24 hours. Or, you can reach us via after-sales email.
- ✓ Give yourself enough room for the assembly process
- ✓ Caution: If using a power drill or power screwdriver for screwing, please pay attention to slow down and stop when screw is tight. Failure to do so may result in stripping the screw. (Assembly speed can be increased by using electric screwdriver)

Helpful Hints

PEOPLE NEEDED FOR ASSEMBLY: 2

- Open your item in the area you plan to keep it to avoid excessive heavy lifting. 
- Identify, sort and count the parts before attempting assembly.
- Do not make the screws too loose or too tight. 
- The accessory bag contains some small accessories, which should be kept away from children. 
- The remaining parts are spare parts.
- Do NOT use harsh chemicals or abrasive cleaners on this item. And Never push, pull, or drag your furniture. 
- Young children can be seriously injured by tipping furniture. You must install the tipping restraint hardware with the unit(X#Accessories) to prevent the unit from tipping, causing any accidents or damage. the tipping restraints are intended only as a deterrent, they are not a substitute for proper adult supervision. 

Notice: Don't open all drawers at the same time.

Board Identification

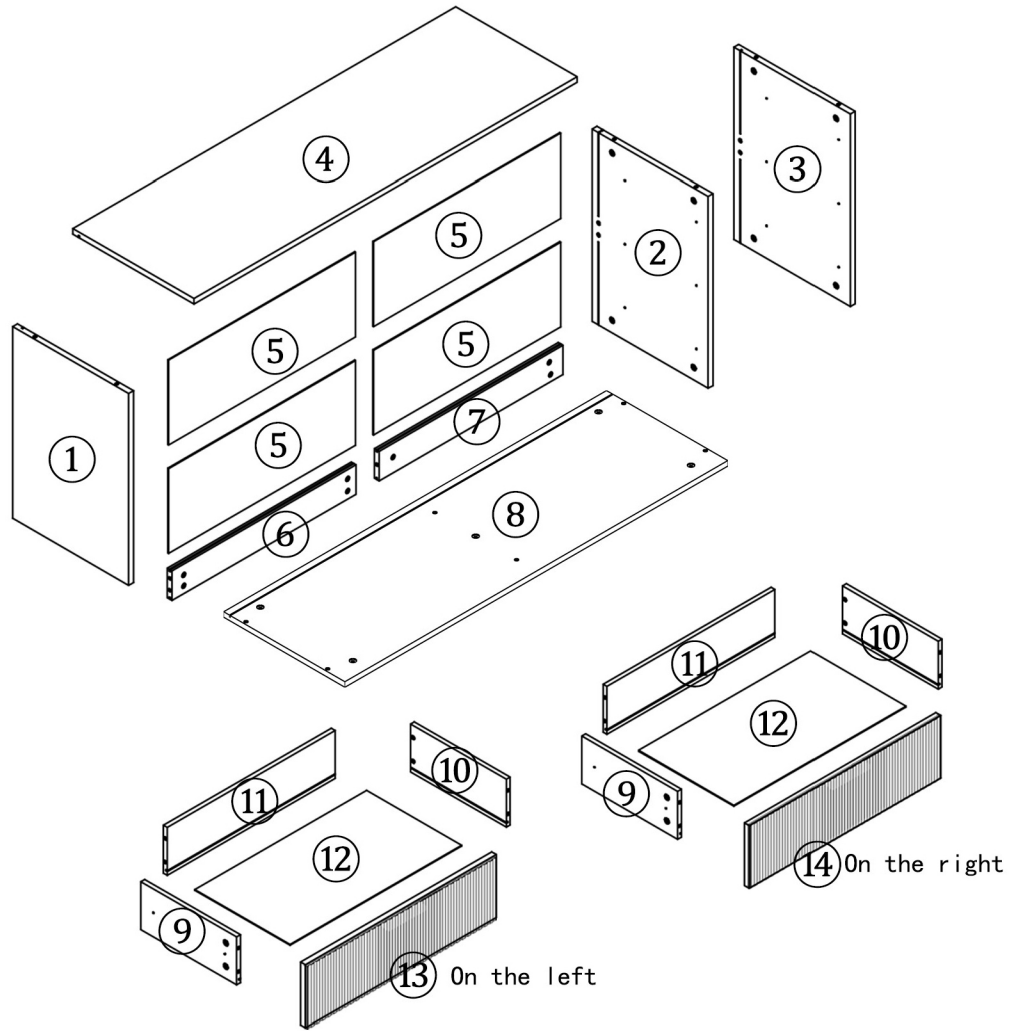

Please note that the left and right drawers are NOT the same, putting the wrong location will lead to a more significant gap between the drawers.

A 67pcs	B 67pcs	C 3.5*14 64pcs	C8 3.5*12 12pcs	F 6pcs	X 2pcs	Y 16pcs
Z4 8*30 5pcs	K 12pcs	AE 4pcs	AE2 1pcs	AM Decorative paper 28pcs	AG 1pcs	



Hardware installation demonstration

- Please make sure "A" hardware tightened and can't be pulled out

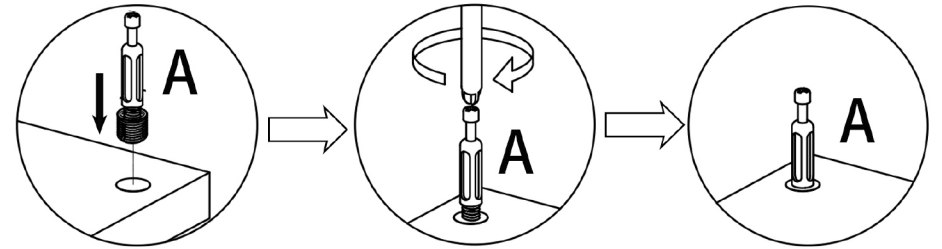

- When inserting cam ensure arrowhead on cam points toward to the hole on the panel edge

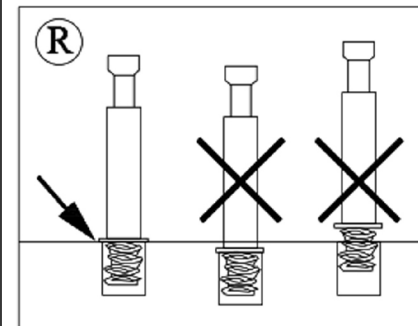
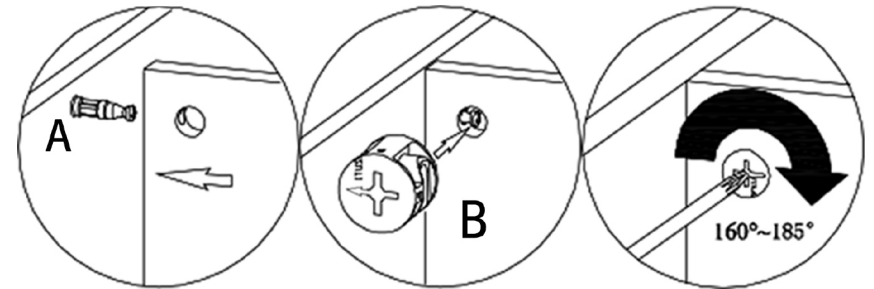



Hardware installation demonstration

- Before installing the drawer rail, you need to separate the K1 and K2 first.

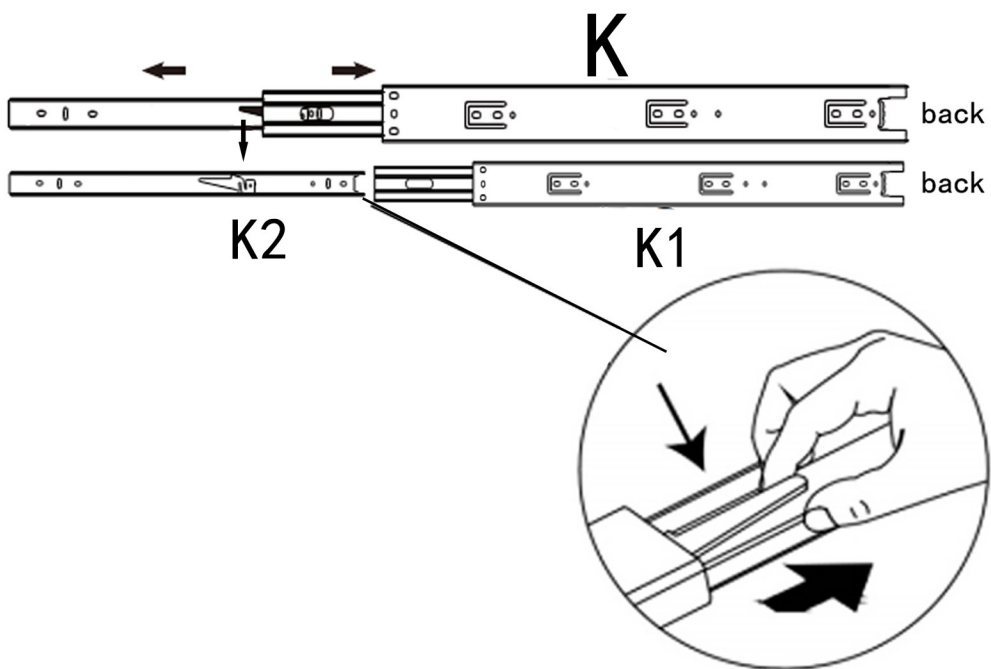

Warm Reminder: Press it and split



Hardware installation demonstration

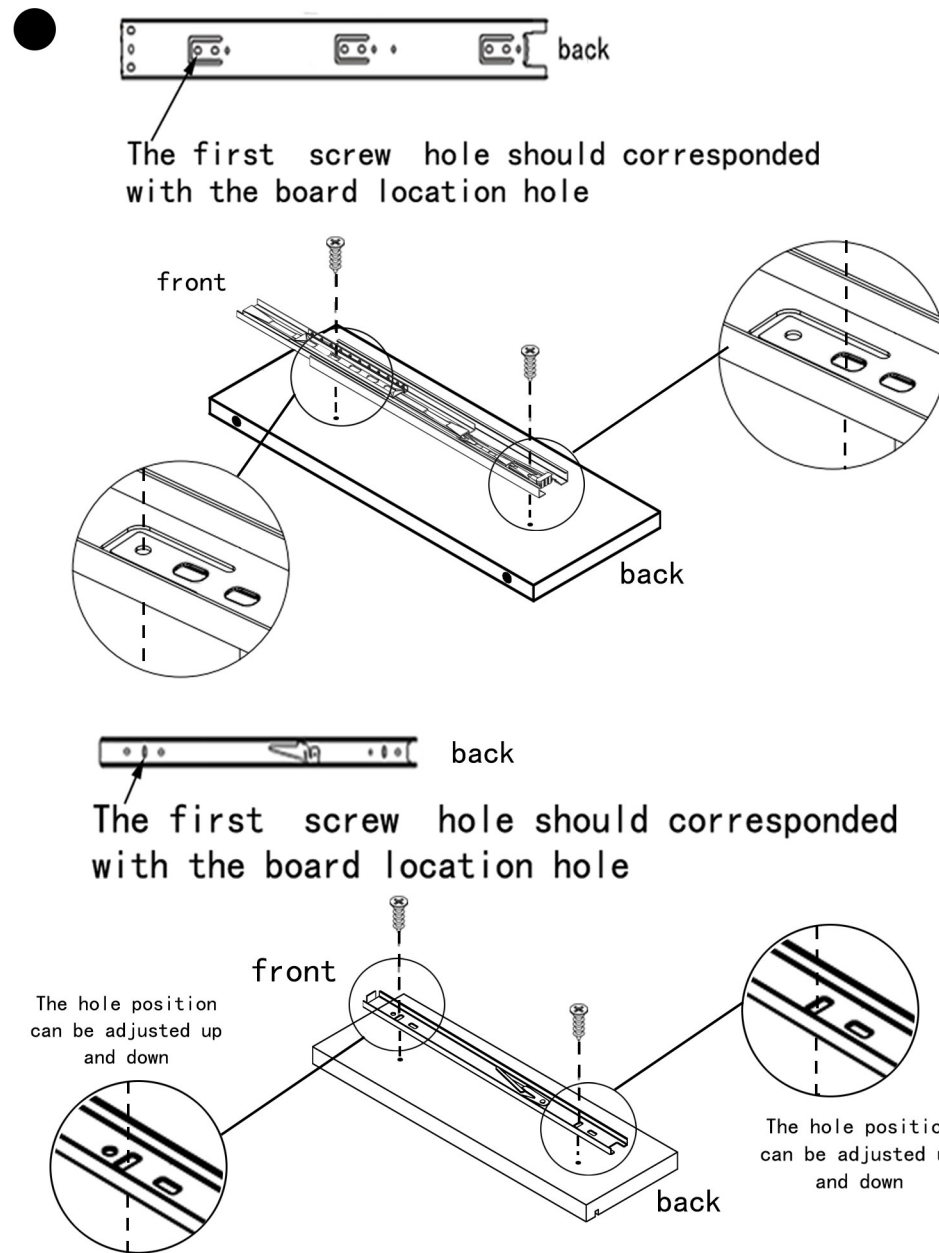

STEP 1

The first screw hole should corresponded with the board location hole

front back

front back

front back

	A*2
	C*6
	K1*3

STEP 2

The first screw hole should corresponded with the board location hole

front back

front back

front back

	A*2
	C*6
	K1*3

STEP 3

The first screw hole should corresponded with the board location hole

front back

front back

front back

	A*1
	C*6
	K1*3

Notice: that the positioning holes of the slide rails on board #2 are different

STEP 4

The first screw hole should corresponded with the board location hole

front back

front back

front back

	A*2
	C*6
	K1*3

Notice: that the positioning holes of the slide rails on board #2 are different

STEP 5

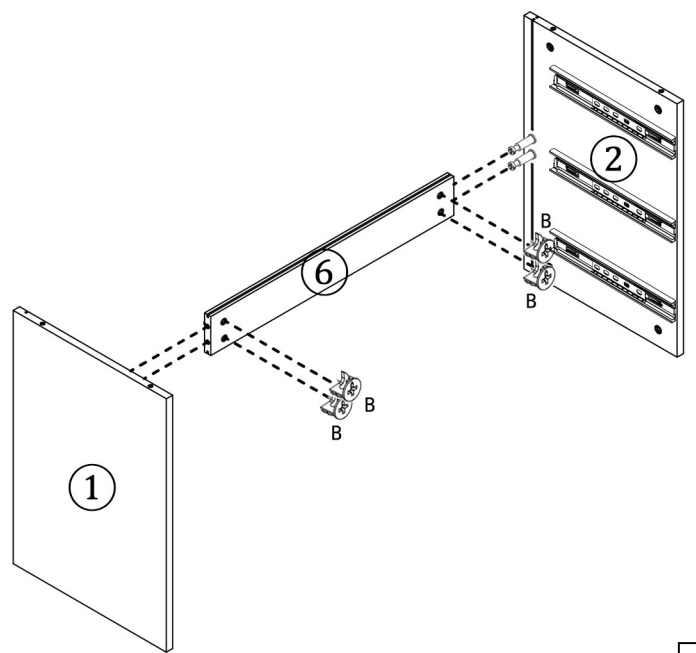

The side with the hole faces inwards

 **B*4**

STEP 6

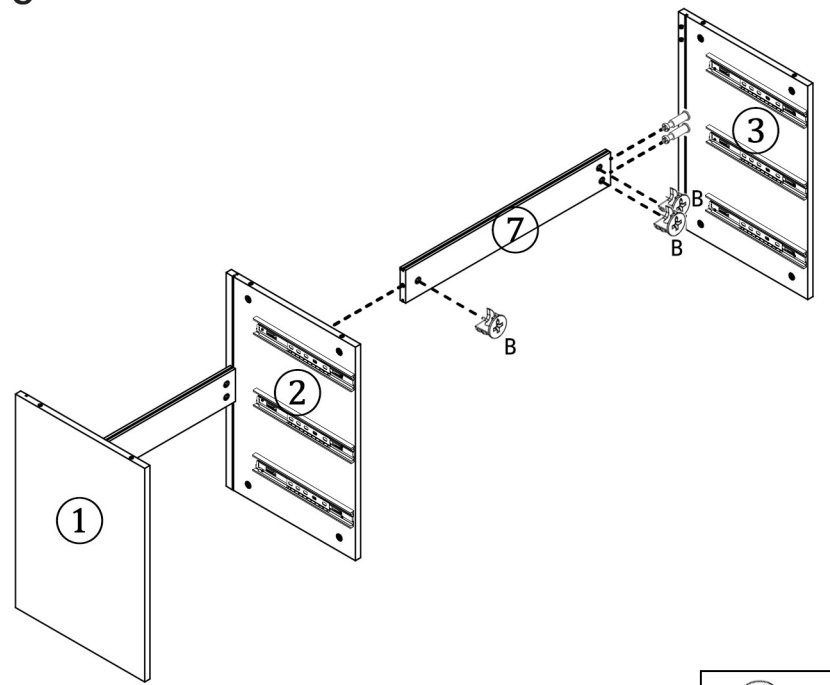

The side with the hole faces inwards

 **B*3**

STEP 7

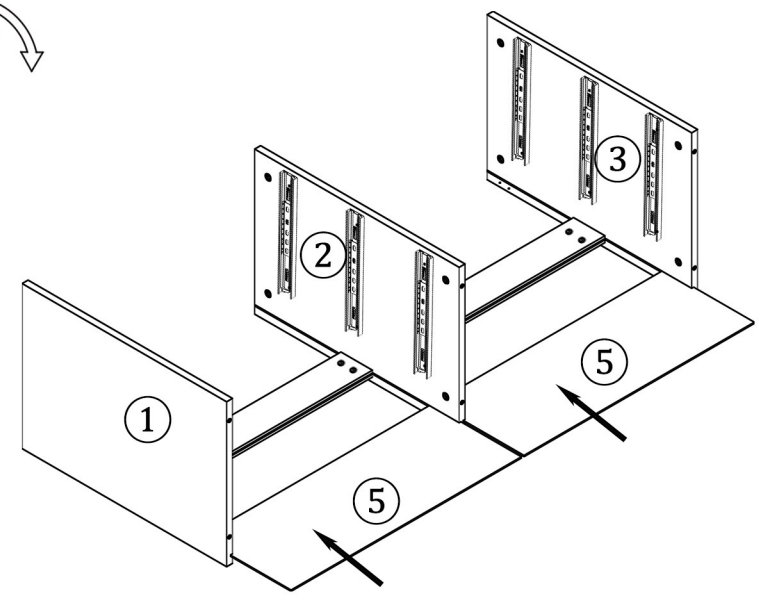
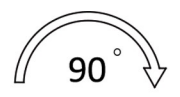

Insert into the groove below first

STEP 8

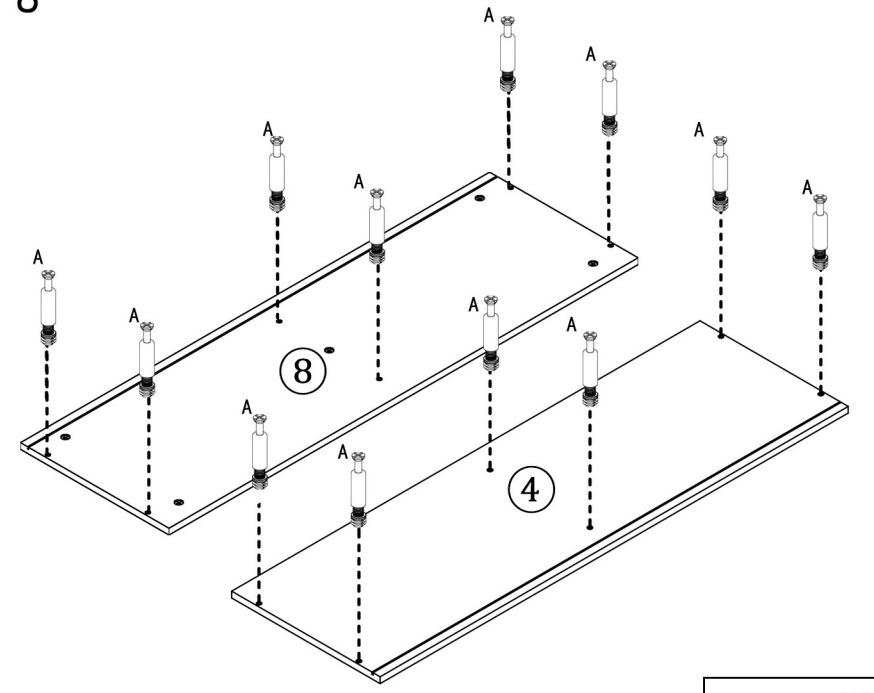

 **A*12**

STEP 9

The support legs are tilted toward the four corners of No. 8 board

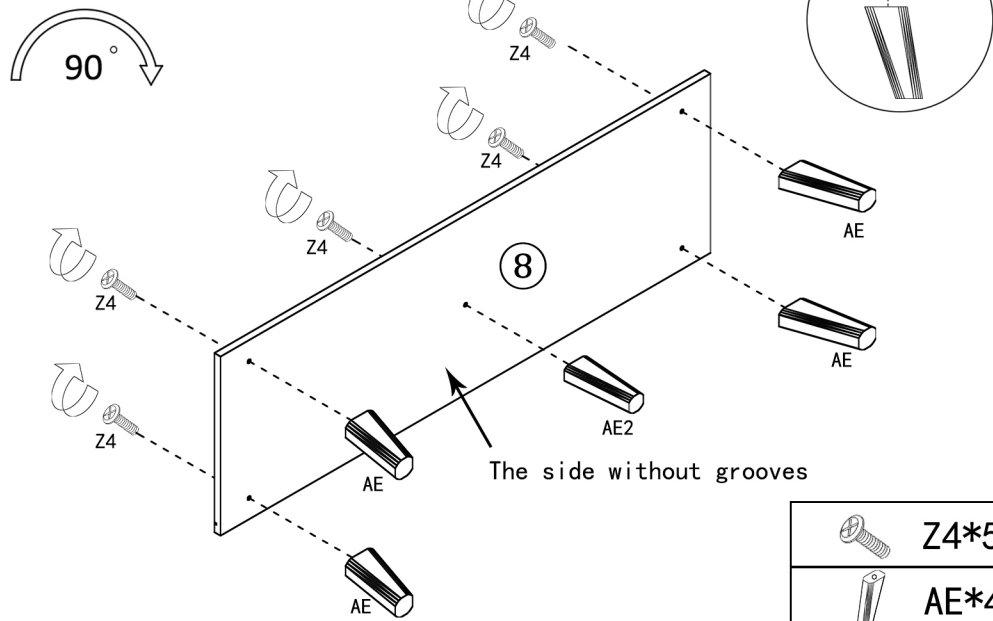

The side without grooves

	Z4*5
	AE*4
	AE2*1

Straight legs installed in the middle

STEP 10

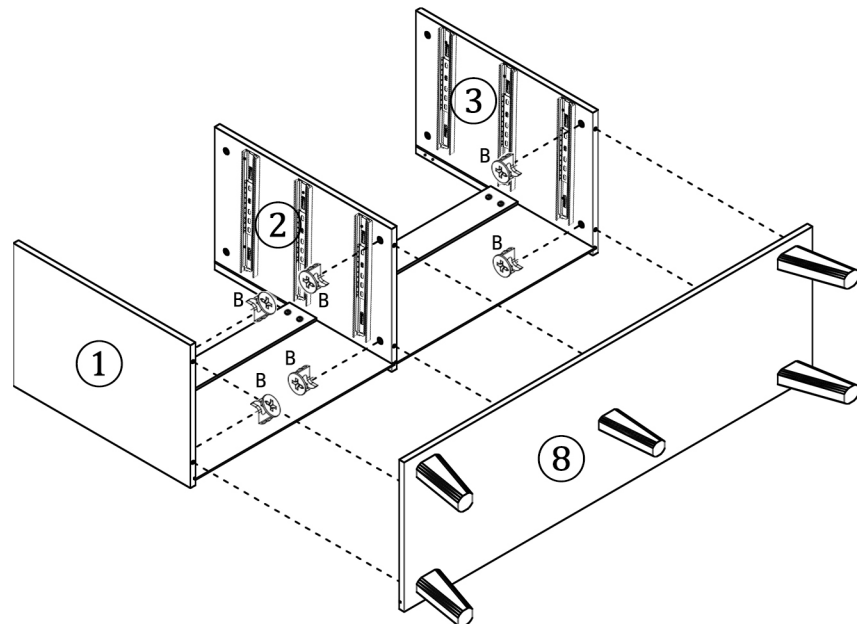

Make sure the No. 5 thin plate is fully inserted into the groove before tightening the screws.

	B*6
--	-----

STEP 11

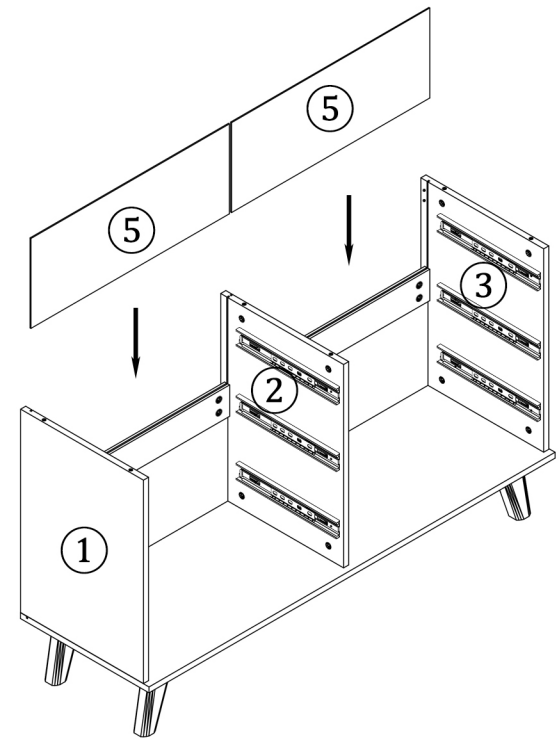

STEP 12

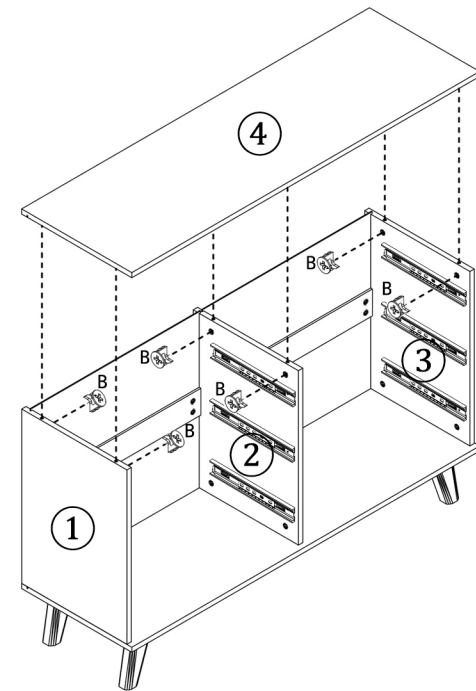

Make sure the No. 5 thin plate is fully inserted into the groove before tightening the screws.

	B*6
--	-----

STEP 13

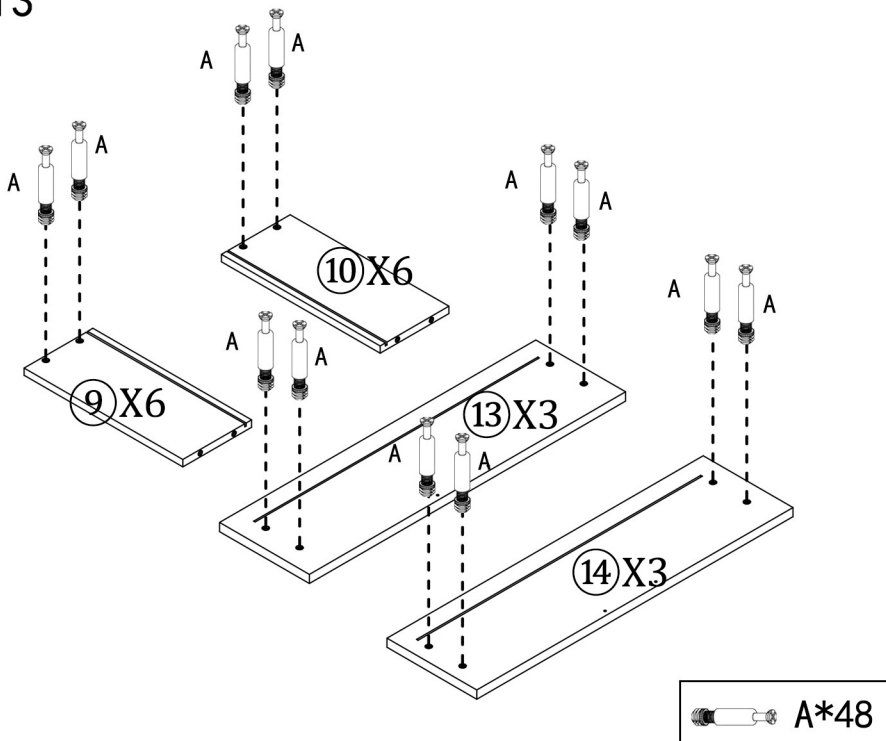

STEP 14

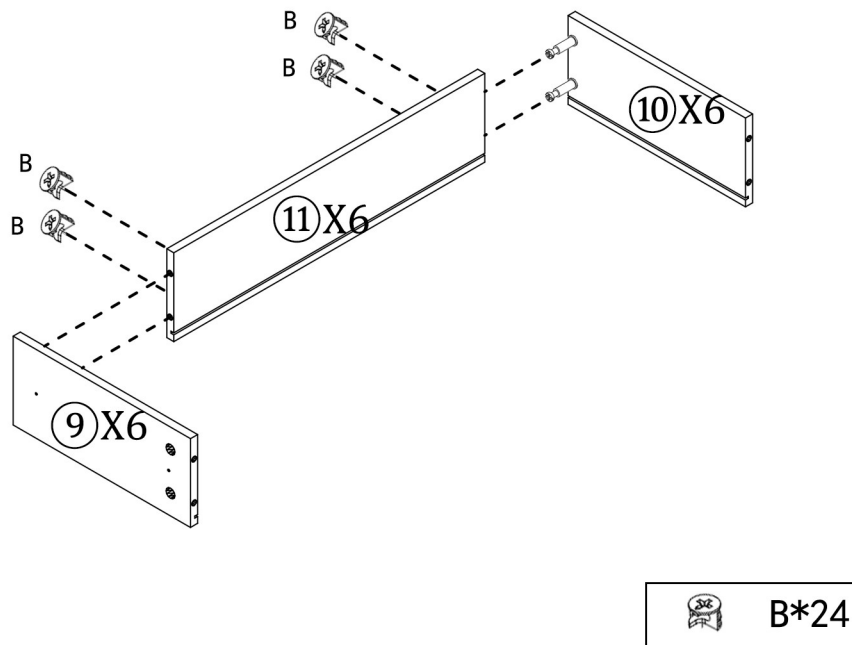

STEP 15

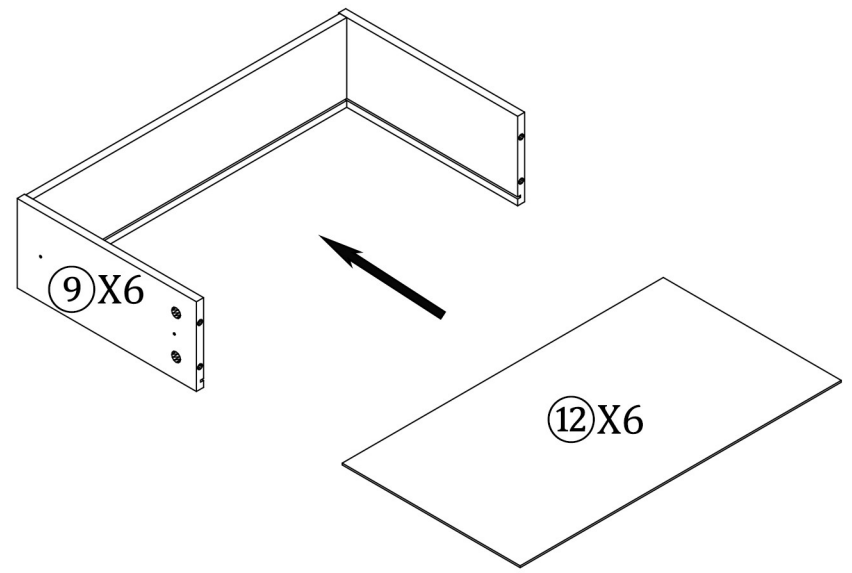

STEP 16

Left-side drawer

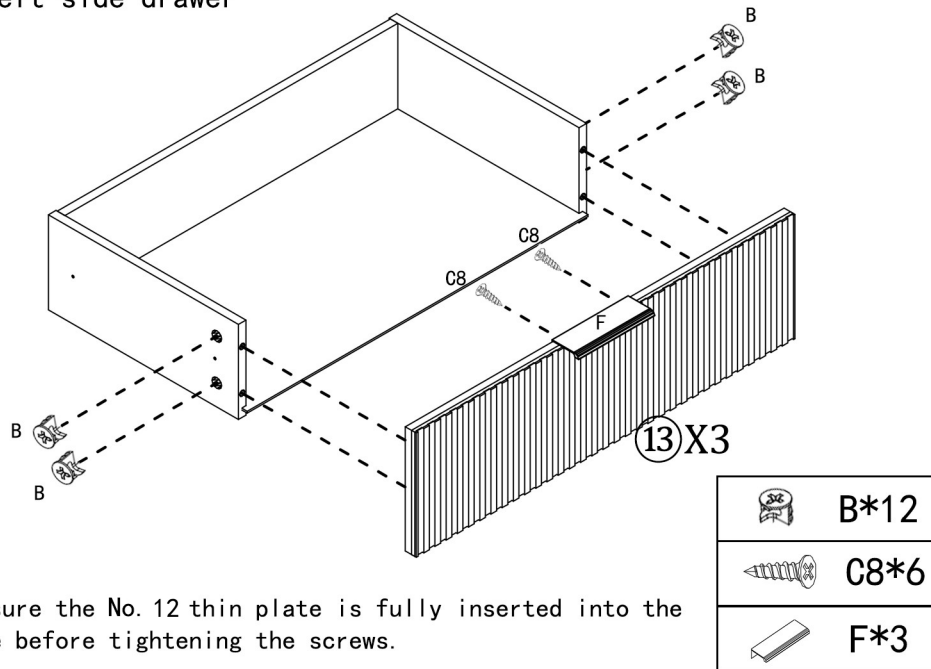

Make sure the No. 12 thin plate is fully inserted into the groove before tightening the screws.

STEP 17

right-side drawer

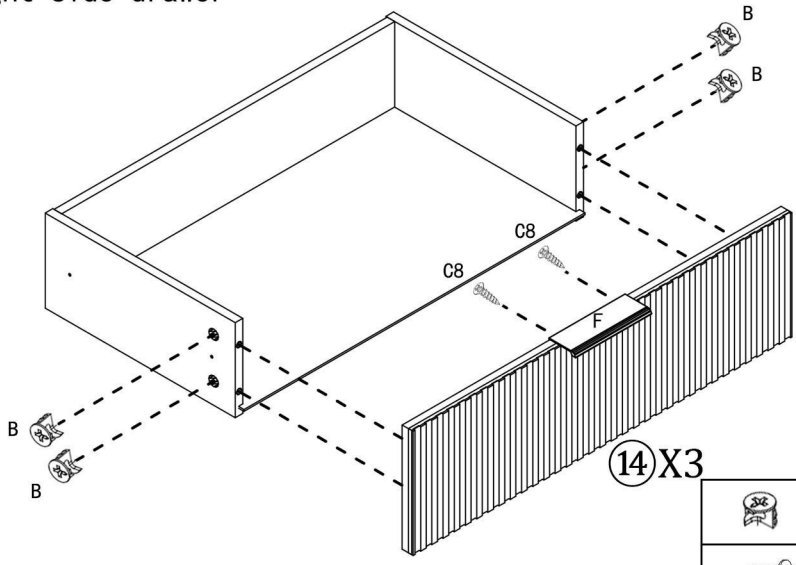

Make sure the No. 12 thin plate is fully inserted into the groove before tightening the screws.

- B*12
- C8*6
- F*3

STEP 19

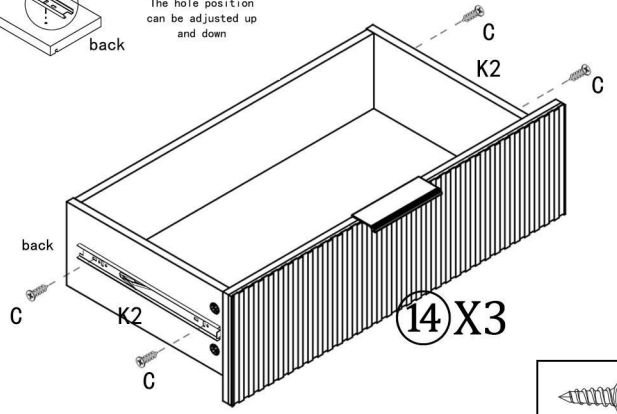
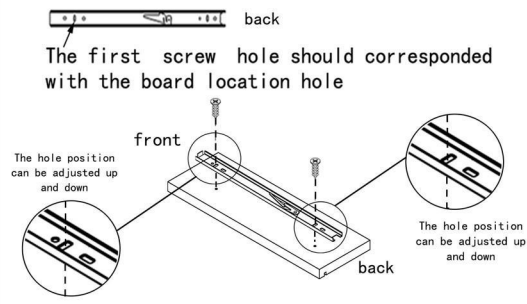

- C*12
- K2*6

STEP 18

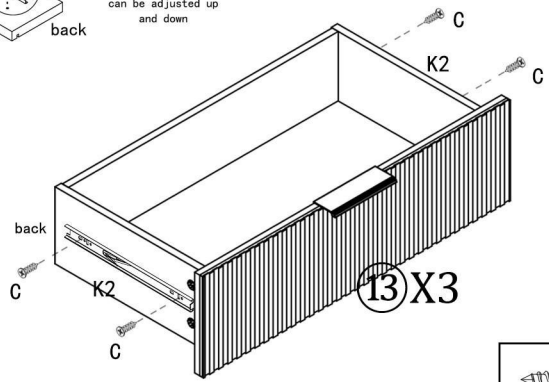
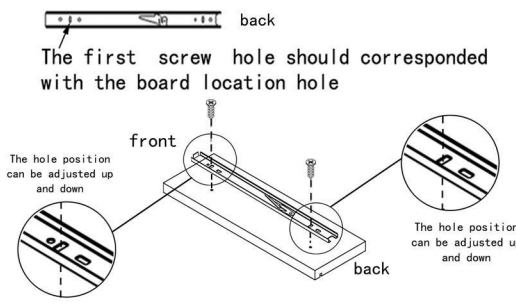

- C*12
- K2*6

STEP 20

No. 13 drawer goes on the left side, and the No. 14 drawer goes on the right side. Just be careful not to mix them up.

Note: When assembling the inner slide rail, it is necessary to place the inner slide rail on the steel ball component first, and push the inner rail parallel to the outer rail together. Direct violence will lead to the falling off or deformation of the rail steel ball.

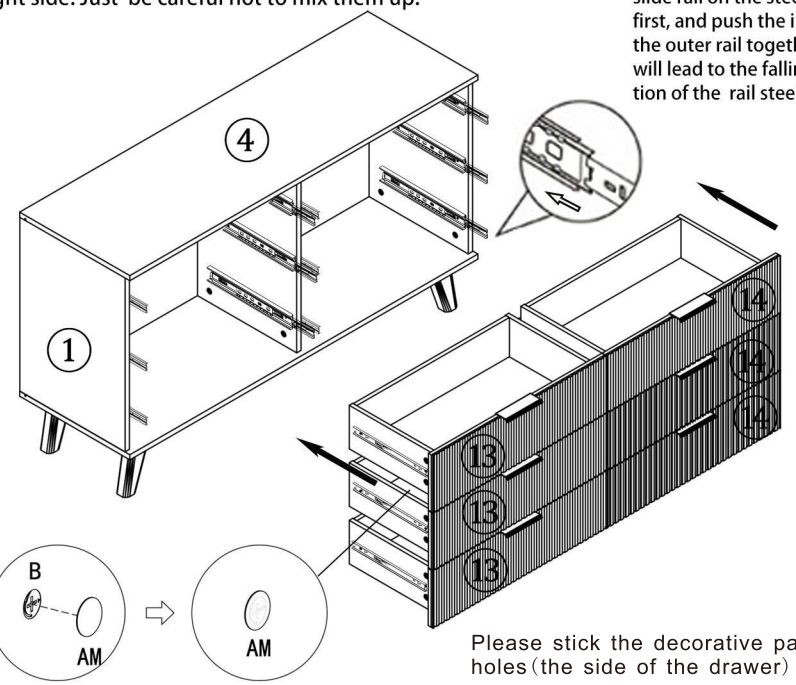

Please stick the decorative paper on the holes (the side of the drawer)

STEP 21

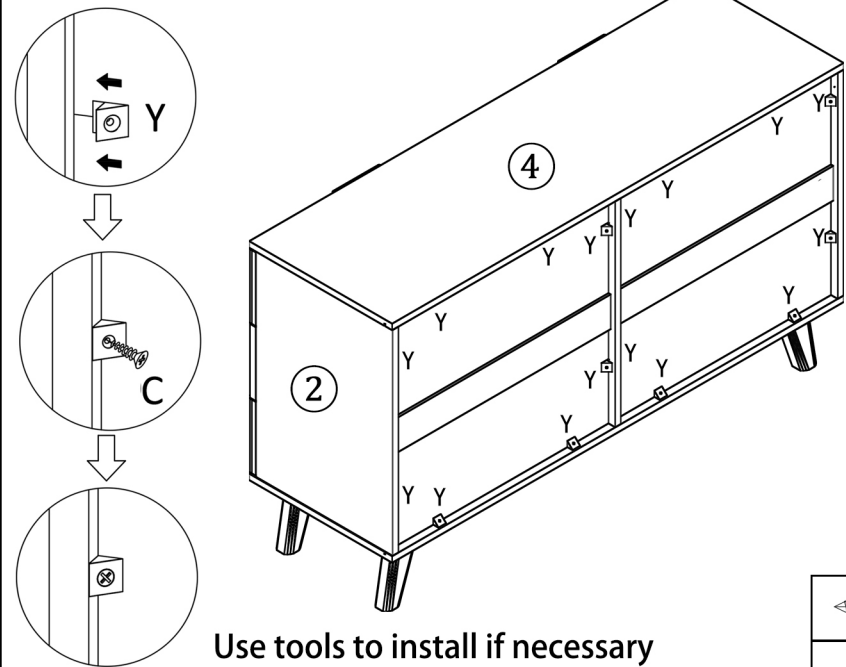

Use tools to install if necessary

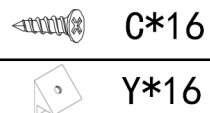

STEP 22

Please separate the parts in bag No.X according to the picture and mark them as X1, X2, X3, and X4.

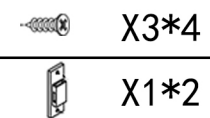
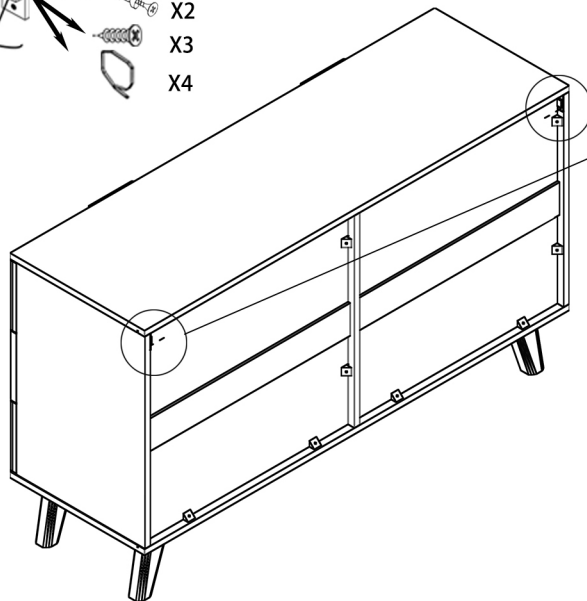
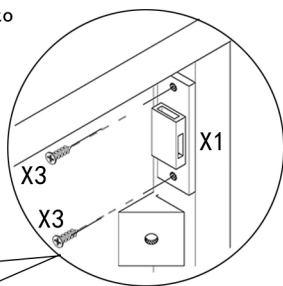
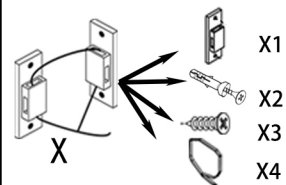

STEP 23

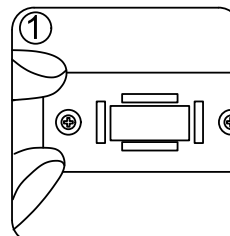
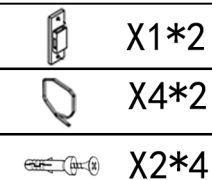
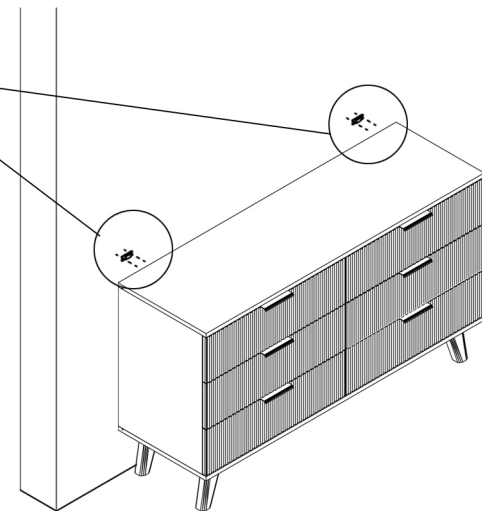
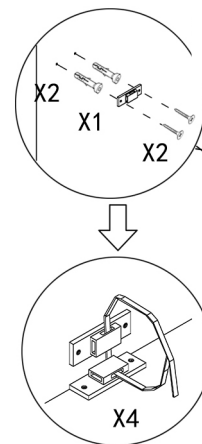

1. make mark on the wall

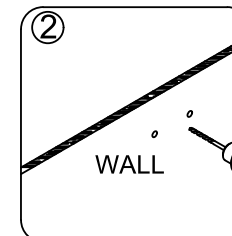

2. drill two Ø6 holes on the wall

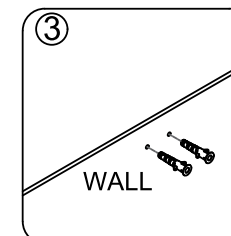

3. put two anchors in the holes

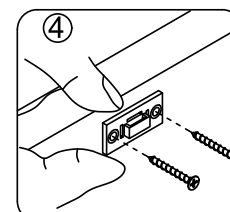

4. fix the device(X1) on the wall by the long screws(X2)

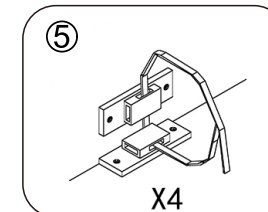

5. Push the Dresser close to the wall so that the two bases are close to each other, and then put on nylon tie (X4) to tighten it.

STEP 24

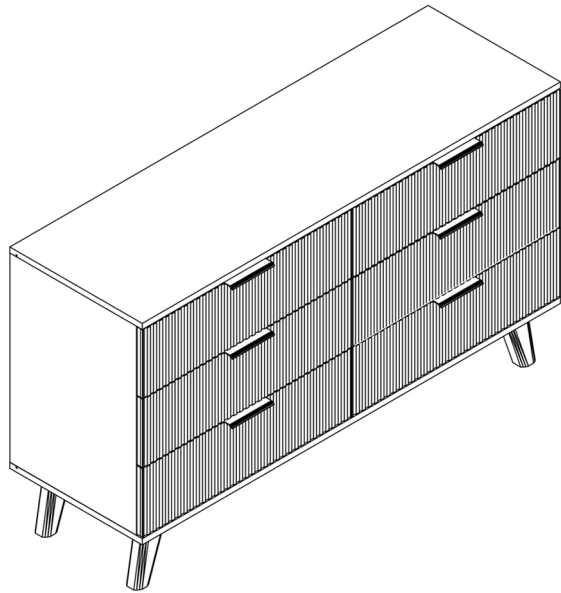

Wow, great job on assembling that drawers dresser!
It looks fantastic. You really nailed it!

⚠ WARNING



Children have died from furniture tipover. To reduce the risk of furniture tipover:

- ALWAYS install Anti-tip device provided.
- NEVER put a TV on this product.
- NEVER allow children to stand, climb or hang on drawers, doors, or shelves.
- NEVER open more than one drawer at a time.
- Place heaviest items in the lowest drawers.

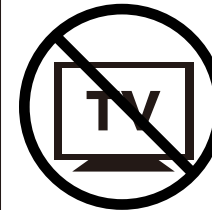

*This is a permanent label.
Do not remove!*