

ASSEMBLY GUIDE

PACKAGE CONTENTS

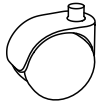

5x Wheels

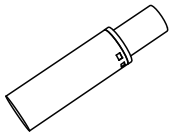

1x Gas Rod

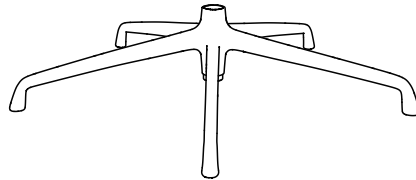

1x Metal Leg

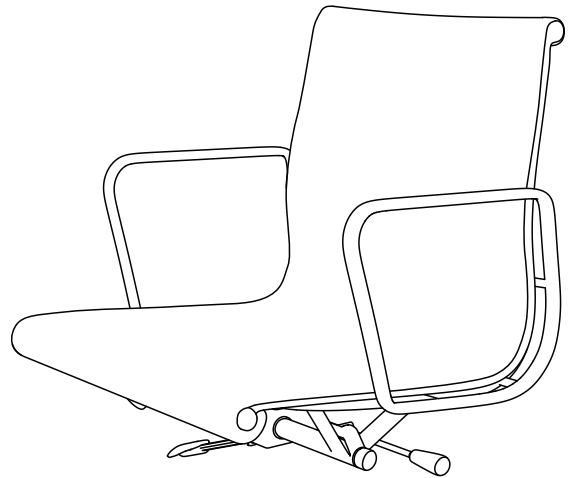

1x Seat

1 Insert the wheels into the base.

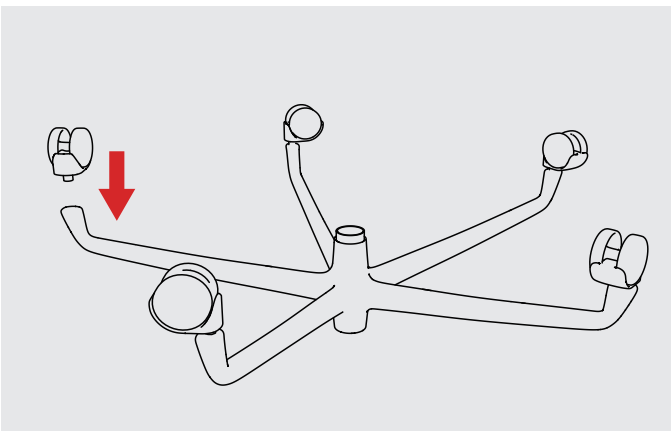

2 Buckle the bottom of the gas rod into the base.

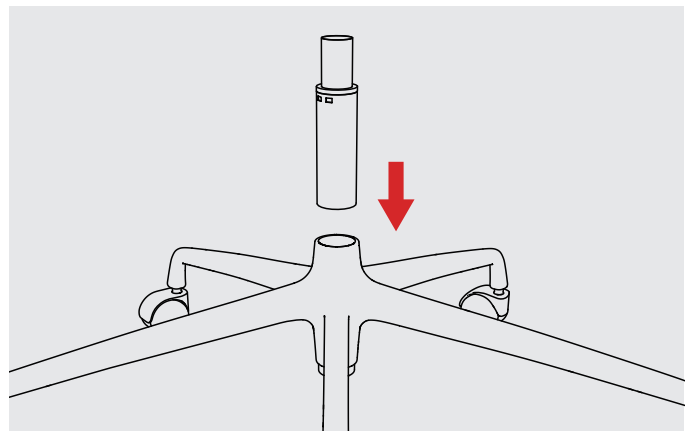

3 Align the installed seat into the air pressure bar.

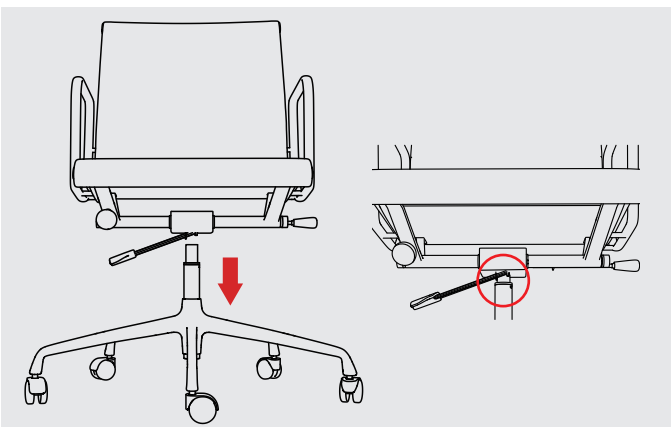

4 A. Seat height adjuster.
B. Seat tifting tension adjustor. Loose/Locking

