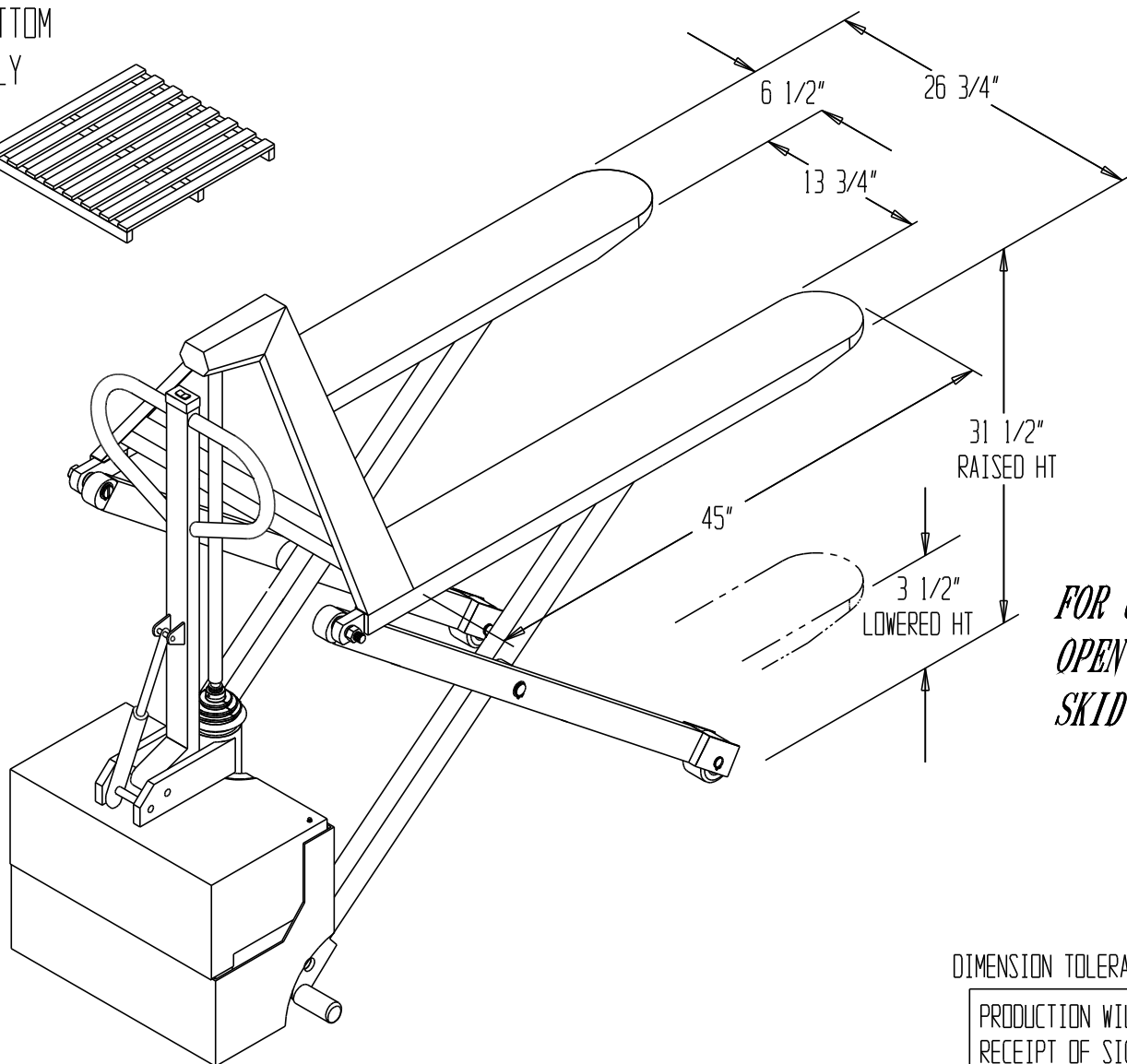
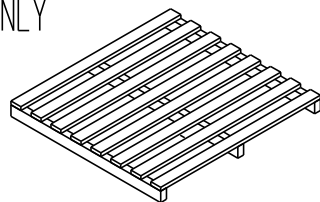

**STAINLESS STEEL DC POWERED TOTE LIFTER L-270-DC-HD-SS**

\*\* Any additions, deletions or omissions must be corrected on this drawing, as this drawing will be considered all inclusive. \*\*

\*\* All graphics provided are for reference only. If certain dimensions are critical please verify those dimensions with your salesperson \*\*

FOR USE WITH  
OPEN BOTTOM  
SKID ONLY**FOR USE WITH  
OPEN BOTTOM  
SKID ONLY**

DIMENSION TOLERANCE +/- 1/2"

PRODUCTION WILL START UPON  
RECEIPT OF SIGNED APPROVAL  
DRAWING**STANDARD FEATURES**

MODEL NUMBER: L-270-DC-HD-SS  
 CAPACITY: 2,000 LBS.  
 LOWERED HT: 3 1/2"  
 RAISED HT: 31 1/2"  
 FORK LENGTH: 45"  
 FORK WIDTH: 6 1/2"  
 OVERALL FORK WIDTH: 26 3/4"  
 INSIDE FORK WIDTH: 13 3/4"  
 12V DC POWERED UNIT

**SPECIAL FEATURES:**

NONE

All graphics provided are for reference only.  
 If certain dimensions are critical please  
 verify those dimensions with your salesperson

FOR INTERNAL USE ONLY  
PROJECT SIGN OFF

SALES	
ENG	
FAB.	
POWER	

A  
P  
P  
R  
O  
V  
A  
L

I, THE UNDERSIGNED, AGREE THAT THE PRODUCT AS REPRESENTED  
 SATISFIES DESIGN & DIMENSION REQUIREMENTS. I ALSO ACKNOWLEDGE  
 MY DUTY TO CONFIRM PRODUCT & INSTALLATION COMPLIANCE WITH ALL  
 APPLICABLE FEDERAL, STATE AND LOCAL REGULATIONS & STANDARDS.

**ANY MODIFIED UNITS ARE NON-RETURNABLE**

[ ] As drawn [ ] As marked

Signed: \_\_\_\_\_ Date: \_\_\_\_\_

Printed Name: \_\_\_\_\_

LEAD TIME WILL START UPON RECEIPT OF SIGNED APPROVAL DRAWING

DISTRIBUTOR'S NAME:

**VESTIL MANUFACTURING**

P.O.#: \_\_\_\_\_

W.O.#: \_\_\_\_\_

DRAWN BY: \_\_\_\_\_

DATE: \_\_\_\_\_

SALES: \_\_\_\_\_

REFERENCE: \_\_\_\_\_

SCALE: \_\_\_\_\_

DRWG./FILE NAME:

QUOTED LEADTIME: \_\_\_\_\_

QUOTE #: \_\_\_\_\_

L-270-DC-HD-SS

\*\*SPECIAL UNITS ARE NON-RETURNABLE

\*AVAILABLE AT ADDITIONAL COSTS