

Safety Instructions

- 1 Do not use outdoor
- 1 Never operate the mirror if it is not working properly, if it has been damaged, or submersed in water. Immediately contact your service provider.
- 1 Do not use extension cord with this mirror.
- 1 Close supervision is necessary when any appliance is used by or near children or people with a physical/mental disability.
- 1 Do not operate this appliance if the appliance malfunctions or has been damaged in any manner. No repairs should be attempted by the consumer.
- 1 Use appliance only for intended use as described in this instruction book.
- 1 Be sure mirror is not in a position where it can reflect sunlight.
- 1 Turn switch to OFF position before storage.
- 1 Do NOT expose the product to fire as this may result in explosions and other hazards.

Storage Instructions

- 1 Please turn the switch to OFF position before storage
- 2 Be sure direct sunlight does not strike mirror when left unattended.
- 3 Place the mirror in cool and dry area.
- 4 For safety, please make sure the mirror is out of reach of children.

How to charge the mirror

- 1 Connect the Type-C charging port with a 5V power supply or computer by the provided charging cable.
- 2 When we start charging, the indicator will turn into red color. When the mirror is fully charged, the indicator will turn into blue color.
- 3 Before charging the mirror, please make sure that the switch is in the OFF position.

DUAL-SIDED WALL MOUNTING LED LIGHTED MIRROR

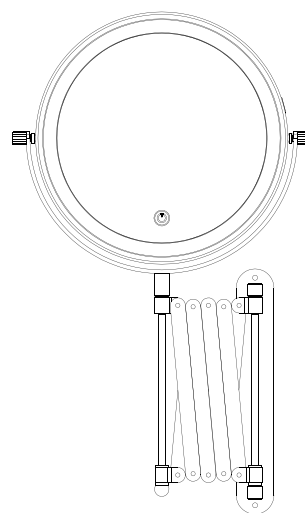

For your safety and continued enjoyment of this product,
Always read the instructions carefully before using.

Special Feature

- This lighted makeup mirror uses Lifetime Energy Saving LED bulbs. Replacement bulbs are not required.
- Built-in touch sensor switch
- Free to switch between warm, natural and cool light
- Magnifying mirror, clear to see details when do makeup.
- 360 degree swivel rotation that adjusts to any position as needed
- Type-c charging more environmentally friendly .

How to Install

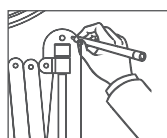

1. Choose a desire location to install
Mark 2 of the holes against the wall

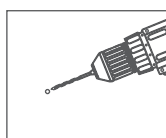

2. Drill holes (diameter of 6mm)
and install expansion anchor on the wall

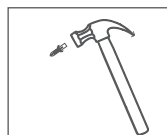

3. Install the 2 expansion anchor on the 2 holes

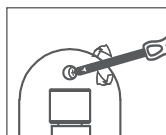

4. Install the mirror with screw

How to use the mirror

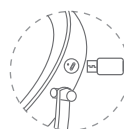

The mirror is powered by li-polymer battery, please make sure it is full charged before use



Put your fingers on the power switch on the mirror panel, the mirror will be lighted up.



Short press the sensor switch, free to switch between warm, natural and cool lights.

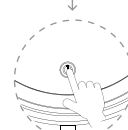

Keep your finger on the power switch, you can adjust the light brightness as per your needs.

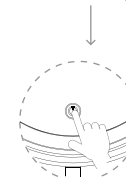

Get your finger off on the power switch, then touch again, the lights will be turned off.

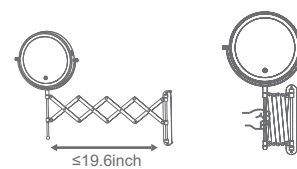

Extendable bracket: The maximum extension distance of the bracket is recommended NOT to exceed 19.6 inch.

What's in the box

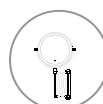

Dual-Sided Wall Mount Mirror



Type-c Cable



Install parts



Product Instruction manual