

ASSEMBLY INSTRUCTION

BROWN DINING SIDE CHAIR

Congratulations on your purchase.

Rest assured only the finest materials, skilled artisans and modern engineering were used to carefully construct this exquisite piece.

PARTS LIST

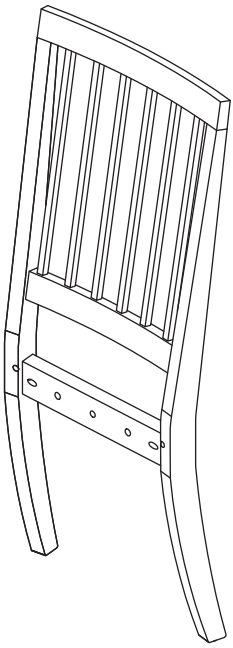

(A)

CHAIR BACK
x 1 PC

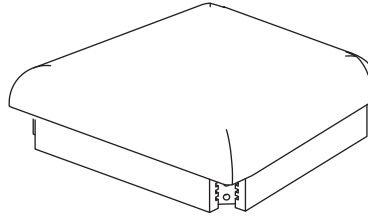

(B)

SEAT CUSHION
x 1 PC



(C)

LEGS
x 2 PCS

HARDWARE LIST

NO.	DESCRIPTION	SKETCH	QTY
1	ALLEN KEY 57mmL * 5mm		1 PC
2	SPRING WASHER Ø5/16" * 1.2mmT		10 PCS
3	FLAT WASHER Ø5/16" * 1.8mmT		10 PCS
4	WOOD DOWEL Ø10 * 40mmL		1 PCS
5	ALLEN BOLT Ø5/16" * 45mmL		2 PCS
6	ALLEN BOLT Ø5/16" * 55mmL		4 PCS
7	ALLEN BOLT Ø5/16" * 82mmL		4 PCS

STEP 1

Instructions:

Figure 1:

Insert Wood Dowel(4) into the hole in Chair Back(A), Align the holes in Seat Cushion(B) into place as shown. Secure the Seat Cushion(B) to Chair Back(A) with Allen Bolt(5), Spring Washer (2) and Flat Washer (3) by using Allen Key(1). Fully tighten all bolts.

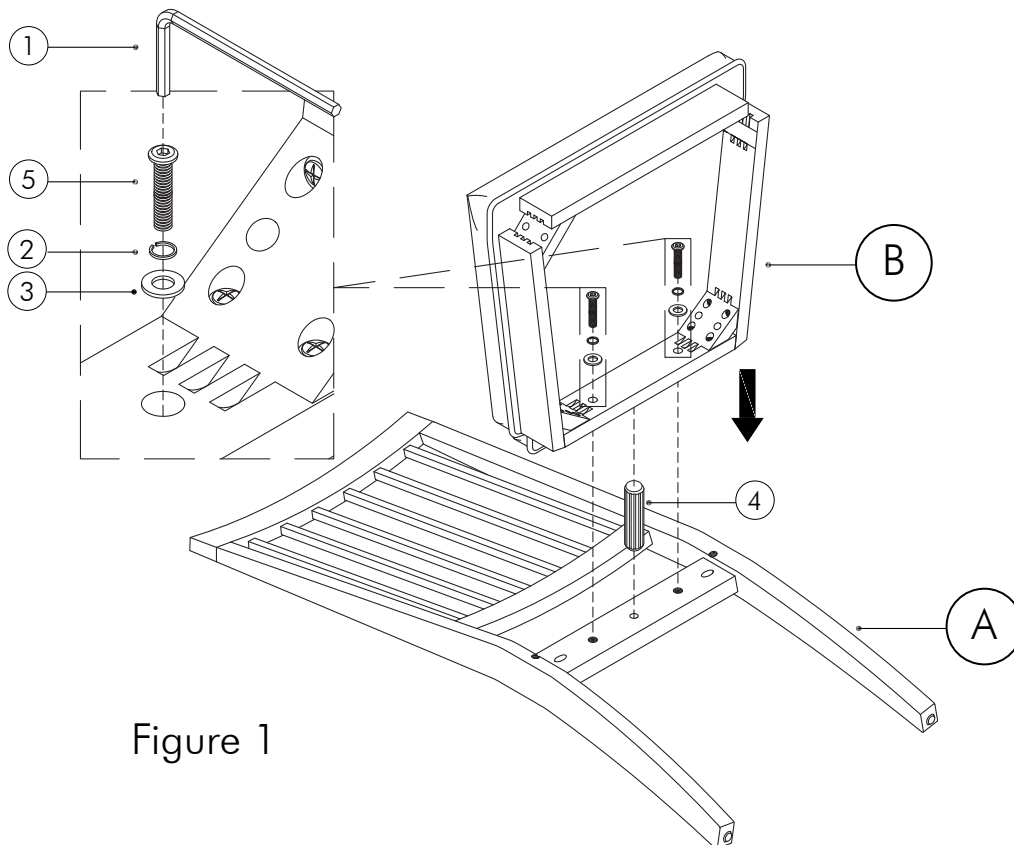

Figure 1

Figure 2:

Secure the Seat Cushion(B) to Chair Back(A) with Allen Bolt(7), Spring Washer (2) and Flat Washer (3) by using Allen Key(1). Fully tighten all bolts.

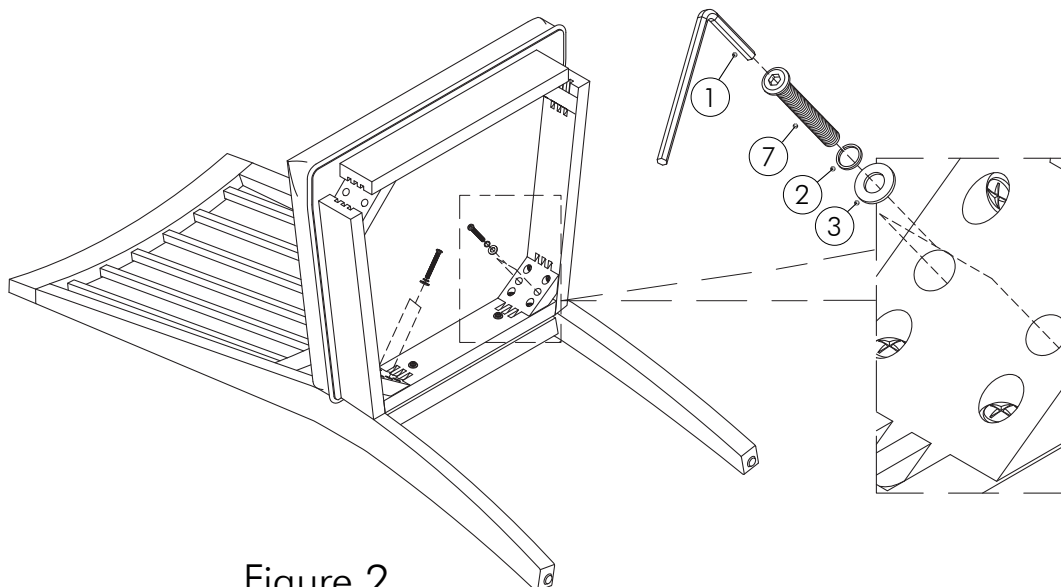

Figure 2

STEP 2

Instructions:

Figure 3:

Align the holes in Chair Leg(C) into place as shown.

Secure the Chair Leg(C) to the Seat Cushion(B) with Allen Bolt(6), Spring Washer (2) and Flat Washer (3) by using Allen Key(1).

Repeat the assembly for the remaining legs.

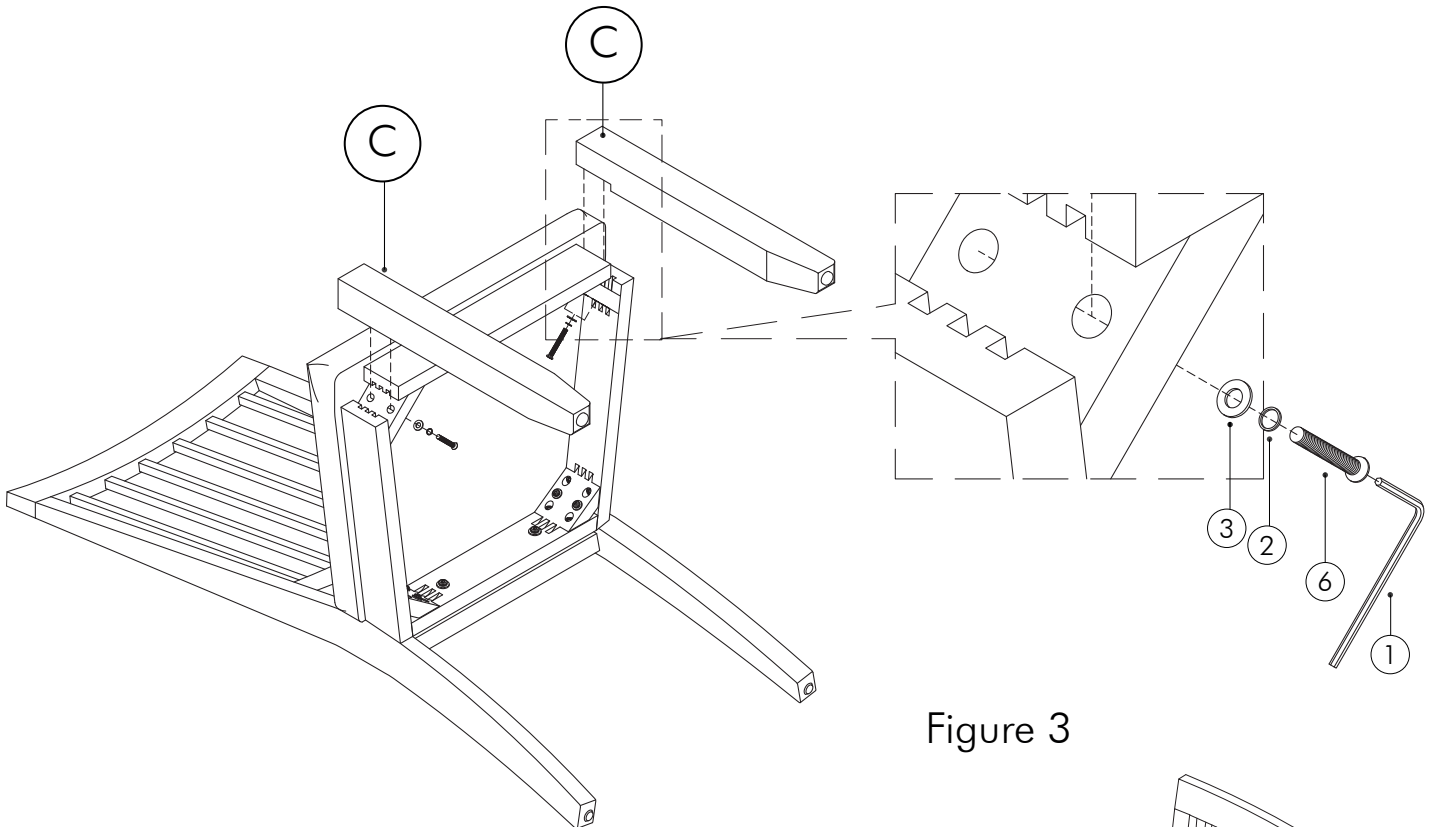

Figure 3

Return the assembled Chair upright and place into the desired position.

ASSEMBLY IS COMPLETED

