

INSTRUCTION MANUAL

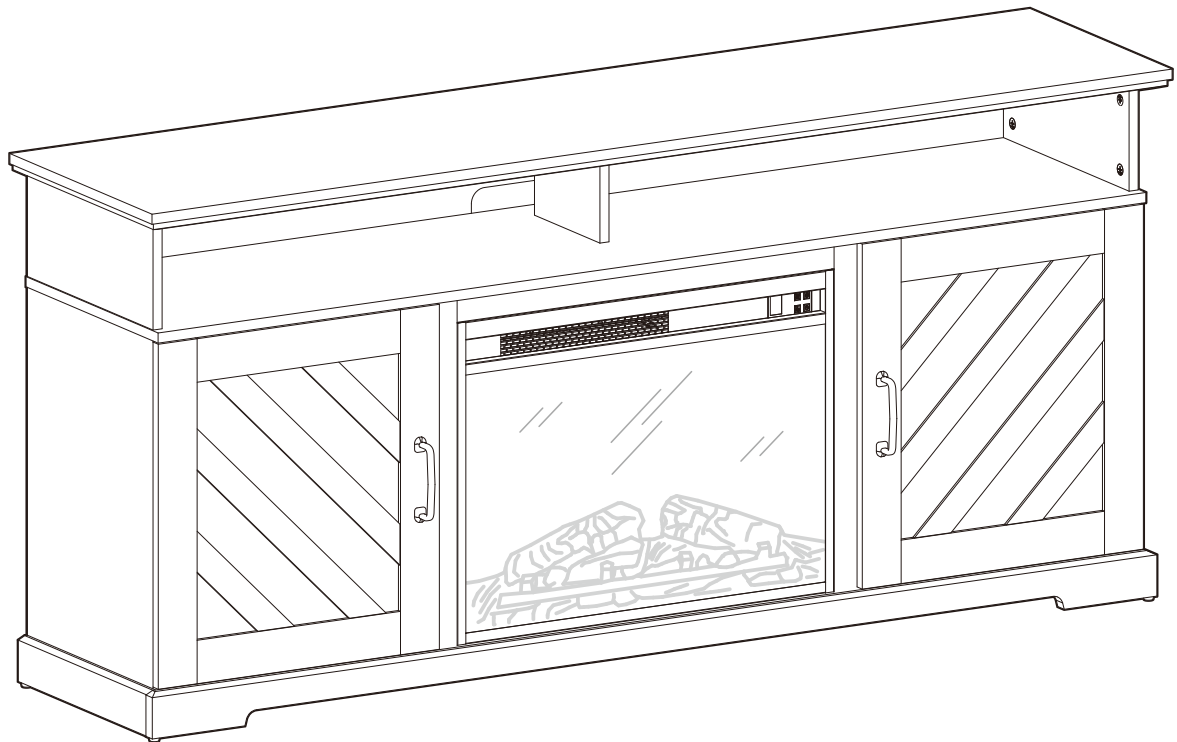

TV Console

Important Safety Information

- Please carefully read all instructions before attempting installation. If you DO NOT understand the instructions or have any questions or concerns, please call technical support or email customer service.

CAUTION: Avoid potential injuries and property damage!

- DO NOT use this product for any purpose that is NOT explicitly specified in this manual. We are NOT liable for damage or injury caused by improper mounting, incorrect assembly or inappropriate use.

WARNING: This product contains small parts that may pose a choking hazard.

- Before starting assembly, verify all parts are included and undamaged. DO NOT use damaged or defective parts. If you require replacement parts, please call technical support or email customer service.
- To prevent the stand from tipping over, use the wall attachment device provided with this product.



Top Shelf Weight Capacity:
200 lbs (90kg)

Fits most flat panel TVs up to 65" diagonally

Middle Shelf Weight Capacity:
50 lbs (22.7kg)

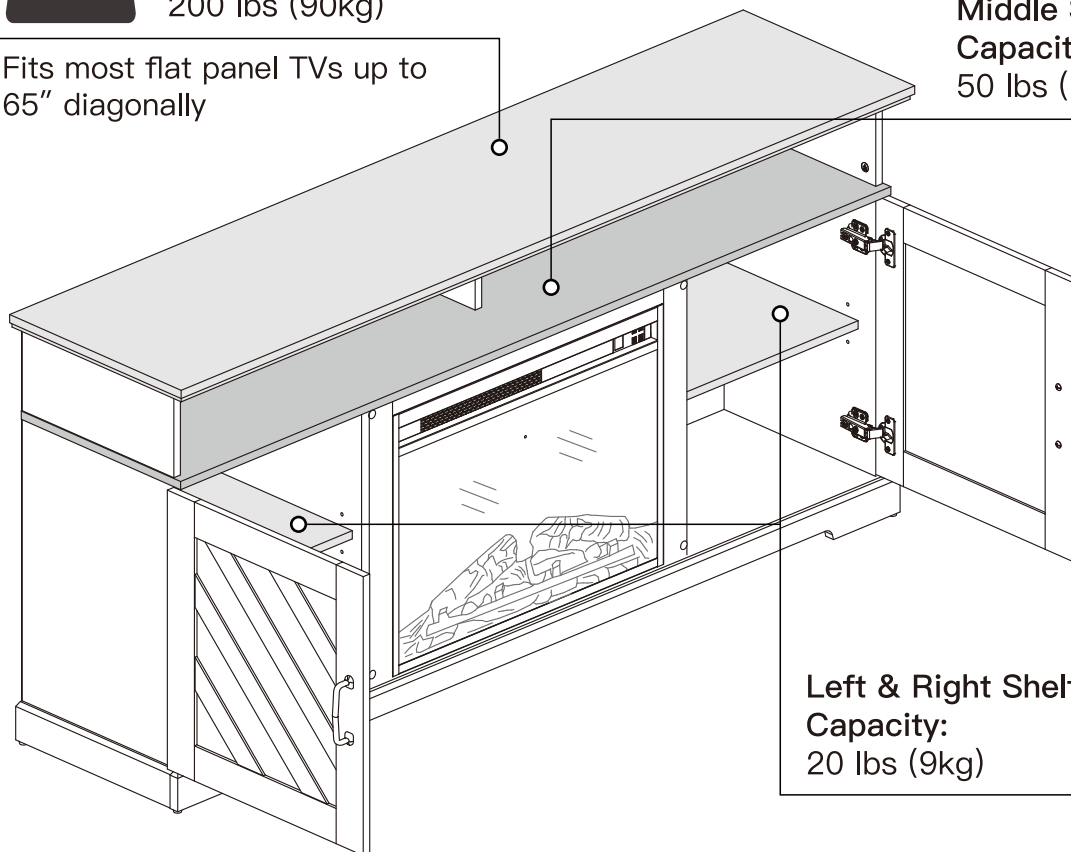

Left & Right Shelf Weight Capacity:
20 lbs (9kg)



Tools Needed (Not Included)

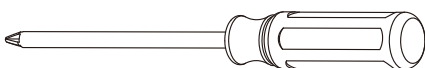

Phillips Screwdriver

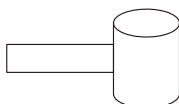

Rubber Mallet

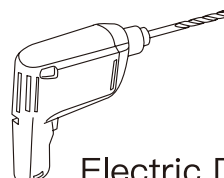

Electric Drill



Hammer

How the Assembly System Works

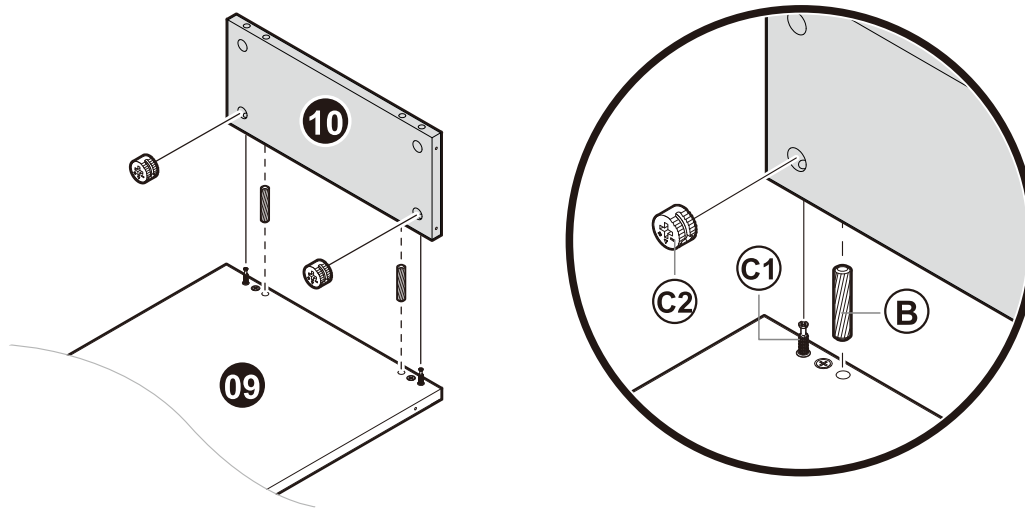

How to Install Wood Dowels

Insert the wood dowel [B] at least halfway into the hole. IF NECESSARY, lightly tap the wood dowel with a self-supplied rubber mallet.

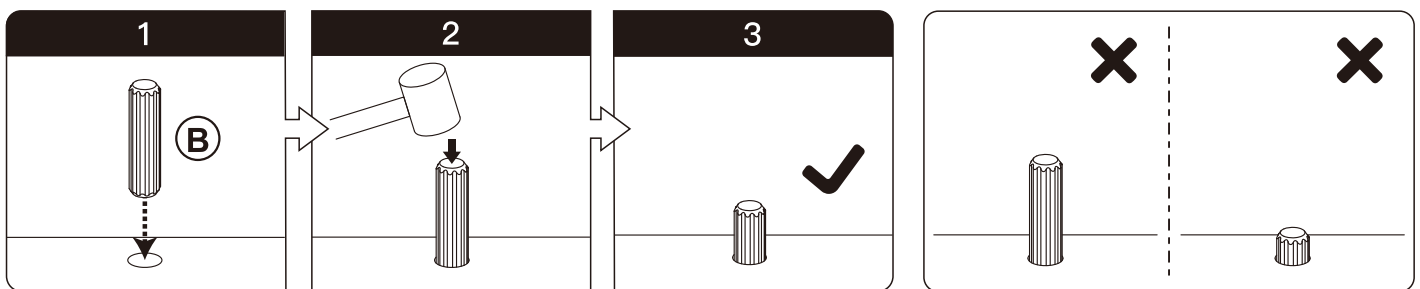

Using the Cam Lock System

1. Screw cam bolt [C1] into the threaded hole on the panel.
2. Connect both panels together. Make sure cam bolt [C1] goes into the pre-drilled hole on the end of the panel for cam lock [C2].
3. Insert cam lock [C2] into the large hole on the panel. Make sure the open slot faces the head of the cam bolt [C1].
4. Rotate cam lock [C2] clockwise with a Phillips screwdriver to lock the cam bolt [C1] in place.

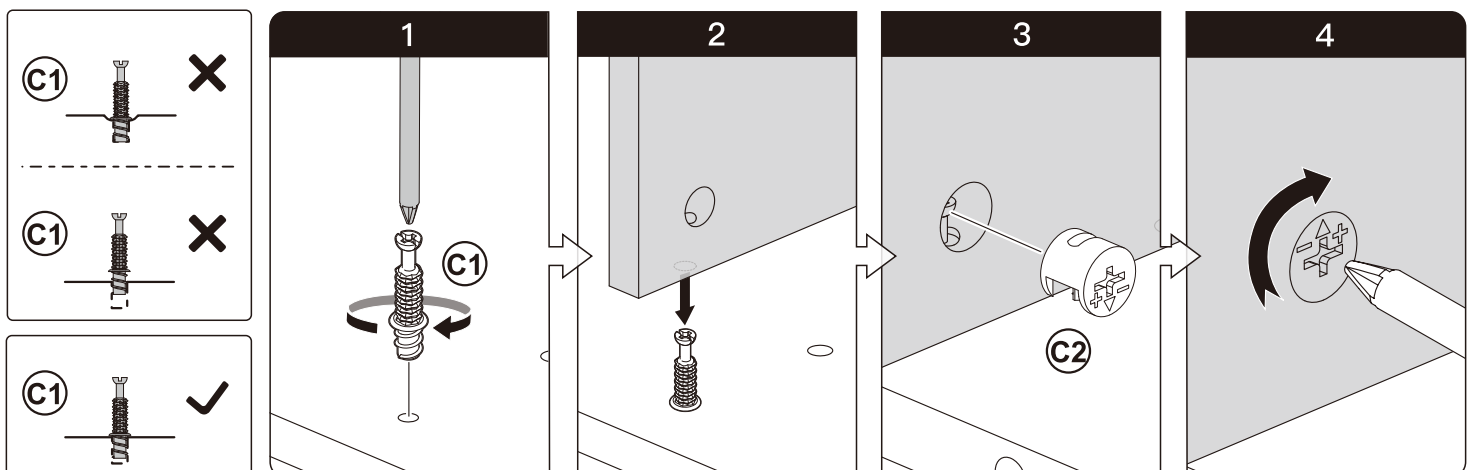

You are now ready to assemble the TV console.

Exploded Drawing

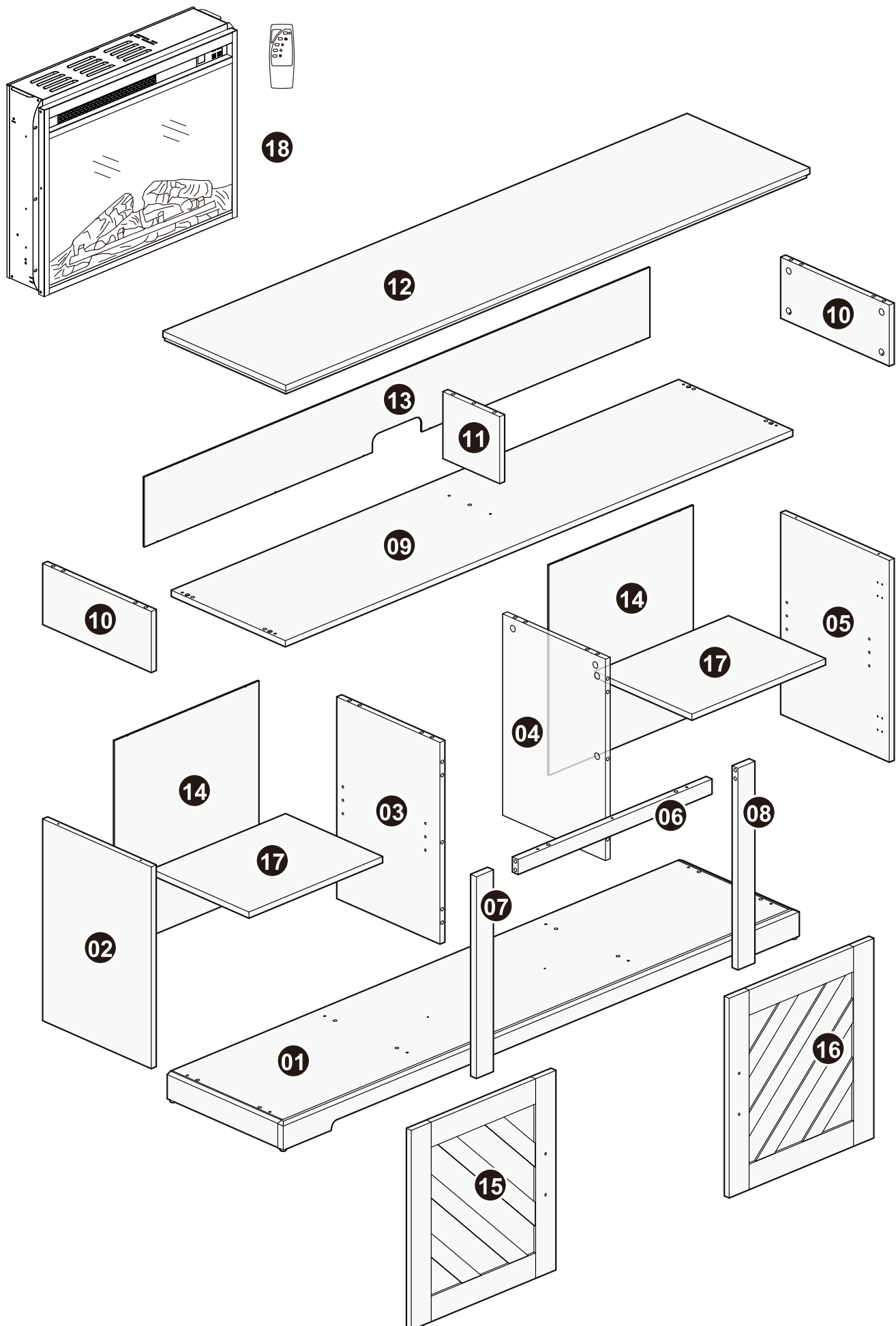

Supplied Parts and Hardware

01 x 1

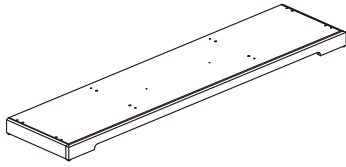

Base

02 x 1

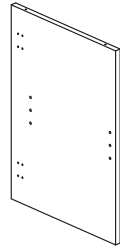

Lower Left End Panel

03 x 1



Left Inside Panel

04 x 1



Right Inside Panel

05 x 1

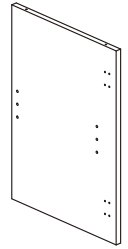

Lower Right End Panel

06 x 1

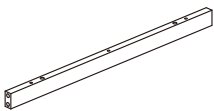

Center Rail

07 x 1



Left Rail

08 x 1



Right Rail

09 x 1

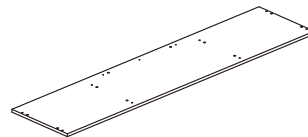

Middle Panel

10 x 2

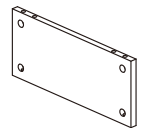

Upper End Panel

11 x 1

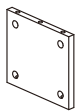

Divider

12 x 1

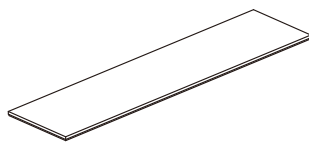

Top Panel

13 x 1

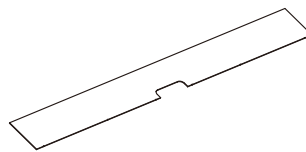

Back Center Panel

14 x 2

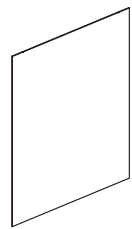

Back Panel

15 x 1

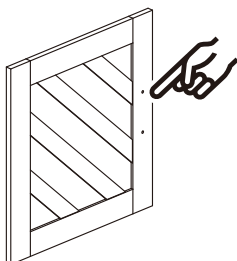

Left Door

16 x 1

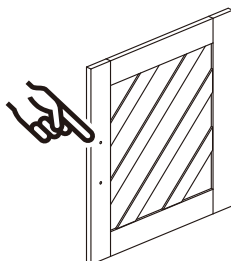

Right Door

17 x 2

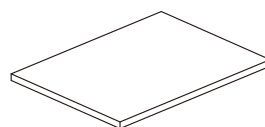

Shelf

18 x 1

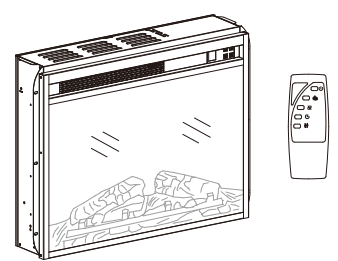

Fireplace

Supplied Parts and Hardware

(A) x 12



ST4 x 50mm
Screw

(B) x 36

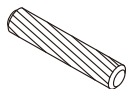

Ø8 x 30mm
Wood Dowel

(C1) x 22

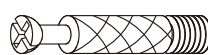

M6 x 35mm
Cam Bolt

(C2) x 22



Ø15 x 11mm
Cam Lock

(D) x 2

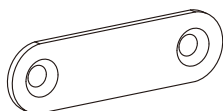

Bracket

(E) x 4

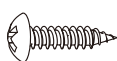

ST3 x 12mm
Screw

(F) x 3



ST4 x 32mm
Screw

(G) x 32

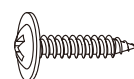

ST3.5 x 15mm
Screw

(H) x 2

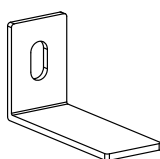

Backstop

(I) x 2

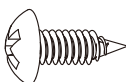

ST5 x 12mm
Screw

(J) x 4

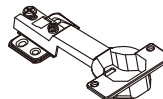

Hinge

(K) x 24



ST3.5 x 15mm
Screw

(L) x 2

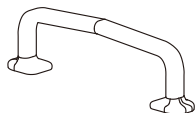

Door Handle

(M) x 4

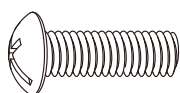

M4 x 19mm
Bolt

(N) x 4



Door Silencer

(O) x 8

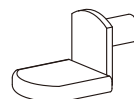

Shelf Pin

Anti-tip Kit



ST4 x 12mm
Screw
x 1



ST4 x 25mm
Screw
x 1



Washer
x 2

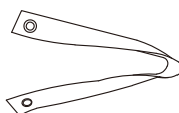

Strap
x 1

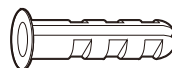

Ø6 x 25mm
Wall Anchor
x 1

! CAUTION!



This wall anchor is for concrete
ONLY. DO NOT use them in
drywall or wood studs.

Step 1

Parts and Hardware

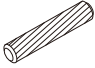

You may need assistance with this step.

- 

[A] x 8 [B] x 8

- [01] x 1 [02] x 1 [03] x 1
[04] x 1 [05] x 1



Phillips
Screwdriver
(not included)

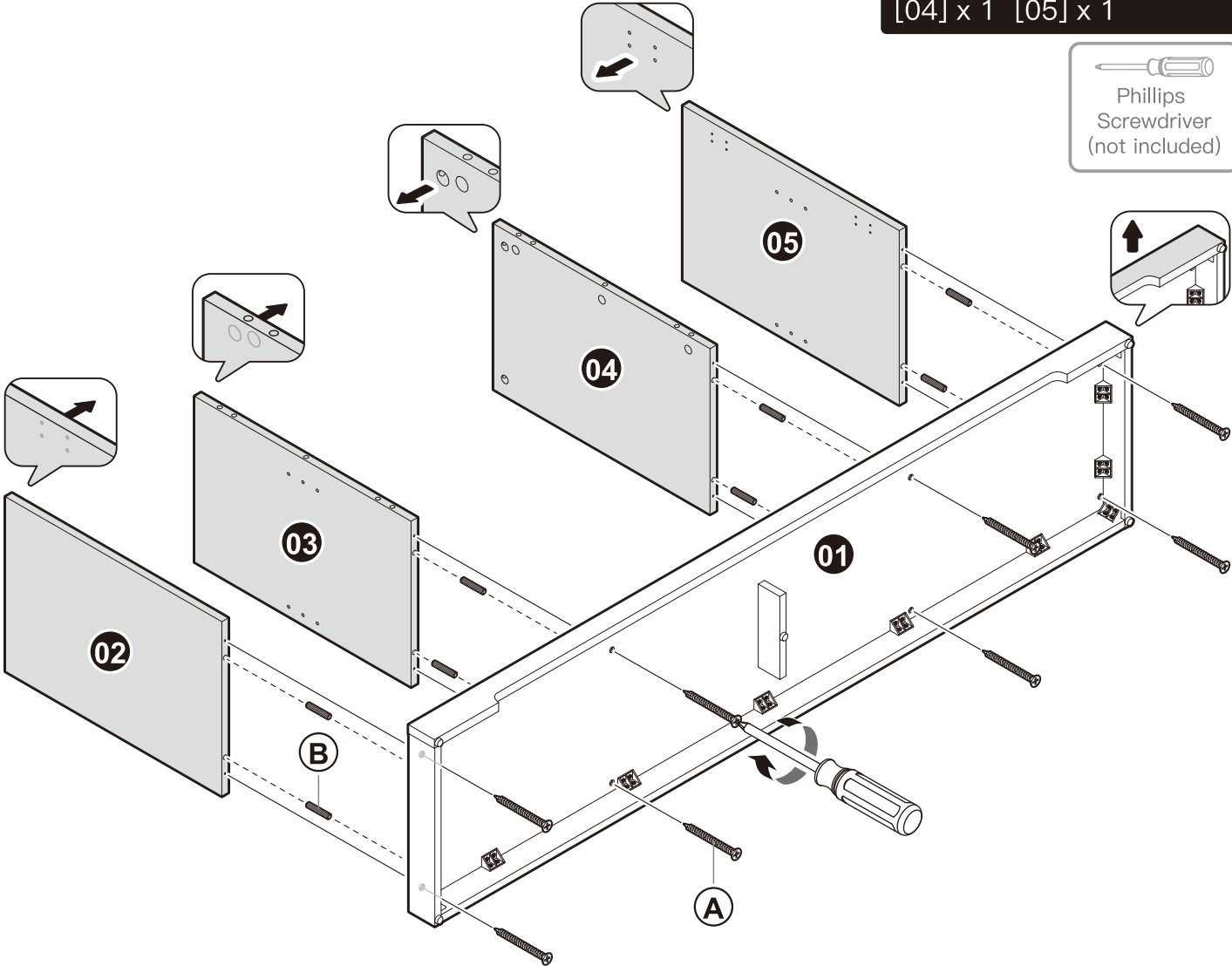

Step 2

Parts and Hardware

- 

[C1] x 6

- [07] x 1 [08] x 1



Phillips
Screwdriver
(not included)

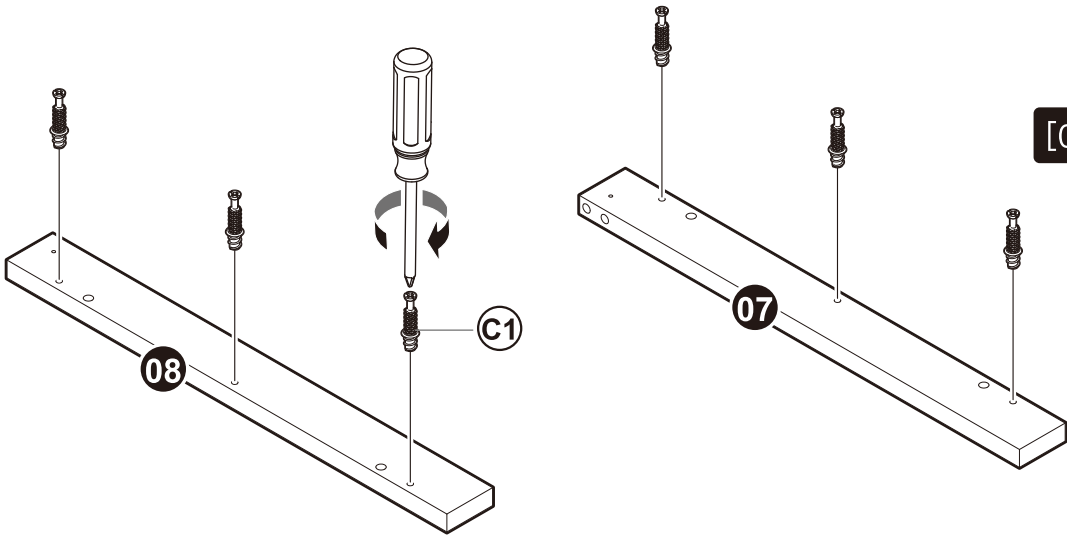

Parts and Hardware

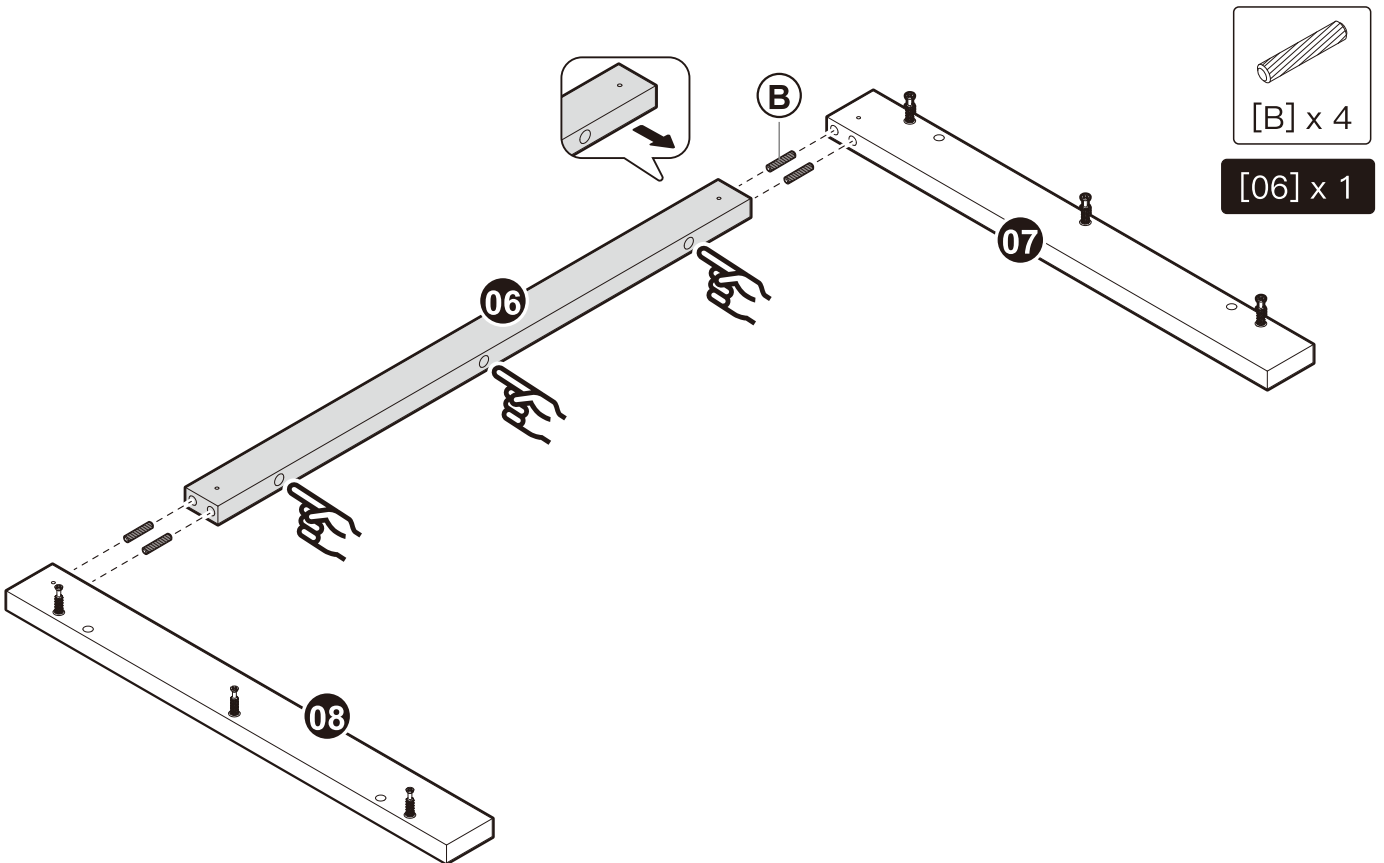

Parts and Hardware

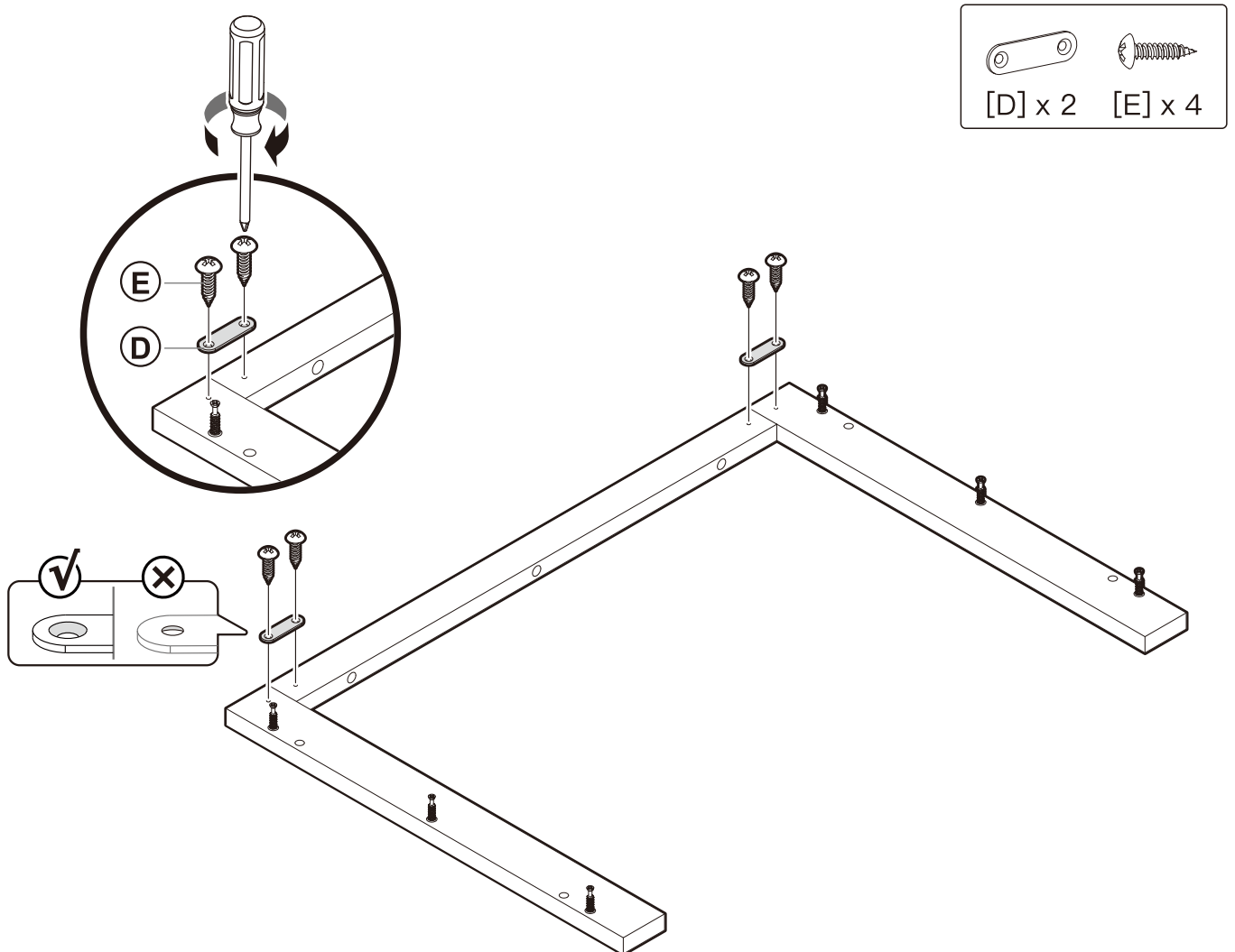

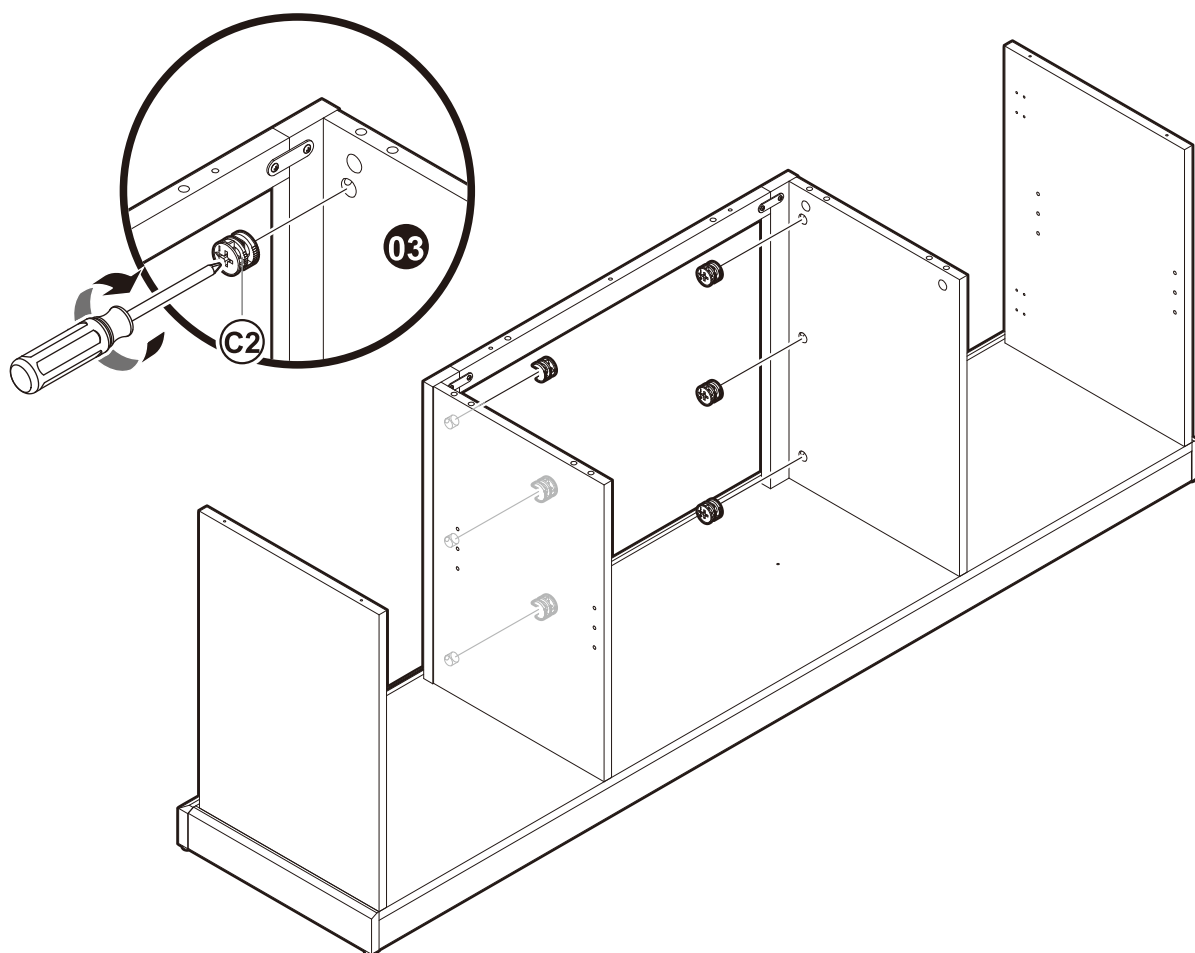
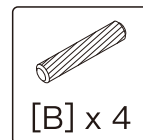
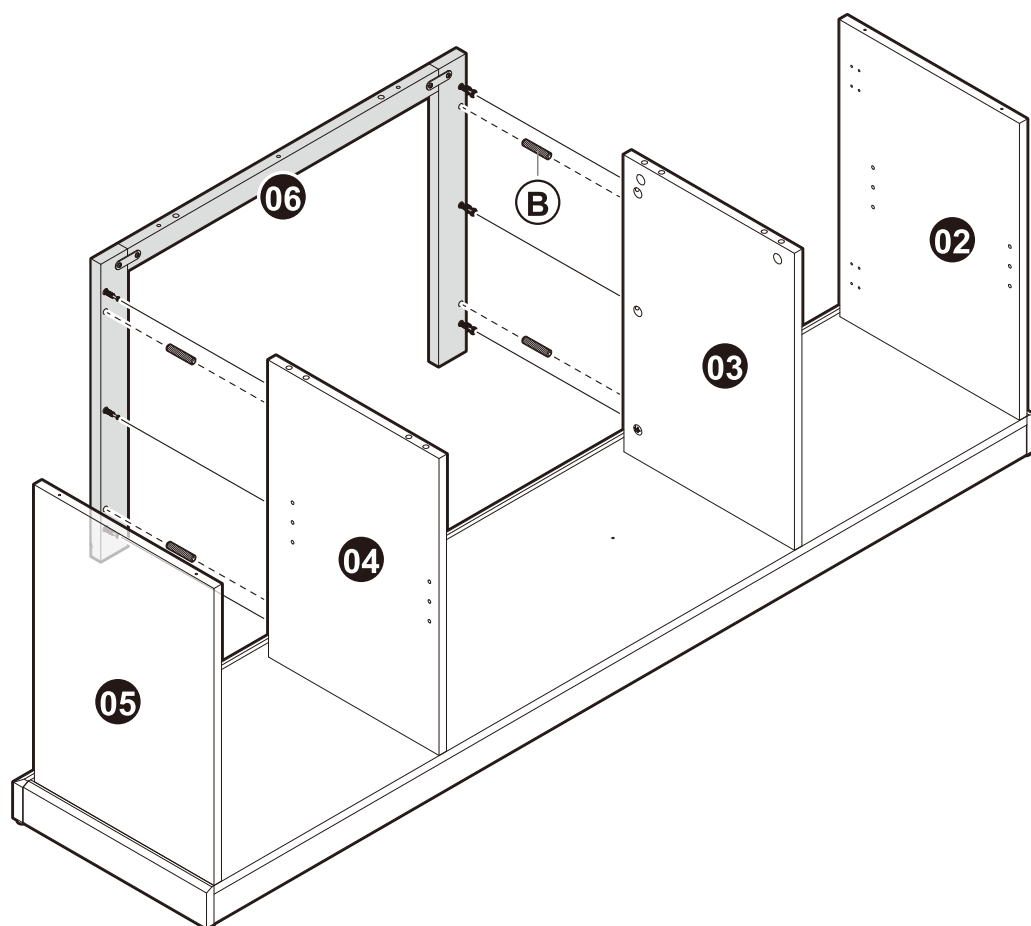

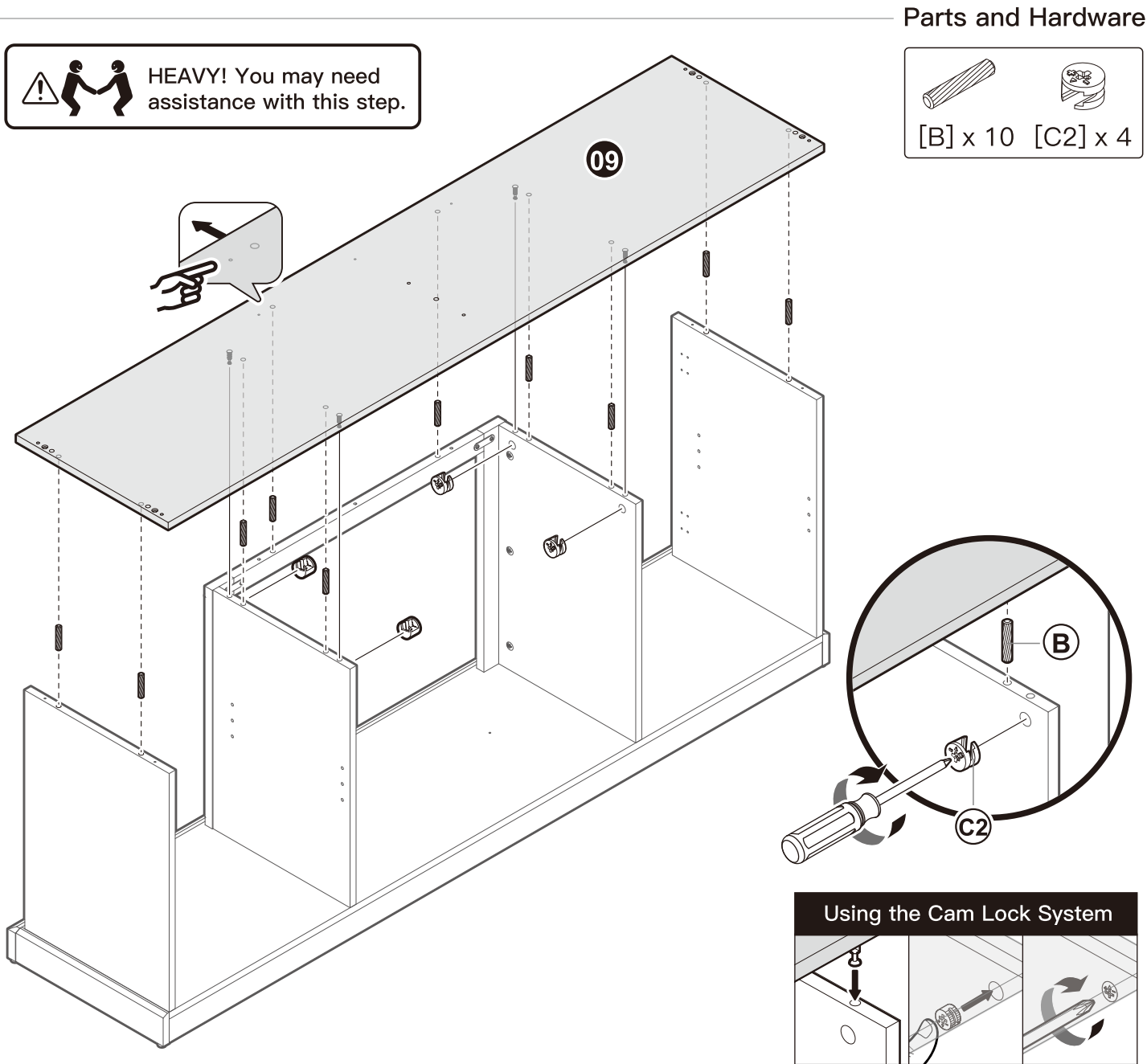
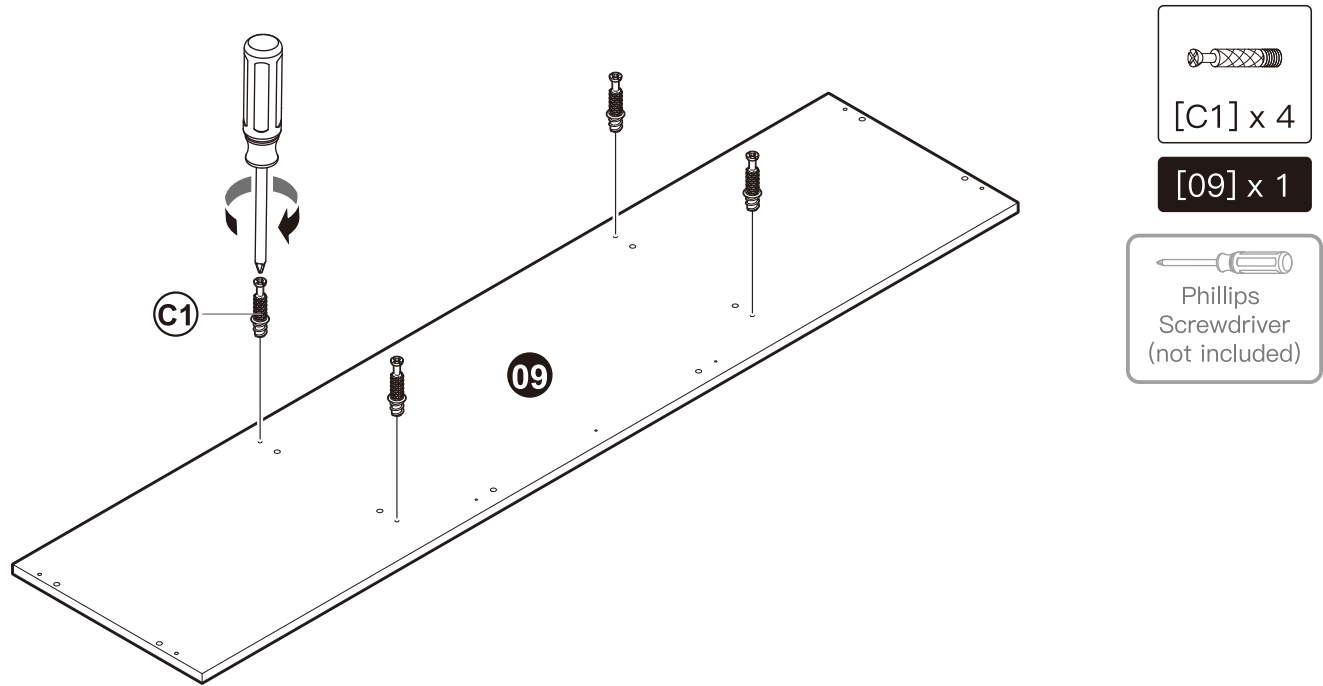

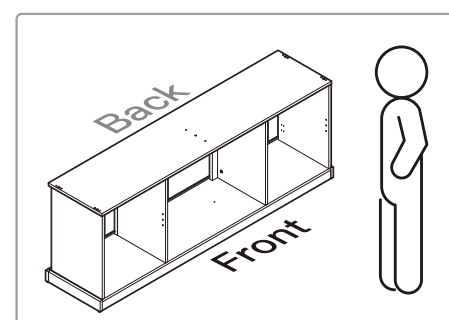
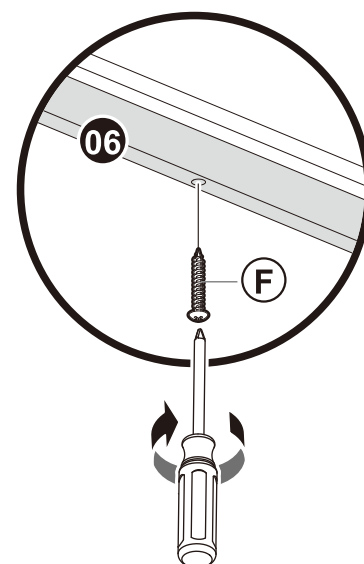
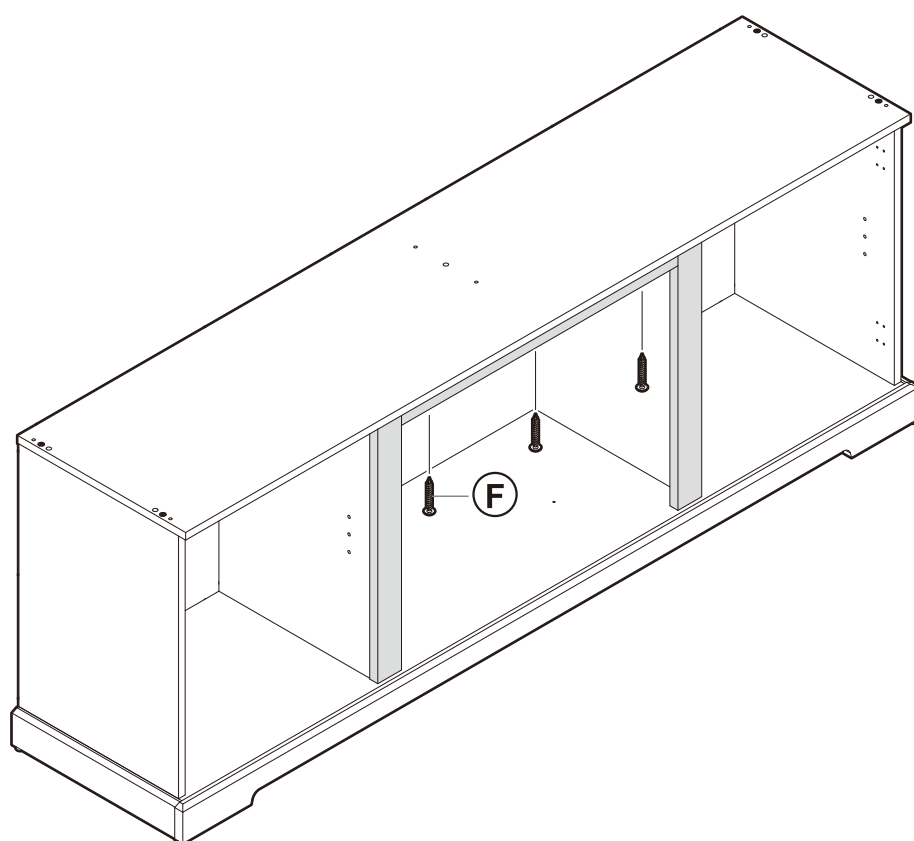
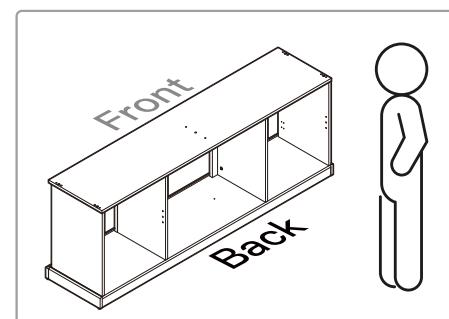
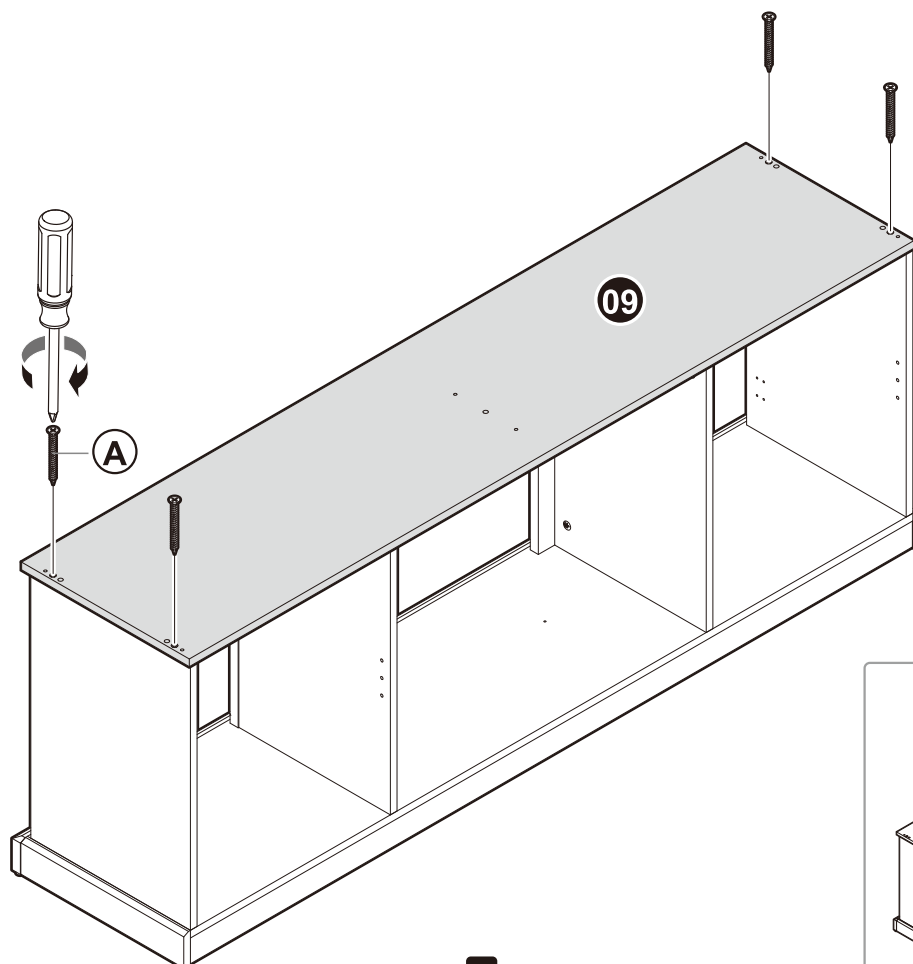
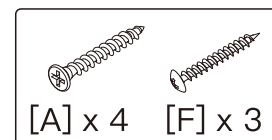

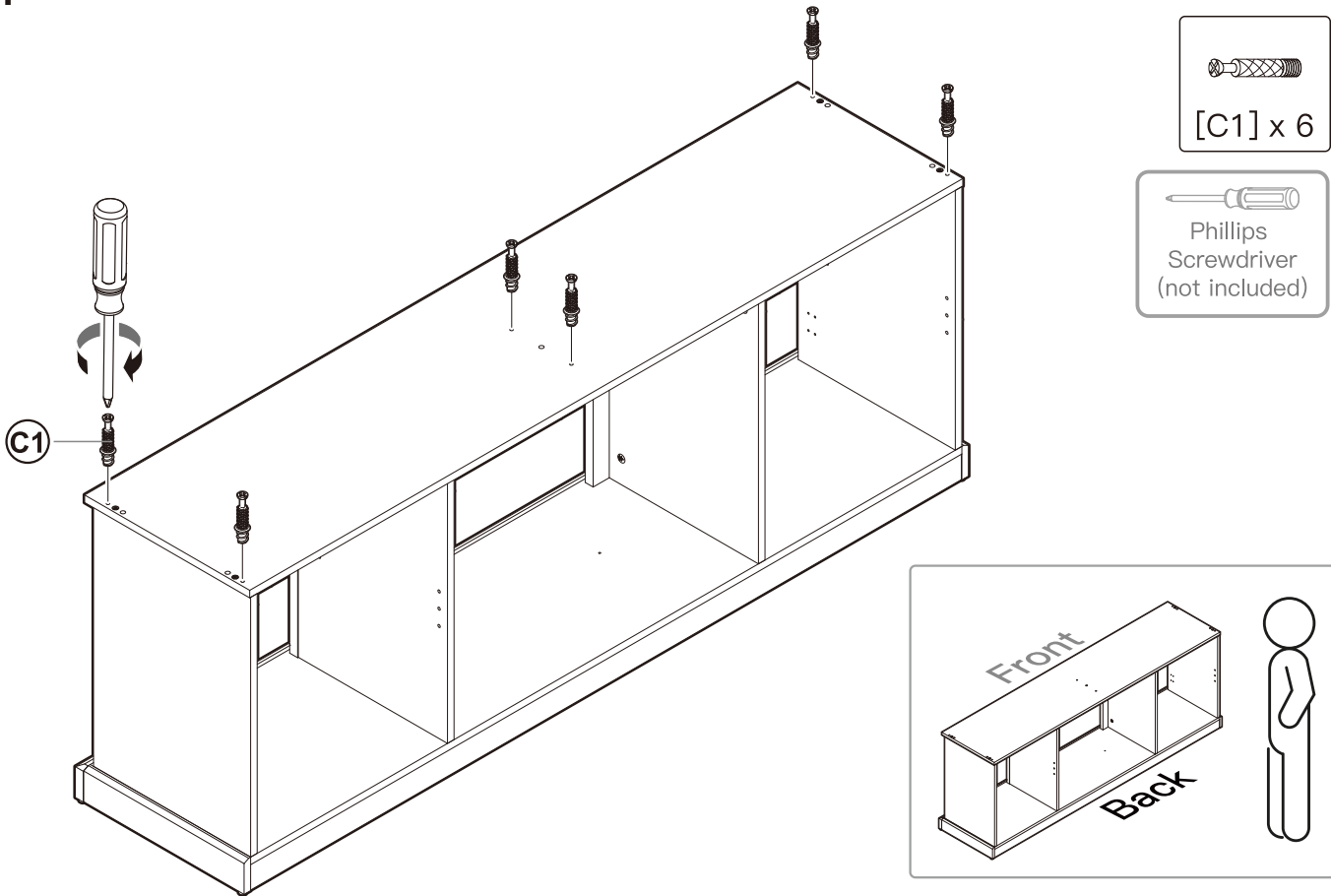

Parts and Hardware

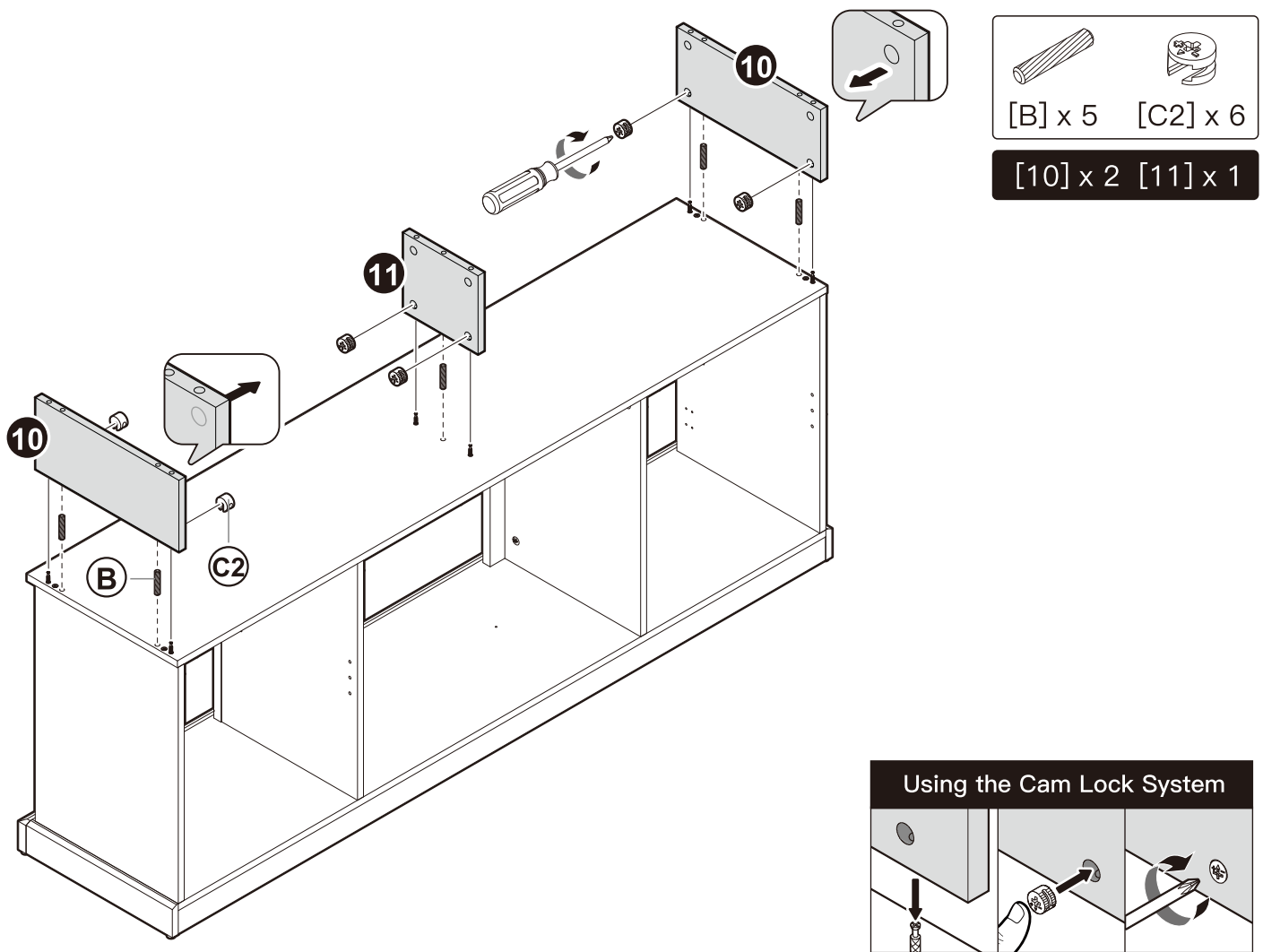

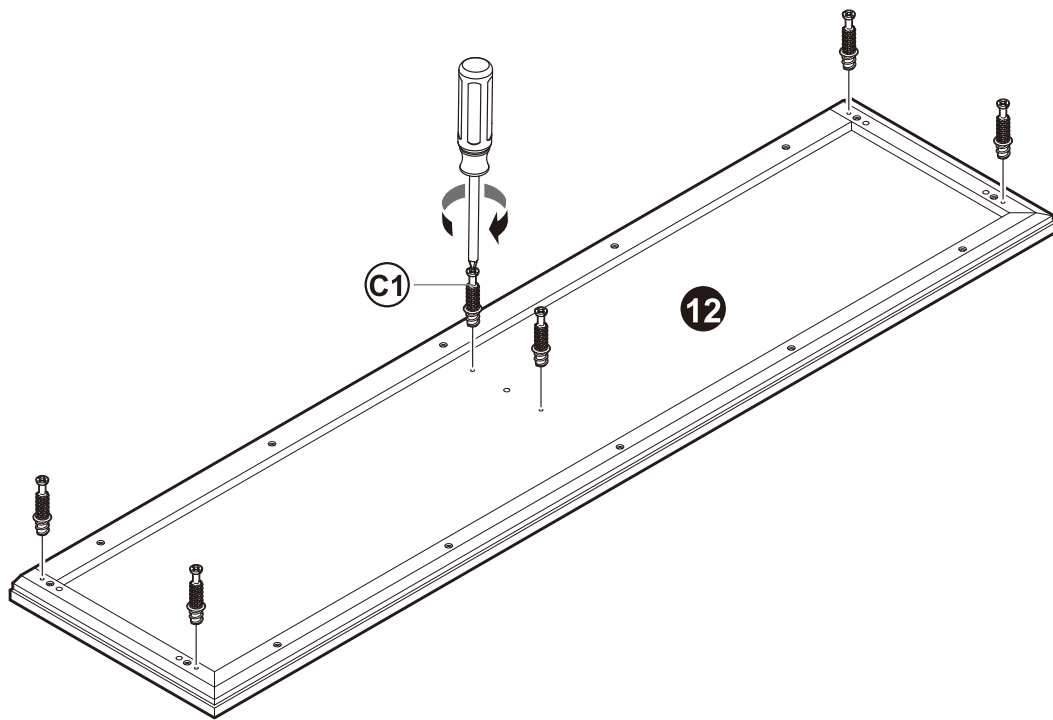

[C1] x 6

[12] x 1



HEAVY! You may need assistance with this step.



Mind your hands!

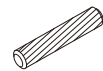

[B] x 5



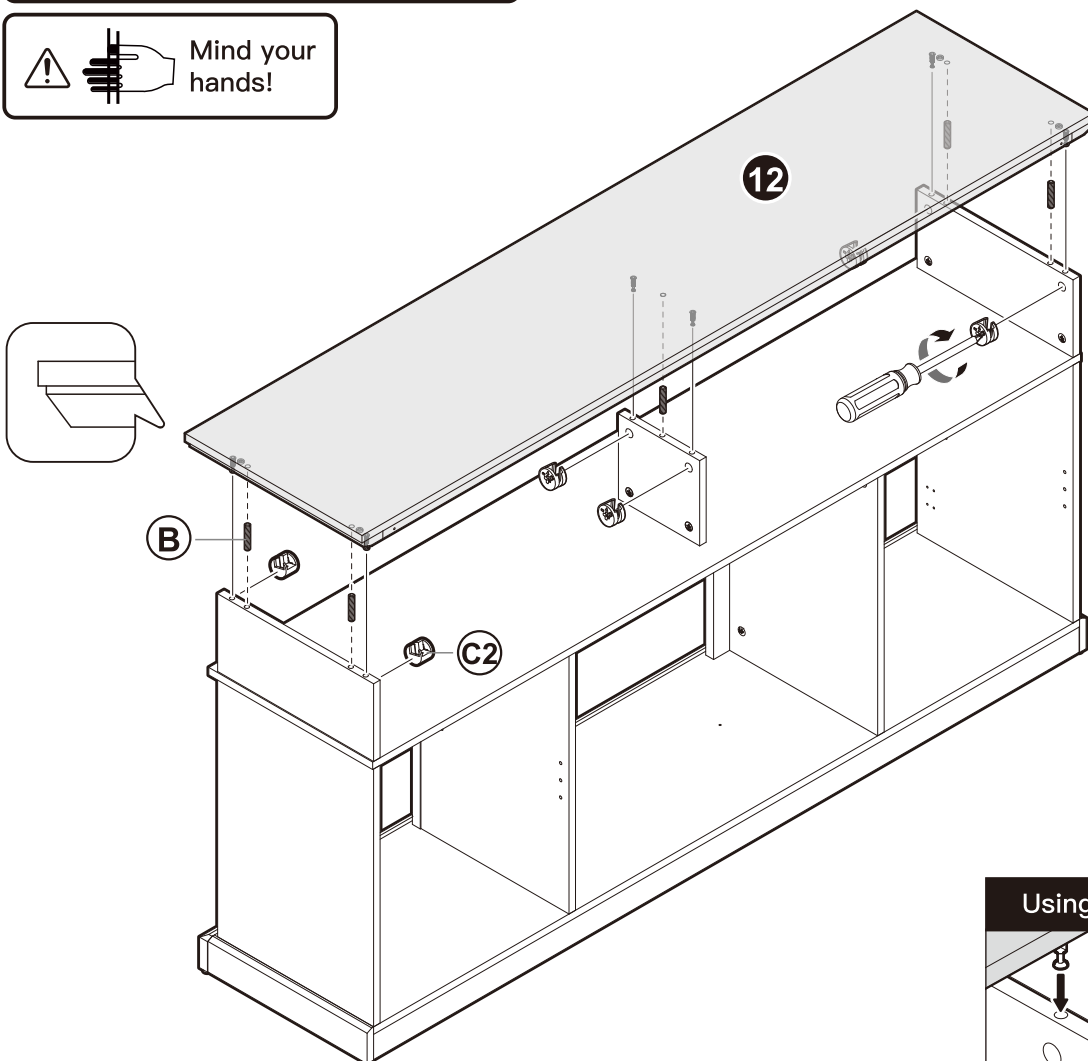

[C2] x 6

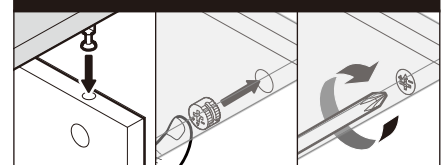

Note: The TV console may be unstable and wobble until the back panel is attached.

Using the Cam Lock System



 You may need assistance with this step.



[13] x 1



Phillips
Screwdriver
(not included)

Note: There are only 2 pilot holes on the top panel for the screws [G]. Attach the back center panel [13] to the top panel first using the 2 pilot holes. Loosely thread all of the other screws [G] into place before fully tightening one by one.



[G] x 22

[14] x 2

[18] x 1

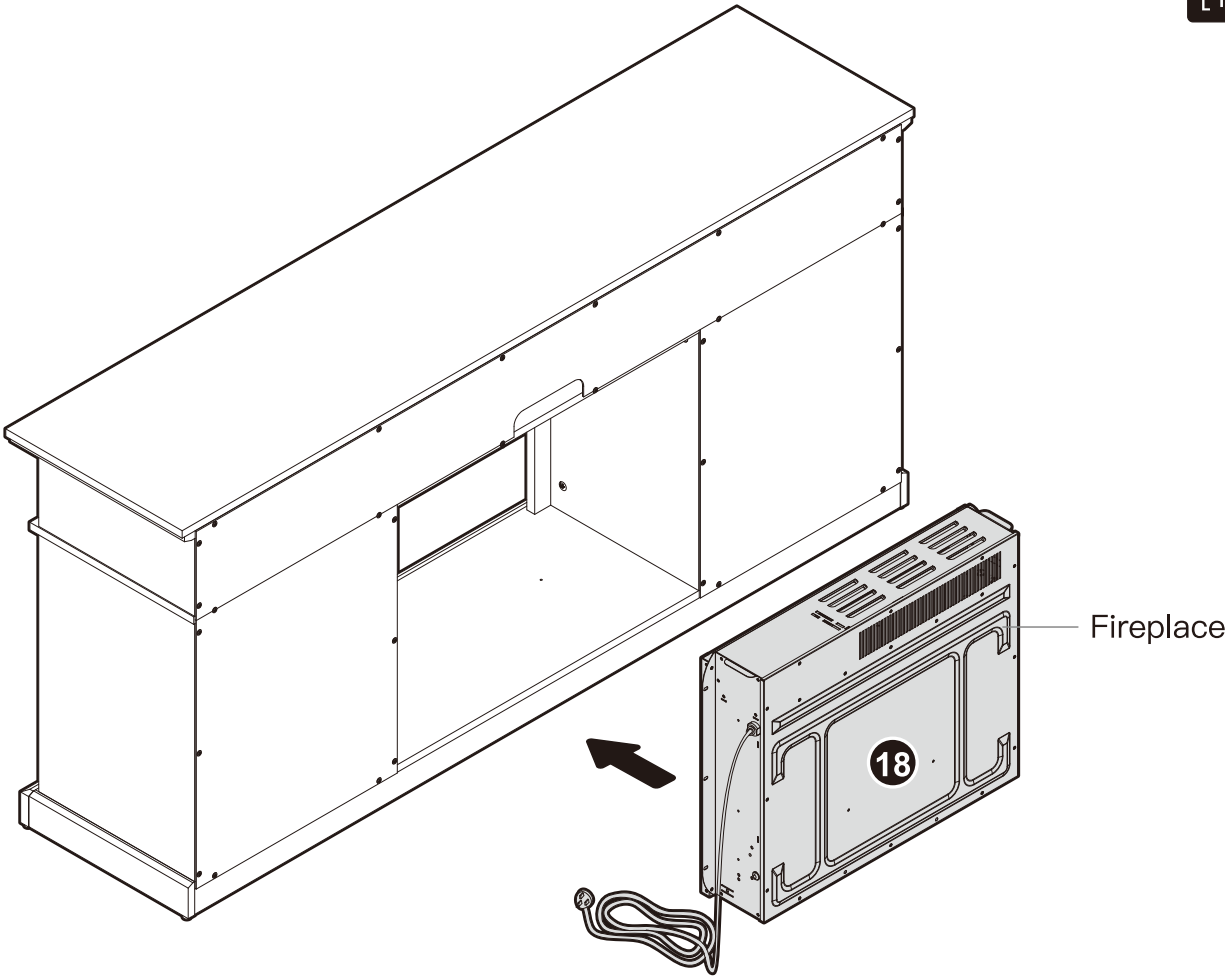

Parts and Hardware

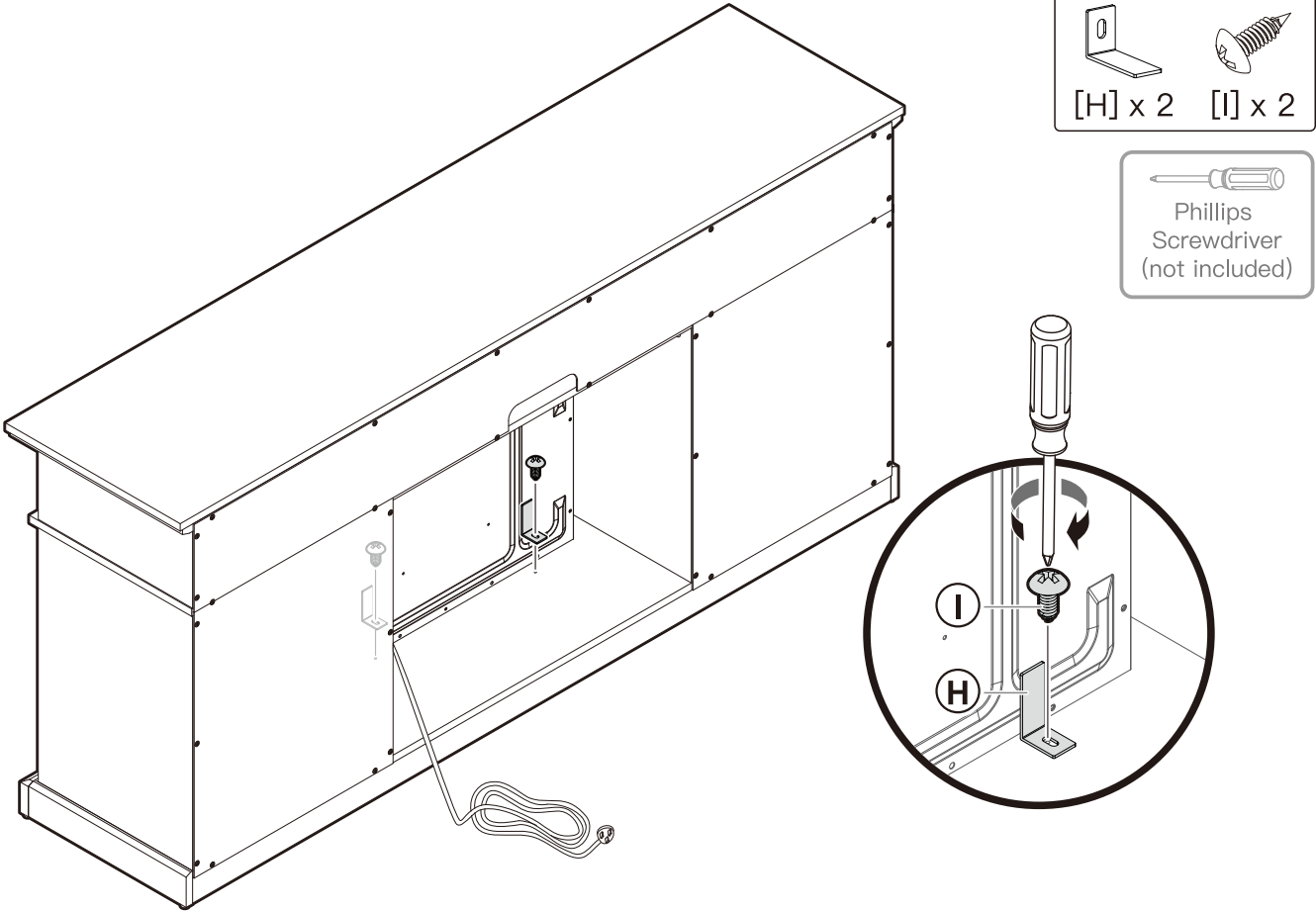

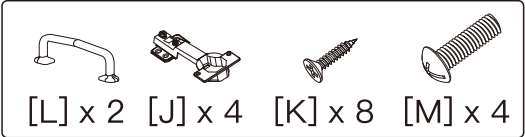

[15] x 1 [16] x 1

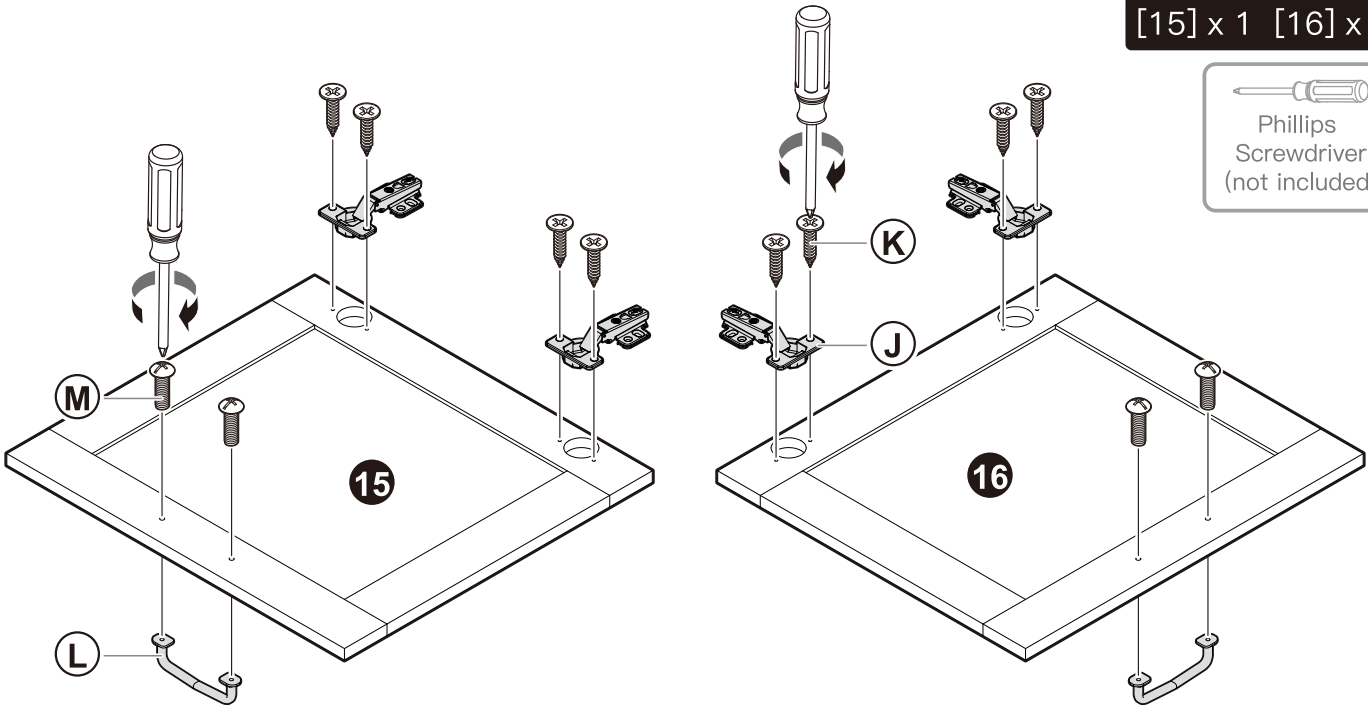

Parts and Hardware

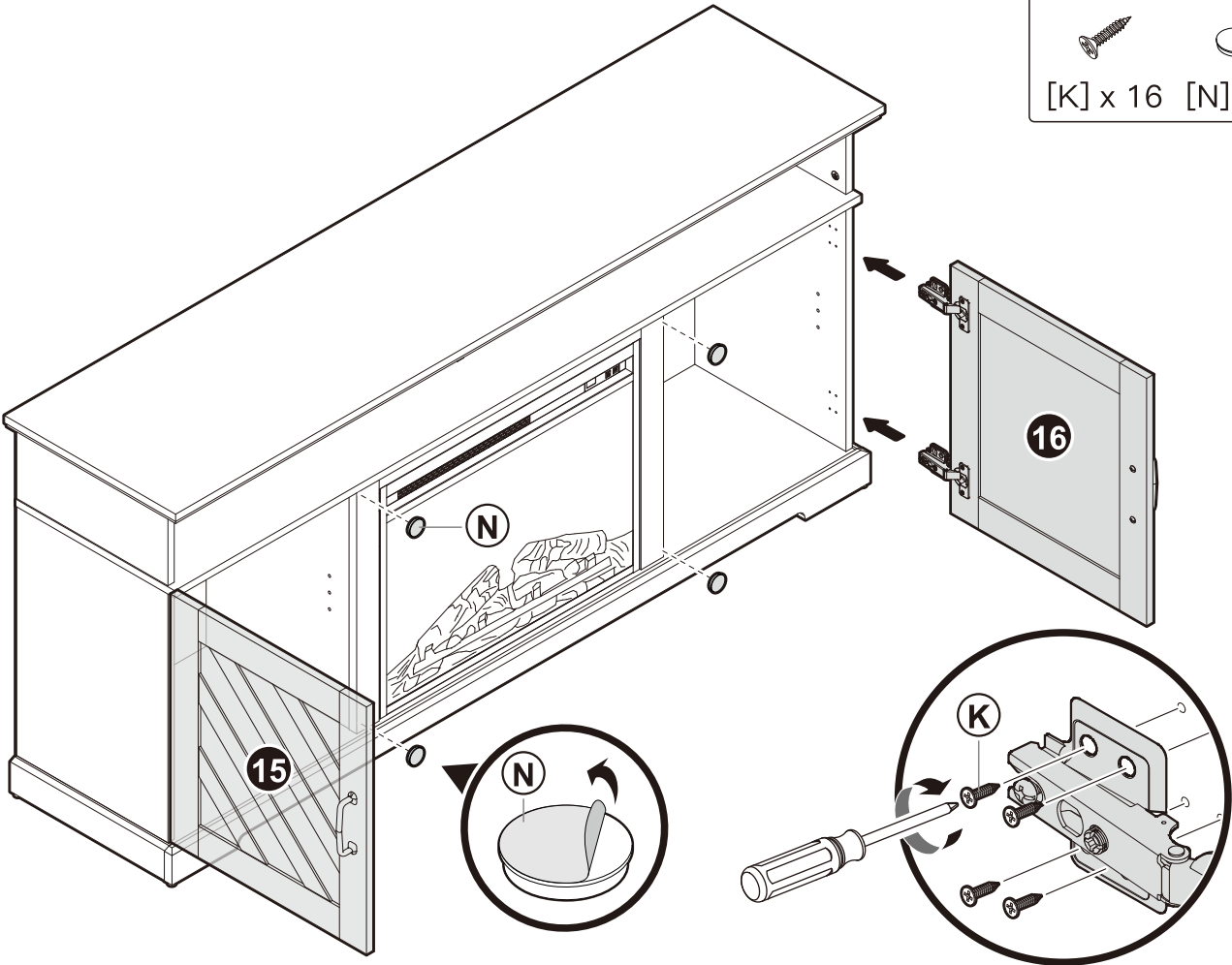

Step 8

Adjustment

The doors may go out of alignment during shipping. Open and close the doors to make sure they are aligned correctly. If you find that the doors need to be adjusted, turn the appropriate screw, as illustrated.

The hinges are adjustable in three directions for perfect alignment.

Phillips
Screwdriver
(not included)

To adjust door up or down

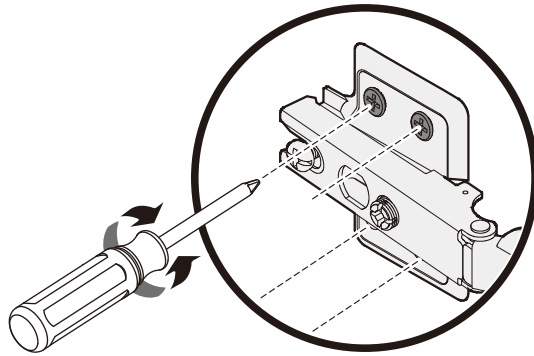
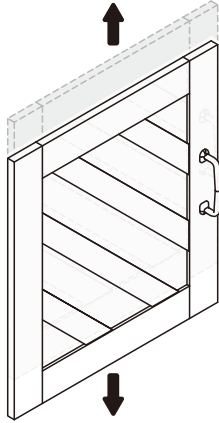

To adjust door forward or backward

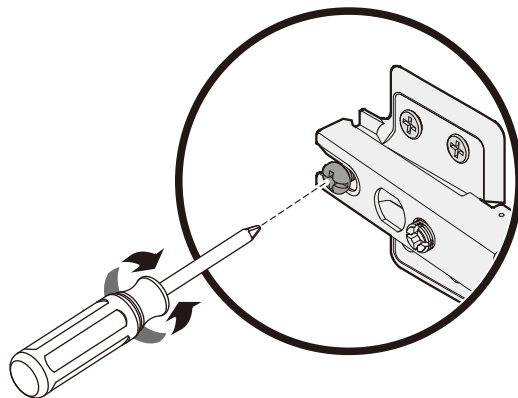
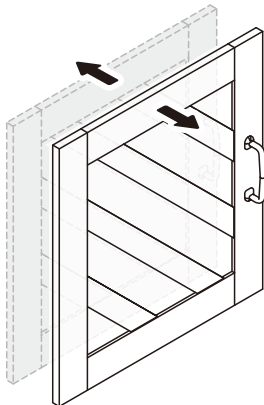

To adjust door right or left

Turn the set screw clockwise to narrow the gap between the door and the end panel.

Turn the set screw counterclockwise to enlarge the gap between the door and the end panel.

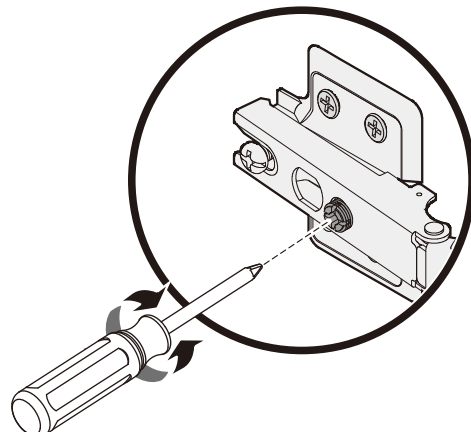
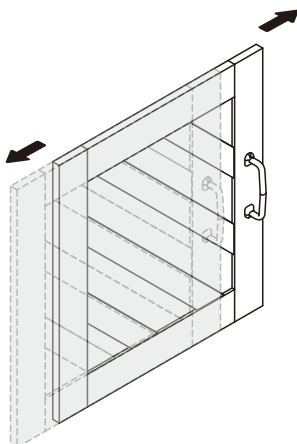

[O] x 8

[17] x 2

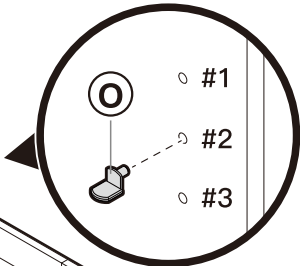
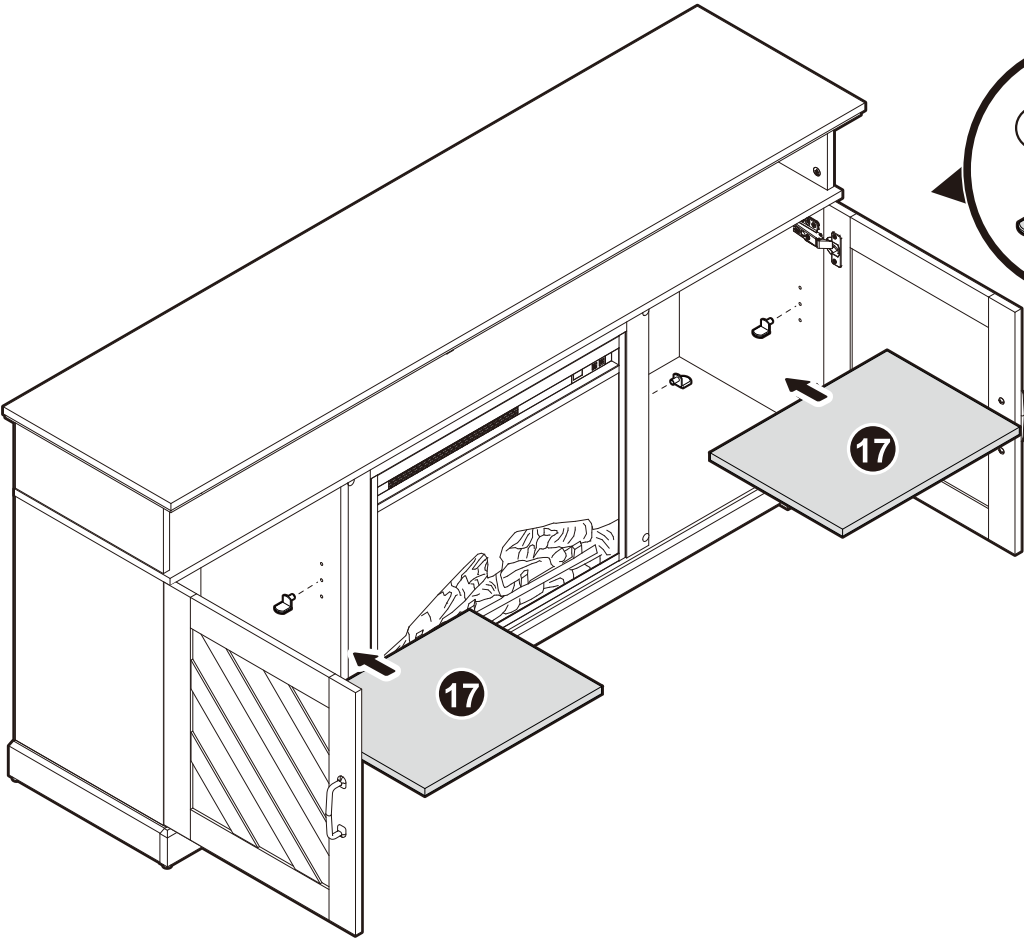

Note: Shelves can be installed at three different heights.

