



# Russell Hobbs

# REFRESH & CLEAN

## Operating Manual

RHCC5001

### ASSEMBLY

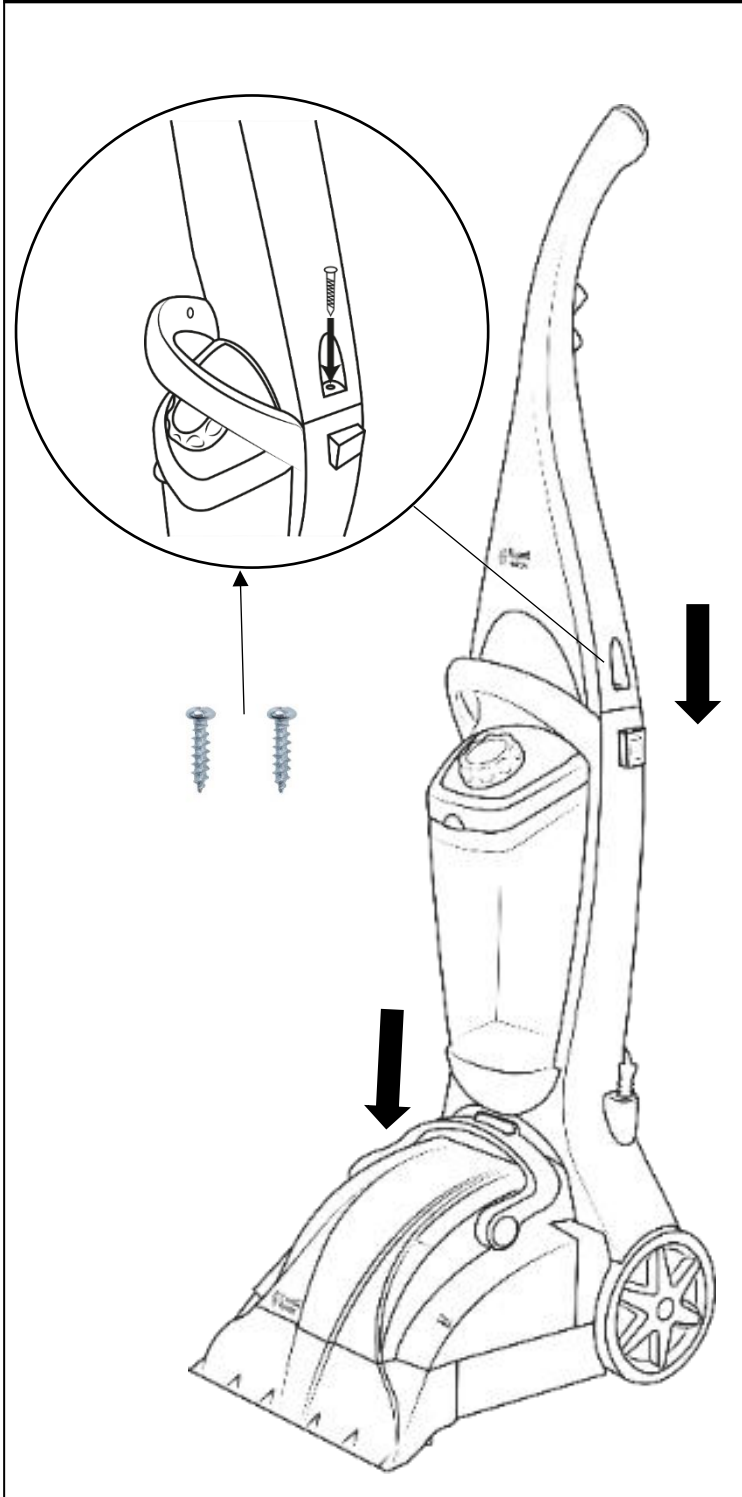

### POWERING ON

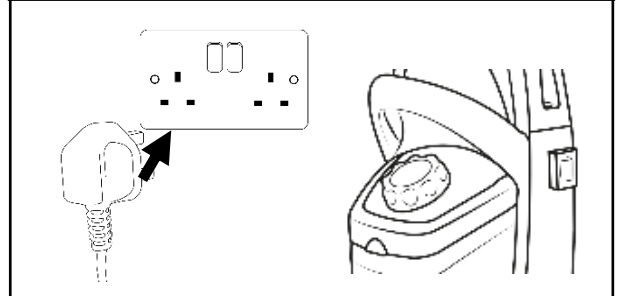

### SUITABLE FOR USE

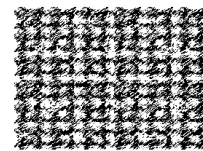

Carpet Only

### WASH FILTERS

Rinse filters with cold water at least once a month

**1**  
MONTH

**REGISTER YOUR  
FREE ADDITIONAL 1  
YEAR GUARANTEE  
TODAY**

# GUARANTEE

At Russell Hobbs, we take all our customer feedback seriously.

Feel free to contact our Customer Services Team who will be more than happy to assist you.

This product is guaranteed for 12 months from the date of the original purchase. If any defect arises due to faulty materials or workmanship, the faulty product must be returned to the place of purchase.

Refund or replacement is at the discretion of the retailer.

The following conditions apply:

- The product must be returned to the retailer with the original proof of purchase.
- The product must be installed and used in accordance with the instructions contained in this instruction guide and any other instructions for use which are supplied.
- It must be used for domestic purposes only and for its intended use.
- This guarantee does not cover wear and tear, damage, misuse or consumable parts.
- This does not affect your statutory rights.

Region	Contact	Website
UK & Northern Ireland	0345 209 7461	mda.russellhobbs.com
Ireland	1 800 938982	ie.mda.russellhobbs.com
Rest of Europe	europe@productcaregroup.com	de.mda.russellhobbs.com fr.mda.russellhobbs.com es.mda.russellhobbs.com it.mda.russellhobbs.com nl.mda.russellhobbs.com

Note your serial number below for future reference

Image for illustration purposes only

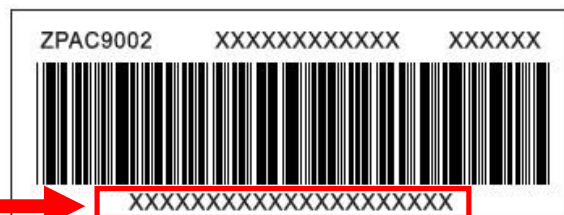

## IMPORTANT SAFETY INSTRUCTIONS

- Do not use as a dry vacuum.
- It is hazardous for anyone other than a competent person to carry out any service or repair operation that involves the removal of a cover which gives protection against exposure to electrical parts.
- Do not remove parts from the appliance such as screws.
- If the supply cord is damaged, it must be replaced by the manufacturer, its service agent or similarly qualified persons in order to avoid a hazard. Do not use with damaged cord or plug.
- This product is intended for household use only. Do not use outdoors.
- This appliance can be used by children aged from 8 years and above and persons with reduced physical, sensory or mental capabilities or lack of experience and knowledge if they have been given supervision or instruction concerning use of the appliance in a safe way and understand the hazards involved. Children should not play with the appliance. Cleaning and user maintenance should not be made by children without supervision.
- Do not direct at people, animals, electrical outlets, or equipment containing electrical components.
- The use of accessory attachments, detergents or cleaning solutions not recommended by the appliance manufacturer may cause fire, electric shock, injury or damage. Use only those as recommended by the manufacturer.
- Descale the product monthly using 50% white vinegar & 50% water solution.
- Do not use in enclosed spaces filled with vapour, such as paint thinner, moth proofing substances, or any flammable or combustible vapours.
- Do not use on leather, wax polished floors, natural wood and/or unsealed floors, and any fabric not recommended for shampoo treatment. If in doubt, consult the flooring manufacturer and test an inconspicuous area.
- Do not store with shampoo or water in the machine.
- Do not immerse in water, such as for cleaning.
- Clean filters at least monthly. Change filter when required.
- Distilled or demineralized water will maximise the performance of the mop.
- Quality testing during manufacture may result in water droplets remaining in the tank. This is normal.
- Always test the machine in an inconspicuous area with the shampoo before using.

# OPERATION

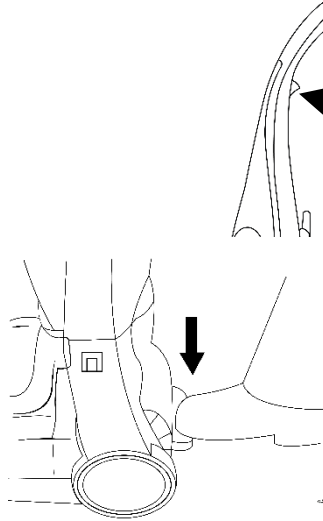
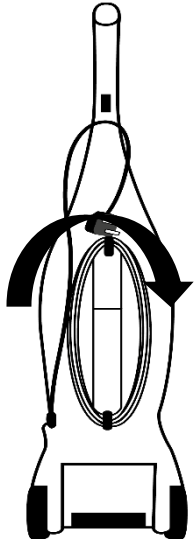

Press to release water & shampoo solution

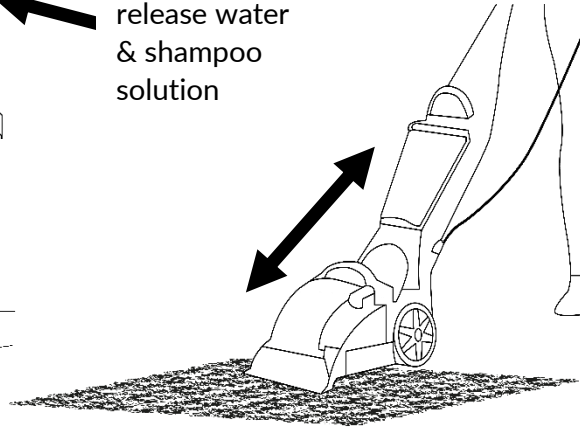

Make 1 pass with trigger pressed, then repeat to collect water.

Multiple passes may be required before carpet is lightly damp.

Allow carpet 4-24 hours to fully dry.

# FILLING THE SHAMPOO

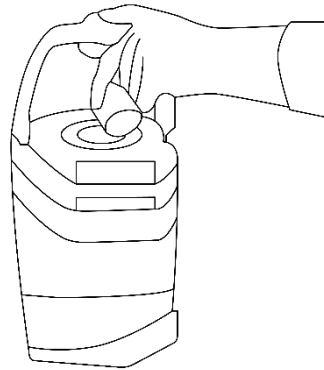
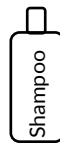
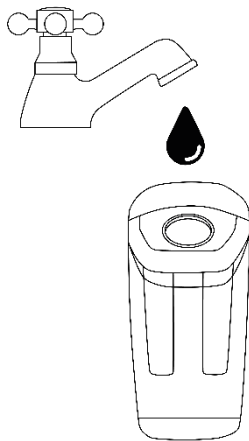
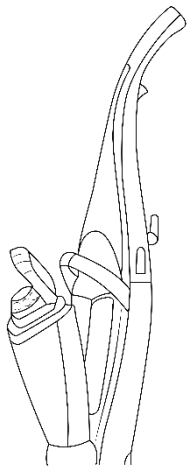

Follow instructions on shampoo label.

Only use Russell Hobbs carpet shampoo.

Do not fill past Max line

# EMPTYING THE DIRTY WATER

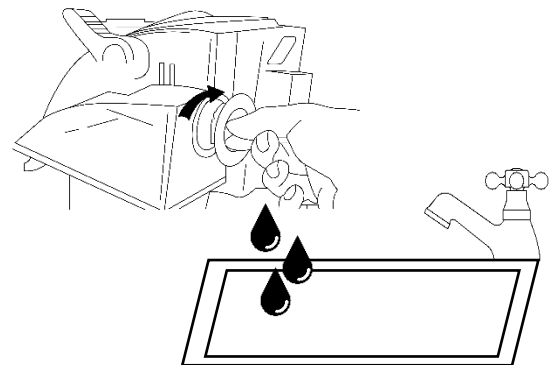
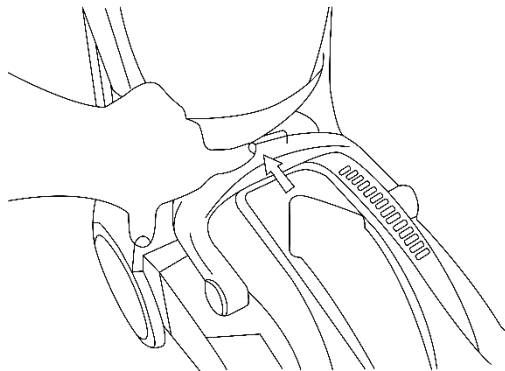
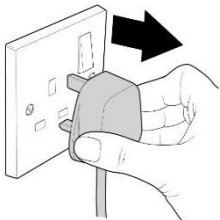

## STORING THE APPLIANCE

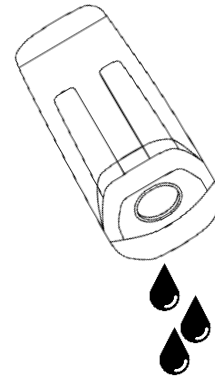
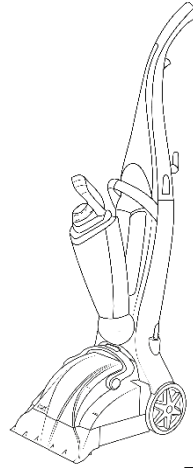
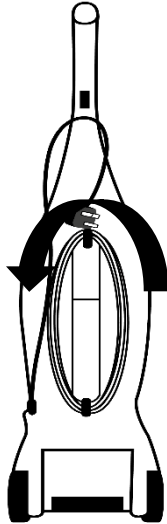
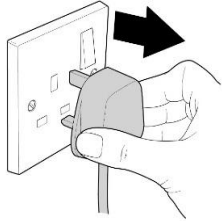

*Empty tanks before storing*

## HELPFUL TIPS

- Vacuum carpet before cleaning
- Remove as much furniture as possible and protect any furniture legs
- Do not over saturate carpets
- Leave to dry for 4-24 hours after use
- Avoid walking on carpet until completely dry
- Heavily soiled areas may require multiple treatments

## WASH FILTERS

Wash the filters with cold water  
at least once a month

**1** MONTH

**REGISTER YOUR FREE  
ADDITIONAL YEAR  
GUARANTEE TODAY**

# IMPORTANT! WASH THE FILTERS

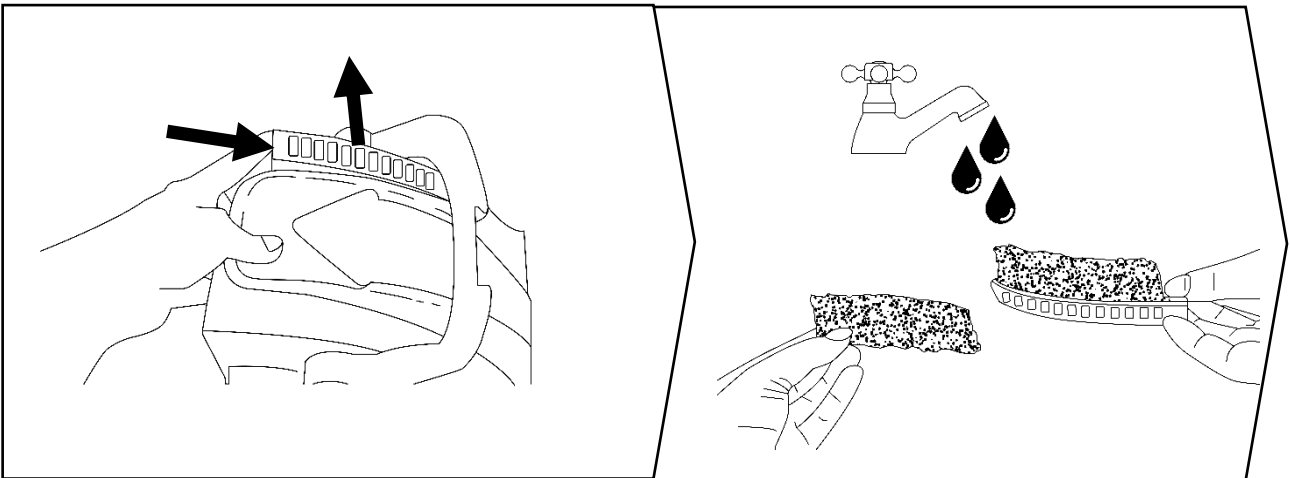
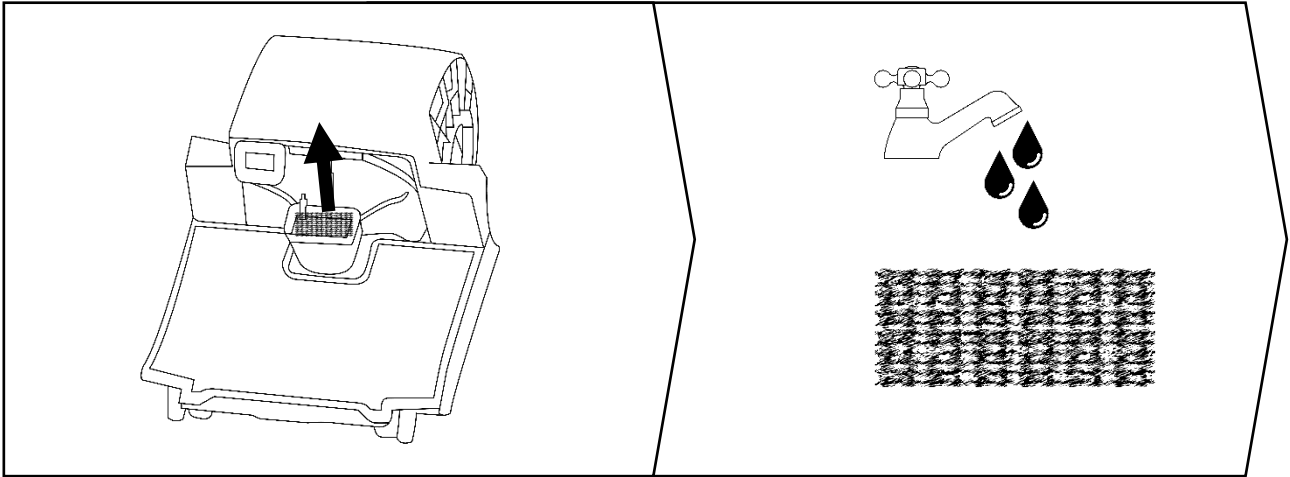

**REGISTER YOUR  
FREE 1 YEAR  
GUARANTEE  
TODAY**

**WASH FILTERS**

Wash the filters with cold water at least once a month

**1**  
MONTH

# IMPORTANT! WASH THE FILTERS

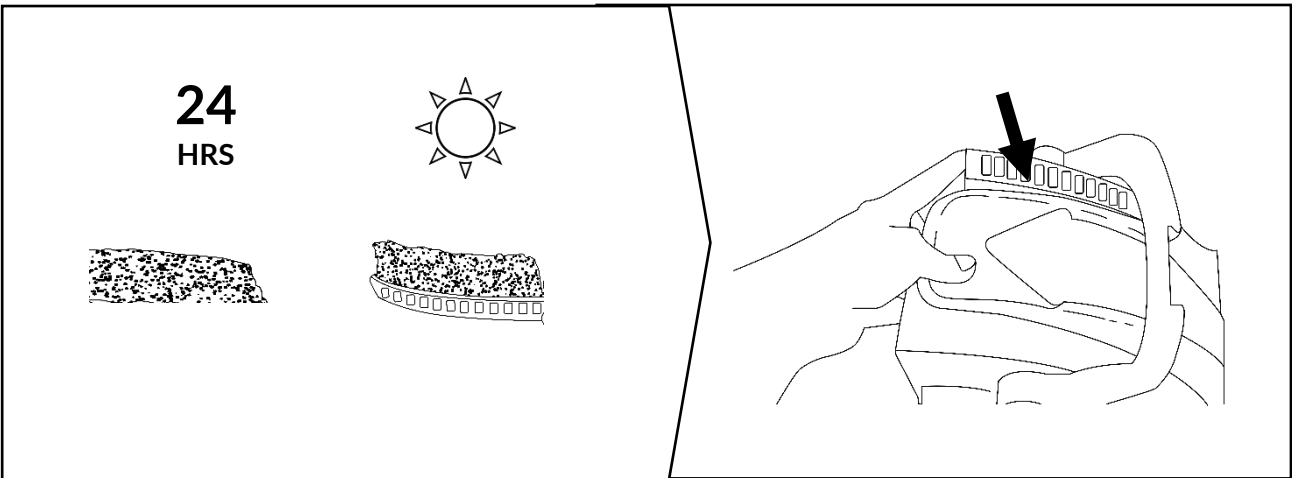
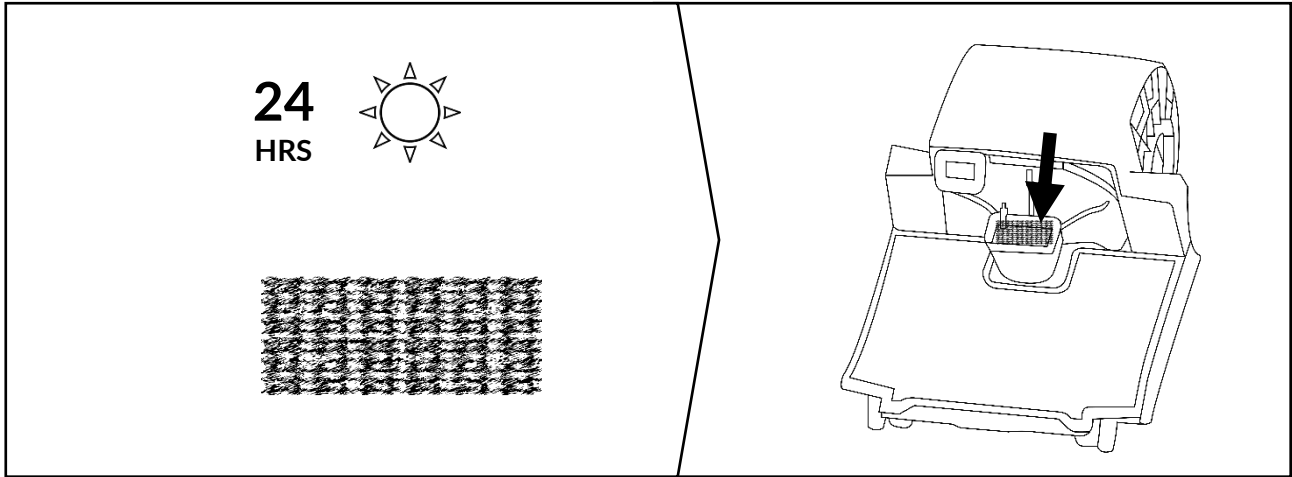

**REGISTER YOUR  
FREE 1 YEAR  
GUARANTEE  
TODAY**

**WASH FILTERS**

Wash the filters with cold water at least once a month

**1  
MONTH**

This appliance is designed to operate from a mains supply of 220-240V~ 50/60Hz. Check that the voltage marked on the product corresponds with your supply voltage.

This product is fitted with a 13A fuse complying with BS1363.

If this plug is unsuitable, damaged or needs to be replaced, contact customer services.

**REGISTER YOUR FREE  
ADDITIONAL YEAR  
GUARANTEE TODAY**

## PROBLEM SOLVING

Reduced water/no water is coming out	<ul style="list-style-type: none"><li>• Check the water tank is filled</li><li>• Check the trigger is pressed</li><li>• Check the appliance is plugged in correctly</li></ul>
The appliance smells	<ul style="list-style-type: none"><li>• Check the tanks are clean</li><li>• Rinse the filters and allow to dry naturally</li><li>• If first time use, new parts heating may cause a smell but this will dissipate quickly</li></ul>
A puddle has formed/the floor is soaking wet	<ul style="list-style-type: none"><li>• Check only official Russell Hobbs shampoo used (please retain bottle)</li><li>• Check water tanks securely attached</li><li>• If still too much water, contact customer services</li></ul>
Parts have broken/need replacement filters	<ul style="list-style-type: none"><li>• Contact customer services</li><li>• Water Tank Filter Part no: G3200100</li><li>• Pre-Motor Filter Part no: G3200213</li></ul>
Stains are not coming up	<ul style="list-style-type: none"><li>• Pre-treat the area by applying Russell Hobbs shampoo neat to a cloth or brush, and very lightly dabbing the area</li><li>• Always test for colour fastness in an inconspicuous area first</li><li>• Professional cleaning may be required</li></ul>

If you are still experiencing difficulties with the appliance please contact us **BEFORE** returning the appliance to the retailer it was purchased from:

**Website:** [mda.russellhobbs.com](http://mda.russellhobbs.com)

**Telephone:** 0345 209 7461

**Address:** Product Care Customer Service, Green Bank Business Park, Hindley Green, Wigan, WN2 4AY

# IMPORTANT!

## WASH FILTERS

Rinse filters with cold water at least once a month

1  
MONTH



This product is guaranteed for 12 months from the date of the original purchase. If any defect arises due to faulty materials or workmanship, the faulty product must be returned to the place of purchase.

By registering your product with us you will get an additional year guarantee free of charge. Further cover can be purchased through the website.

### REGISTER ONLINE

Visit our website to register your full parts and labour guarantee online.

[mda.russellhobbs.com](http://mda.russellhobbs.com)

### REGISTER BY PHONE

Call our friendly Product Care team.

0345 209 7461

# ENERGY CONSUMPTION

## Product information for power consumption and maximum time to reach applicable low power mode

Off mode	Power Consumption (Off Mode)	0W
	Setting and the maximum time need to reach the applicable low power condition	The mains plug is connected to the mains socket and the power dial on the appliance is switched in “O” position.
Standby mode	Power Consumption (Standby)	N/A
	Setting and the maximum time needed to reach the applicable power condition	The appliance does not incorporate a standby mode



# Russell Hobbs

Made by Product Care Trading Limited under license from Spectrum Brands (UK) Limited. Product Care Trading Ltd, Unit 1, Green Bank Business Park, Swan Lane, Hindley Green, Wigan, WN2 4AY, United Kingdom

Product Care (Ireland) Ltd, Unit 3D North Point House, North Point Business Park, New Mallow Road, Cork, T23 AT2P, Ireland. Russell Hobbs is the registered trademark of Spectrum Brands (UK) Ltd.

**UK  
CA**



The 'wheelee bin' symbol is known as the 'Crossed-out wheelee bin Symbol'. When this symbol is marked on a product/batteries, it means that the product/batteries should not be disposed of with your general household waste. Only discard electrical/electronic/battery items in separate collection schemes, which cater for the recovery and recycling of materials contained within. Your co-operation is vital to ensure the success of these schemes and for the protection of the environment. For your nearest disposal facility, visit [www.recycle-more.co.uk](http://www.recycle-more.co.uk) or ask in store for details.

SEDEX – Connecting businesses and their global suppliers to share ethical data and enabling improvement in ethical performance. Visit [www.sedex.org.uk](http://www.sedex.org.uk) for further information.

We reserve the right, due to possible changes to design, to alter the instruction manual without prior notice.