

STEP 1 : Turn Stool assembly (E) upside down on the table.
Attach Backrest (D) by aligning the hole in the bottom of Stool (E).
Use flat washer (A) and a hexagonal nut (B).
And tighten it using the open wrench (C) provided.

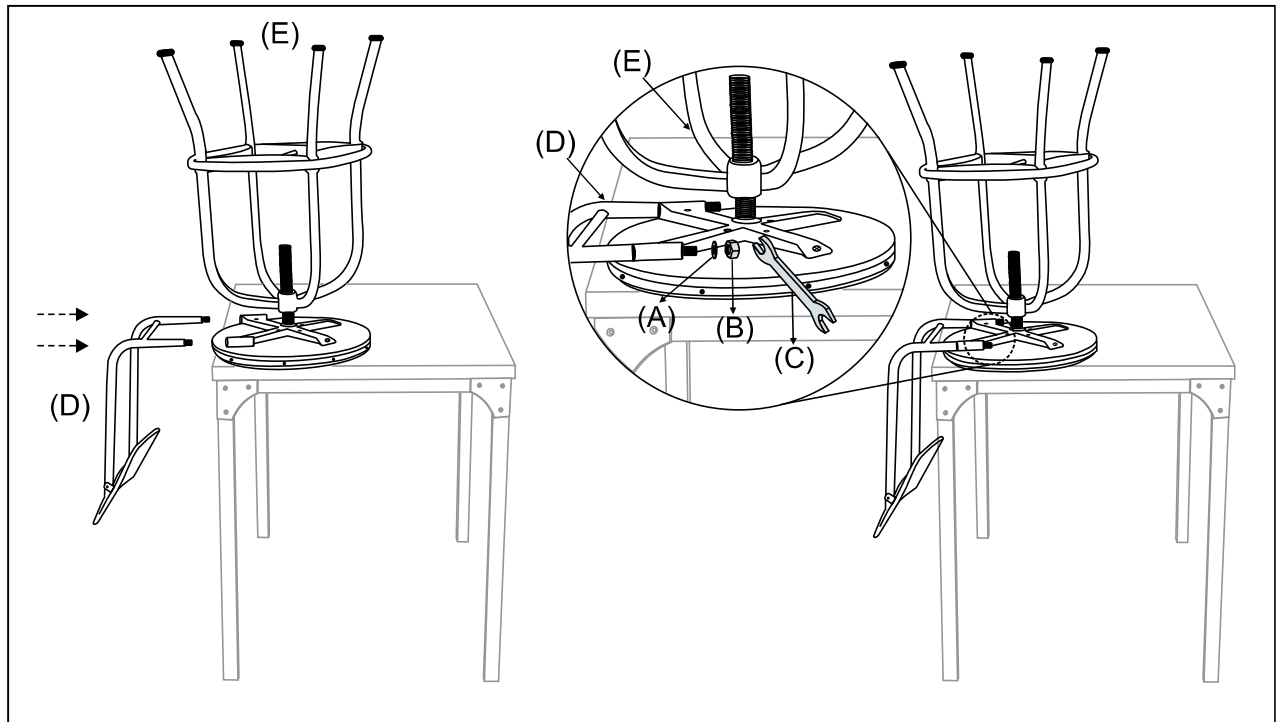

STEP 2: Assembly complete, turn the chair right side up,
Chair is now ready to use.

