

Installation Steps

1. Before installing the permanent lights, please connect each segment of the lights and then power on to confirm if all devices are functioning properly. Note: Connect first, then power on. Do not connect after powering on to avoid a sudden surge of current that may damage the devices.

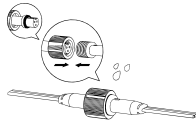

2. Clean the surface of the planned installation area with a cloth or tissue, ensuring it is dry and free from debris. It is recommended to install under the soffit, keeping 2-4 inch from the wall.

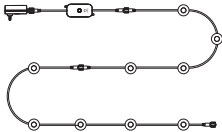
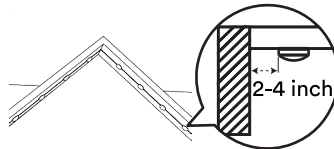

3. Peel off the 3M adhesive on the back of the permanent lights. If the eaves are positioned at a right angle to the wall, use equally spaced fixtures to align the lights tightly against the edge of the fixture, and then press it upwards firmly.

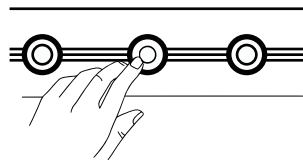
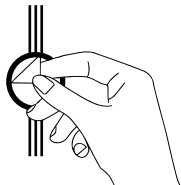

4. After installation, use the steel nail cable clips and back adhesive cable clips provided in the accessory kit for securing. It is recommended to use one steel nail cable clip and one back adhesive cable clip to reinforce every two lights.

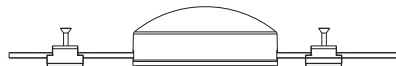

How To Connect Remote Controller?

Step1: Eaves lights completed the Wifi connection.

Step2: Turn off the power supply and turn on again.

Step3: Press the ON/OFF button for 3-5 seconds, until the led lights flashes.

Step4: Press any button to control properly.

Remote Controller Introduction

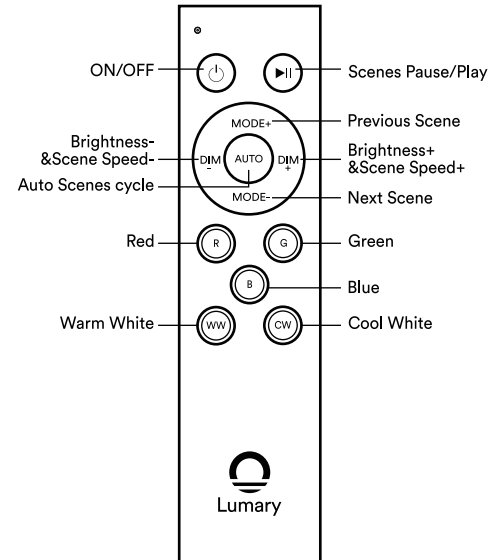

1 inch

2 inch

3 inch

4 inch

5 inch

6 inch

7 inch

Keeping eaves lights 2-4 inches away from the wall

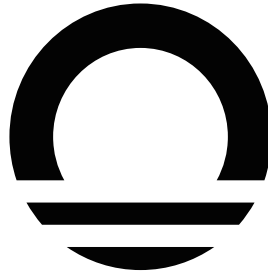

Lumary

Lumary Permanent Outdoor Eaves Lights