

STEPS TO ASSEMBLE THE LAMPSHADE

1



Take out the lampshade and 2 wrought iron frames

Unfold the fabric lampshade

2

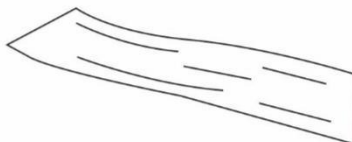

3

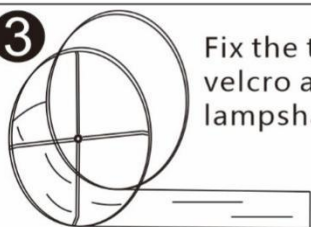

Fix the two frames with velcro along the edge of the lampshade

Mount the harp and install the bulb
(Not included)

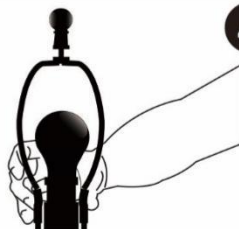

4

5

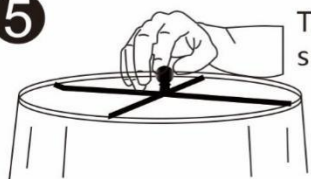

Tighten the finial to secure the lampshade

TABLE LAMP INSTRUCTION MANUAL



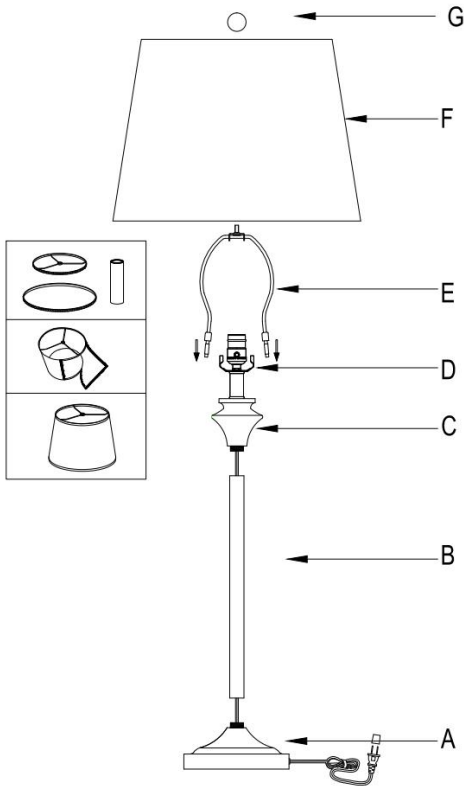

1. Unpack all parts from cartons carefully.
2. Carefully pull-out excess power cord from the lamp base while assembling to prevent the cord from becoming twisted.
3. Tighten the tube(B) into the base(A) until tight.
4. Tighten the lamp socket (C) into the tube(B) until tight.
5. Place the harp(E) onto the saddle(D).
4. Place the shade(F) onto the harp(E).
5. Tighten the finial(G) into the harp(E) until tight.

WIRE CONNECTION DIAGRAM

Wires meeting safety standards are required to connect the electrical circuit

CAUTION: Risk of fire



Please read all instructions carefully. Before you proceed to install, make sure that the power supply is turned off and remains off until installation is completed.

PARTS INCLUDED

Code	Part description	QTY
A	Base	1
B	Tube	1
C	Lamp socket	1
D	Saddle	1
E	Harp	1
F	Shade	1
G	Finial	1