

biquole

Installation Instructions

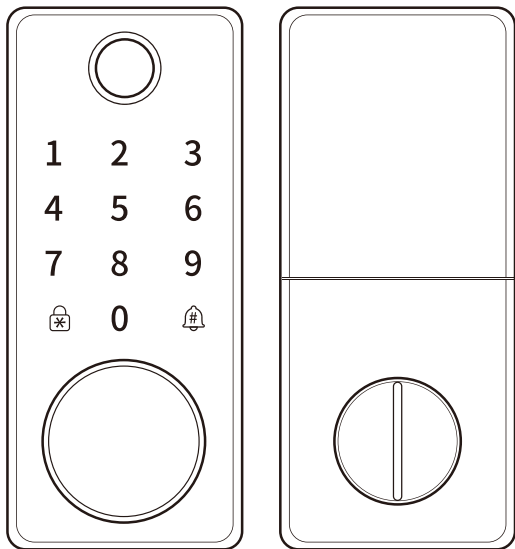

QEK-S03

Email: support_service@biquole.com

Product layout

Back Panel

Battery Cover

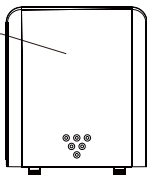

Battery Case

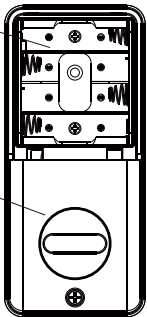

Lock Switch

Front Panel

Fingerprint Scanner

Keyboard

RFID Scanner

Lock Button

Doorbell Button

Cylinder (cover open)

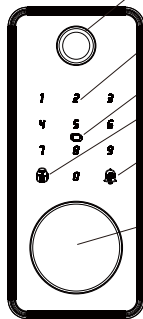

Reset

(Press the reset button 6 seconds, follow the voice signal, reset the lockset succeeded)

Reset Button

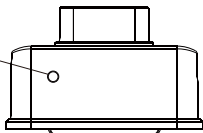

The bottom of front panel

Speaker

Type-C Port

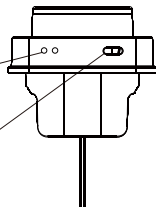

Parts List

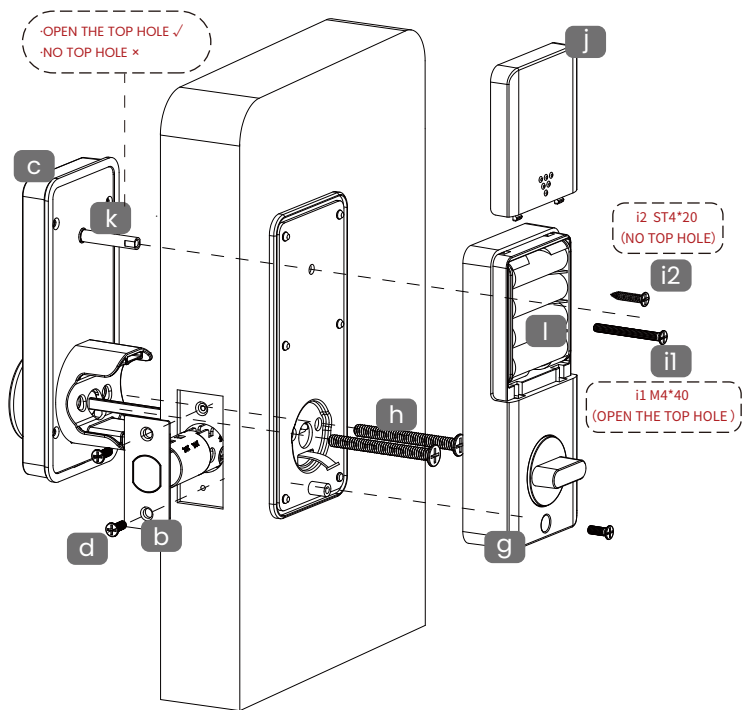

The details of part identification is shown on following page

Parts identification

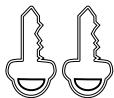

a

key*2

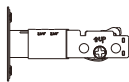

b

Lock Body

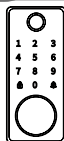

c

Front Panel



d

Lock Body
Mounting Screws*4



e

Buckle Box



f

Strike Plate



g

Back Panel



h

M6×50 Screws*2



i2

i2 ST4*20 (NO TOP HOLE)



k

· OPEN THE TOP HOLE ✓ · NO TOP HOLE ✕
Mounting Stud * 1



il

il M4*40 (OPEN THE TOP HOLE)

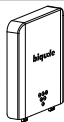

j

Battery box cover



l

4*Battery

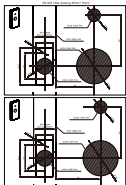

m

Hole Drawing Paper

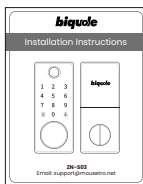

n

User Manual*1



o

IC Card*2



Before Installing the Lock, Check Door Jamb and Door Preparation

Door thickness:
1.38" to 1.97"
(35mm to 50mm)

·OPEN THE TOP HOLE
·or
·NO TOP HOLE

Diameter Of
Front door
Small hole
0.78" (20mm)

Diameter Of
Lockset Front
door hole
2.17" (55mm)

Backset thickness:
2.3" or 2.76"
(60mm or 70mm)

Diameter Of
Lock body hole:
0.98" (25mm)

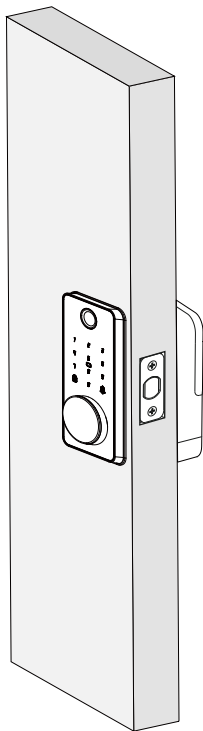

1. Prepare the door and check dimensions

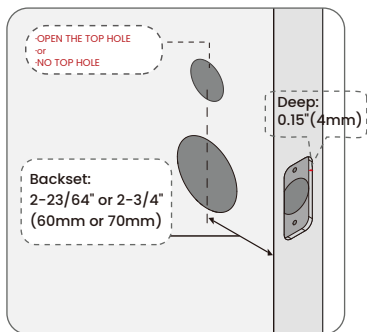
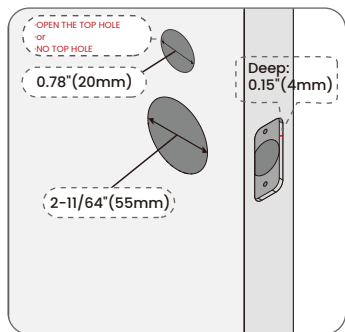

Measure to confirm that the hole in the door is 2-11/64" (55mm)
Measure the small hole on the front door diameter is 20 mm

Measure to confirm that the backset is either

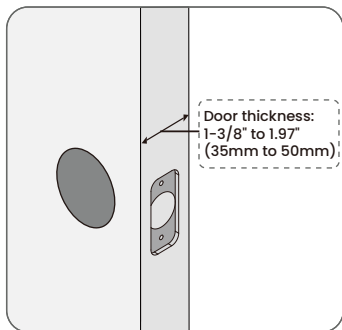
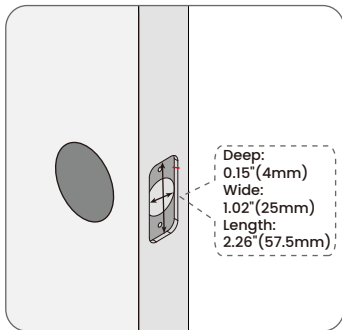

Measure to confirm that the hole in the door is 0.98" (25mm)

Measure to confirm that door thickness is between 1.38" to 1.97" (35mm to 50mm)

2. open the strike hole, deep 26.2 mm , and install it with screw

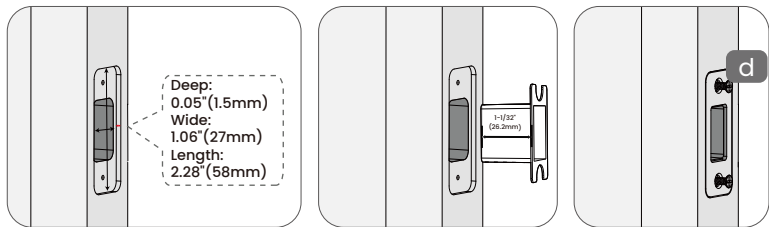

3. Install the Lock Body

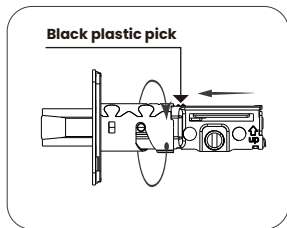
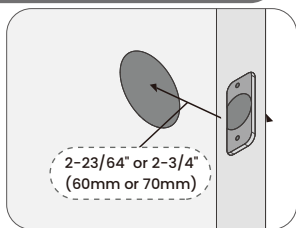

The lock body can rotate to lengths of 2-23/64" or 2-3/4" (60mm or 70mm). Please choose according to the length of the door panel opening

Open the black plastic pick of the lock cylinder to pop out the lock tongue, and rotate the lock cylinder to adjust the size.

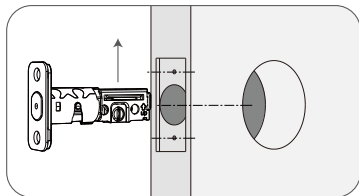

Make sure the UP side is facing up and the bolt is closed before installing it into the door opening.

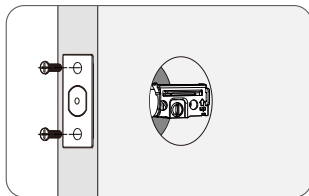

Install the lock body into the door panel
Use Lock Body Mounting Screws*2

4. install the mounting stud

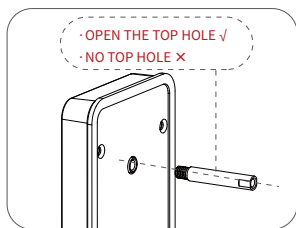

install the mounting stud

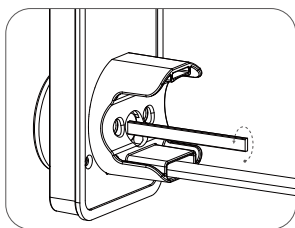

5. Install the Front Panel

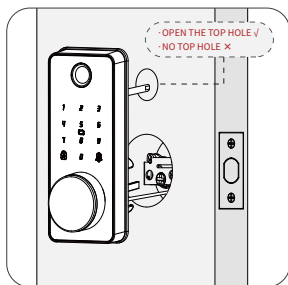

Thread the cable under the lock body

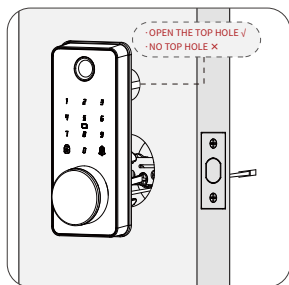

Keep the locking bar vertical when installing

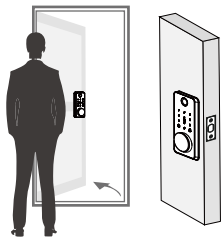

Make the panel close to the door surface

6. Install the Back mounting plate

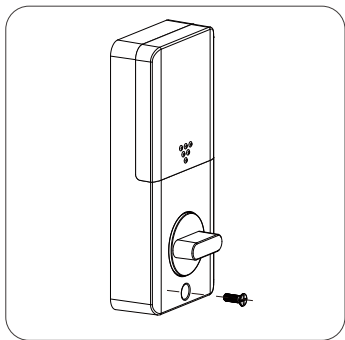

unscrew the back panel screw,
Remove the back panel parts

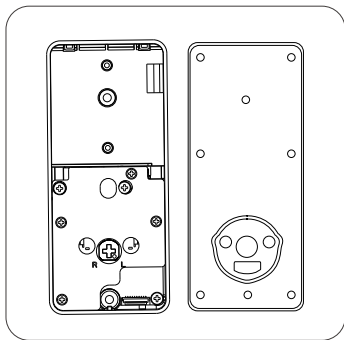

Remove the mounting plate

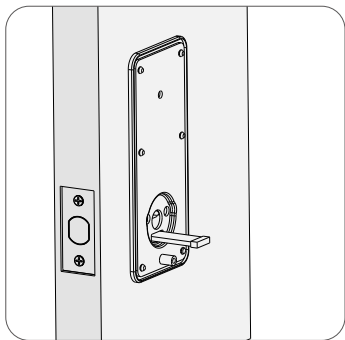

place the cable like
this in the mounting plate

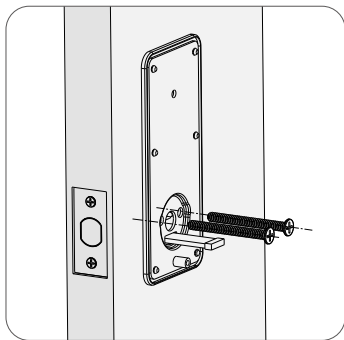

Secure the mounting
plate with the supplied screws

7. According to your actual door open direction to adjust the knob dot direction

Left opening Way door



The Back panel knob adjusted to horizontal

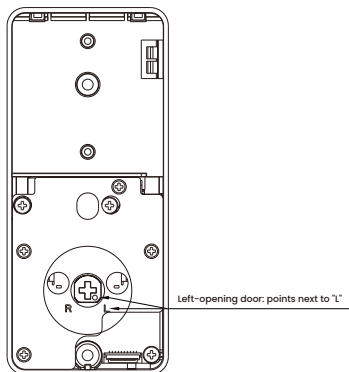
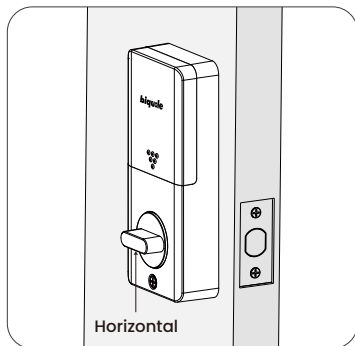

7. According to your actual door open direction to adjust the knob dot direction

Right opening Way door



The Back panel knob adjusted to Vertical

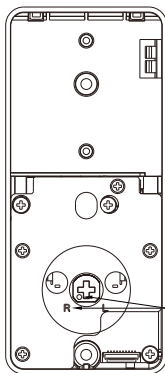
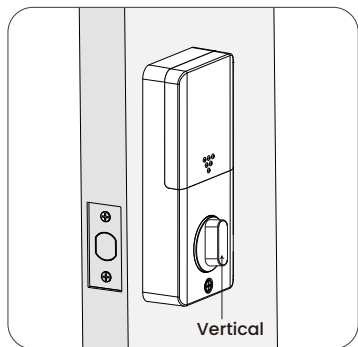

Right-opening door: points next to "R"

8. Install the Back Panel

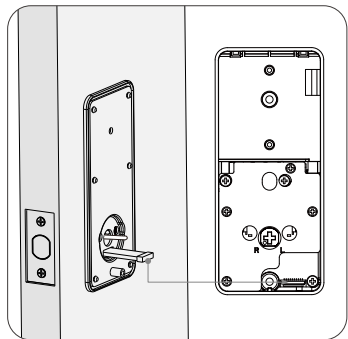

Connect the main cable

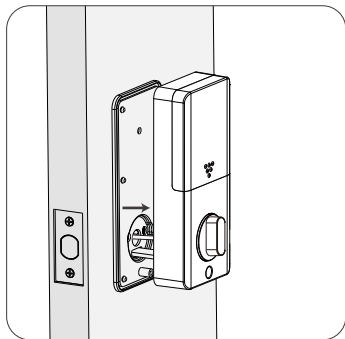

Insert the Back panel with direction of correspondence

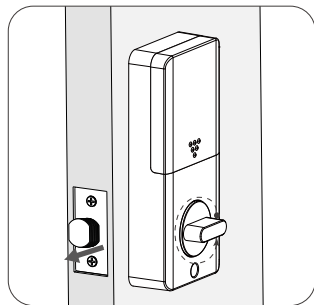

Test: Can the switch rotate to open the door?
If can't, the direction of the knob is incorrect, return to step last step to adjust the direction

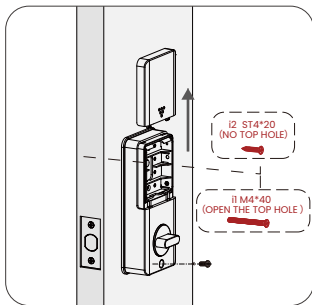

Install the screws



9. Install the battery

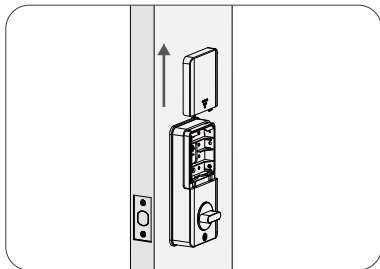

Push upwards to open the battery cover

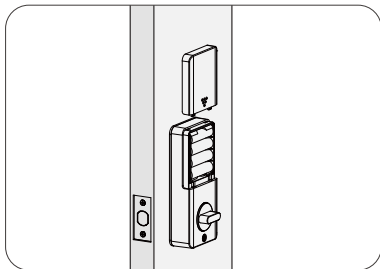

Install 4 batteries in the battery compartment

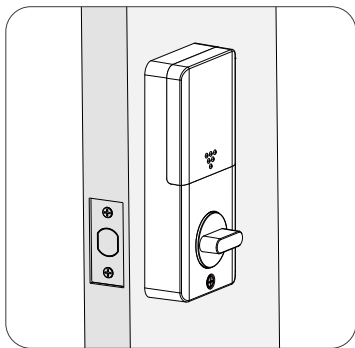

install the battery cover



Then download the app,
set your lockset in your phone



Smart life

biquole

Programming Instructions

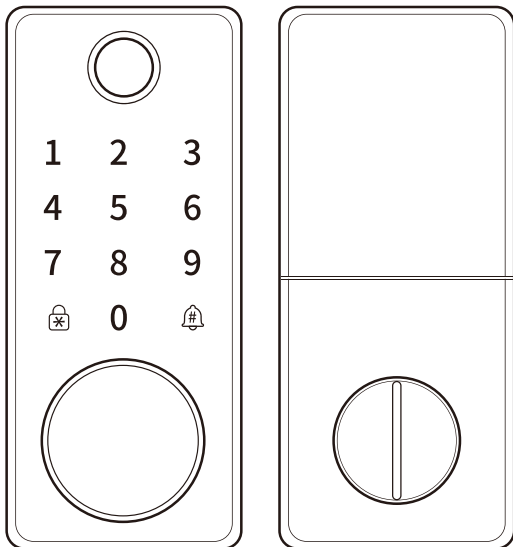

QEK-S03

Email: support_service@biquole.com

Function

1. Doorbell press the bell button, will get Dingdone sound
2. Mechanical Key Unlock
3. Ic Card Unlock
4. App Unlock - Buletooth Contecting
5. Password Unlock (Forever or Temporary)
6. Fingerprint unlock
7. Auto-Lock & Auto-lock trouble warning

Reset

master right, clean all code and data

Reset
Button

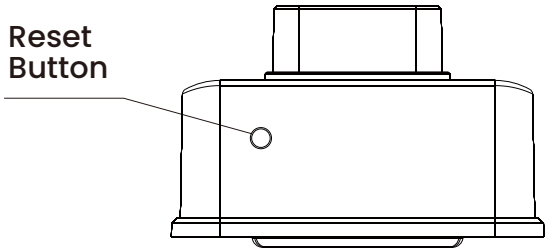

Anti- Peeking Password

Random numbers (up to 12 digits) can be added before and after the correct password to ensure security and prevent peeping.

Real Password

Random Digits

364794

Random Digits

Bluetooth Conctection

1

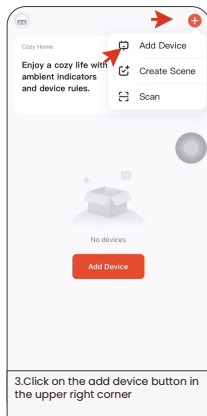
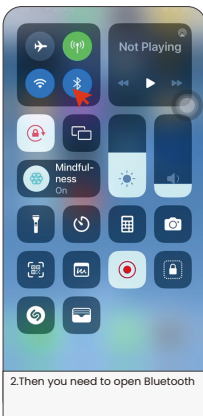
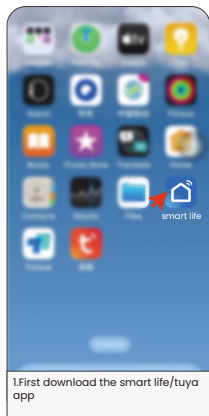

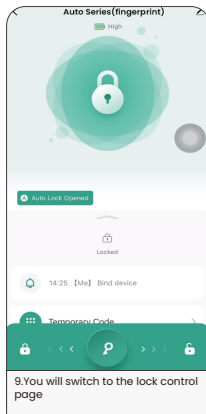
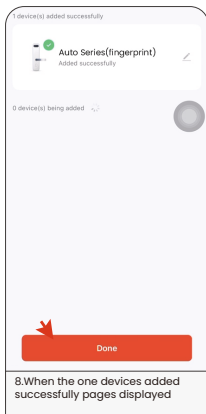
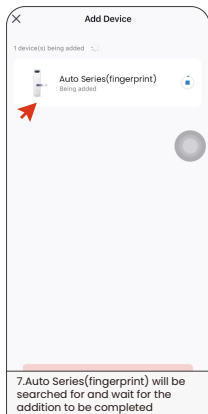
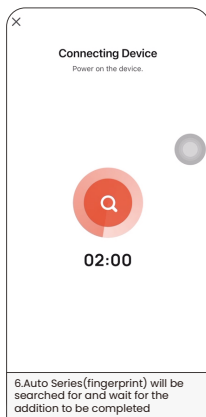
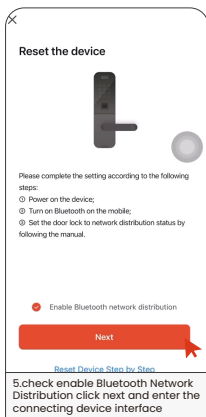
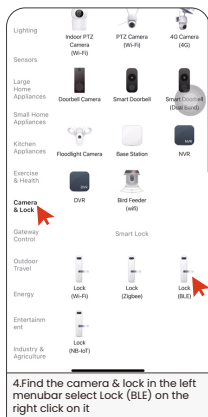

More

(After connecting, modify the "Left On" first)

- Adjust door opening direction
- Auto-lock
- Auto Lock Delay
- Lock Volume

Left door opening



Left Opening:
"Special Function" -- "Left on"

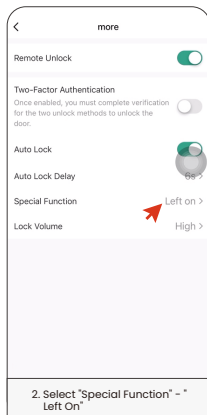
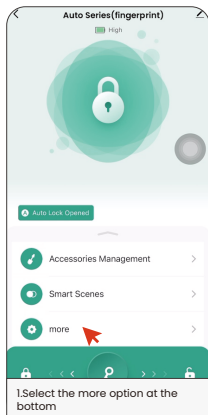

More

(After connecting, modify the "Right On" first)

- Adjust door opening direction
- Auto-lock
- Auto Lock Delay
- Lock Volume

Right door opening



Right Opening:
"Special Function"--"Right on"

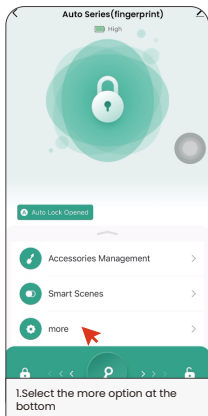

1. Select the more option at the bottom

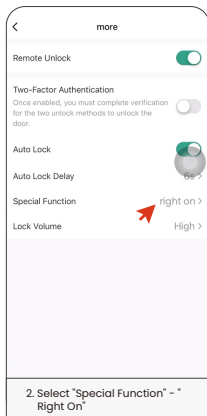

2. Select "Special Function" -- "Right On"

Member Management

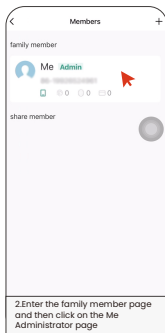
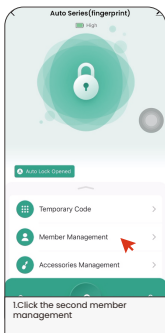

Password

- Long press any from 2 to 9 to wake up the lock screen. After entering the password, press "#" to confirm.
- if you press wrong word, just stop and wait the screen light go out then Re-enter password, press #.
- Screenshot before you save the password, or you can not check it any more

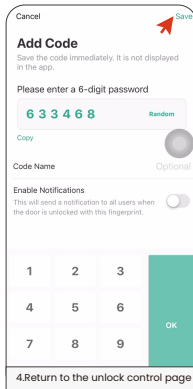
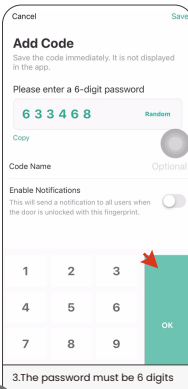
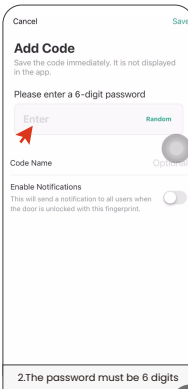
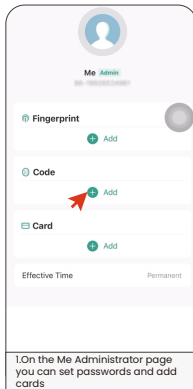

Card

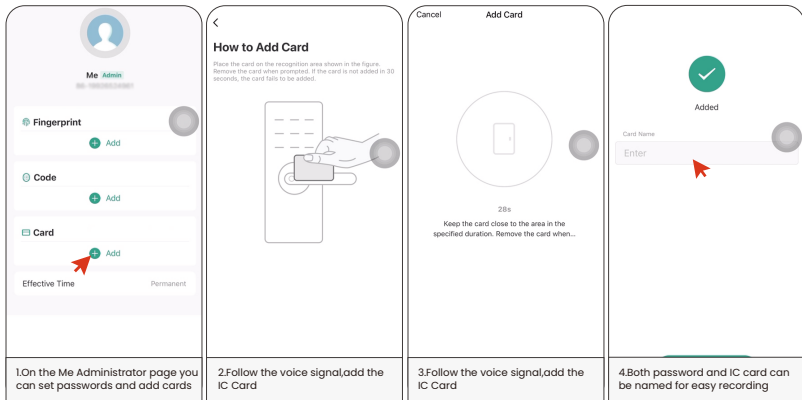

Temporary Code

· Choose the code type you need, enter your password and screenshot, adjust the effective time, expiration time, name code, repeat weekly or not, finally save it.

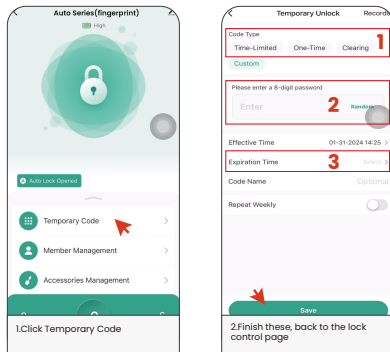

· The code can not be six same numbers or consecutive number
Screenshot before you save the password, or you can not check it any more

Add Member

- Tip 1.invitation code work in 3 days, then the code will be unvalued.
- Tip 2.Administrator has the right to add password/card/Common Member / and delete them, the user can not.

1

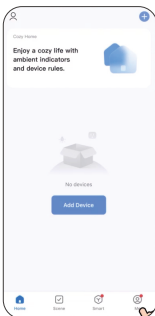

2

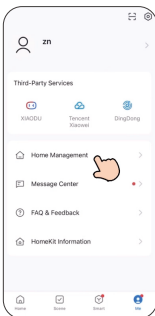

3

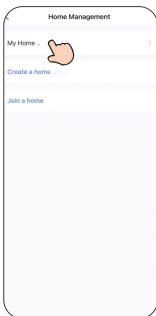

4

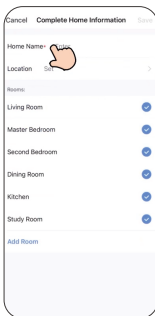

5

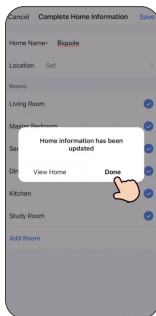

6

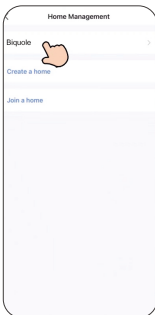

7

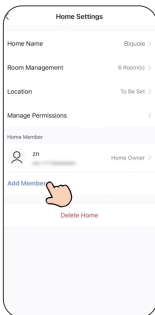

8

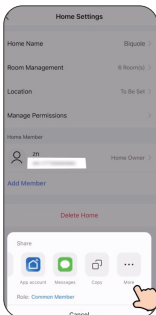

Add Member

- Tip 1.invitation code work in 3 days, then the code will be unvalued.
- Tip 2.Administrator has the right to add password/card/Common Member / and delete them, the user can not.

Administrator / Common Member

9

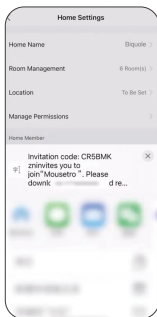

10

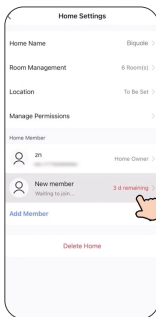

11

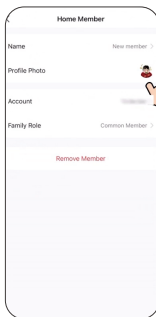

12

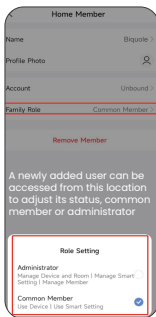

13

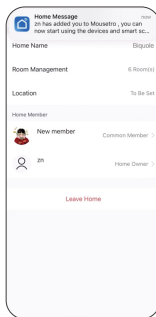

Invitee

9-1

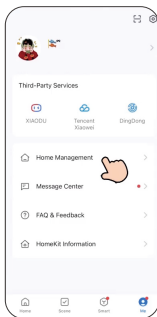

9-2

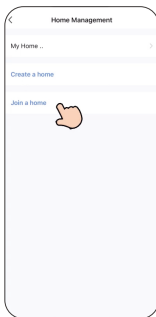

9-3

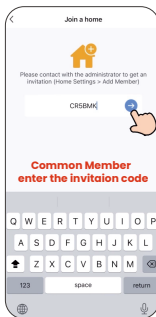

9-4

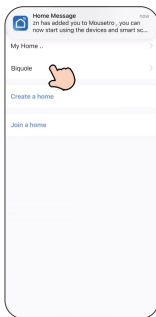

9-5

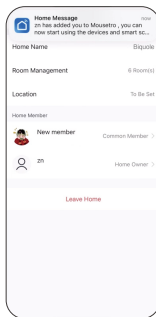

1 Installation

Questions	Answers
After installing the door lock, the knob cannot be turned	<ol style="list-style-type: none">1. Confirm that the "top" of the Lock Body is on top.2. Confirm that the Locking Bar on the Front Panel is inserted vertically.3. Distinguish your left and right doors (refer to the manual), confirm the left and right doors, check the knob on the Back Panel, adjust the left door to horizontal and the right door to vertical.
How to troubleshoot whether the left and right doors are installed upside down?	Firstly, confirm whether the back panel knob can rotate normally without power. If it can rotate normally, but the voice broadcast is still the opposite, then change the left and right on the APP. ("more" - "Special Function")
APP voice is opposite to actual commands	<ol style="list-style-type: none">1. Check if the knob direction on the back panel is correct, adjust the left door to horizontal and the right door to vertical. (Distinguish between left and right doors for viewing videos / manuals)2. Check the Special Function settings of the mobile app. The left door needs to be switched to the left, and the right door needs to be switched to the right door (on the homepage menu bar page, change "more" - "Special Function")

2 APP Setting

Questions	Answers
How to wake up the screen of the smart lock?	Long press any number from 2 to 9 to wake up the screen.
Unable to search for Bluetooth devices	1. Check if Bluetooth is turned on 2. Press and hold the reset button at the bottom of the back panel for 6 seconds, and hear a beep for 6 seconds, indicating successful reset.
After setting an 6-digit password on the mobile app, the actual unlocking did not respond	When actually unlocking, after entering the 6-digit password, you need to press "#" to confirm and successfully unlock.
Why does my password expire?	Check if the password you have set is a temporary password or an administrator password. Temporary passwords have a time limit, while administrator passwords have no restrictions.
Can the password be set to 4 or 6 digits?	No, our password must be 6 digits.
How to turn off auto-lock?	The last option in the menu bar of the smart lock control page is "more" - "Auto Lock". Simply close it.
How to modify the time of auto lock door.	The last option in the menu bar of the smart lock control page is "more" - "Auto Lock Delay". Just modify the time. (Note that we can only modify it to a maximum of 180s)
Can it be remotely controlled?	We need to match the gateway sold in our store to achieve remote control.

3 Member settings

Questions	Answers
How to add fingerprints, passwords, and IC cards for common member?	Common member cannot add fingerprints and passwords on their mobile phones. They can only add fingerprints and passwords to common member through member management on the administrator's mobile phone.
Why can't my family find this Bluetooth?	Once being searched and connected by the administrator, no one else can find the Bluetooth. Unless you add this member to your home management, they can share all devices.
I have already connected it, how can my wife quickly connect to the smart lock.	The simplest way to quickly connect is to log in with same account. (Note: Family members' accounts have been registered in the same app)
Can multiple people connect to Bluetooth together?	Bluetooth can only connect to one phone at a time.