

Technical drawing of a wooden bunk bed with dimensions. The drawing shows a side view of the bed, including the upper and lower bunks, a ladder, and a storage drawer. Dimensions are provided in inches.

Dimensions:

- Overall width: 59"
- Overall length: 103 1/4"
- Upper bunk length: 74 3/4"
- Upper bunk width: 15 3/4"
- Upper bunk height: 15 1/4"
- Upper bunk depth: 38"
- Upper bunk width (inner): 51 1/4"
- Upper bunk width (outer): 53 1/4"
- Upper bunk height (inner): 15 1/4"
- Upper bunk height (outer): 10 3/4"
- Upper bunk depth (inner): 37 3/4"
- Upper bunk depth (outer): 30"
- Upper bunk width (inner): 3 1/2"
- Upper bunk width (outer): 25"
- Upper bunk height (inner): 13"
- Upper bunk height (outer): 13"
- Upper bunk depth (inner): 13"
- Upper bunk depth (outer): 13"
- Upper bunk width (inner): 54 3/4"
- Upper bunk width (outer): 9"
- Upper bunk height (inner): 66 1/2"
- Upper bunk height (outer): 69 1/2"

A diagram of a rectangular box. The front face is a rectangle with a width of 9 inches and a height of 66 1/2 inches. The depth of the box is 9 inches. The top edge of the box is labeled 9". The right edge of the box is labeled 66 1/2". The bottom edge of the box is labeled 9".

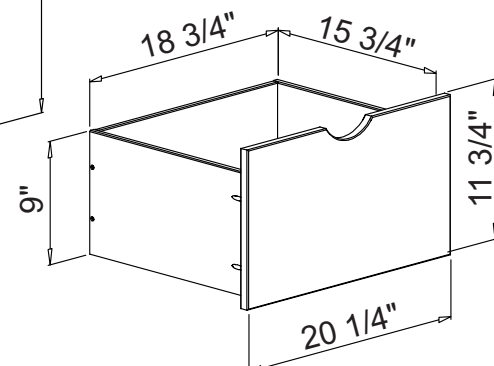

This is a natural wood product. We cannot guarantee the sizes on this drawing are the exact measurements of the bed you will receive. The dimensions are provided as a guide to assist you with your purchase. Please ensure the bed will fit your room.