

SCREWS x2



WALL PLUG x2

Included Hardware



STEP 1:

Determine the distance between the two hanging hardware by using a measuring tool.



STEP 2:

Create hole at the location you marked previously using a drill.



STEP 3:

Tap the wall plug into the hole using a hammer.



STEP 4:

Fasten the screw into the wall plug and use a screwdriver to ensure it is tightly secured.

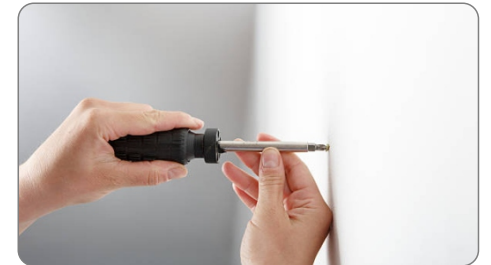

STEP 5:

Position the sawtooth on top of the screw.



“ There you go! Your medallion has been installed and is now firmly secured! ”