

Limited Warranty Information

Thank you for choosing a Hi-Line product! We strive to bring the best home and garden decor products for our customer from across the world. Our exclusive designs and systematic approach to make your home a wonderland for you! In the event that we have not achieved our usual standard of excellence, we will repair or replace, at our discretion, within the warranty period. A valid proof of purchase, with the purchase date clearly indicated, must be provided. Photos of defective merchandise will also be required to help distinguish the actual cause of the defect. Please read below for a detailed description of warranty coverage.

• Procedure/Service

Should a warranty/claim be needed, you should contact the retailer from whom you purchased the product. If that is not an option, you can contact Hi-Line Gift Ltd at www.hilinegift.com. When contacting Hi-Line Gift Ltd, you must be prepared to show proof of purchase, provide photographs and any other information needed to validate your claim. This may be necessary to distinguish between a partial or complete replacement of a defective product.

The warranty does not cover any items with multiple parts; the warranty will ONLY cover the individual component of the unit/item that may be defective. Replacement parts can be made available to a consumer through the original selling party, or an approved parts retailer. If this is not an option, contact our customer service department. Item is covered under one year limited warranty from the date of purchase. If your purchase was after our 30-day grace period, payment information will be requested for shipping charges.

• Return / Damage Claim Instructions

⚠ **Do not discard the box / original packaging.**
The item must be returned in the original box, otherwise your return will not be accepted.

⚠ **Take a photo of the box markings.**
In case a part is needed for replacement, a photo of the markings (text) on the box is required to identify the item number and ensure you receive the correct parts.

⚠ **Take a photo of the damaged part if (applicable).**
A photo of the damage is always required to file a claim and get your replacement of refund processed quickly. Please make sure you have the box even if it is damaged.

⚠ **Send us an email with the Images required.**
Email us directly from marketplace where your item was purchased with the attached images and a description of your claim.

• Not Covered Under Warranty

The limited warranty will NOT cover cases of damages due to

1. Inadequate care and/or neglect
2. Environmental and/or natural elements
3. Improper Installation/use and/or Maintenance

This warranty also does not cover any additional charges or installation, removal, disposal and/or shipping costs or consequential damage associated with any warranty claim.

Owner's Manual

Item # 37402-160



HI-LINE GIFT LTD.



**Have Questions or Issues?
Need help with assembly?
Contact us via email or phone.**

(For faster assistance, please include PO#, PO Date, and Buyer Name in your email.)

Email: support@hilinegift.com

Website: www.hilinegift.com

Call: 1-800-868-9176 (US) 905-564-2815 (Canada)

Before you start

- Please read this instruction before use of this product.
- Decide on an appropriate location for your product:
 - 1) Please refer to the cable label affixed to the product to establish its positioning suitability.
 - 2) Do not position or place near heaters or any other direct sources of heat.
- Keep pets, babies and children away from all small parts and components of this product as they potentially pose a serious choking hazard.
- Please keep this instruction manual for future reference.

Product assembly

| PARTS | QTY |
|-----------|----------|
| 6 ft tree | 8 pieces |
| Base | 1 piece |

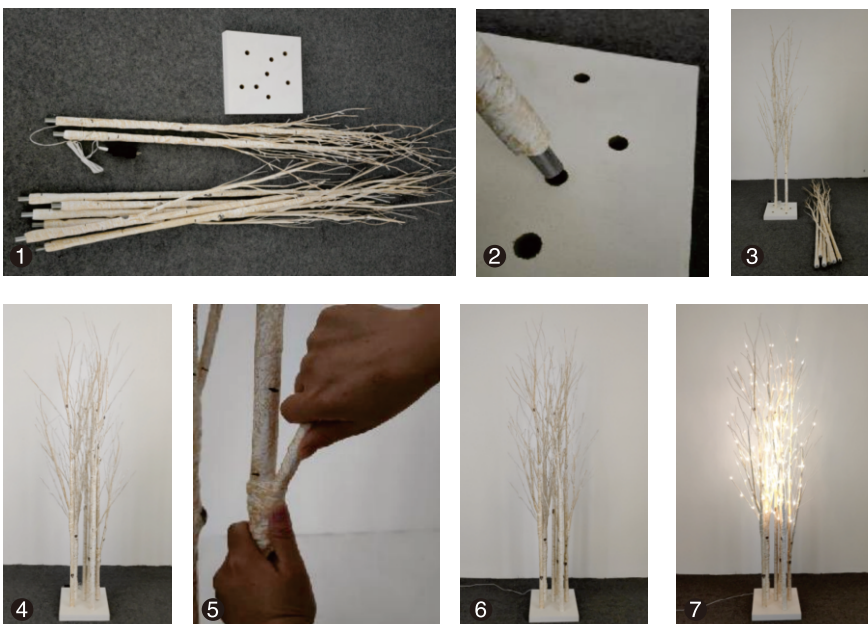

- Check that you have all pieces and parts before continuing.
- Attach the bottom tree section to the base of the tree by screwing the section into the base in a clockwise direction.
- The branches of the tree are wired and can be manipulated for their shaping. To do this lightly grip the branch at its thickest end and manipulate the branches to the desired look.
- You may now plug the tree into the power supply and stand back and admire your efforts.

SAFETY INSTRUCTIONS

Always isolate the power before commencing installation, repair or maintenance. If in doubt about the installation, repair or maintenance, consult a qualified electrician or contact your retail outlet.

Always tighten the terminal's screws firmly, especially the attachment for low voltage wiring if applicable.

Observe the correct color of the wiring before installation: blue (N), brown or black (L), yellow green (Earth.) If the luminaire is mounted on a metal surface, this surface must be connected to the protective earth conductor or the equipotential bonding conductor of the installation.

If you want to dim the luminaire (if there is no dimming device installed) please be sure you use the right type of dimming device. In doubt always consult a qualified electrician or contact your local retail outlet. The manufacturer cannot be held responsible in case of usage of a-wrong type of dimming device.

If the luminaire is mounted onto a ceiling-box or wall-box, it is obligated to cover the box with a lid first. In case that the luminaire is not mounted directly under the ceiling-box, be sure to use a solid fixing hook. If in doubt about the fixing hook, or which patch to use, consult a qualified electrician or contact your retail outlet. Always observe all the technical specifications of the luminaire.

WARNINGS

- It is very important that this product is NEVER DIRECTLY connected to the mains supply without the supplied transformer.
- Keep away from children & pets.
- Do not operate this item whilst still in the packaging.
- The LED lamps are not replaceable.
- The transformer is suitable for indoor use ONLY.
- Do not try to connect this set electrically to another set.
- If there is any damage or breakage to the electric wire, please dispose of safely.
- Ensure that cables are fully unwound and sited where they will not become damaged or present a tripping hazard.
- Do not secure the wiring of this product with staples or nails.
- Do not close doors or windows on the product, as this may damage the wiring insulation.
- Do not submerge this product in water (e.g. puddles, guttering or ponds)
- Do not overload wall sockets. Use different sockets around the house to plug in multiple lights to balance the load.
- Do not damage the insulation of cable or LED holder.
- Do not lay the cable under carpet or where it can be damaged.
- Do not completely cover the LED with decorations & other flammable materials. Ensure adequate airflow around each LED.



HI-LINE GIFT LTD.



Scan for assembly video