

# 60" REEDLEY COPPER DOUBLE ROLL TOP TUB

Cat. No.  
COTDRN61K



L: 59-7/8"  
W: 31-3/4"  
H: 26-3/8"

Rim: 3"  
Water depth: 20" to top of tub

**The following is recommended for  
COTDRN61K tubs without faucet holes:**

- Faucet: part# 4602, 4604 or 7082
- Freestanding bath supplies: part# 4502
- Leg tub drain: Part# 5599LT or 5599TS



Overflow can be drilled.  
With overflow drilled this tub  
requires drain **5599E**.  
**Tubs that have been  
drilled with overflow are  
"special order" and  
are not returnable.**

Gallon Capacity: 65  
Shipping Weight: 325 lbs.  
Empty Weight: 100 lbs.  
Filled Weight: 643 lbs.

## Features:

- ▶ Made of 16 gauge copper  
(Copper is a living finish and will patina over time)
- ▶ Hammered antique copper inside and out
- ▶ Hand polished
- ▶ No overflow
- ▶ Double roll top with tap deck
- ▶ Includes base
- ▶ No faucet holes
- ▶ Tub is thoroughly inspected before shipment

## Tub Finishes:

**AC** Hammered Antique Copper

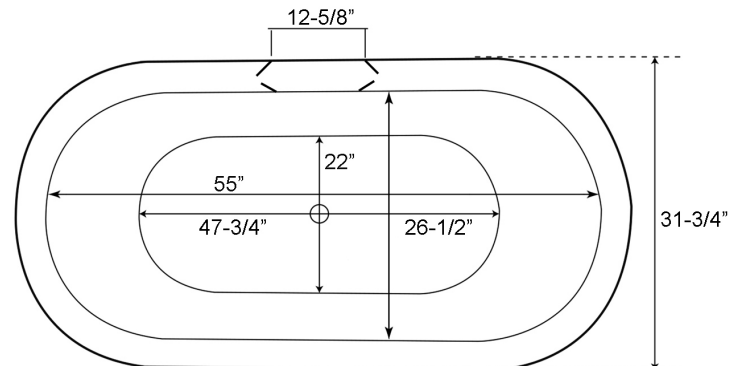
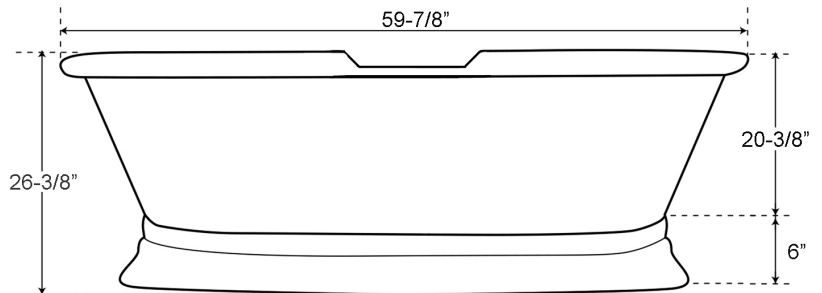

Dimensions and specifications subject to change without notice.

09/12/2018

P 847•244•1234

www.barclayproducts.com