

CATALOG NUMBER	TYPE
PROJECT	

LARC SPOT – LOW VOLTAGE TRACK HEAD

SERIES 316L

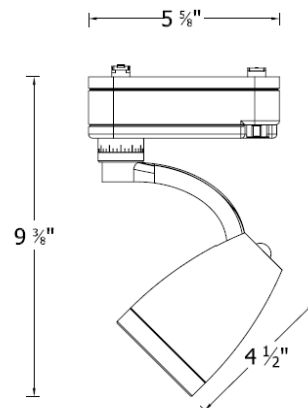
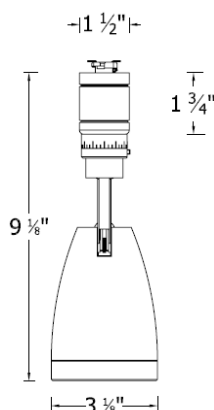

Ordering Matrix

Model	Finish
<input type="text"/>	<input type="text"/>
JHT-316L	BK = Black WT = White PT = Platinum

Ordering Example (*model – finish*): JHT-316L-WT

Product Details

Description:	Low voltage track head using MR16 lamps. Designed for use with WAC and W2 J & J2 series track. Adaptable to other manufacturer's track. (Consult factory for specific brands).
Materials:	Die-cast aluminum fixture, cap ring and check ring. Clear 1/8 inch tempered glass lens included.
Transformer:	Electronic transformer with auto reset, soft start, and short circuit protection.
Socket:	Ceramic bi-pin socket.
Aiming:	350° horizontal rotation and 90° vertical aiming with indexing scales. Spring loaded buttons lock to secure the aiming adjustment on horizontal and vertical axis.
Lamping:	Re-lamps from the front using 12V MR16 lamps, 75W maximum. Lamp not included.
Finish:	Powder coat paint finish. Available in Black (BK), White (WT), Platinum (PT).
Listing:	UL & CUL Listed. Patent Pending.

Specification Features

- Die-cast aluminum fixture with integral indexing scales to assure precise directional adjustment.
- Threaded check ring within lens cap allows 2 captive accessories to be held securely.
- Electronic transformer soft start feature is designed to prolong lamp life.
- The 316L track head utilizes the second circuit on the J2 style track with the use of the JCLIP.
- Accommodates up to 2 lenses and one accessory.
- 5 year product warranty.

Track Adaptor Information

Standard Adaptor
For J style
W2 & WAC track



J2 Adaptor
For J2 style
W2 & WAC track



JCLIP
Ordered when using track
heads on 2nd circuit of J2



Compatible Accessories

LENS-20-DIC-COLOR
Dichroic Lenses

LENS-20-COLOR
Color Lenses

AMB = Amber ; BLU = Blue ; GRN = Green
RED = Red ; YEL = Yellow



LENS-20-HCL
Honeycomb Louver



LENS-20-CRL
Cross Louver



HOOD-065-BK
Light Deflecting Hood
for wall wash application

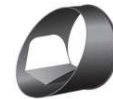

LENS-20-UVF
UV Filter

LENS-20-FR
Frosted Lens

LENS-20-SPR
Spread Lens

LENS20-BEL
Beam Elongating Lens

Photometry

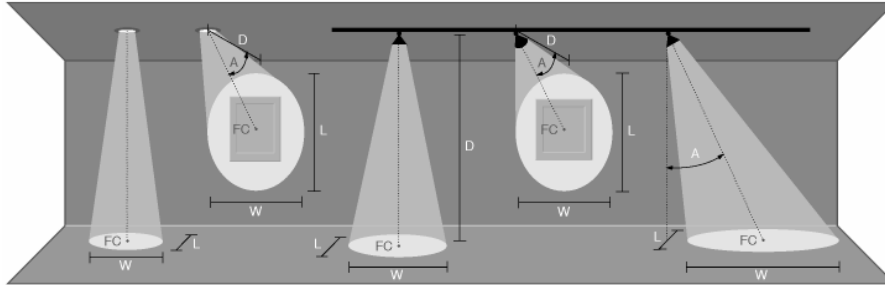

D Distance To Fixture From Wall Or Floor
FC Initial Footcandle Level At Center Of Beam
L Beam Length (where candlepower drops to 50% of maximum)
W Beam Width (where candlepower drops to 50% of maximum)

50W MR16 N (15 DEG)				
0° Aiming Angle				
D(ft)	FC	W	L	
6	283	1.6	1.6	
9	126	2.4	2.4	
12	71	3.2	3.2	
15	45	3.9	3.9	
45° Aiming Angle				
D(ft)	FC	W	L	
6	100	3.2	2.2	
9	45	4.8	3.4	
12	25	6.4	4.5	
15	16	8.0	5.6	

75W MR16 N (15 DEG)				
0° Aiming Angle				
D(ft)	FC	W	L	
6	333	1.6	1.6	
9	148	2.4	2.4	
12	83	3.2	3.2	
15	53	3.9	3.9	
45° Aiming Angle				
D(ft)	FC	W	L	
6	118	3.2	2.2	
9	52	4.8	3.4	
12	29	6.4	4.5	
15	19	8.0	5.6	

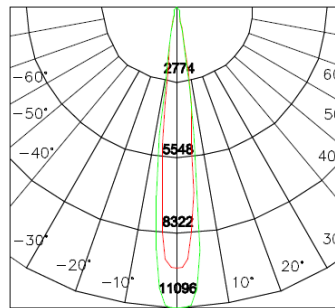

— 50W CBCP 10188
— 75W CBCP 11096

50W MR16 F (25 DEG)				
0° Aiming Angle				
D(ft)	FC	W	L	
6	94	2.7	2.7	
9	42	4.0	4.0	
12	24	5.3	5.3	
15	15	6.7	6.7	
45° Aiming Angle				
D(ft)	FC	W	L	
6	33	5.6	3.8	
9	15	8.4	5.6	
12	8	11.2	7.5	
15	5	14.0	9.4	

75W MR16 F (25 DEG)				
0° Aiming Angle				
D(ft)	FC	W	L	
6	136	2.7	2.7	
9	60	4.0	4.0	
12	34	5.3	5.3	
15	22	6.7	6.7	
45° Aiming Angle				
D(ft)	FC	W	L	
6	48	5.6	3.8	
9	21	8.4	5.6	
12	12	11.2	7.5	
15	8	14.0	9.4	

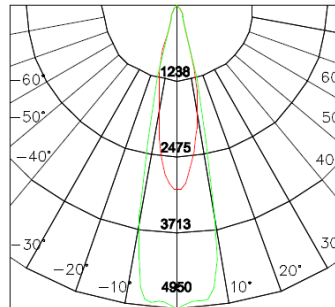

— 50W CBCP 3384
— 75W CBCP 4950

50W MR16 W (40 DEG)				
0° Aiming Angle				
D(ft)	FC	W	L	
6	51	4.4	4.4	
9	23	6.6	6.6	
12	13	8.7	8.7	
15	8	10.9	10.9	
45° Aiming Angle				
D(ft)	FC	W	L	
6	18	10.1	6.2	
9	8	15.1	9.3	
12	5	20.1	12.4	
15	3	25.2	15.4	

75W MR16 W (40 DEG)				
0° Aiming Angle				
D(ft)	FC	W	L	
6	58	4.4	4.4	
9	26	6.6	6.6	
12	15	8.7	8.7	
15	9	10.9	10.9	
45° Aiming Angle				
D(ft)	FC	W	L	
6	21	10.1	6.2	
9	9	15.1	9.3	
12	5	20.1	12.4	
15	3	25.2	15.4	

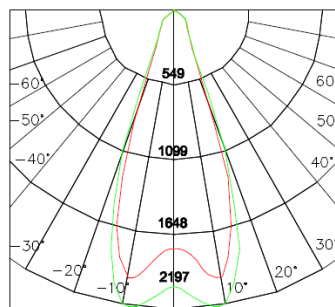

— 50W CBCP 1836
— 75W CBCP 2088