

Assembly Procedure

Foldable Clothes Dryer

Fast Drying / Sealed Closet / Home Warmer

Accessory List:

- 1*Cloth Cover
- 1 Set* Plastic Upper Side Frame
- 1 Set*Plastic Center Side Frame
- 1 Set*Plastic Lower Side Frame
- 12*Vertical Tube/Long Tube
- 9*Horizontal Tube
- 1 Set * Universal Wheels (According to Customer Demand)
- 1*Main Unit (Do not touch the tube mouth to prevent cuts.)
- Randomly Delivered Some Towel Tubes



1.Start by installing the casters and the three "cross tubes". Place the "lower" plastic side frame with the small U-shaped groove facing upwards.

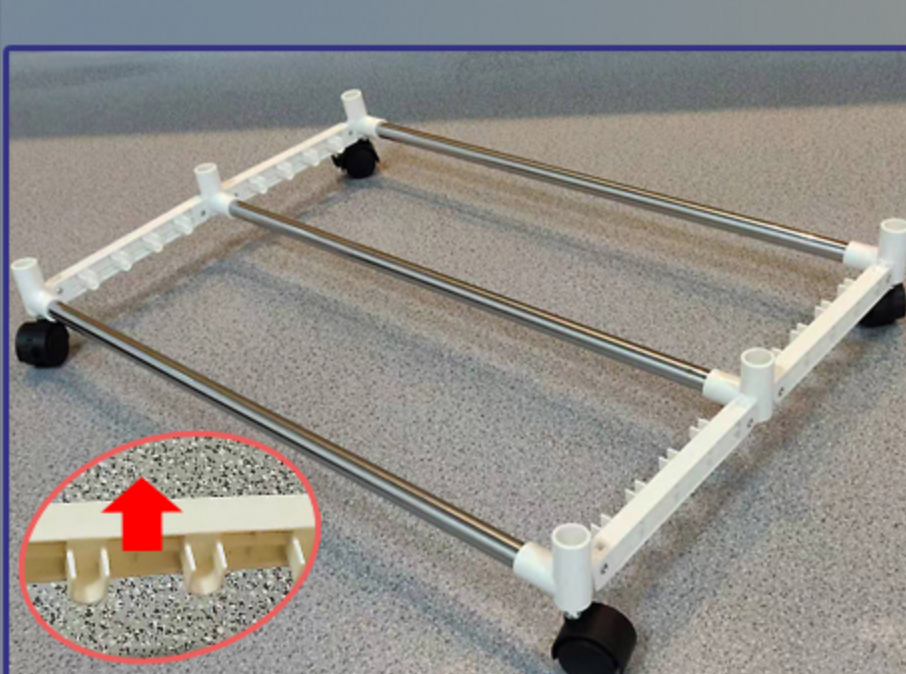

2.Install the six "vertical/long tubes". tubes".

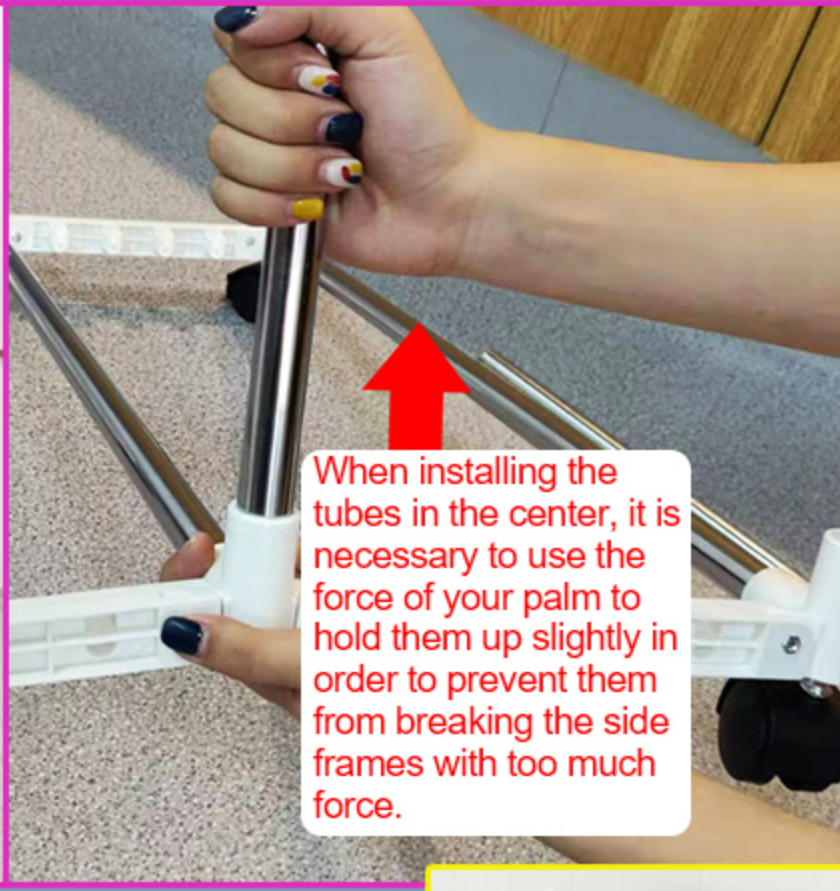

3.Place the cloth cover with the bottom hole side down, align the holes, set down along the six vertical tubes, wrap the six vertical tubes in the cloth cover, and then assemble the "middle" and the three "horizontal tubes" at the level as shown in the picture.



3.Continue to install the six long tubes and the "upper" plastic side frame and the corresponding three "horizontal tubes". Turn the U-shaped grooves of the "Middle" and "Upper" layers upwards.

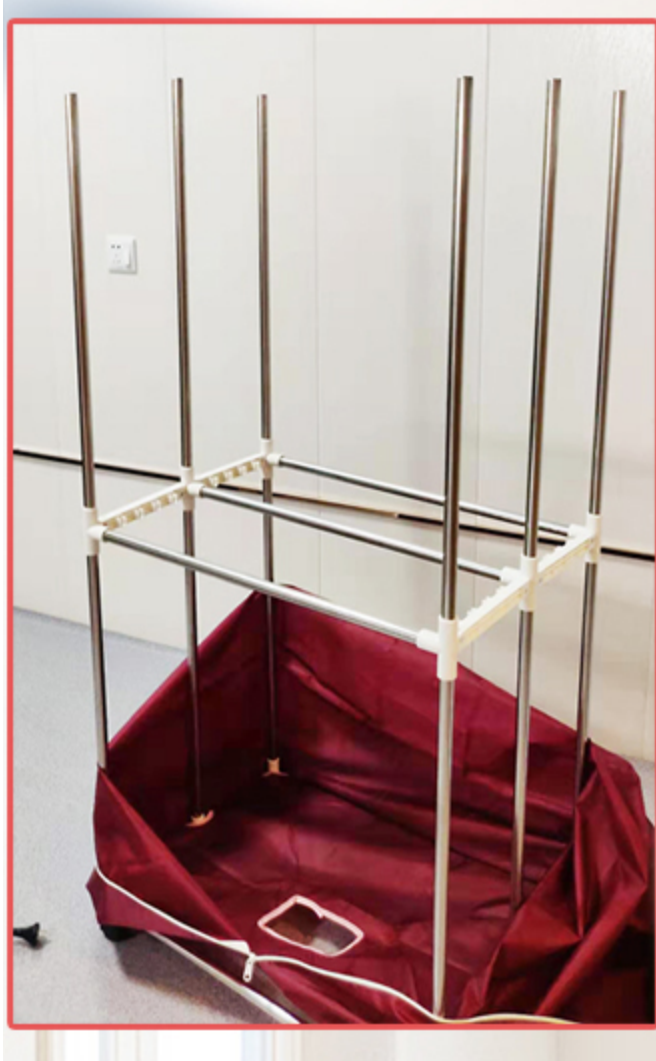

4.Assemble the hood by lifting the corners of the hood up to the top until it covers the "upper" level.



Note: Finally, set up the main unit on the "lower" tube, and align the air outlet with the bottom hole of the cloth cover.

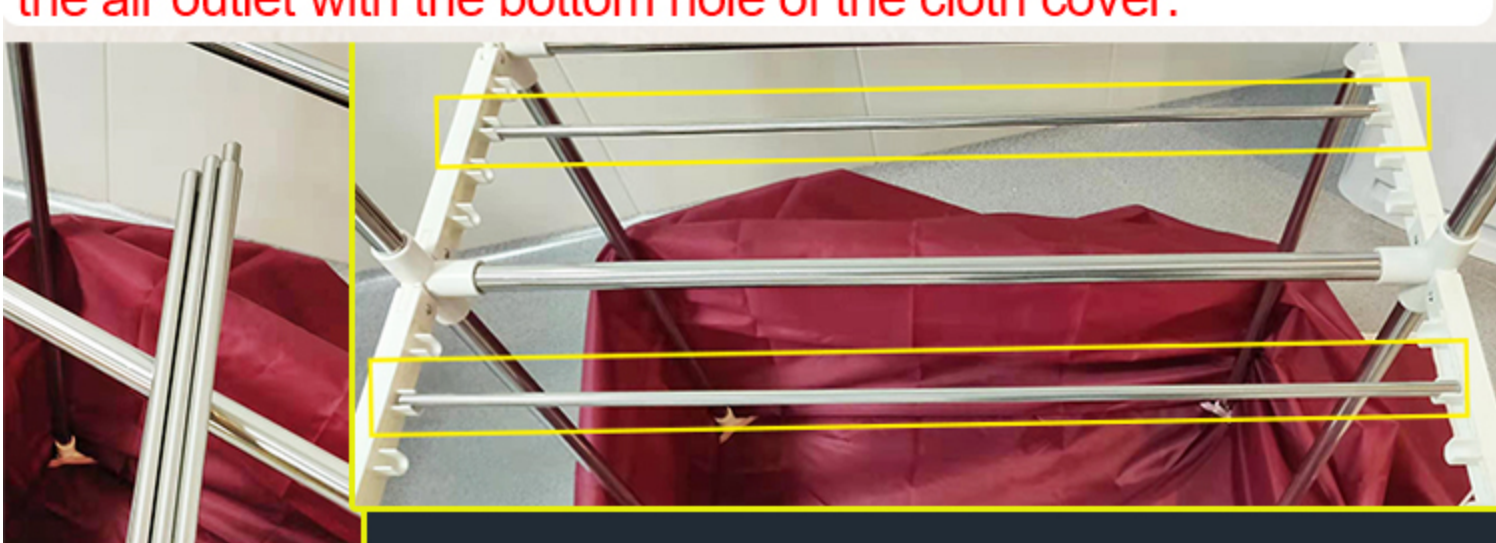

A number of complimentary towel tubes can be randomly paired on the center or upper U-shaped grooves.

Note: If your clothes are too long, you can remove the horizontal tube in the middle of the middle shelf to make it a single-shelf cabinet suitable for long clothes!