

## Knob Installation Instructions

- Requires 1/8" diameter hole
- Insert screw into hole

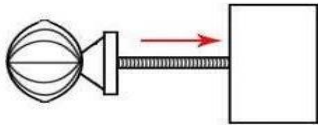

- A rubber washer may be used between knob and wood to avoid direct contact
- Tighten from the back using provided washer and nut

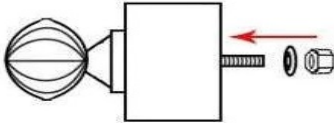

- An extra washer and nut are provided if you would like to tighten it further

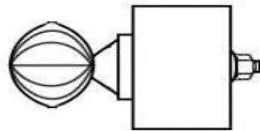

- All knobs provided with an extra-long screw to fit any drawer or door thickness
- Screw can easily be trimmed with pliers or snippers

