

Installation and User Manual for Bidet Seat

MODLE: CD-BT04A

- Thank you for purchasing the BIDEET . Please read through the manual carefully for appropriate use of the product.
- After you read through the manual, keep it at a proper place for further reference.

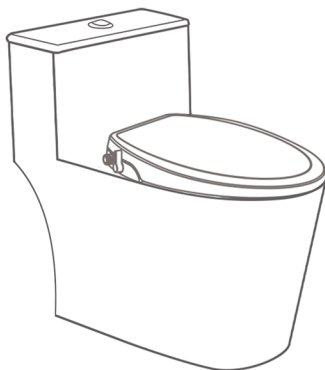

1 Names of parts for bidet seat

Product

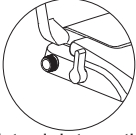

Water inlet on the left



Water inlet on the right

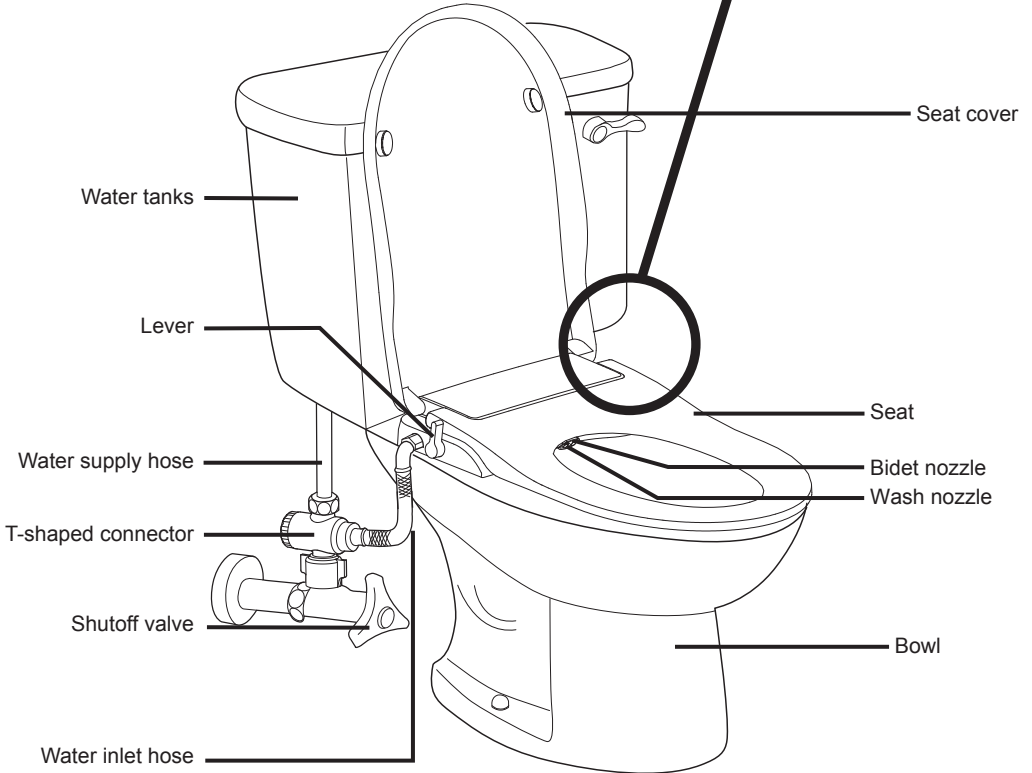
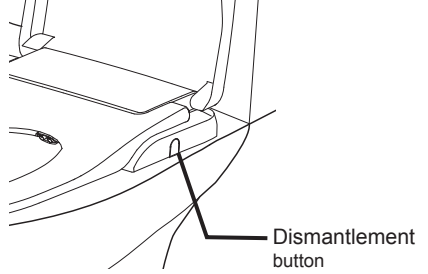

■ Components for Bidet Seat

1.Main body

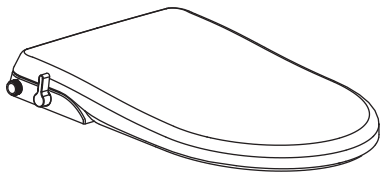

2.Installation template

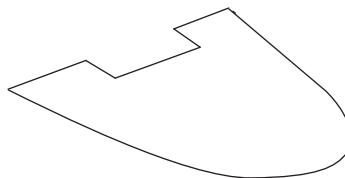

3.Fixing Components



Connecting bolts(2)



Expansive nuts(2)

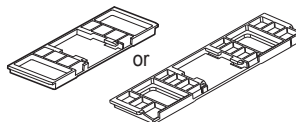

Adaptable panel(1)



Sliding plates(2)



Nut(2)

4.T-shaped connector

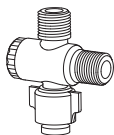

5.Water hose



Filter

6.Installation and User Manual

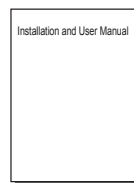

Note:

There are two methods for installation. The way of employing expansive nuts is recommended. Another way is using butterfly nuts. Please choose one for specific case.

3 Installation for Bidet Seat

Please make sure you read the instructions carefully and install it properly.

■ Cautions

1. The water pressure limit is from 0.07 to 0.8 MPa (10 to 116 PSI). Please use as instructed.
2. The water shutoff valve should be near where the product can be installed and dismantled.

■ Product Installation Procedure

■ Pre-installation

1. Insert the connecting bolts in adjusting pieces.

- As figure, insert the connecting bolts in the boles of adjusting pieces.

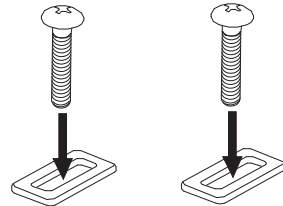

2. Insert connecting bolts with adjusting pieces in the adaptable panel.

- As figure, insert the connecting bolts in the boles of adjusting pieces in the holes of the adaptable panel.

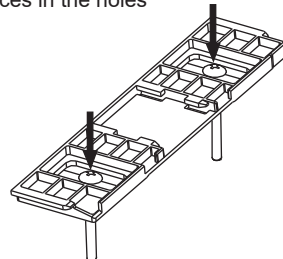

■ Installation Procedure

● First installation method (recommended):

1. Install expansive nuts

- As figure, insert expansive nuts in the holes of the ceramic.

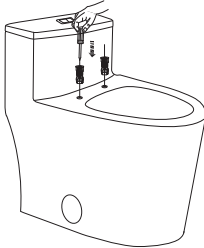

2. Install installation template

- As figure, install the installation template on the ceramic.

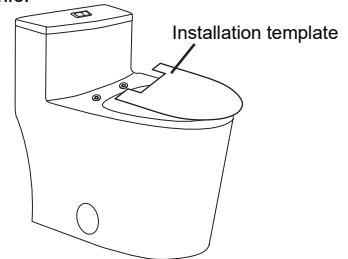

3. Fix the adaptable panel

- As figure, take the adaptable panel to the holes of the ceramic. Adjust position for connecting bolts and adjusting pieces, make the connecting bolts aim at according expansive nuts. Then fix the adaptable panel.

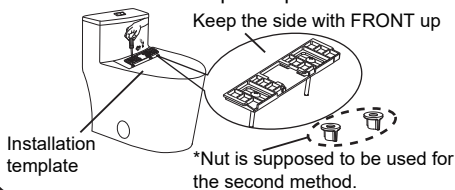

4. Take away the installation template

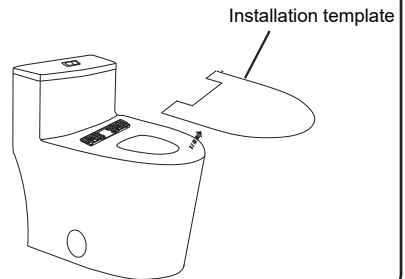

5. Install the product

- Keep the fix slots under the product aim at slots on the adaptable panel. Push the product to the end as figure below. Then completes installation.

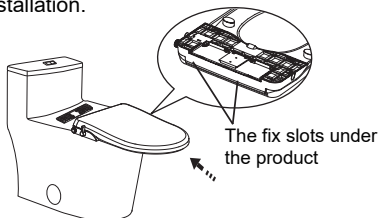

6. Quick-release design

- Easy to remove and re-install the seat for cleaning.

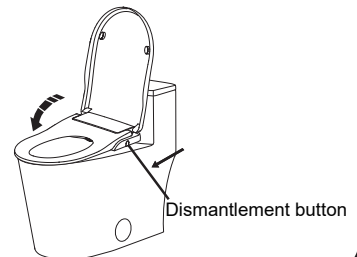

● Second installation method

1. Refer to first installation method step 2. Put the installation template on the ceramic.
2. Refer to first installation method step 3. Take the adaptable panel to the holes of the ceramic. Adjust position of the connecting bolts with adjusting pieces. Screw in the nuts from underside of the ceramic. Then fix the adaptable panel.
3. Refer to first installation method step 4 and 5. Complete following installation procedure.

■ Connecting water hose

1. Close the water valve and detach water pipe from the water tank.
Connect the t-shaped connector to the water tank.
Make sure that rubber packing is inserted in between.

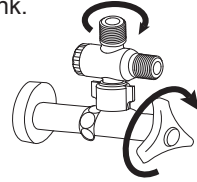

2. Connect the water pipe to the t-shaped connector.

Note: Please remove the regulator cover and regulate o-ring under the following conditions:
a. When the water dynamic pressure is lower than 0.05MPa, especially using the family tank.
b. When the nozzle cannot work normally and water is low.

1. Take out the regulator with pliers and other tools.
2. Remove the regulator cover and regulate o-ring except the sealing o-ring.
3. Insert the regulator component into the inlet pipe.

Caution: Must use the regulator cover and regulate o-ring when the water pressure is bigger than 0.1MPa.

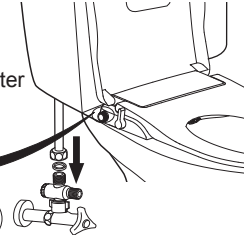
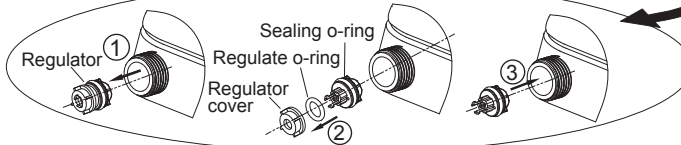

3. Press the filter and washer at the two ends of water hose into the screw tube, then connect the main body and T-shaped connector with water hose.

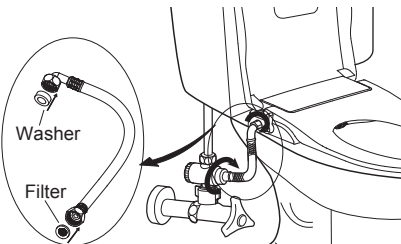

4. Open the water valve to check if there is any leakage.

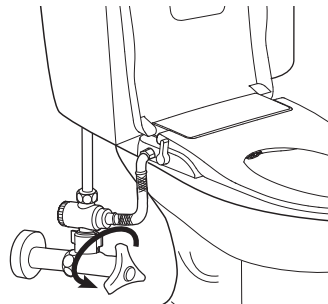

Prohibition

1. Do not lift the product with the seat cover and seat open.
This may cause a mechanical trouble.

2. Warning: The water supply can't be above 40 degrees or below 0 degree.

6 Operation

WASH

- Turn the lever clockwise from the vertical position.
- Nozzle for WASH moves forward and start the function.
- The water volume changes with the turning of lever.

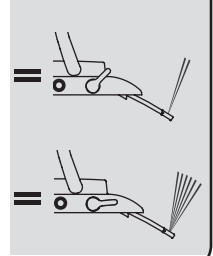
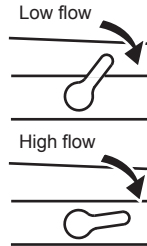
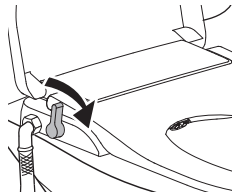

BIDET

- Turn the lever anticlockwise from the vertical position.
- Nozzle for BIDET moves forward and start the function.
- The water volume changes with the turning of lever.

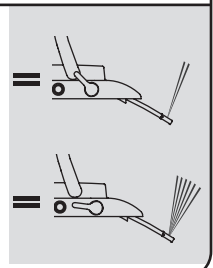
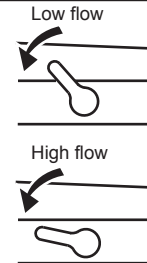
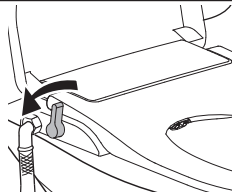

Off and Self-cleaning (Self-cleaning is an optional feature)

- Keep the lever at the 90° position when not in use.
- Position the lever at 25° before each use then hold few second ,it could clean the wand and once product connect warm water could empty the cold water.
- The wand cleans itself after each use. For additional flush clean of the wand, position the lever at 25° for a few seconds and then reposition back to 90° .

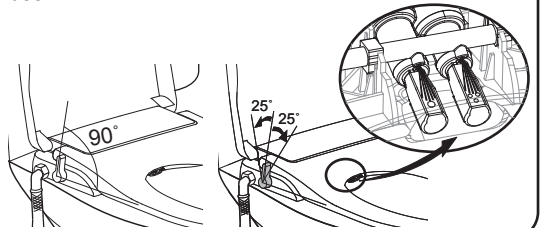

7 Clean and dismantlement

1. Clean the outside parts of the product.

Use a smooth sponge/cloth with diluted kitchen detergent to clean the product. Do not use the following types: hydrogen chloride detergent, painting thinner, benzene, abrasive paper, polishing agent, fragrance and insecticide, etc.

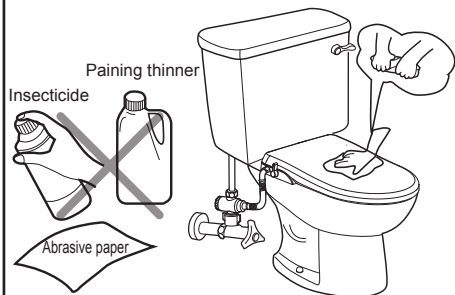

2. Clean the nozzle

Pull out the nozzle softly and use smooth cloth/sponge or toothbrush with kitchen detergent to clean the nozzle.

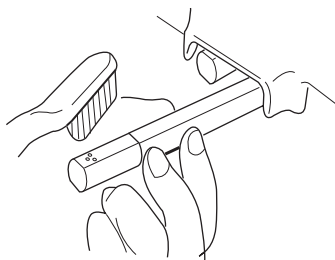

3. Clean the filter and regulator

(If the water flow is smaller than usual)

1- Clean the filter for both sides. Make sure to disconnect the water supply hose during cleaning.

2- Clean the regulator o-ring (See the step 2 on the page 5 to find how to remove and install the regulator o-ring).

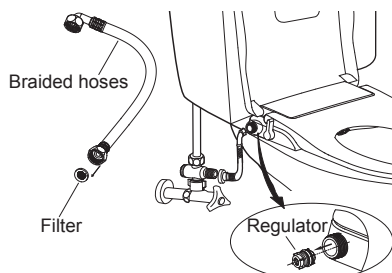

4. Remove the main body.

Close the lid. Push the dismantlement button and pull out the product as the arrow the figure. Then the product will be dismantled.

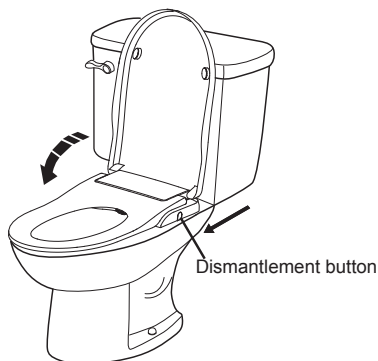

8 Product maintenance

1. Lever replacement

As per figure A, rotate the lever to the highest wash volume.

As per figure B, Remove the old lever along the axis direction.

As per figure C, insert the new lever rib into the corresponding control valve slot. The installation is completed with a "click" sound.

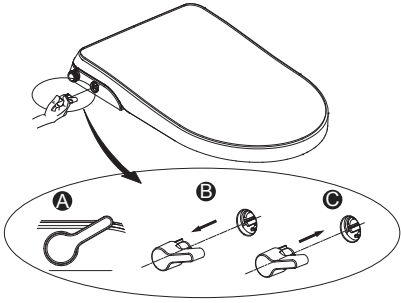

2. Nozzle replacement

As per figure A, Pull out the tube and do not release then remove the old nozzle along the axis direction. As per figure B, insert the new nozzle into the tube along the corresponding slot. The nozzle replacement is completed.

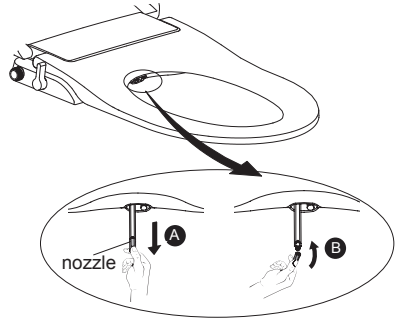

3. Regulator replacement

Rotate the lever in the working position, clip out the regulator from the inlet tube by pliers. Press the new regulator into the bottom of the inlet tube. The regulator replacement is completed. Then rotate the lever back to non-working position.

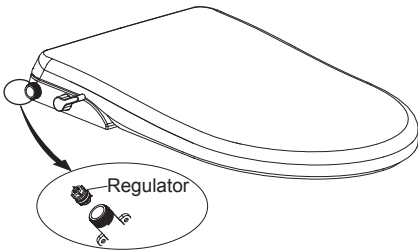

4. Water hose leaking solution

If water leaks from the two ends of water hose, re-tighten the nuts to avoid water leaking.

