

User Manual

Modern Floor Lamp

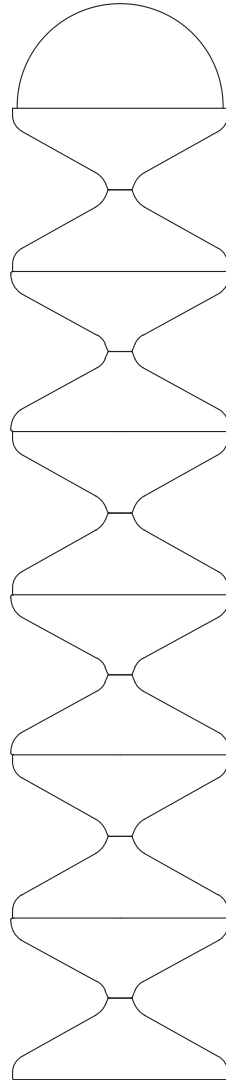

Introduction

Thank you for purchasing our modern floor lamp, please read the following instructions carefully before use.

Cautions

1. When opening the package with a sharp tool like a utility knife, take care not to damage the internal components.
 2. Carefully remove all packaging materials and keep them for future use.
 3. Keep all hardware parts and packaging out of the reach of small children.
 4. Do not allow children to play with this product.
 5. Please make sure that the voltage is 100-120V, which is standard for US.
- This product can only be used between 100-120V.
6. Please check whether the packing list is complete.

Parameter

Lamp	
Material	Iron + Acrylic
Switch	Foot Switch
Socket Type	E26
Bulb	
Voltage	120V
Power	12W
CCT	3 Color Temperature

Warranty and Our mission

Light the world, Warm your heart, which is the goal that we have been pursuing. We'd like to provide the best lamps and service to you. We provide a 12-month warranty for you.

Package List

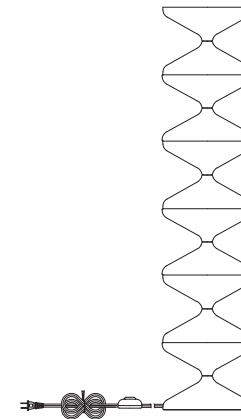

A. Lamp x1



B. Base x1



C. Bulb x1

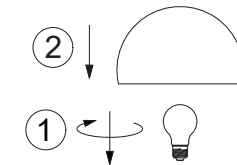

- A. Twist the light bulb to the lamp holder
- B. Put the lampshade on the lamp post
- C. Assembly is complete

