

USE AND MAINTENANCE

Use on level surfaces only

Because this product needs assembly, it is prone to working itself loose from time to time depending on the use. Please take the time to check that all connections are still tight and working properly
Only clean using a damp cloth and mild detergent, do not use bleach or abrasive cleaners.

PART LIST

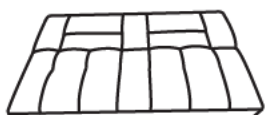

1 - Futon Assembly x1



2 - Leg x2

HARDWARE



A - Bolt x4



B - Expansion Bolt x4



C - Allen Wrench x1

Assembly Instructions

1

Select and lay Futon Assembly 1 and turn over upside down. Select 2 x2 and insert leg post into back hole in futon. Turn clockwise to hand tighten.

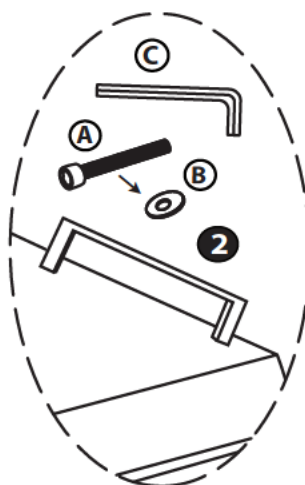
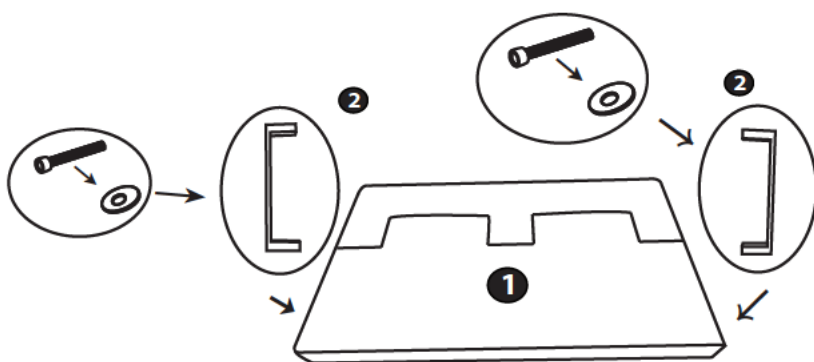

2

Select A Bolt x2, B Bolt x2, Insert B Bolt into A into the Leg with C Allen Wrench, then through hole to part 1 Assembly. Ensure the leg orients to point outward for proper support. Repeat the B into A into the Leg for the other side.

3

Turn Futon Assembly 1 over, you can sit there to relax, push the backward to lay flat, you can sleep.

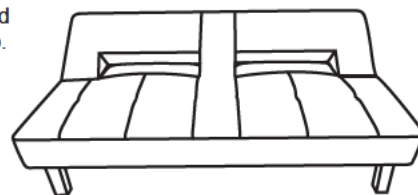
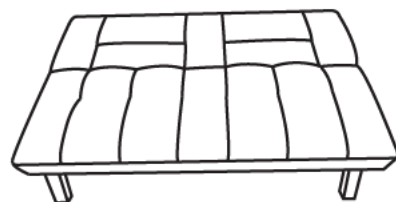

Note:

To sleep - pull backrest forward until it clicks to release and then push backward to lay flat.

To Recline:

Lay flat to sleep, then pull up into desired recline position.

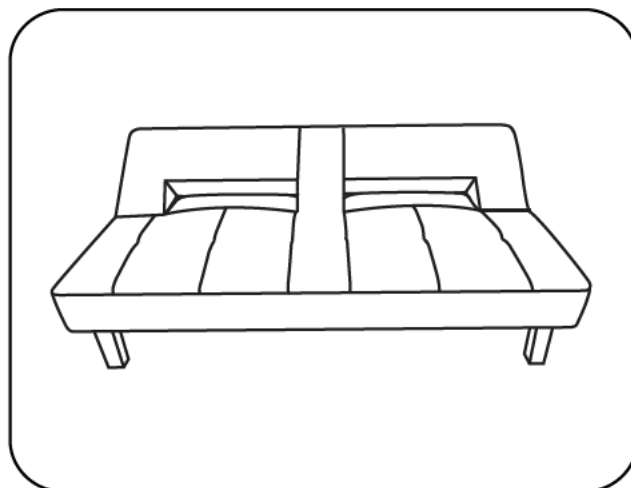

Congratulations! Setup of your new Naomi Home Futon is Complete!