

LEFTON

# Installation Manual

## LGD-714



3/4HP Continuous Garbage Disposal

## Diagram and Parts List



## STEP 1: DISASSEMBLE THE MOUNTING ASSEMBLY

Use a flathead screwdriver to remove the snap ring from the sink flange. Loosen the mounting screws and remove the upper mounting ring, backup ring and fiber gasket from the sink flange.

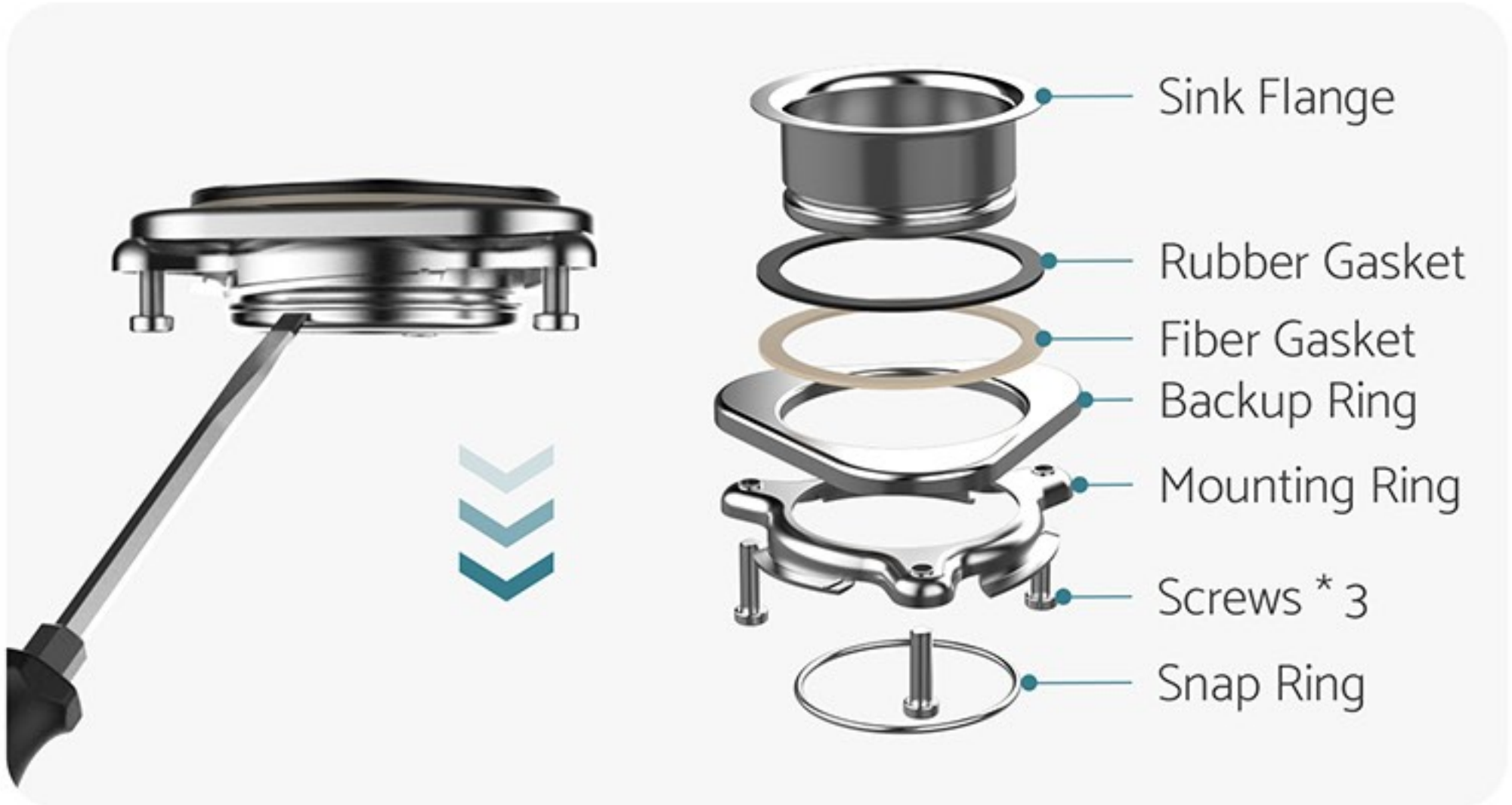

## STEP 2: INSTALL THE SINK FLANGE

Put the sink flange and rubber gasket into the center of the sink drain. Push the sink flange down firmly to make a good seal.



### STEP 3: ATTACH THE UPPER MOUNTING ASSEMBLY

Place the fiber gasket, backup ring, and upper mounting ring onto the sink flange in this order. Hold in place while inserting the snap ring. Pull the snap ring open and press firmly.

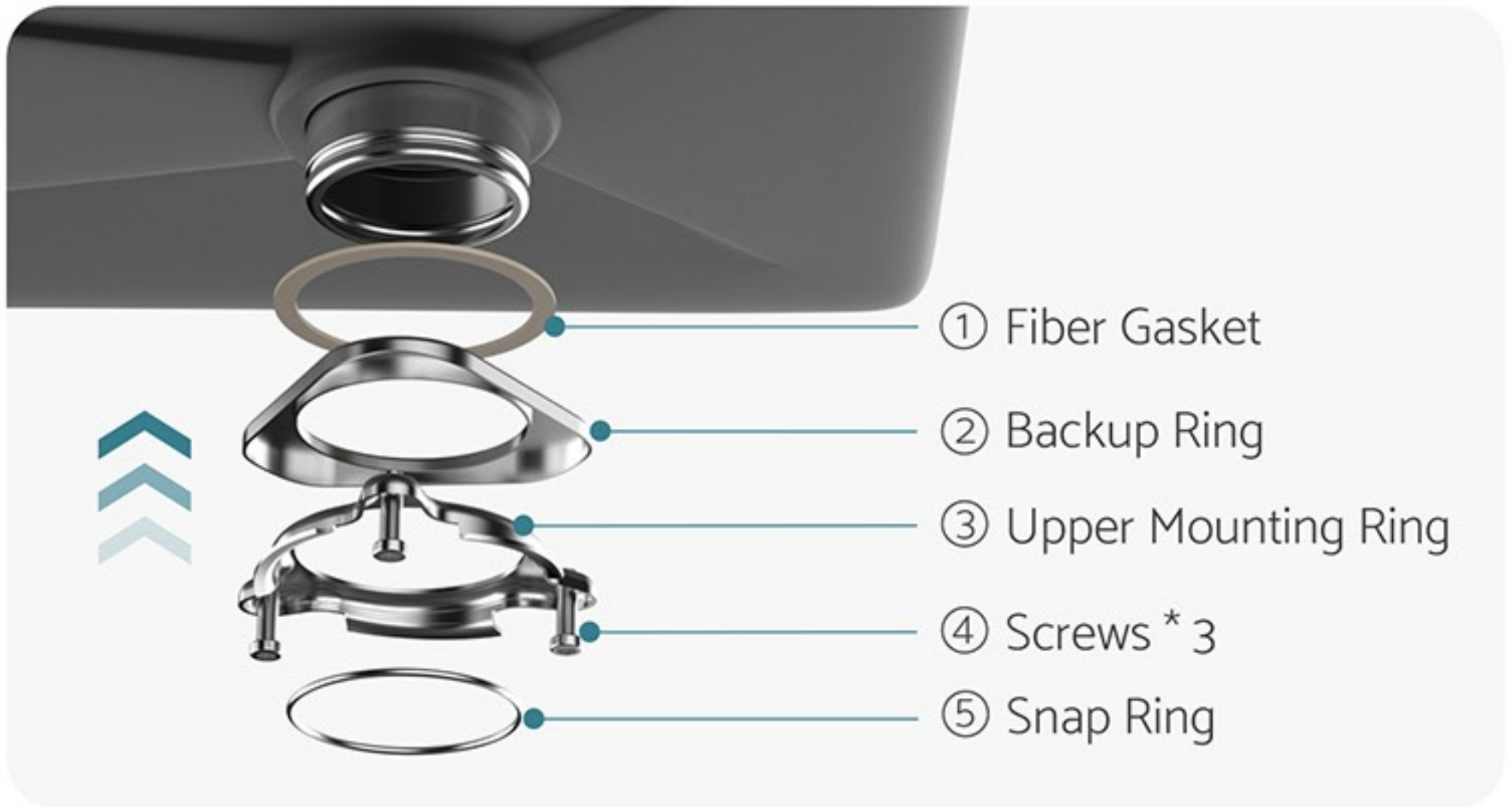

### STEP 4: LOCK THE UPPER MOUNTING RING

Tighten mounting screws evenly and firmly against the backup ring with the included hex wrench.



## STEP 5: DISHWASHER CONNECTION (IF REQUIRED)

If you are utilizing a dishwasher, complete the following procedure. If you do not need to connect it, move to the next step.

- A. Insert the screwdriver into the dishwasher inlet and tap it with the hammer to knock out the plug on the inner body.
- B. Remove the loose knockout plug from the inside disposer. Please take out the knockout plug if it falls into the chamber.

**!** **Caution:** Once the plug is removed, it cannot be replaced.

**!** **Caution:** If the dishwasher is connected without removing the plug, it may overflow. (Connections must comply with local plumbing codes.)

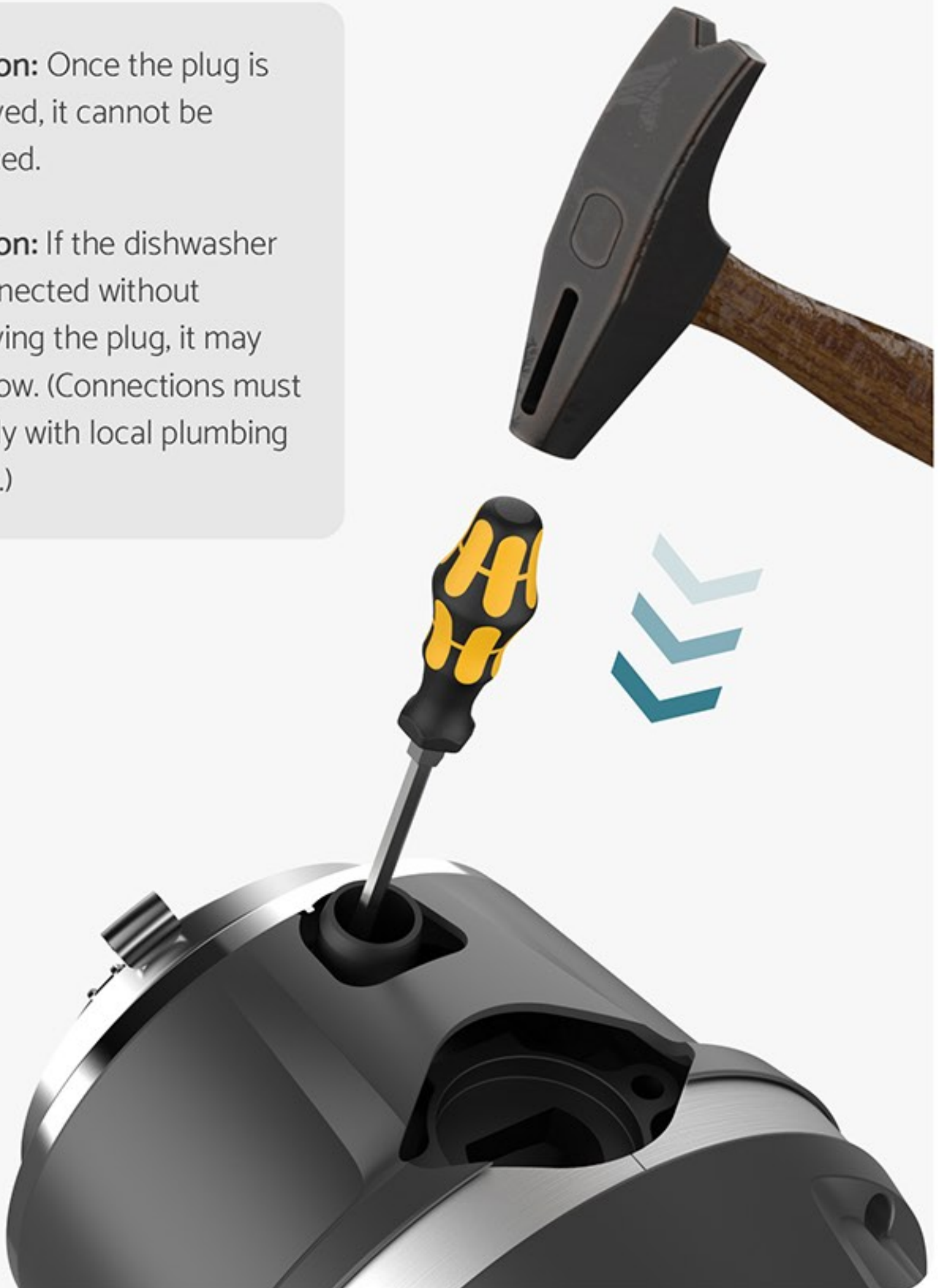

## STEP 6: CONNECT DISPOSER TO SINK FLANGE

Lift the disposer and connect it to the mounting assembly. Use the screwdriver to turn the disposer onto the buckle of the mounting ring to fix it tightly.



## STEP 7: CONNECT MULTIFUNCTIONAL DRAIN ELBOW

A. Place the drainpipe gland over the pipe connector A. Attach the drain seal to the pipe connector A and insert it into the discharger outlet of the disposer. Secure the drainpipe gland with screws tightly.

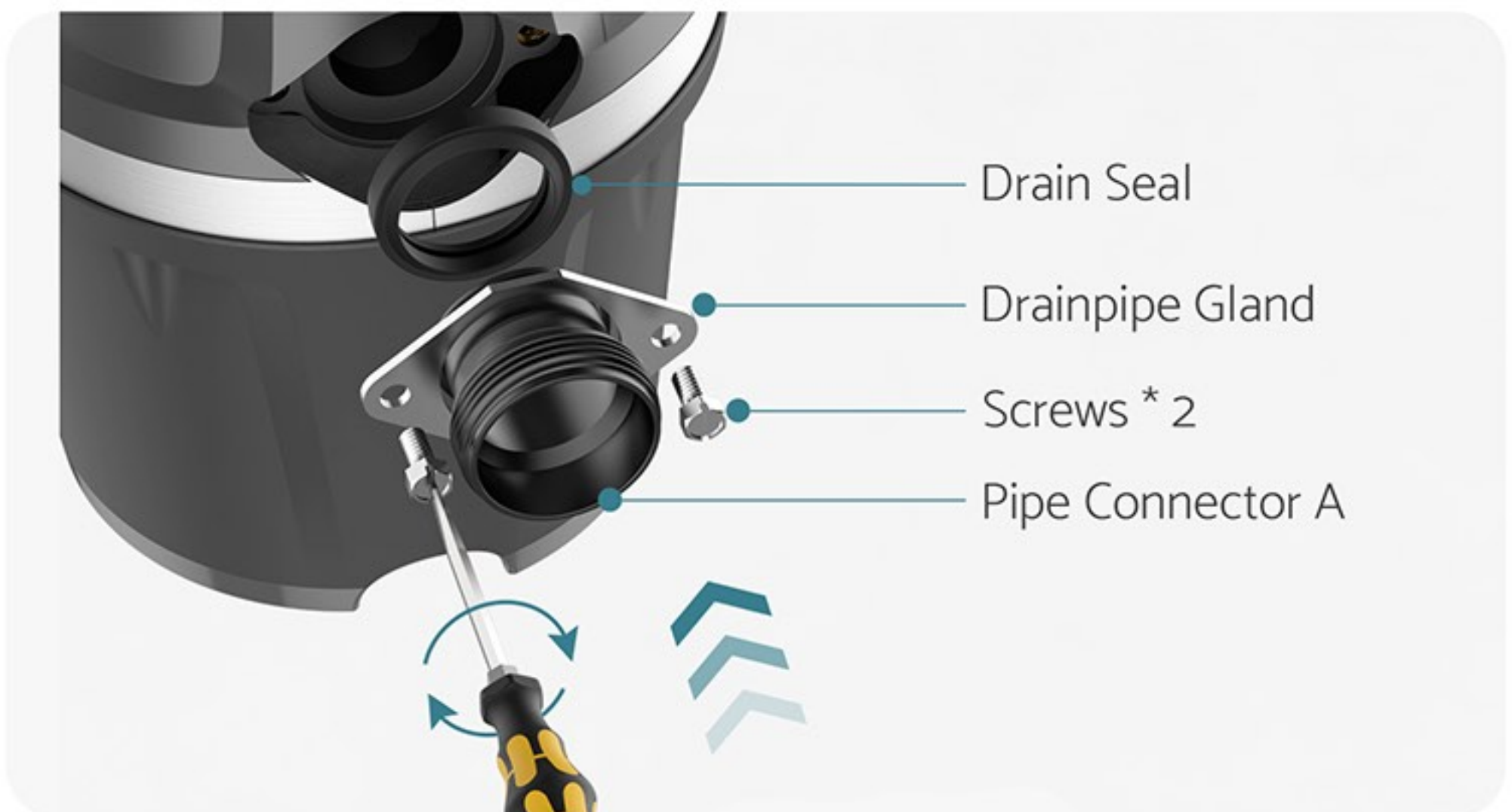

B. Attach the rubber buckle to the pipe connector A and press it firmly into the gap.



**! Caution:** If it is hard to get the rubber buckle in, you can use a tool such as a screwdriver for assistance.

**! Caution:** The rubber buckle must be fully inserted into the disposer outlet and does not cover the threads of the pipe connector A.

C. Install the multifunctional drain elbow onto the pipe connector A by turning it clockwise.

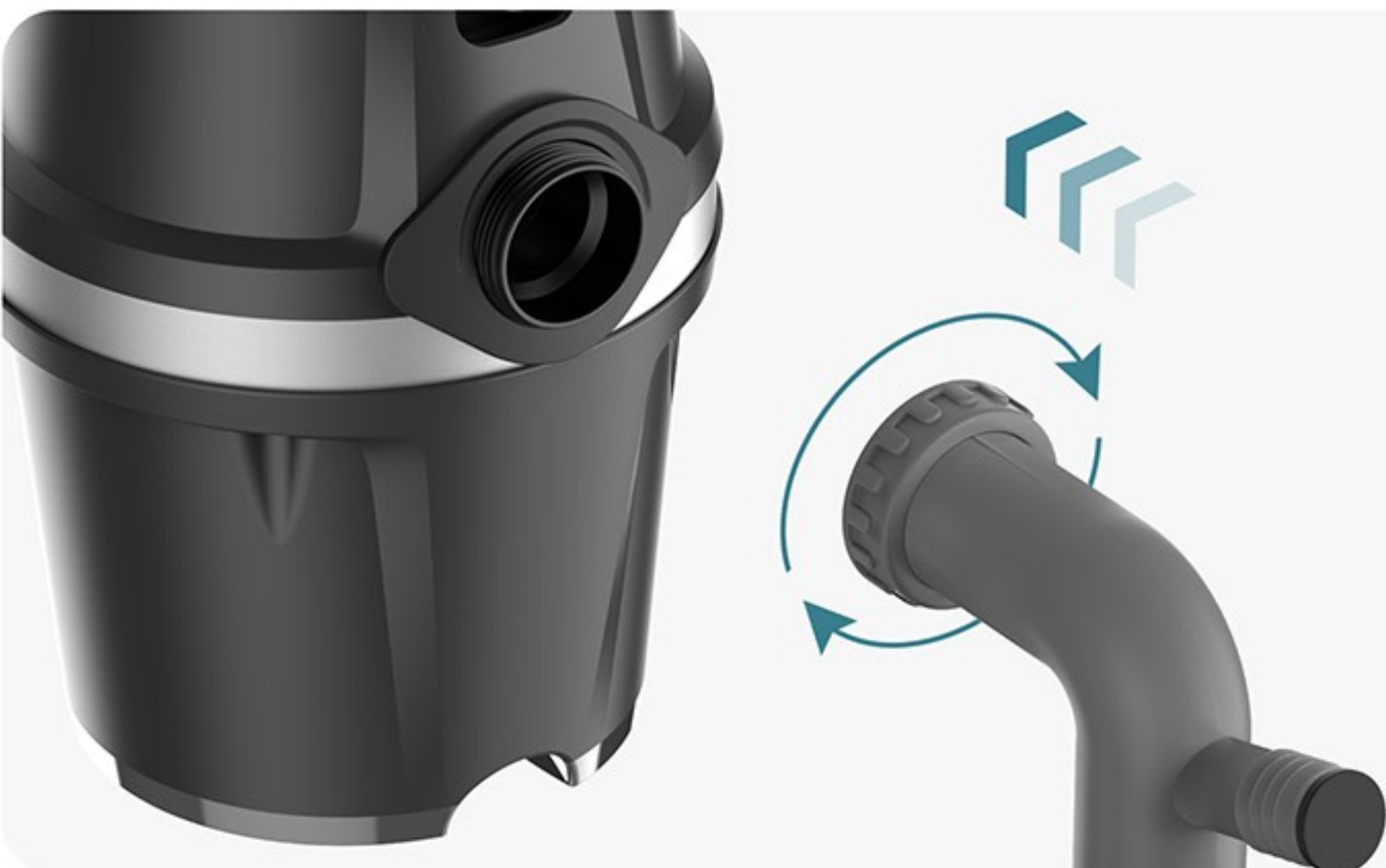

## STEP 8: CONNECT THE PIPE CONNECTOR

Attach the pipe connector B with the drain elbow. If you have a dishwasher connected, you can install the water line to inlet access on the upper part of the disposer. Make sure all plumbing connections are tight and comply with local plumbing codes.



## STEP 9: CHECK FOR LEAKS

Run water into the sink, then check for leaks.



### **WARNING**

- To reduce the risk of injury, close supervision is required when an appliance is used near children.
- Do not put fingers or hands into a waste disposer.
- To avoid electrical shock, disconnect power before installing or serving the disposer.
- If you are not familiar with electric power, contact a qualified electrician to connect the disposer to the electrical circuit.
- If a three-prong earth (grounded) plug is used, the plug must be inserted into the three-hole, earth(grounded)receptacle.
- Improper connection of equipment earth(grounded) conductor can result in electric shock.
- Do not attach earth wire (ground wire) to the gas supply pipe.
- All wiring must comply with local electrical codes.
- Do not reconnect the electrical current at the main service panel until proper earth (grounded) outlets are installed.
- If the supply cord is damaged, it must be replaced by the manufacturer, service agent, or similarly qualified person to avoid a hazard.