

# Installation & Assembly

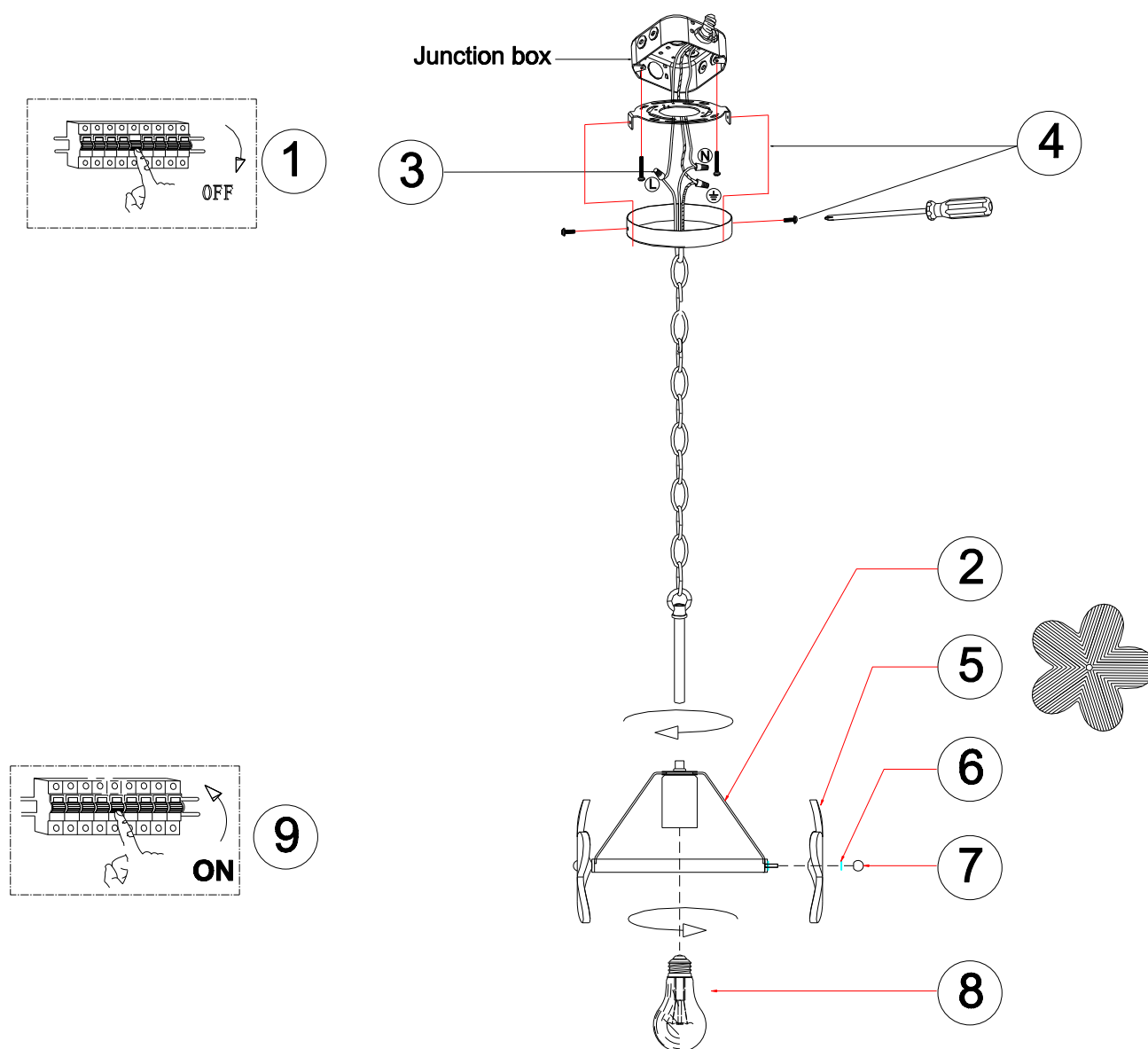

- 1 : Shut down the power.
- 2 : Twist the conical frame into the straight pipe beneath the chain.
- 3 : Tighten the wiring end cover in the correct manner
- 4 : Tighten and fix the installation plate onto the junction box, and then secure the screws on both sides of the ceiling.
- 5 : Insert the glass sheet onto the straight rod with teeth on the top of the conical holder.
- 6 : Also insert the small round plastic gasket onto the serrated straight rod.
- 7 : Twist the small ball onto the serrated straight rod to secure the glass.
- 8 : Turn the E26 bulb into the lamp socket.
- 9 : Turn on the main power supply, and the lights will come on.