

ASSEMBLY INSTRUCTION

DESCRIPTION: 3 DRAWER NIGHT STAND

Thank you for purchasing this quality product. Be sure to check all packing material carefully for small parts which may have come loose inside the carton during shipment. Identify and count all parts and compare with the parts List Below:

PART LIST:

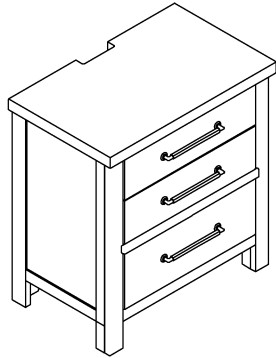

HOW TO REMOVE DRAWER

To remove drawer, simultaneously pull tab up on one side and push down on the other and remove drawer.

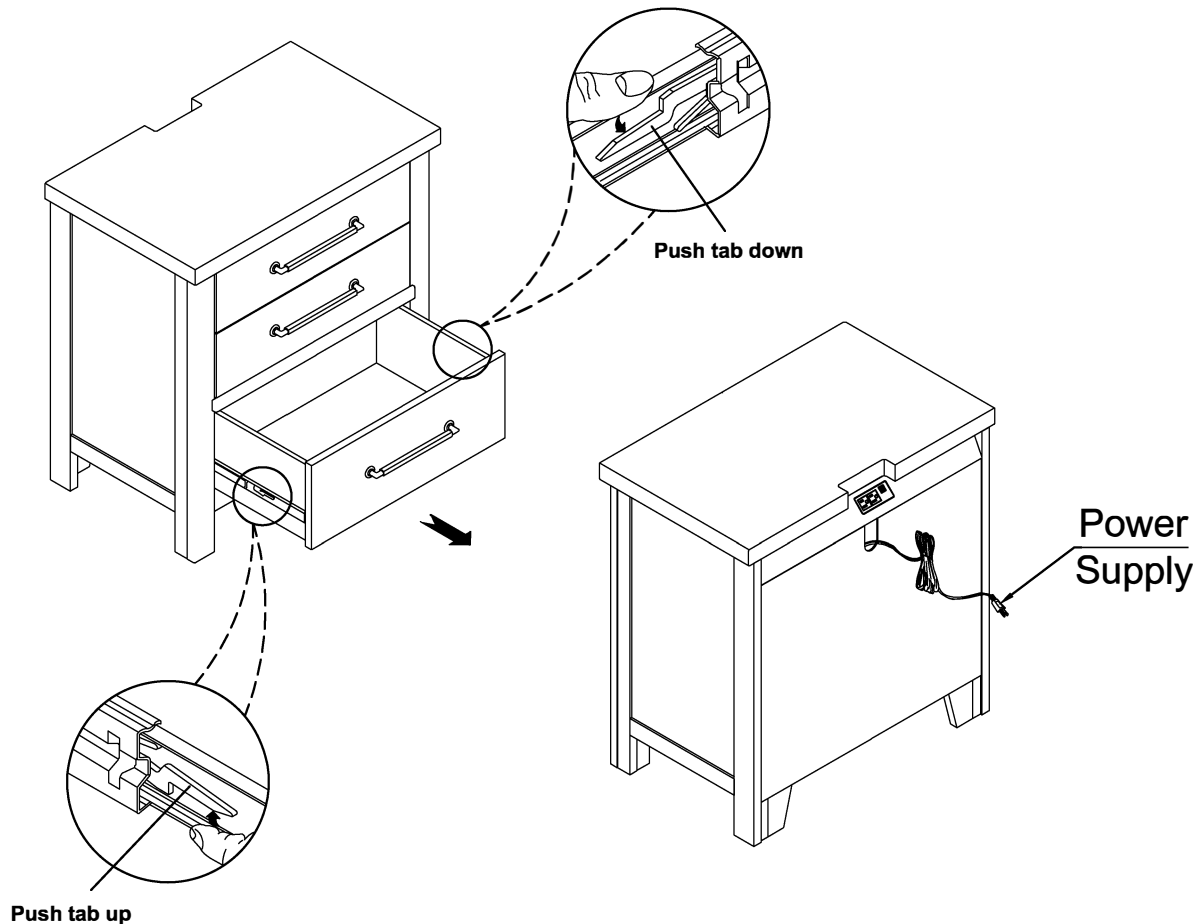

CLEANING INSTRUCTION

Clean the 3 Drawer Night Stand surface with a furniture polish and a soft cloth.