

Queen Bed

Assembly Instructions

W11-0820

1 Assembled View

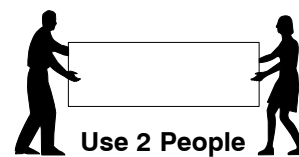
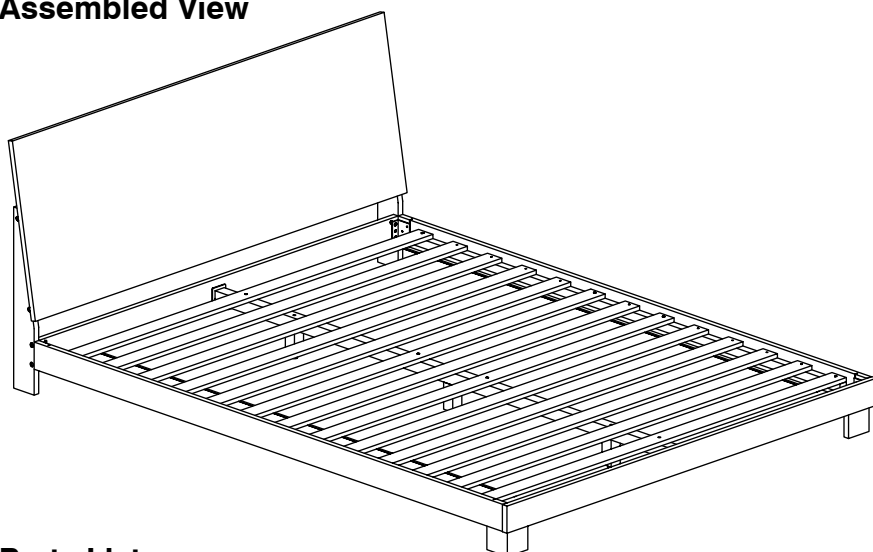

Note: Do not assemble using power tools. This can cause the bolts to be overtightened

2 Parts List

Parts in Box A:



A Headboard Panel **x 1**

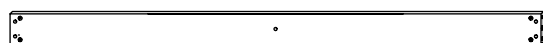

B Headboard Support **x 1**

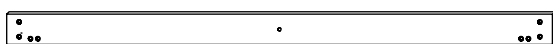

C Footboard Panel **x 1**

F
Headboard Post
(Left Hand)
x 1

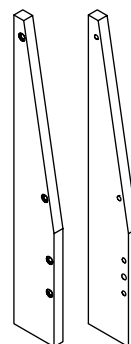

G
Headboard Post
(Right Hand)
x 1

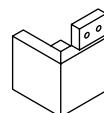

H
Footboard Post
(Left Hand)
x 1

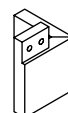

J
Footboard Post
(Right Hand)
x 1

Parts in Box B:



D Side Rail **x 2**

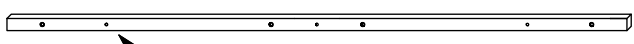

E Long Support **x 1**

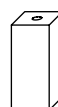

K
Support Leg
x 3

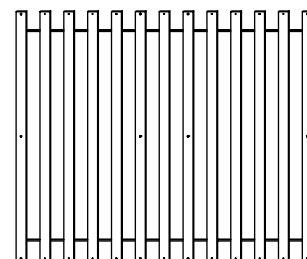

L Set of Bed Slats **x 1**

Queen Bed

Assembly Instructions

W11-0820

3 Hardware List



1 M4 Allen Key
x 1

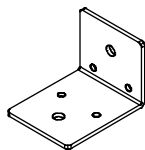

2 Center Rail
Bracket x 2

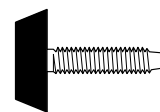

3 Adjustable
Foot x 3



4 Barrel Nut
x 8

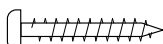

5 Wood Screw
(M4 x 32mm)
x 18

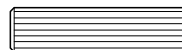

6 Wood Dowel
(10 x 40mm)
x 2



7 Spring
Washer x 12



8 Flat
Washer
x 12



9 M6 x
15mm JCB
x 4

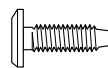

10 M6 x
20mm JCB
x 8

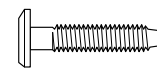

11 M6 x
30mm JCB
x 4



12 M6 x 40mm JCB
x 12



13 M6 x 70mm JCB
x 8

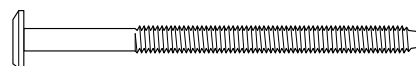

14 M6 x 90mm JCB
x 3

4 Fix the Adjustable foot to the bottom of the Support Leg (K).

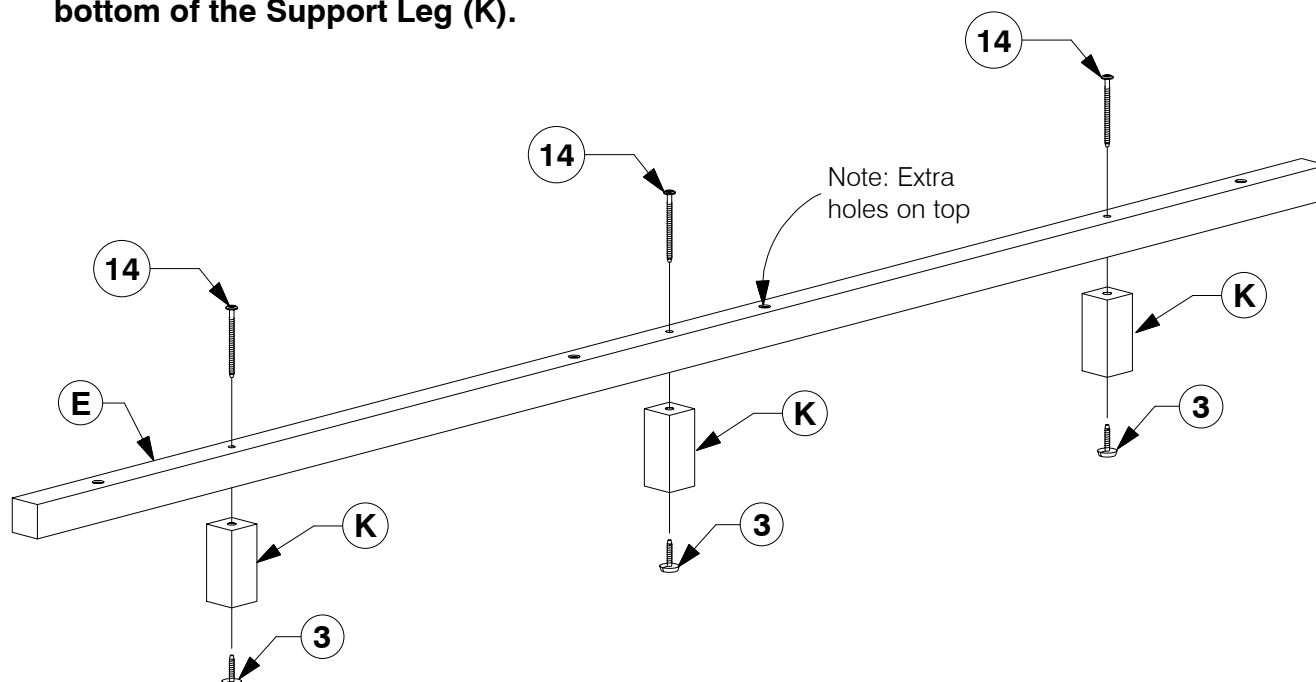

Queen Bed

Assembly Instructions

W11-0820

- 5** Attach the Footboard Post (H & J) to the Footboard Panel (C).

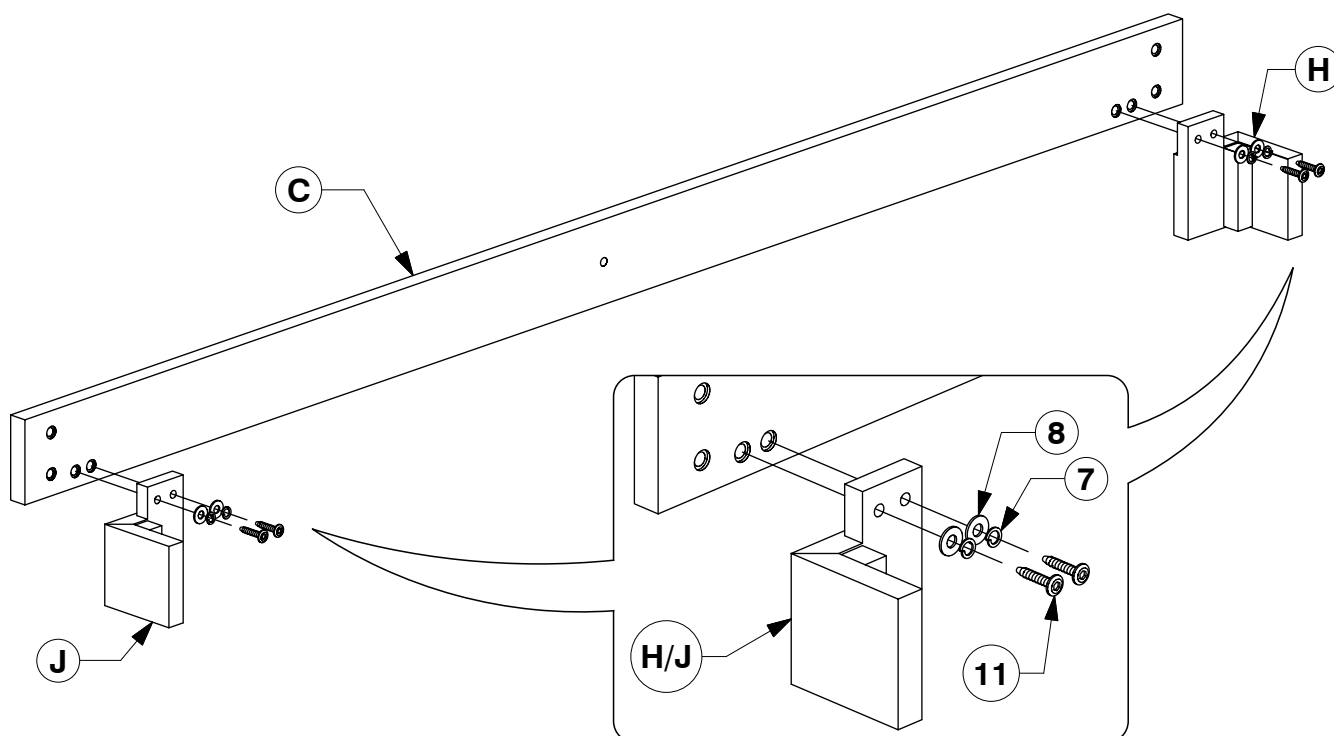

- 6** Fit the Center Rail Bracket to the Footboard Panel (C).

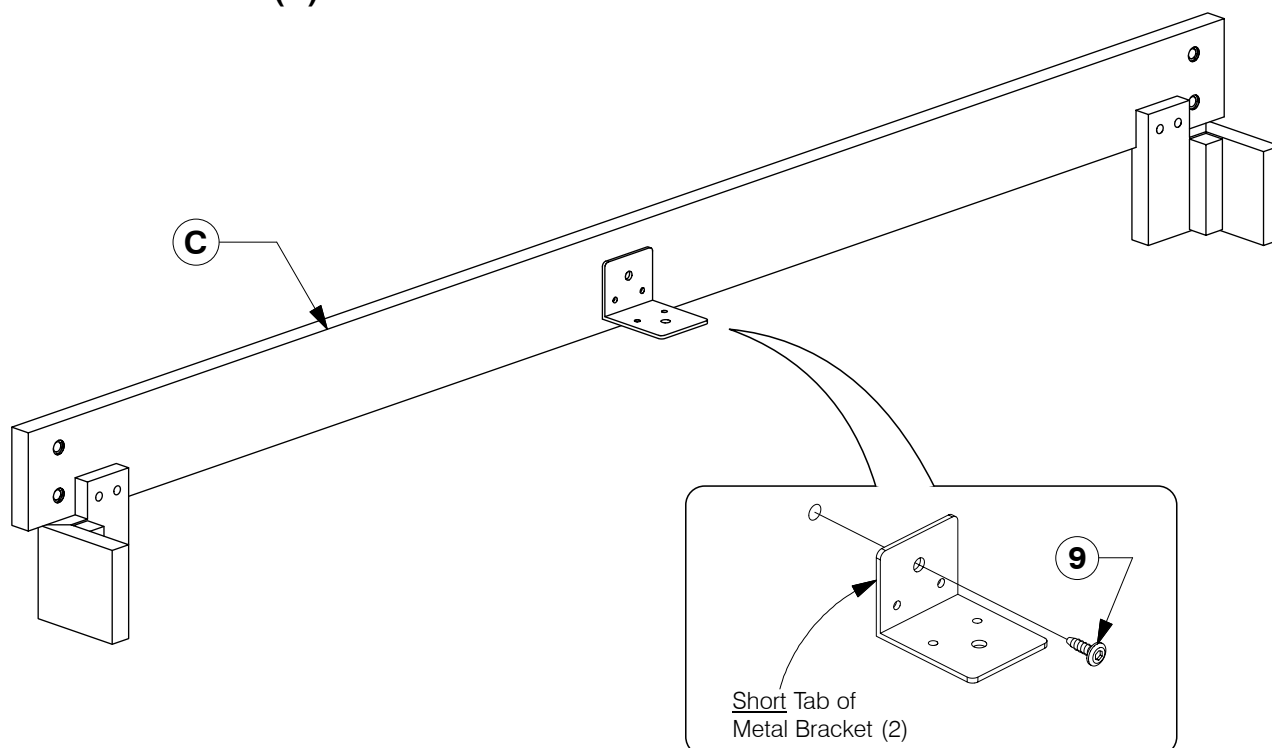

Queen Bed

Assembly Instructions

W11-0820

- 7** Fit the Center Rail Bracket to the Headboard Panel (B).

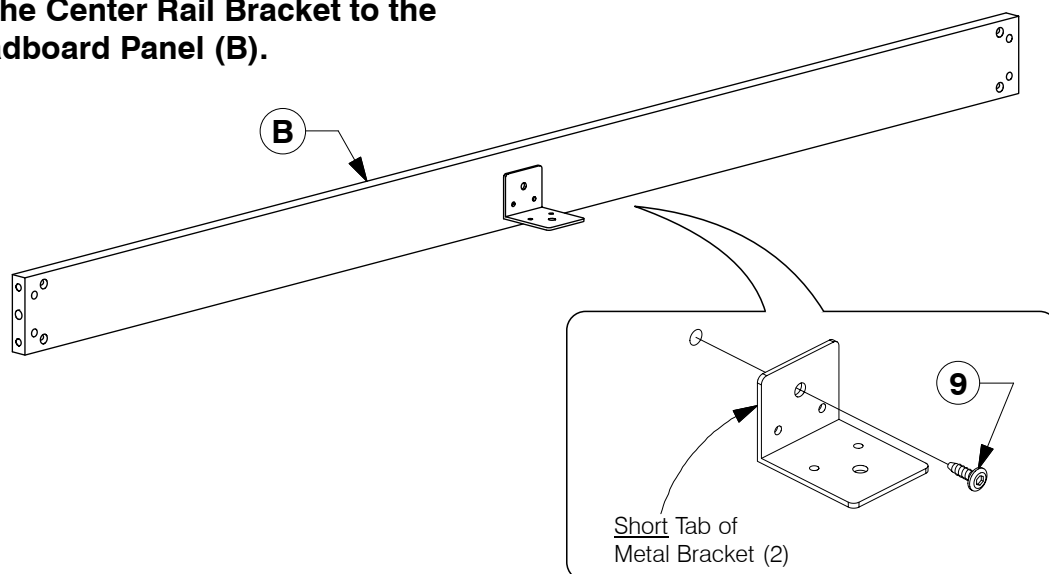

- 8** Assemble the Headboard Panel (A) & Headboard Support (B) to the Headboard Post (F & G).

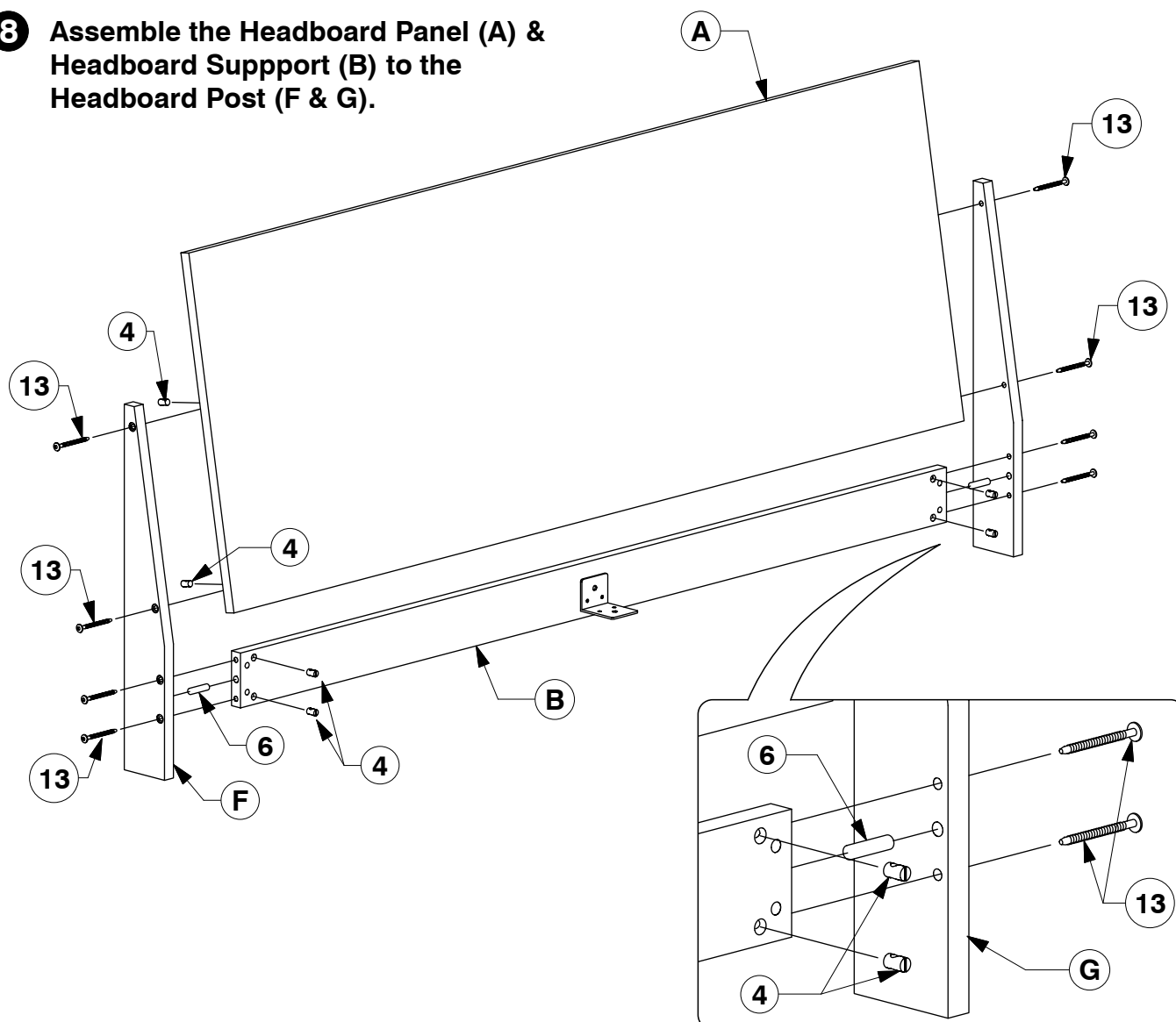

Queen Bed

Assembly Instructions

W11-0820

- 9 Assemble the Side Rail (D) to the Head / Footboard.**

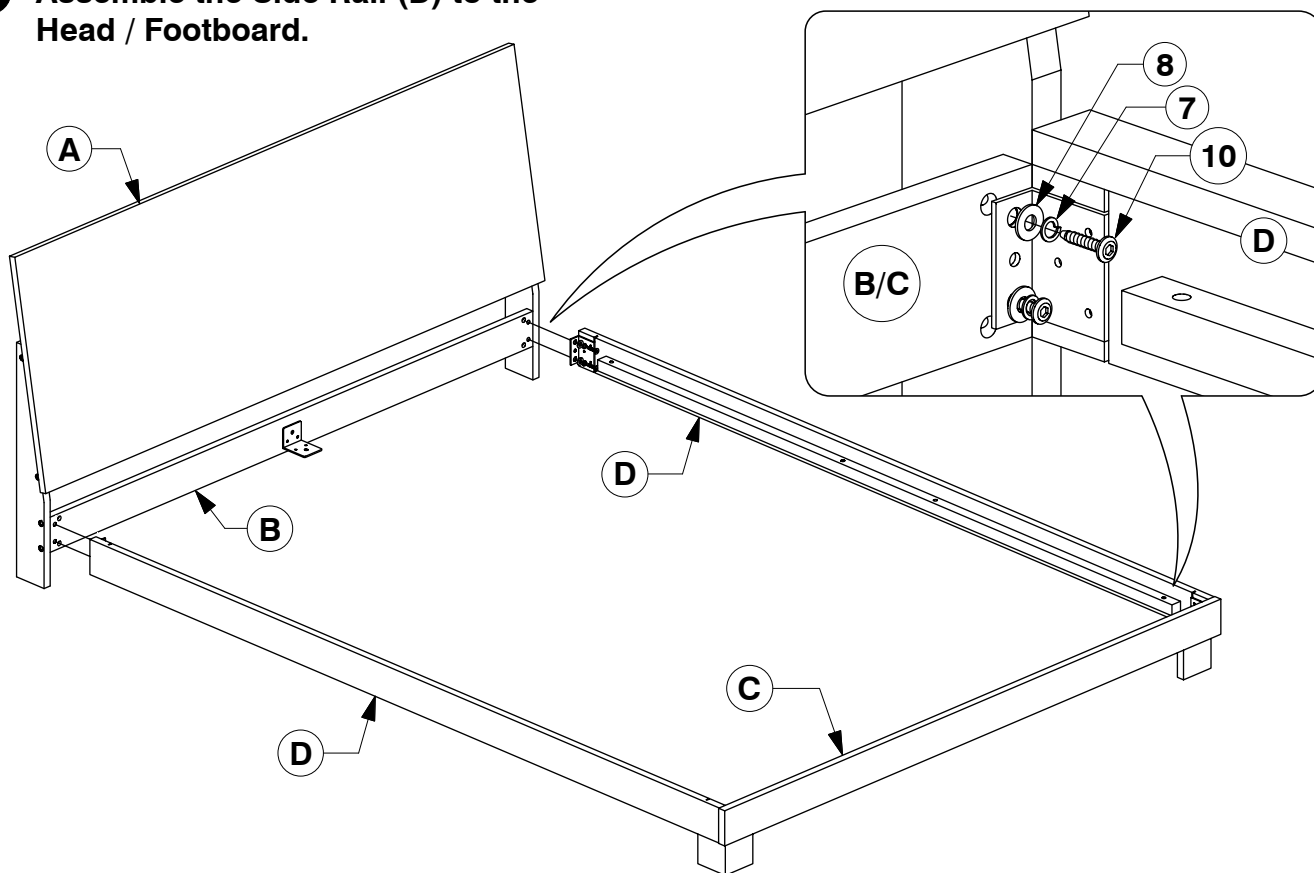

- 10 Bolt the Long Support (E) to the Center Rail Brackets (2) on the Headboard / Footboard.**

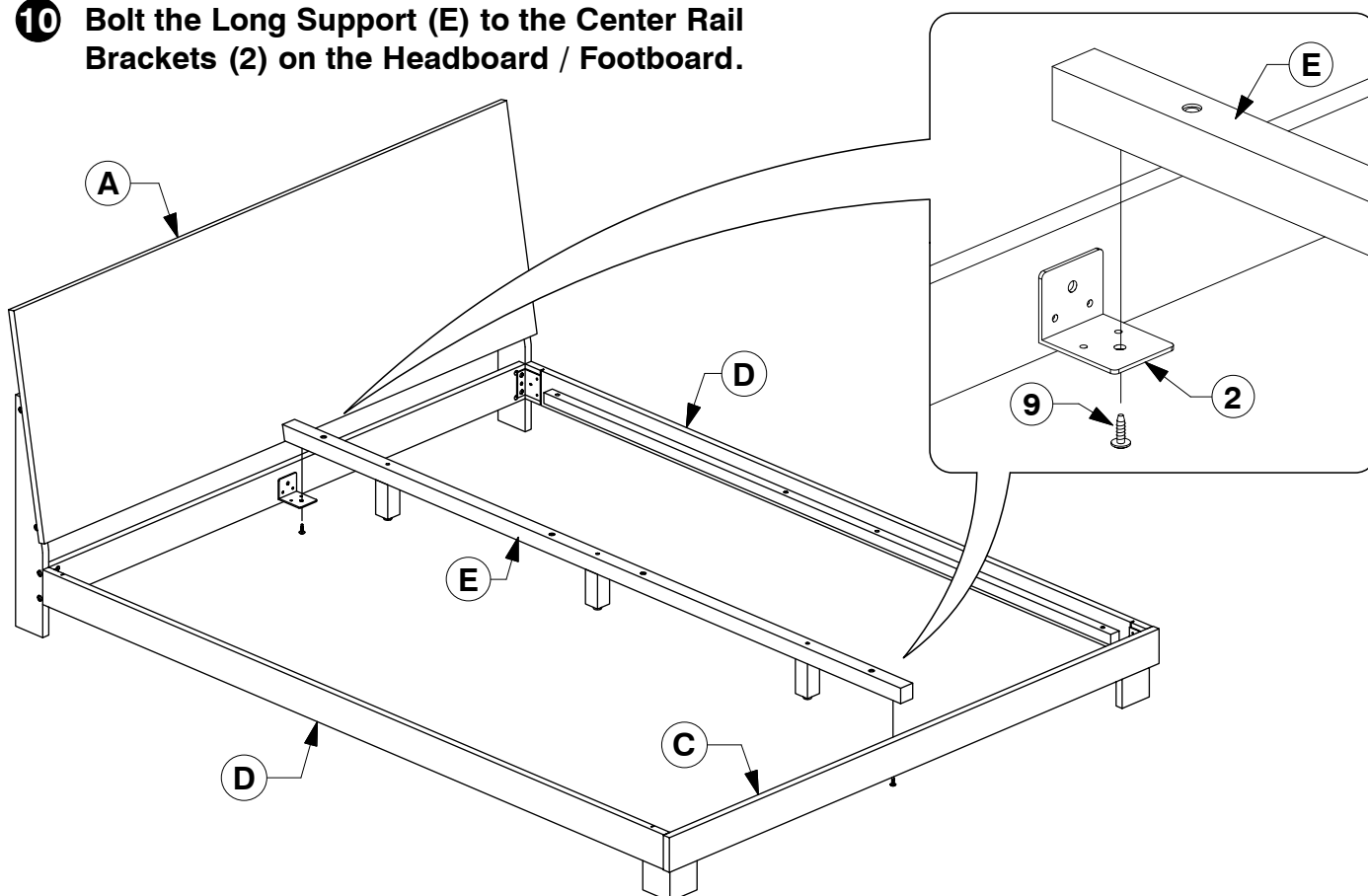

Queen Bed

Assembly Instructions

W11-0920

- 11** Bolt the Bed Slats (L) to the Side Rail (D).

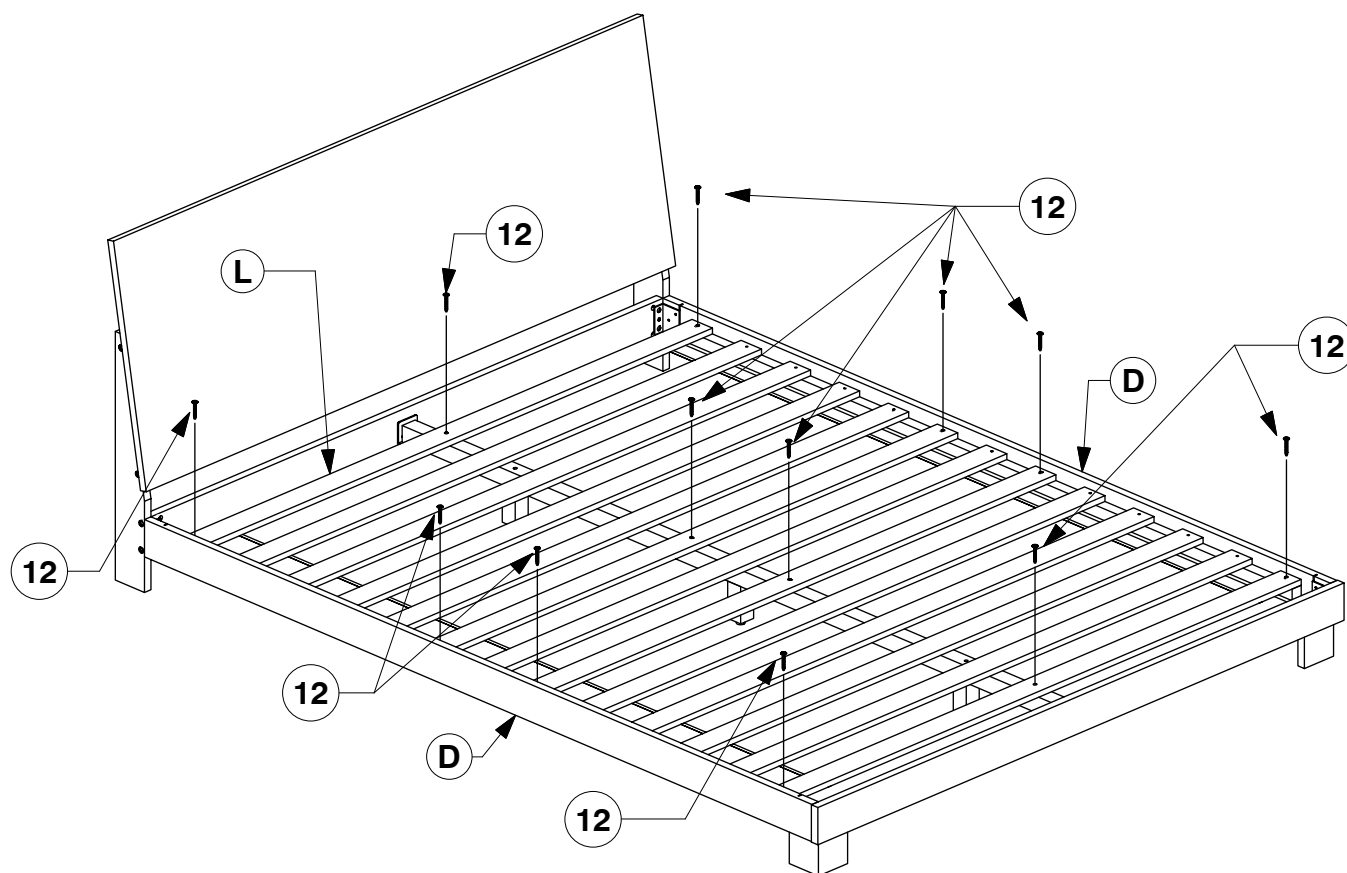

- 12** Screw the Bed Slats (L) to the Side Rail (D).

