

Make Yourself Comfortable

We're glad you're here.

*This piece is designed for comfort —
and following pages are the setup guide.*

*Assembly is beginner-friendly and straightforward.
You do not need any tools for installation. And now,
here we go.*

ASSEMBLY INSTRUCTIONS

Please check the lists before installation

A MODULE COMPONENTS

Armrest 1

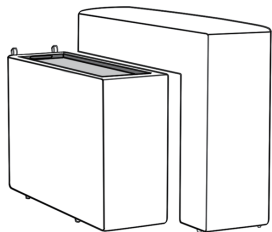

X1

Armrest 2

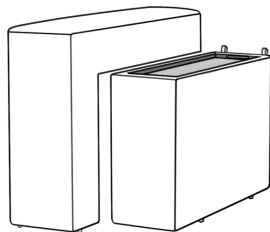

X1

BL MODULE COMPONENTS

Seat frame

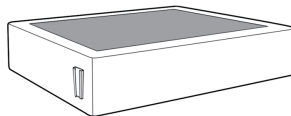

X1

Couch cushion

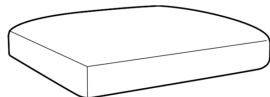

X1

Sofa backrest

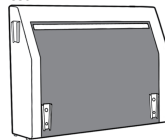

X1

Solid wood leg



X4

Plastic gasket



X4

ASSEMBLY OF MODULE A

Step1:

Take out the armrest 1 and 2 module from carton A, and take out the armrest bag.

Step2:

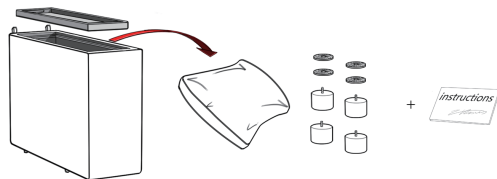

Armrest1 and Armrest2

CARTON BL ASSEMBLY

Step1:

Seat frame and backrest are in carton BL, Remove all parts from the carton BL, Place them on protected surface or carpet.

Step2:

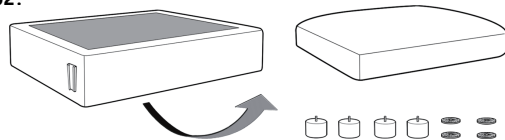

The cushion will be wrinkled due to slight compression, and will recover after a period of time.

Step3:

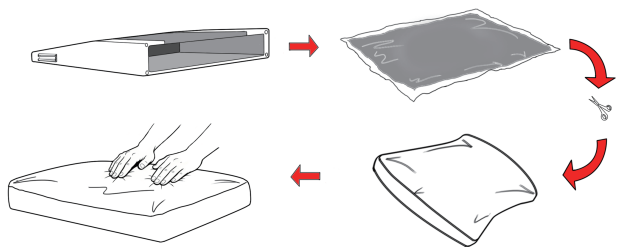

Remove the sofa bag from the bottom of the backrest, gently tap against the bag, Let it fluff up.

Step5:

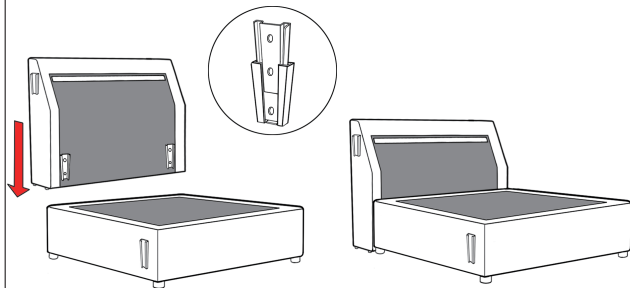

Step4:

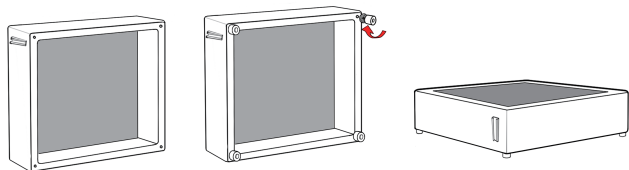

Install wooden sofa feet.

Step6:

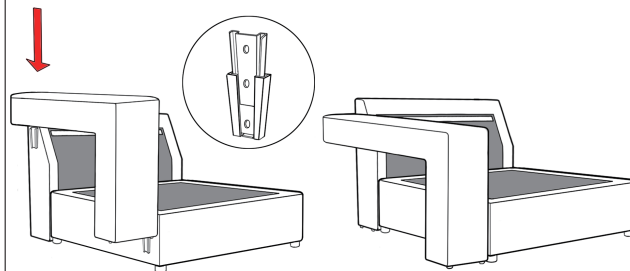

Connect Armrest 1 to the seat frame and backrest using the metal fasteners.

Step7:

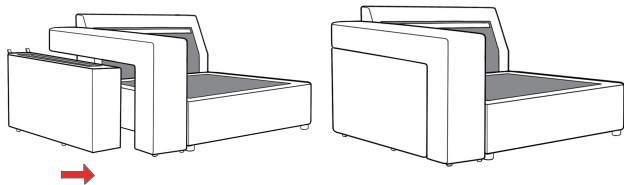

Place the coffee table section under the armrest to form an integrated unit with the armrest.

Step8:

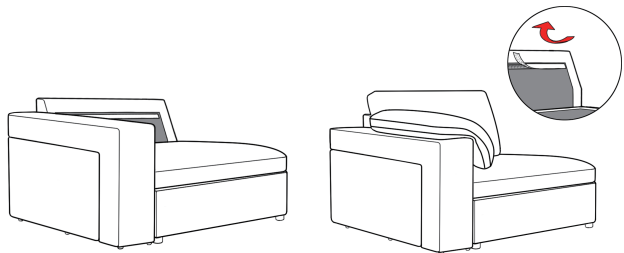

Peel off the fabric attached to the hook-and-loop fasteners on the backrest, then place the seat cushion, back cushions, and armrest cushions.

B MODULE COMPONENTS

Seat frame

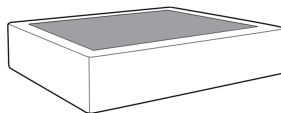

X1

Couch cushion

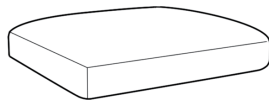

X1

Sofa backrest

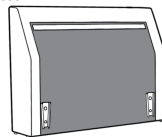

X1

Solid wood leg



X4

Plastic gasket



X4

CARTON B ASSEMBLY

Step1:

Seat frame and backrest are in carton B, Remove all parts from the carton B, Place them on protected surface or carpet.

Step2:

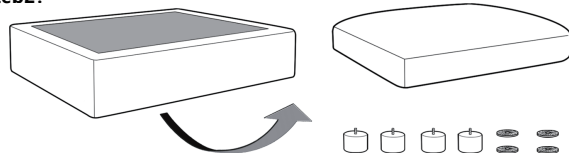

The cushion will be wrinkled due to slight compression, and will recover after a period of time.

Step3:

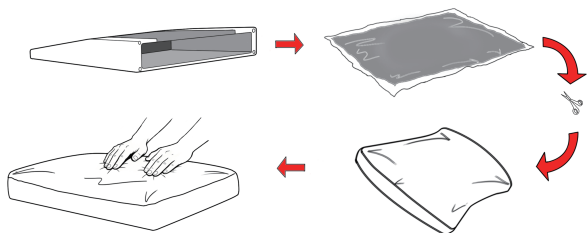

Remove the sofa bag from the bottom of the backrest, gently tap against the bag, Let it fluff up.

Step5:

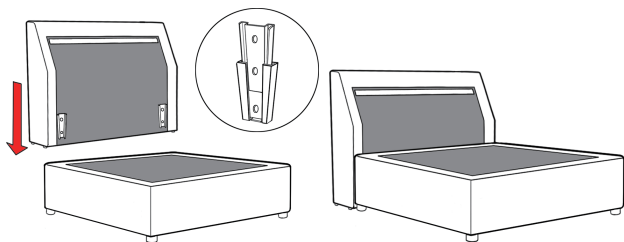

Step4:

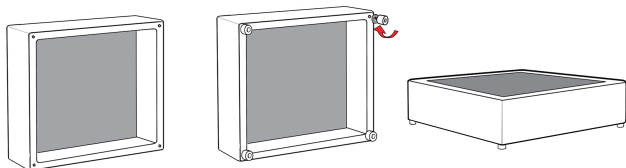

Install wooden sofa feet.

Step6:

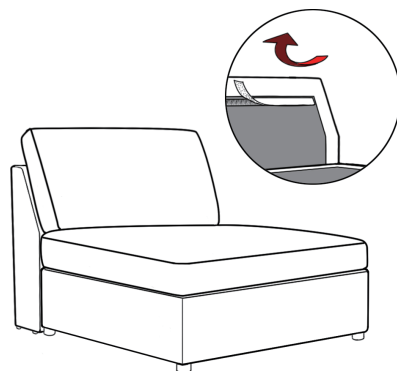

BR MODULE COMPONENTS

Seat frame

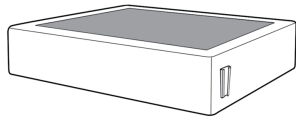

X1

Couch cushion

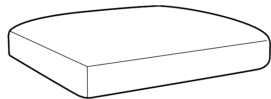

X1

Sofa backrest

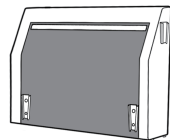

X1

Solid wood leg



X4

Plastic gasket



X4

Step3:

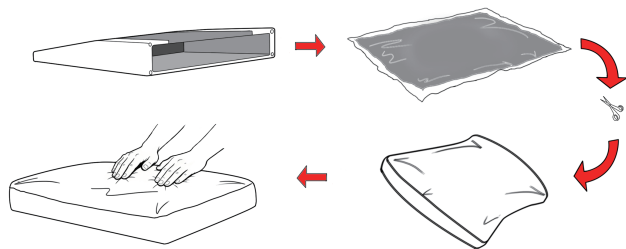

Remove the sofa bag from the bottom of the backrest, gently tap against the bag, let it fluff up.

CARTON BR ASSEMBLY

Step1:

Seat frame and backrest are in carton BR, Remove all parts from the carton BR, Place them on protected surface or carpet.

Step2:

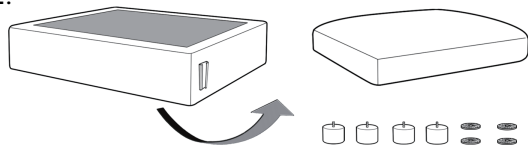

The cushion will be wrinkled due to slight compression, and will recover after a period of time.

Step4:

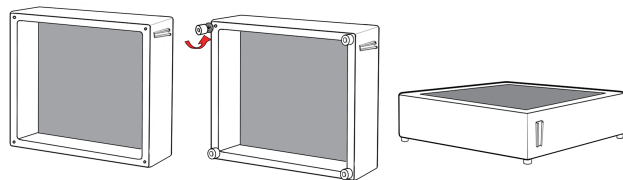

Install wooden sofa feet.

Step5:

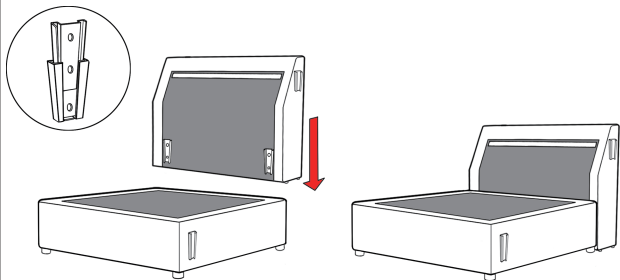

Step7:

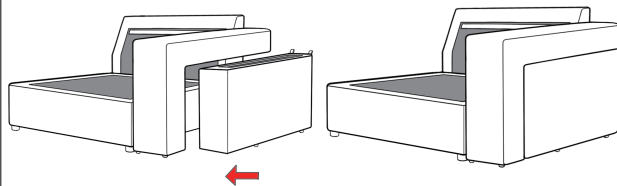

Place the coffee table section under the armrest to form an integrated unit with the armrest.

Step6:

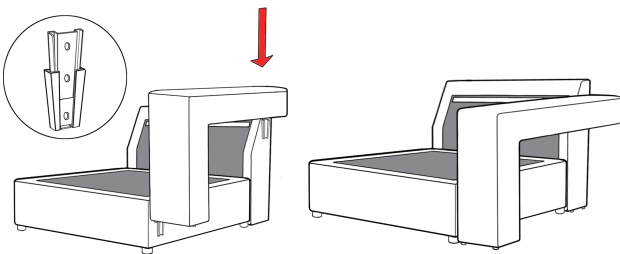

Connect Armrest 2 to the seat frame and backrest using the metal fasteners.

Step8:

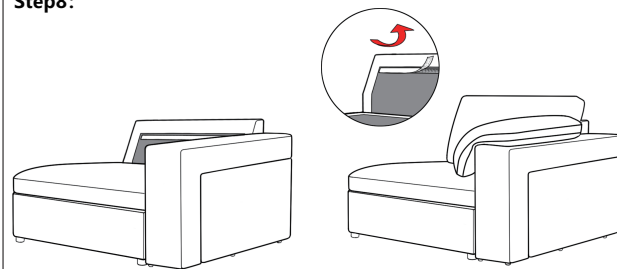

Peel off the fabric attached to the hook-and-loop fasteners on the backrest, then place the seat cushion, back cushions, and armrest cushions.

C1+C2 MODULE COMPONENTS

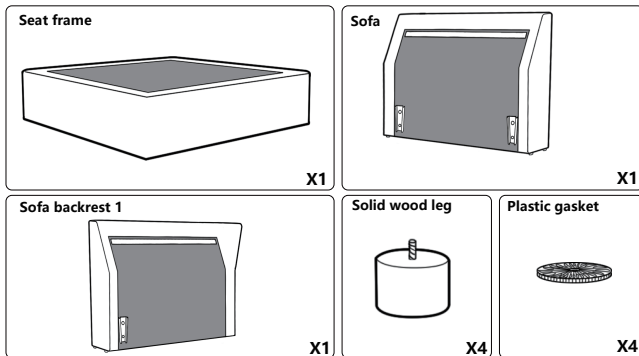

Step3:

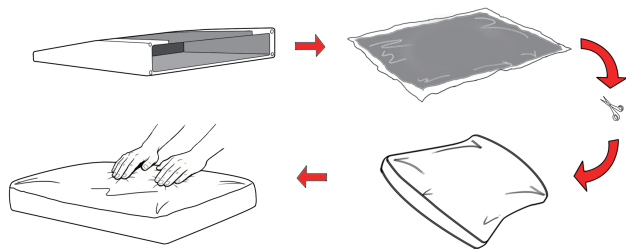

Remove the sofa bag from the bottom of the backrest1 and 2, gently tap against the bag, Let it fluff up.

CARTON C1 AND C2 ASSEMBLY

Step1:

Seat frame and backrest are in carton B, Remove all parts from the carton B, Place them on protected surface or carpet.

Step2:

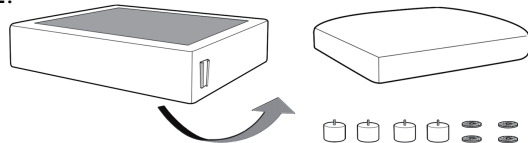

The cushion will be wrinkled due to slight compression, and will recover after a period of time.

Step4:

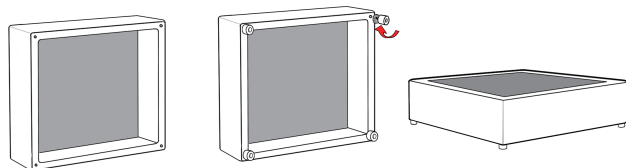

Install wooden sofa feet.

Step5:

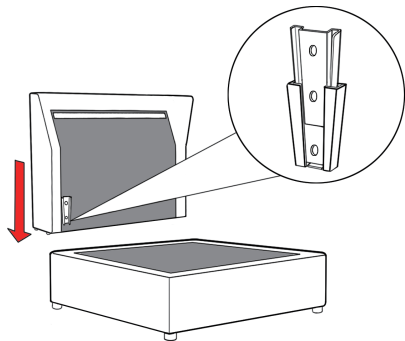

Step7:

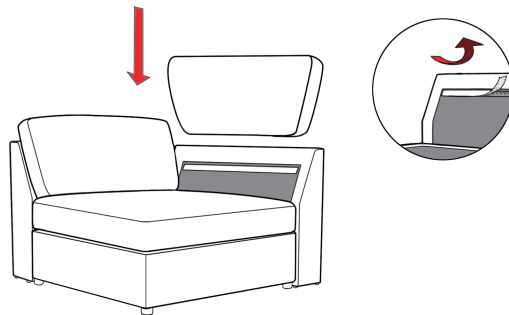

Step6:

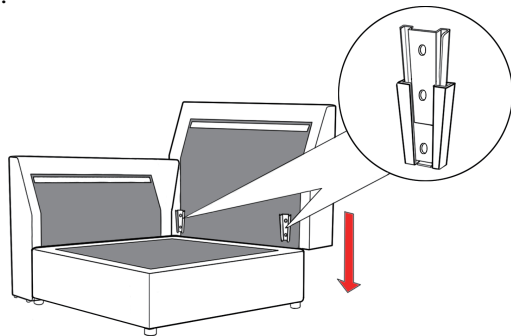

Step8:

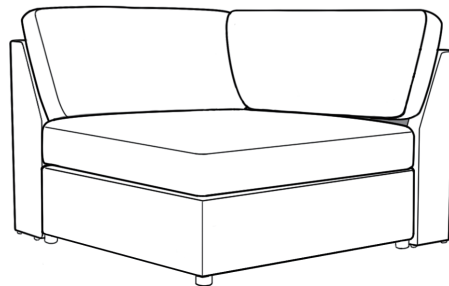

D MODULE COMPONENTS

Seat frame

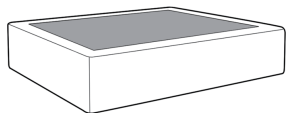

X1

Solid wood leg



X4

Couch cushion

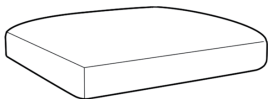

X1

Plastic gasket



X4

Step3:

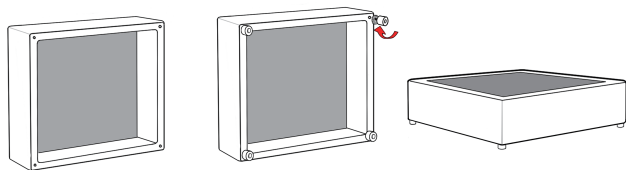

Install wooden sofa feet.

CARTON D ASSEMBLY

Step1:

Seat frame and backrest are in carton D, Remove all parts from the carton D, Place them on protected surface or carpet.

Step2:

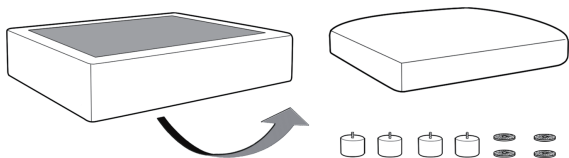

The cushion will be wrinkled due to slight compression, and will recover after a period of time.

Step4:

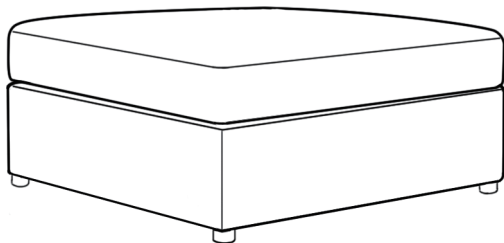

MORE COMBINATIONS

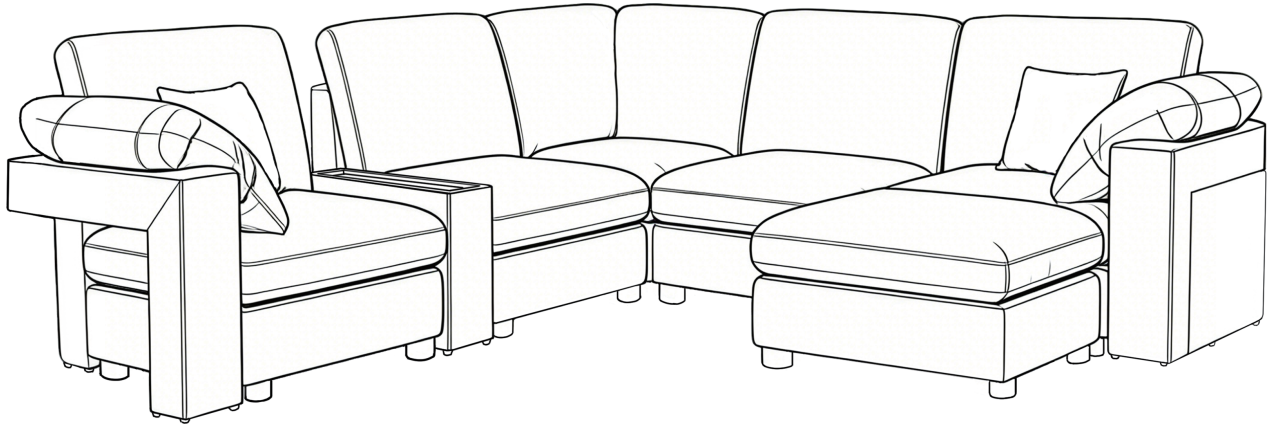

Thanks to its modular design, this sofa allows for endless combinations to suit your space.

Usage Guide: Armrest-Embedded Coffee Table 1、 2

1



Take it out under the armrest.

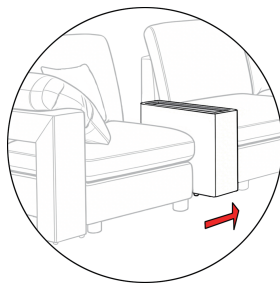

Place between sofa modules.

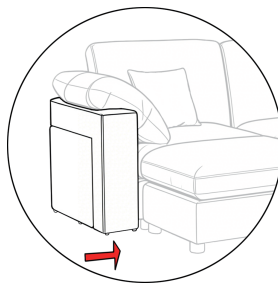

Put it under the armrest when not in.

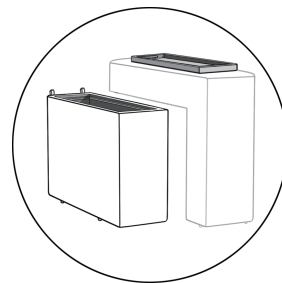

The solid wood tray is detachable for separate use, and the table features internal storage space.

2



Take it out under the armrest.

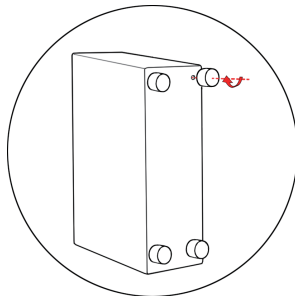

Install the wooden legs.

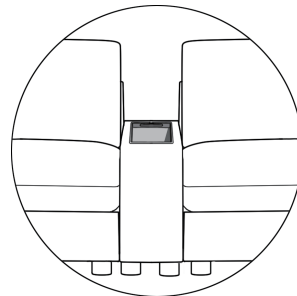

Combine together.

Gentle Note

Wooden legs need to be installed if you use the coffee table frequently, which can enhance the height and stability. However, if you want to put it under the armrest, you need to tear down the legs first.

Gentle Note

If you encounter any issues , please feel free to contact us via email.

We are delighted to know that you have successfully assembled your sofa.

We would like to make invitation of you for sharing your using experience and spreading your joy and happiness.

Thanks for your time and patience. We will be right here waiting for you at anytime, anywhere for anything.

Care & Maintenance

- 1) Avoid contact with hot objects, such as boiling water and electric irons, to prevent deformation and damage.
- 2) To avoid scratches, such as knives and scissors, prevent them from getting cut.
- 3) Avoid sun light Shining It directly so as to prevent cover layer from changing color and aging earlier.
- 4) The long-pile fabric is not suitable for hand washing or machine washing. For stains, please dry clean only.
- 5) If the sofa is smelling, please try to air it 24-48 hours and the smell will give away.
- 6) To avoid pilling or deformation of the fabric, do not use violent scrubbing or brushes.
- 7) Please use the specified detergent to wipe and avoid using bleach or bleach containing chlorine prevent fading and aging of the fabric

**Warm tips : Material certified according to OEKO-TEX® STANDARD 100
Every Part of the Fabric has been tested and is harmless to health.**

Thank you 😊