

# **INFLATABLE SPA OWNERS MANUAL**

PH050011-R6RAT

Read Carefully Before Use  
Keep for Future Reference

# SAFETY INFORMATION

## DANGER!

### General Safety Instructions

- Consult your primary care physician before making use of this spa. Do not use this spa without specific approval from your physician, you are pregnant or potentially pregnant, obese, or have a history of heart disease, abnormal blood pressure, or diabetes.  
To avoid severe personal injury, property damage, or even death, it is crucial to carefully follow all assembly and operation instructions. If any part of the instructions is unclear, too difficult to perform independently, or requires special modifications for your home, please seek assistance from customer service or a local contractor. Also, remember to keep these instructions for future reference and include them with the spa if it is ever given or sold to a third party.
- Use this spa only in full compliance with all applicable local and national laws and standards. In particular, permanent connection to fixed wiring or protective fencing may be required in your area.
- **DO NOT** allow children or persons with impaired physical or mental capabilities—particularly those insensible to heat or pain in their extremities—to use the spa without close supervision at **ALL** times. Do not allow pets or children under the age of 8 to use the heated spa at all.
- **ALWAYS** ensure at least one person present is familiar with life-saving procedures for drowning and heat exhaustion. Additionally, have at least one phone accessible for use in case of emergencies. If necessary, seek out classes in such procedures from local authorities or charities.
- **DO NOT** operate this spa if any component is missing, damaged, or shows signs of malfunction. Repair or replace problematic components before further use. Always fully replace any damaged power cords. Never replace any parts with non-identical ones.
- **DO NOT** leave this spa unattended while in use.
- **ALWAYS** securely cover and lock the spa during heating and between uses to prevent unauthorized use, especially by children.

### Electrical Safety Instructions

- **ONLY** this spa with stable and compatible grounded power sources equipped with a ground fault circuit interrupter (GFCI) or residual-current device (RCD) rated to trip at 30 mA or less. Do not use with 3-to-2 prong adapters, ungrounded extension cords, an external switch, timer, or circuit. Do not regularly turned on and off by your utility. This spa with stable and compatible grounded power sources equipped with a ground fault circuit interrupter (GFCI) or residual-current device (RCD) rated to trip at 30 mA or less. Do not use with 3-to-2 prong adapters or ungrounded extension cords. Do not use with an external switch, timer, or circuit. Do not regularly turned on and off by your utility.
- **DO NOT** use this spa while the power cord or socket is wet or when it is raining. Never install it in another body of water. Apart from the waterproof control panel, never touch any electrical component with wet hands or allow them to become wet during use. Allow time for wet components to dry completely before further use.
- Ensure all electrical sockets and exposed electrical connections are at least 3 m (10 feet) away from the spa. Avoid using any charging or extension cords within this distance.

- Electrical devices and components not specifically designed to use safety voltages below 12v **MUST** be entirely inaccessible to any person in the spa. Electrical transformers, junction boxes, hardwired switches, televisions, lights, telephones, etc. should be at least 2 m (6'7") away at all times. **NEVER** bring a charging mobile phone near the spa and never allow any electrical device to be placed or used in such a way that it might fall into the water under **ANY** circumstance.
- To minimize the potential for electric shock, it is imperative to install this spa at a minimum distance of 2 meters (6 feet 7 inches) from all conductive metal surfaces. In the event that any metal surface is located closer than this recommended distance, it must be securely connected to a designated terminal box using a solid copper conductor with a thickness of at least 3.3 millimeters (8 gauge). It is strictly prohibited for any metal surface to come into contact with the spa's water or its splash zone under any circumstances.
- The distances described above are absolute and not limited by any walls, partitions, or other obstacles. Maintain such minimum distances at all times in all circumstances.
- **ALWAYS** fully disconnect this spa from power before undertaking any cleaning, maintenance, or repair.

## Water Safety Instructions

- The spa should only be installed on a firm, flat, nonslip surface that can support its full weight when filled. Ample additional support should be provided for the weight of the bathers and other items. The surface must be impervious to moisture damage, and the surrounding area must be able to handle the expected humidity created by the heated water. If installing the spa outdoors, ensure that all rocks and sharp objects are carefully removed from the area.
- An adequate drainage system **MUST** be provided to safely deal with any overflow and to permit easy emptying of the spa, even if the spa is set up outdoors.
- **DO NOT** set up or leave the spa out in temperatures below 4°C (40°F). Do not provide power or turn on the spa if there is any possibility water in its lines has frozen.
- **NEVER** provide power or turn on the spa if the water level is below the minimum line. Always add more water first. Running the system dry or with insufficient water **WILL** cause malfunctions and void any stated or implied warranty.
- **ALWAYS** open the spas cover before activating its jets.
- **DO NOT** run or allow others to run in the pool area.
- **DO NOT** jump or dive into the pool or allow others to do so.
- **DO NOT** allow the water to become dirty or stagnant. Replace the water regularly, but do not run the filtering system for more than 48 hours at a time. If you will use tap or hose water to your spa, filtering the water before use to prevent lime scaling is recommended. Similarly, do Not use chemical purifiers that include calcium ions, which can also create scale.
- Chemicals should always be added to water carefully. Water should never be added to concentrated chemicals.
- **DO NOT** use bath salts or oils in the spa. All such products will damage the spa and your water quality, and some are capable of creating chemical burns or poison gas in combination with chlorine and other common chemicals.

## Heat Safety Instructions

- Adequate ventilation **MUST** be provided to safely deal with the expected heat and humidity.
- **ALWAYS** check the water temperature before entering the spa. Healthy adults should not enter the spa if the temperature exceeds 40°C (104°F). Children, pregnant or possibly pregnant women, and individuals using certain medications should only use lower temperatures as directed by their physicians to avoid the risk of burns, heart arrhythmia, and miscarriage.
- **NEVER** add preheated water hotter than 40°C (104°F) to the spa. Limit use of the spa to a maximum of ten minutes at a time when it is at its hottest. Exit the spa immediately if you feel uncomfortable or drowsy.
- **DO NOT** consume drugs, alcohol, or cognition-impairing medication while using this spa. Use of such substances in spa greatly increases the risk of hypothermia, a significantly elevated blood temperature. Symptoms include dizziness, drowsiness, insensitivity to heat, loss of coordination and focus, and sudden and uncontrollable loss of consciousness. This risks permanent health damage and accidental drowning, as well as miscarriage in pregnant women.
- **Do NOT** run the heater for more than 48 hours at a time.

## HEATING GUIDE

Heating the water in your spa will usually take between 1-1.5°C / 2-3°F per hour, however this depends on starting water temperature and ambient temperature. The table below gives a guide to the approximate time required to heat the spa to 40°C / 100°F in different conditions.

AMBIENT TEMP.	WATER TEMP.	SET TEMP.	HEATING TIME
10°C / 50°F	10°C / 50°F	40°C / 100°F	23 Hours
15°C / 59°F	15°C / 59°F	40°C / 100°F	18 Hours
20°C / 68°F	20°C / 68°F	40°C / 100°F	14 Hours
25°C / 77°F	25°C / 77°F	40°C / 100°F	11 Hours
30°C / 86°F	30°C / 86°F	40°C / 100°F	8 Hours

# PRODUCT DIAGRAM

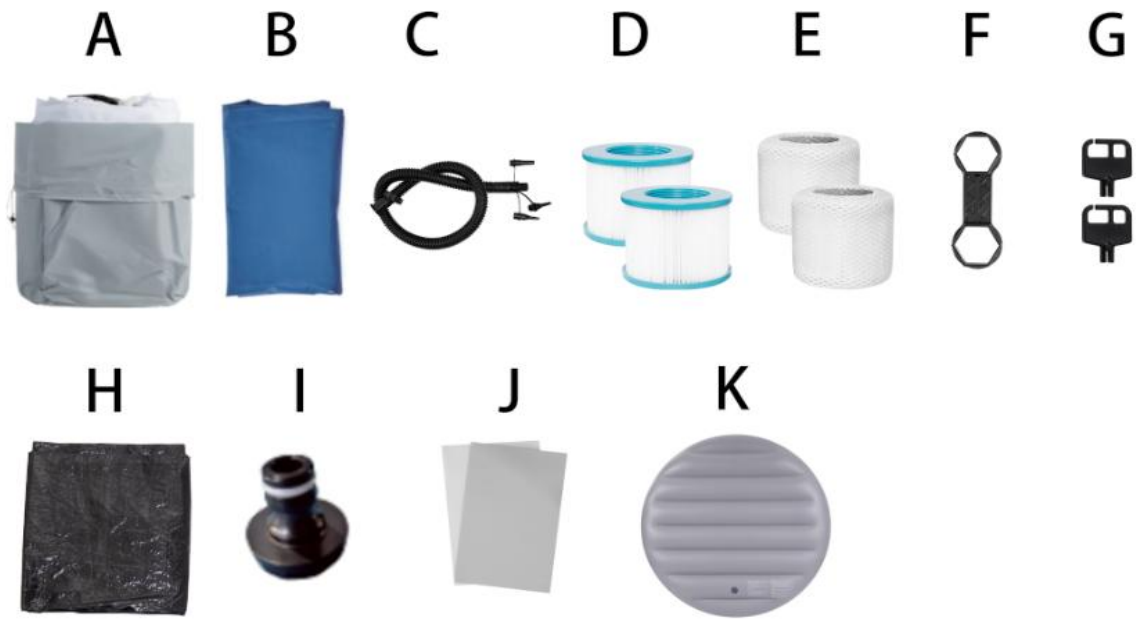

Item	Name	Qty.
A	Inflatable Spa with Electric Pump	1
B	Spa Cover	1
C	Air Hose	1
D	Filters	2
E	Filter Cover	2
F	Spanner	1

Item	Name	Qty.
G	Keys	2
H	Mat	1
I	Hose Connector	1
J	Patches	2
K	Inflatable lid	1

## Filters sizes

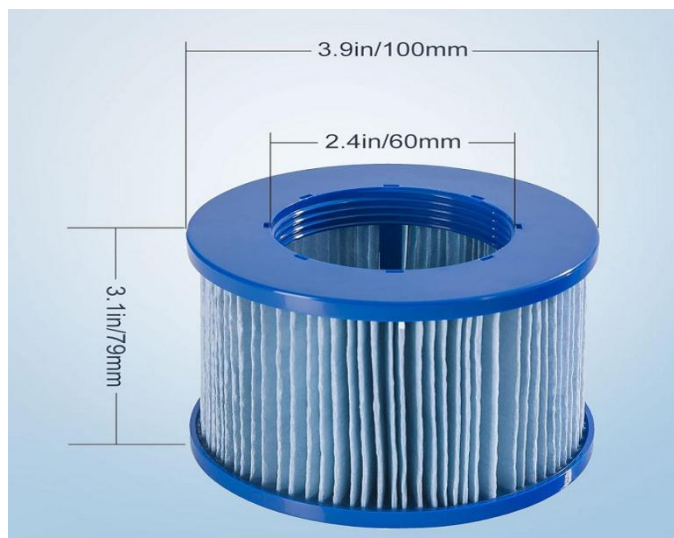

# SPECIFICATIONS

Model		PH050011-R6RAT	
Capacity		4-6 Adults	
Volume		240 gal.	1000L
Diameter	Inner	65 in.	165cm
	Outer	81.9 in.	208cm
	Jets	0.12 in.	3 mm
	Drain Tube	1.2 in.	3.1 cm
Height		25.6 in.	65 cm
No. of Jets		130	
Input Power		110-120V~60 Hz	
Rated Power	Jets	600 W	
	Heater	1350 W	
	Filter	30 W	
Max. Temperature		104°F	40°C
Filtration Rate		6 gpm	23 L/min.
Power Cord Length		10ft. 10 in.	3.3 m
Net Weight		53 lb.	28.5 kg

## CONTROL PANEL

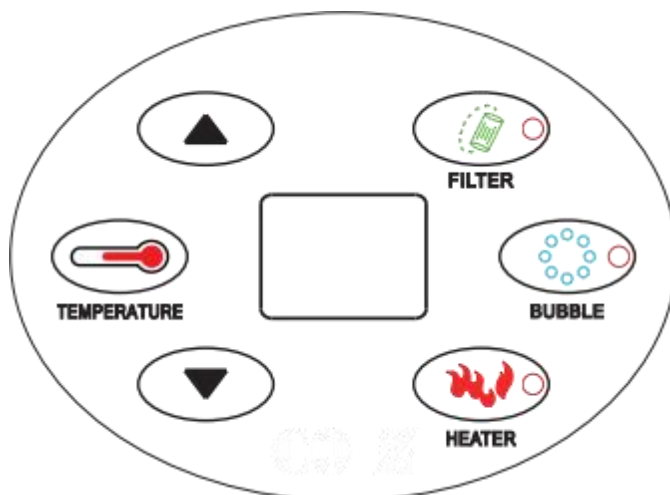

**FILTER:** Press the FILTER button to activate the spa's water circulation, which repeatedly passes the water through the filter cartridge. The indicator light on the button will let you know when the system is active. Press the button again to deactivate the filter system when you are finished.



Never activate the spa if the water is below the marked minimum level.

**HEATER:** This button activates the spas heating system, which requires water to circulate through the filter system. The filter system will automatically activate if it is not already on when the heater is started. The light on the button will indicate that the system is active. Press the button again to deactivate the heating system when you are finished and separately deactivate the filter system if you desire.



The spa's heating system is primarily designed to keep your water tempered. The heating system can only heat a completely full spa at 1–2°C (2–4°F) per hour. Adding preheated water to begin use is highly recommended, but such water should never exceed 40°C (104°F).

**TEMPERATURE:** Press this button after the heater has been activated to set the spas target temperature. The control panel display will begin to flash, showing that the system is waiting for your adjustment.



The spa's default temperature is 40°C (104°F), but remember to lower the temperature if you will be in the spa for more than ten minutes at a time. Also lower the temperature for children, pregnant or potentially pregnant women, and some others. (See Safety Information above.)

▲ and ▼: Press these buttons after hitting **TEMPERATURE** to raise or lower the spa temperature. Once the new temperature is set, the spa will return to displaying the actual temperature and begin heating the water to reach or maintain your target temperature. When this temperature is reached, the spa will stop heating until it detects that the water is 2°C (3.6°F) below the target temperature.

**BUBBLE:** Press this button to activate the spas jets for up to 20 minutes. The light on the button will indicate that the system is active. Press the button again to deactivate the jets early. This button is also used to inflate the spa (see below).



After the jets have been running for 20 minutes, the system will stop and lock out commands to restart for a 10 minute cooling period. At the end of this time, press **BUBBLE** again to restart. Do not activate the jet system while the cover is in place.

# INSTALLATION



Prior to installation, ensure that the spas setting will be appropriate for use. It must be flat, stable, able to easily bear the weight of the fully-filled spa, resistant to high humidity, and out of direct sunlight. Adequate drainage and ventilation must be provided, and all metal surfaces and electronic devices must be kept at a suitable distance. See the Safety Information above for more details. It is the owners responsibility to maintain the sites suitable condition at all times.

1. Remove all packing materials, being careful to keep children from playing with them. Store the original packaging through your warranty period in case of any return. Check all components and accessories for any damage during transport. If any damage is discovered, notify customer service and do not continue with installation until the spa is completely repaired.
2. Spread the spa (A) out, making sure it is right side up. It is highly recommended to set your spa on the provided mat (H) to provide a protective non-slip surface.
3. Unscrew the air outlet cap under the control panel. Connect the wide end of the air hose (c) to the outlet and screw it tight. As the picture shows

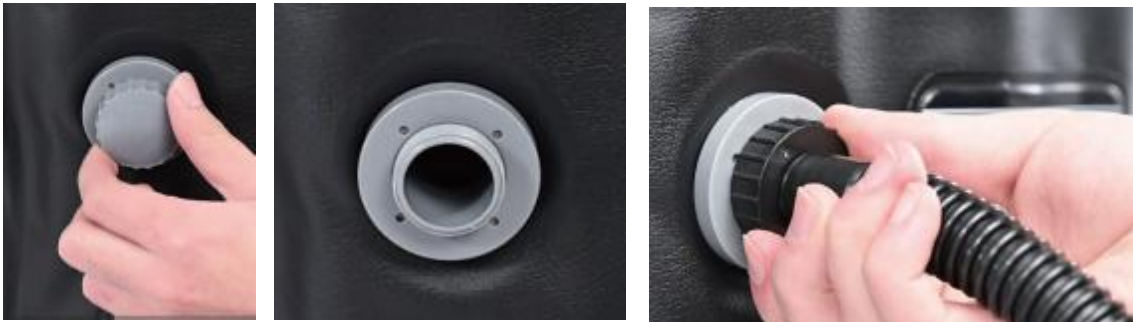

4. Unscrew the cap of the air valve at the bottom of the spa. Insert the narrow end of the air hose into the valve and push until it is secure.



5. Connect the power cord to a stable, compatible, and well grounded power source equipped with a GFCI or RCD rated to trip at 30mA or less. Press **RESET** on the power plug and the control panel will display the detected current temperature in degrees Celsius.



6. Press **BUBBLE** On the control panel to start inflation.when the spa becomes firm, press **BUBBLE** again to stop inflation. Disconnect the air hose from the air valve and seal the valve tightly by replacing and tightening its cap. Remove the hose from the air outlet and close it completely by replacing and tightening its cap.

△ Stay with the spa during this process. **DO NOT** allow it to overinflated.



7. Seal the drain tightly on the floor inside the spa using its cap as shown.



8. Place the filter cover (E) over either of the provided filters (D) and screw the filter onto the water inlet inside the spa as shown.



9. Unscrew the cap of the drain tube underneath the spa and connect it to your location's drain with a matching hose. If necessary, make such connection using the provided 5/8" hose connector (I).



10. Fill the inflated spa with water to some level between the minimum and maximum watermarks. You can use unheated water from your home's hose and wait for the system to heat it, but using preheated water is highly recommended. For repeated use of tap or hose water, it is recommended that the water be filtered separately to prevent possible scale build-up. For best results when using the spa to heat large amounts of water, always keep the cover locked in place while the water heats. (See Step 11 for how to lock the cover.)

⚠ Never add water hotter than 40°C (104°F) to the spa.



11. If you will not immediately use your spa, unfold the spa cover (B), place it over the filled spa buckle the bands, and lock it in place using either of the provided keys (G) as shown.



## OPERATION

1. Prepare the location and install the spa as described above. Fill it with water to a level between The minimum and maximum fill lines marked below the control panel. Use preheated water 40°C (104°F) or cooler or cover the spa, lock the cover, and wait for the water to heat to The proper temperature.
2. Press the **HEATER** button to activate the filtration and heating systems. The default target temperature is 40°C (104°F). Press **TEMPERATURE** and use ▲ and ▼ if you want or need to set a lower temperature. Cover the spa and lock the cover if you will need to wait for it to heat or need to leave the activated spa for any reason.
3. Once the water reaches the desired temperature, remove the cover and enjoy your spa, activating the jets as needed with the **BUBBLE** button. It is important to not exceed the spa's capacity, prohibit children under the age of 8 from entering the heated spa, and never leave older children unattended. Ensure they and any other users understand and observe **ALL** the rules described in the Safety Information above.



Do not use the spa for more than 10 minutes at a time on its highest heat settings. If you begin to feel drowsy or uncomfortable at any point, leave the water immediately.

- The filtration system does not need to be continuously active during use, but it is necessary for the water to circulate as long as the heater is active. The jets may be used as needed, but remember that they can only be used continuously for 20 minutes at a time, after which the System will lock out further use for a 10 minutes period. Do not run the filtration or heating.

System longer than 48 hours continuously, and cover and lock the spa at any point when it has water but cannot be attended.

- when you are done, you can leave the spa inflated and full of water so long as it is securely covered and locked in a suitable location out of direct sunlight without any possibility of freezing or near freezing temperatures. Be sure to use appropriate chemicals to maintain the water's safety, run the filtration system periodically to circulate everything, and change the water at least once a month. Alternatively, fully drain, clean, and dry the spa between each use.

### Water treatment

To ensure the comfort and safety of SPA users, the water parameters must be well-balanced. The mineral content of water is constantly changing and can be directly affected by persons in the water, water treatment products and by evaporation. Deviations from the desired values can cause deposits that can damage the SPA. As the volume of water is relatively small, it is difficult to maintain constant values.

It is therefore important to observe the following points: We suggest begin water treatment immediately after filling the spa. To ensure your health, you need to turn on the filtration function for a period of time before using the spa.

Check the following water parameters and adjust them as follows:

	Minimum	Ideal	Maximum
Free chlorine	2 ppm	2 - 4 ppm	5 ppm
pH	7	7.2 - 7.6	7.8
Total alkalinity (TA)	60 ppm	80 ppm	120 ppm
Calcium hardness (CaCO <sub>3</sub> )	100 ppm	150–250 ppm	350 ppm
Active oxygen	5 mg/l	6 - 7 mg/l	8 mg/l
Bromine	3 mg/l	3.5 - 4.5 mg/l	5 mg/l

- The indicated water values must be checked regularly and adjusted (every day, if necessary)
- Use a good and clearly legible testing set for these tests. There are test strips with which you can measure free chlorine, active oxygen, bromine, pH, water hardness and total alkalinity at the same time.
- Use water treatment products to correct and adjust the values.
- If the SPA is being used regularly, the water must be completely changed at least every two months. If the SPA is used more intensively, the water must be changed more frequently.

**CAUTION: If the pH value and chlorine content are not corrected, it can have negative effects on the service life of components, which can invalidate the warranty.**

**CAUTION: Never use fragrances. These oil-based products can result in deposits and leaks. The use of fragrances will invalidate your warranty claim.**



**NEVER** leave the spa accessible to unsupervised children or exposed to low temperatures. In temperate climates, fully drain, clean, dry, and store the spa (see below) each autumn and do not reinstall it until spring temperatures are consistently warm.

6. To drain the spa, dry your hands, turn off the spa by pressing **TEST** on its power plug, and disconnect its power cord from power.



Remove the cap of the drain inside the spa and keep an eye on the spa as it drains. When the spa is mostly empty, dry your hands, reconnect it to power, reactivate it, press **BUBBLE**, and allow the jets to clear water from their line for at least 5 minutes. Do not run the filtration or heating system at this low water level and do not tip or angle the pool to speed draining until it is almost completely empty. When all water has drained, close the drain.



In the event of blockage, leakage, or other problems during this process, **IMMEDIATELY** replace the cap of the drain and correct the problem(s) before continuing to drain the spa or allow time for it to air dry.

# MAINTENANCE

## GENERAL CARE

- Always disconnect the spa from power when performing any cleaning, maintenance, or repair. In particular, disconnect the spa from power while the filters removed for cleaning or replacement.
- Wash your spa as needed using a mild soap or detergent and soft cloths. Do not use caustic chemicals, harsh abrasives, or rough brushes. Rinse thoroughly after cleaning, drain the water from rinsing completely, and dry the spa or allow time for it to air dry. Do not use soapy or rinsing water for standard operation of the spa.

## WATER PURITY

- The filter cartridge should last at least 168 hours of continuous. During use, clean the filter cover and filter as needed and at least once every 84 hours of continuous use or every month, whichever comes first. Replace the filter or its cover if they become deformed or discolored after thorough cleaning.
- The spa automatically counts down the filter's 168-hour service life for you. The error message FC will appear on the control panel display once it is time to change the cartridge. An alarm will sound and the indicator lights for **FILTER** and **HEATER** will come on but neither system will operate until you press the **FILTER** button to acknowledge the situation. Replace the current filter with an identical one as quickly as possible and thoroughly clean or replace its cover. A new countdown will begin automatically.
- Assuming you leave the same water in your spa for more than a day, we do not recommend using pool chemicals in order to keep the water safe and keep your warranty valid. It is safer and more environmentally friendly to simply regularly drain and replace the water. If you still choose to use such chemicals, purchase a water testing kit and consult local pool supply retailers for more details. Be sure to avoid chemicals with calcium ions that can caused destructive scaling in the filtration and heating system. Generally speaking, aim to maintain a pH between 7.2 and 7.8, total alkalinity between 80 and 120 ppm, and free chlorine between 3 and 5 ppm. Lower pH may damage the spa and its components. Water and chemical safety are entirely the responsibility of the owner. If they cannot be carefully and correctly maintained, always empty and carefully clean the spa every two days or so during use.

## DEFLATION AND STORAGE

1. Disconnect the spa from power. Drain all water from the spa and remove the filter as described above.
2. Dry everything or allow it to air dry in the shade. Use of a wet/dry vacuum is recommended, especially for the hoses.
3. Unscrew the **ENTIRE** air valve from the spa and deflation should begin. When the spa no longer deflates on its own, remove the air by pressing down on it as you fold it neatly for storage. For best results, unfold it after it is completely flat, apply a small amount of talcum powder to the vinyl, and fold it neatly again.



4. Store your spa in the carton provided in a cool, dry location out of direct sunlight and out of reach of children. Be sure the storage area will never reach temperatures below freezing, which can damage the vinyl, reduce the service life of your spas components, and void any stated or implied warranty. For best results, do not place heavy objects on top of the spa during storage.

## CAULKING

1. Checking: Periodically check for any punctures as you clean your spa. Look for any places where the soapy water begins to bubble from escaping air. Mark any spots for repair after the spa is dry and deflated.
2. Repair: To properly cover small punctures, use the provided patches (J), ensuring that each patch can span at least 2.5 cm (1 inch) in all directions from the hole. Ensure the area surrounding the puncture is clean, dry, and flat. Apply a thin, uniform layer of suitable adhesive to the patch and position it over the puncture. Smooth the patch to eliminate any air bubbles and securely attach it to the vinyl around the puncture. Allow at least 24 hours for the adhesive to set before re-inflating the spa. Subsequently, apply soapy water around the patch and inspect for any bubbles indicating escaping air.

In the event of a larger puncture or damage to the seams or near the control panel, specialized repair is probably necessary. Contact customer service or a professional service before further use.

## CONTROL PANEL & ELECTRIC PUMP REMOVAL

To have a technician check or repair the electrical connections in the control panel and electric pump, disconnect the spa from power, drain it completely, detach the filter and other accessories, and then remove the panel and pump from the spa as follows:

1. Unscrew the covers of the water outlet and inlet on the spas internal wall using the provided spanner (F) as shown.



2. Flip the cover around the control panel and then remove it from the spa, taking care not to damage the spas external surface with excessive force.



3. Remove the locking nuts by hand, detach the control panel from the spa, and disconnect it from the wiring of the pump.



4. Remove the cap from the air outlet, unscrew the locking ring around it, and remove the air valve as described above.

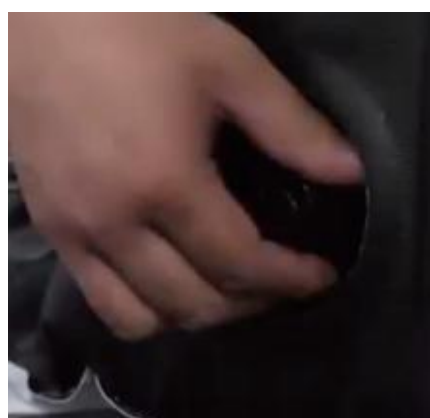

5. Pull down the pump and find the one-way check valve. Loosen the locking bolt on the valve's clamp using a Phillips screwdriver (not included) and then disconnect the valve from the pumps tubing.



6. Carefully remove the pump from the spa.



# TROUBLESHOOTING

Possible Problems	Usual Solution(s)
Inflation fails.	Check for leaks on the spa, repairing any with the provided patch(es).
	Reconnect the air hose firmly to the air valve.
	Re tighten the wide end of the air hose connected to the air outlet.
	Replace the air hose with a new identical one.
	Have a technician check the electrical connections in the control panel.
	Have a technician check the pneumatic system in the electric pump.
The jets do not turn on.	Wait for the jet system to finish resting and try again. They can only be used for 20 minutes at a time, after which the system must cool for 10 minutes.
	Have a technician check the electrical connections in the control panel.
	Have a technician check the pneumatic system in the electric pump.
The water does not heat.	Check that the water is at the proper levels.
	Check that the temperature is set correctly and wait.
	Clean or replace the water filter cartridge.
	Have a technician check the electrical connections in the control panel and the components of the heating system.
The filter does not work.	Clean or replace the water filter cartridge.
	Have a technician check the electrical connections in the control panel and the voltage level of the power supply.
	Have a technician check the magnetic drive in the electric pump.
Water leaks from the spa.	Dry the area as well as possible and check for leaks, repairing any with the provided kit.
The water is dirty.	Check the filter. If it is clean, allow more time for it to work. If it is dirty or full, clean or replace it.
	Consult the instructions for your purifying chemicals. If you are in full compliance but it still fails to work, change to a different brand or kind.

Possible Problems	Usual Solution(s)
Completely unheated	<p>1. Please completely block the water outlet with your hand for approximately 1 minute, and check whether the temperature on the control panel changes? Does not rise the heating element is damaged; rise the heating system is normal, troubleshooting the next problem</p> <p>2. Check whether your filtration system is functioning properly, could you remove both filter cartridges, open the hot tub's heating and filtration system, and use your hand to feel if there is strong suction at the water inlet?</p> <p>(1) no suction: the filter system is damaged</p> <p>(2) less suction: the filter pump is clogged resulting in a reduction in the amount of water intake, affecting the amount of water heated resulting in slower heating</p> <p>(3) stronger suction: filtration system is fine.</p> <p>3. If control panel does not light and control properly, please contact seller to reship control panel; if GFCI and control panel not light, please contact seller to reship GFCI.</p> <p>Warm tips: please send a short video to show the issue you encountered when contact seller.</p>
Slow heating, not reaching the set temperature	<p>1. Please completely block the water outlet with your hand for approximately 1 minute, and check whether the temperature on the control panel changes? Does not rise the heating element is damaged; rise the heating system is normal, troubleshooting the next problem</p> <p>2. Check whether your filtration system is functioning properly, could you remove both filter cartridges, open the hot tub's heating and filtration system, and use your hand to feel if there is strong suction at the water inlet?</p> <p>(1) no suction: the filter system is damaged</p> <p>(2) less suction: the filter pump is clogged resulting in a reduction in the amount of water intake, affecting the amount of water heated resulting in slower heating</p> <p>(3) stronger suction: filtration system is fine. Please check next issue.</p> <p>3. Filter clogged, it needs to clean the filter. Refer to instruction manual to clean the filter.</p> <p>4. If the setting is 104 degrees Fahrenheit, but the maximum temperature can only reach 100, please test whether the maximum temperature is set successfully. Setting method: To set the temperature, press the "Temperature" button and use the "Up" and "Down" buttons to adjust the temperature, your temperature display will flash. Confirm your temperature by pressing the "Temp" button again and finally press the "Heat" button. At this point, the "Heat" button should light up red and the "Filter" button should also light up, indicating that the temperature has been set successfully and the heating process is functioning properly.</p> <p>Warm tips: please send a short video to show the issue you encountered when contact seller.</p>

Leak air	<p>To check for leaks in the spa, please inflate it and then spray soapy water on the surface of the spa (Make sure the check valve is tight). If there is a leak, it will produce bubbles at the leak point. Could you please give this method a try? You can refer to:How to find the air leak using soapy water via scanning the the QR CODE and watch GORHT001-Video 8</p> <p>If you find the hole in the spa, could you please use the PVC (part J) repair tools provided by us and glue (not included) to perform the repair as follows?</p> <ol style="list-style-type: none"> <li>1. Deflate the spa.</li> <li>2. Clean and dry the area to be repaired.</li> <li>3. Cut the provided PVC patch (part J) to the appropriate size.</li> <li>4. Apply glue (not included) to one side of the newly cut patch to ensure uniform distribution of glue.</li> <li>5. Wait for 30 seconds, then attach the patch containing the glue to the damaged area.</li> <li>6. Press firmly on the patch for two minutes to ensure that bubbles that may appear below the patch are eliminated.</li> <li>7. After waiting for 30 minutes, the product is inflated again.</li> <li>8. If the product leaks again, please repeat the above process.</li> </ol>
Leak of water	<p>First, ensure that the spa's internal drain plug is pressed firmly and the external drain cap is tightly closed.</p> <p>Second, observe the location of the leak.</p> <ol style="list-style-type: none"> <li>1. If water is leaking from the vicinity of the bottom of the chassis, please check if the two connections at the bottom of the chassis are properly tightened.</li> <li>2. If air bubbles are coming out of the water inlet or outlet around the case, you can remove the inlet or outlet with a wrench and check to see if the round plastic film at the bottom is misaligned or wrinkled, causing a leak.</li> </ol> <p>(2) If you notice bubbles coming out of the water after filling, it may indicate that the hot tub has holes or cracks in the inner wall.</p>
Usage environment	<ol style="list-style-type: none"> <li>(1) Below 40 degrees Fahrenheit, the product is not recommended.</li> <li>(2) Ambient temperatures around 50 degrees Fahrenheit, the product is recommended for warmer indoor environments, and additional insulation such as air bags, floor mats, and thermal covers are recommended.</li> <li>(3) Ambient temperature around 70 degrees Fahrenheit, it is recommended to add airbags, floor mats, thermal covers and other insulation measures. Heating time 14 hours or more</li> </ol> <p>Warm tips: It is normal for the water temperature to drop when the tub's "bubble" function is turned on, as this accelerates heat dissipation.</p>
How to exchange filter	Please scan the QR CODE and watch GORHT001-Video 1
How to exchange all components	Please scan the QR CODE and watch GORHT001-Video 2

Repair the damaged	Please scan the QR CODE and watch GORHT001-Video 3
Storage	Please scan the QR CODE and watch GORHT001-Video 4
Exchange control panel	Please scan the QR CODE and watch GORHT001-Video 5
The usage of the one way valve	Please scan the QR CODE and watch GORHT001-Video 6
How to install it	Please scan the QR CODE and watch GORHT001-Video 7
How to find the air leak using soapy water	Please scan the QR CODE and watch GORHT001-Video 8
Heating	Please scan the QR CODE and watch GORHT001-Video 9
How to cut open disassemble the pump	Please scan the QR CODE and watch GORHT001-Video 10

QR CODE

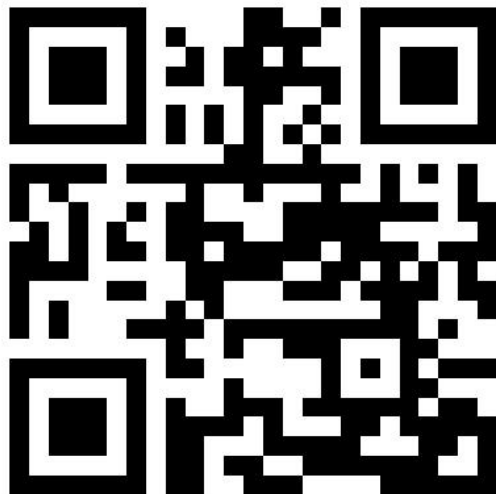

Error Code	Meaning	Usual Solution(s)
FC	Filter Change Needed	If you have not already changed the filters over the last 168 hours of use, disconnect the spa from power and replace them now. Press <b>FILTER</b> to clear the error and reset the timer.
HL	High Temp. Detected	If the water is not much too hot, the spas temperature sensor probably needs to be repaired or replaced. If the water is over 104°F (40°C), add colder water immediately to avoid damage to your spa. Take steps to never allow such conditions to recur.
OC	Open Circuit Detected	The spas temperature sensor has probably been disconnected, producing extremely low readings. Have a technician reconnect, repair, or replace the sensor.
SH	Short Circuit Detected	The spas temperature sensor has probably experienced a short circuit, producing extremely high readings. Have a technician reconfigure, repair, or replace the sensor.
SL	Low Temp. Detected	If the water is not much too cold, the spas temperature sensor probably needs to be repaired or replaced. If the water is under 40°F (5°C), add hotter water immediately to avoid damage to your spa and take steps to never allow such conditions to recur.

## DISPOSAL

Electrical products should not be disposed of with household products. In the EU and UK, according to the European Directive 2012/19/EU for the disposal of electrical and electronic equipment and its implementation in national laws, used electrical products must be collected separately and disposed of at the collection points provided for this purpose. Locations in Australia, Canada, and the United States may have similar regulations. Contact your local authorities or dealer for disposal and recycling advice.



## CONTACT INFORMATION

Manufacturer: Shanghai Sunshine Development Co.,Ltd

Manufacturer address: Room 2306, South Tower, International Fortune Center, No. 36 Xinjinqiao Road, Pudong New Area, Shanghai