

Vero Furniture handrinse basin # 0703500000 / 0703500008 / 0703500009

< 19 5/8" Inch >

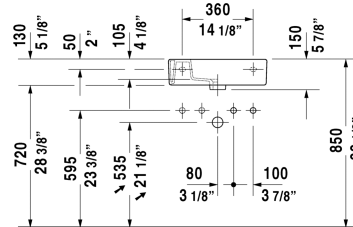
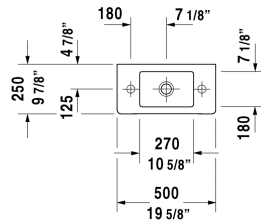

Furniture handrinse basin	Dimension	Weight	Order number
with overflow, with faucet deck, underside fully glazed, wall-mounted, hardware included, cUPC® listed*, 19 5/8" Inch			
Colors			
00 White			
Variant			
● ● pre-marked faucet hole on left and right side, without faucet hole	19 5/8" x 9 7/8" Inch	21.9 lb	0703500000
● faucet hole on right side	19 5/8" x 9 7/8" Inch	21.9 lb	0703500008
● faucet hole on left side	19 5/8" x 9 7/8" Inch	21.9 lb	0703500009
Infobox			
* Complies with following standards: ASME A112.19.2/CSA B45.1			
Sanitary ceramics with the special WonderGliss surface finish will remain clean and attractive-looking for a long time to come. When ordering WonderGliss please add a "1" as eleventh digit to the model number.			
Space-saving siphon	1 1/4" Inch	0.9 lb	005076
Suitable products			
Vanity unit wall-mounted 1 door, for Vero # 070350, 17 3/4" x 8 7/8" Inch	17 3/4" x 8 7/8" Inch		KT6629 L/R
Vanity unit wall-mounted 1 door, for Vero # 070350, 17 3/4" x 9" Inch	17 3/4" x 9" Inch		XL6208 L/R

All drawings contain the necessary measurements which are subject to standard tolerances. They are stated in inch & mm and are non-binding. Exact measurements, in particular for customized installation scenarios, can only be taken from the finished ceramic piece.