

# Installation Instructions

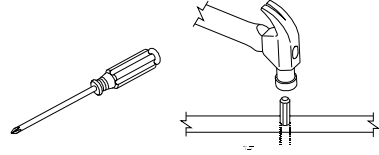

(Ax34)

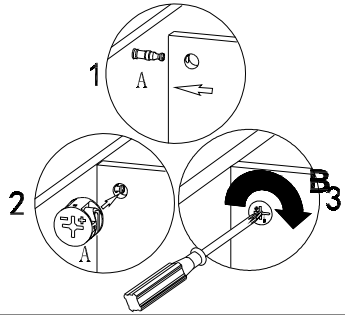
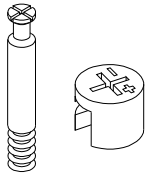

(Bx18)

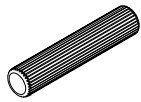

3.5\*14mm(Cx40)

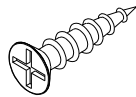

200\*200mm(Dx1)

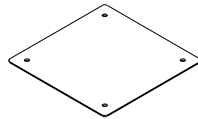

3.5\*20mm(Ex6)

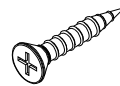

6\*25mm(Fx4)

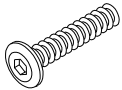

6\*20mm(Gx6)

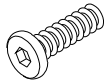

6\*12mm(Hx8)



8\*25mm(Ix10)

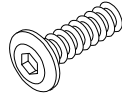

(Jx1)



4\*18mm(Kx4)



ø10mm(Lx4)

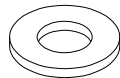

6MM(Mx1)

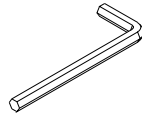

8MM(Nx1)

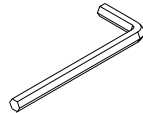

155\*155mm(Ox1)

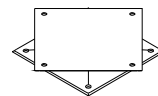

(Px4)



(Qx2)



(Rx4)

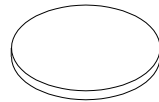

(Sx4)

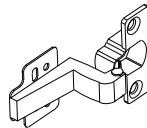

(Tx2)

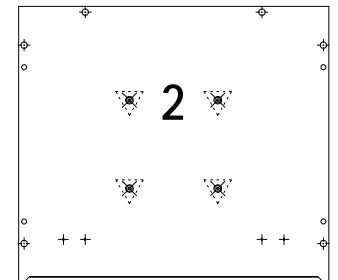
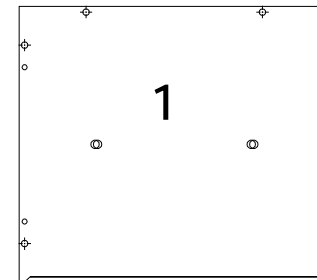
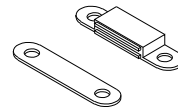

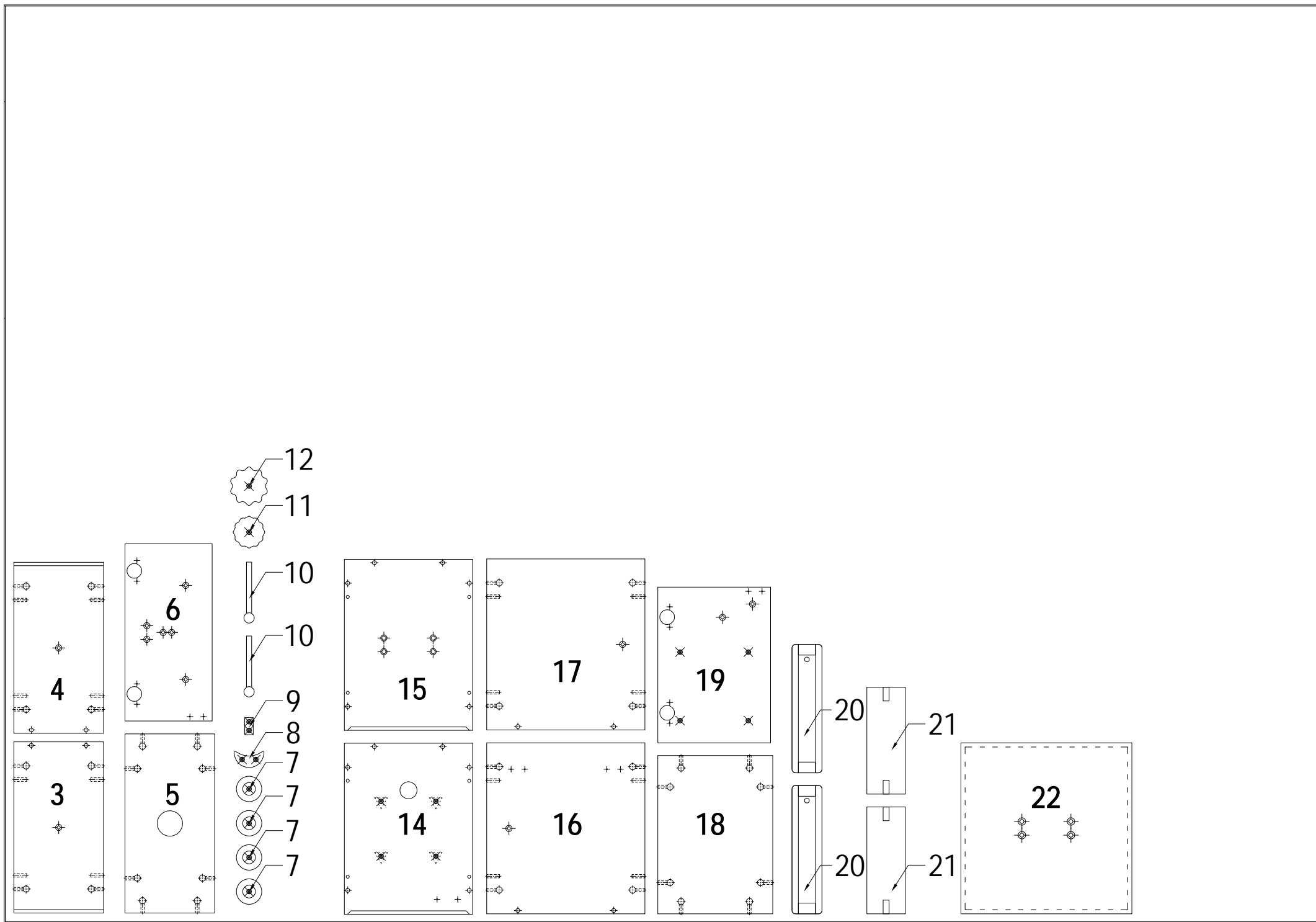

step1

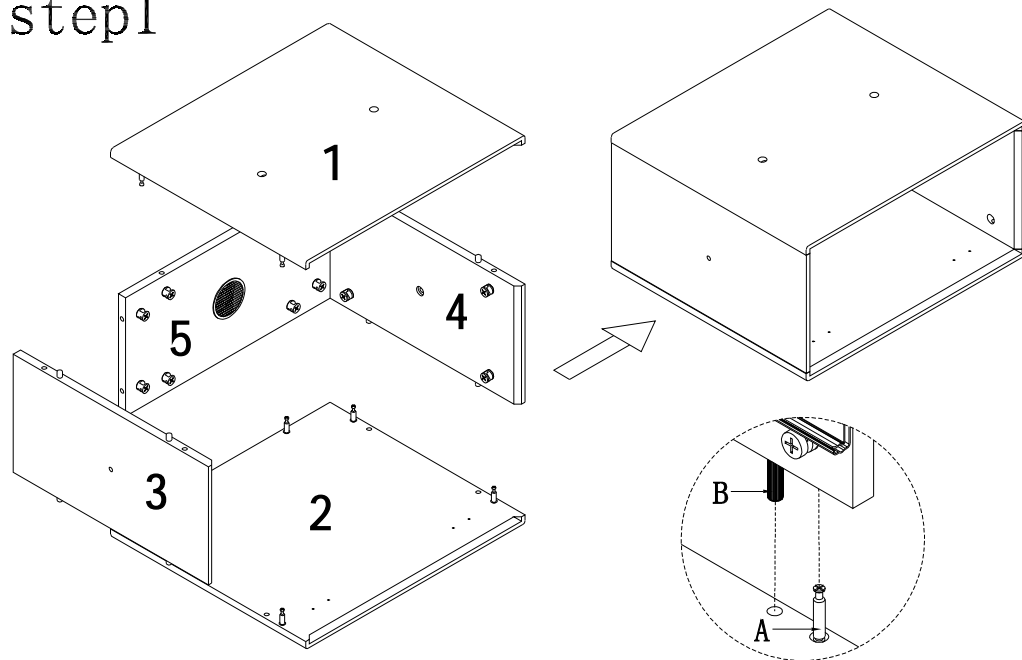

step2

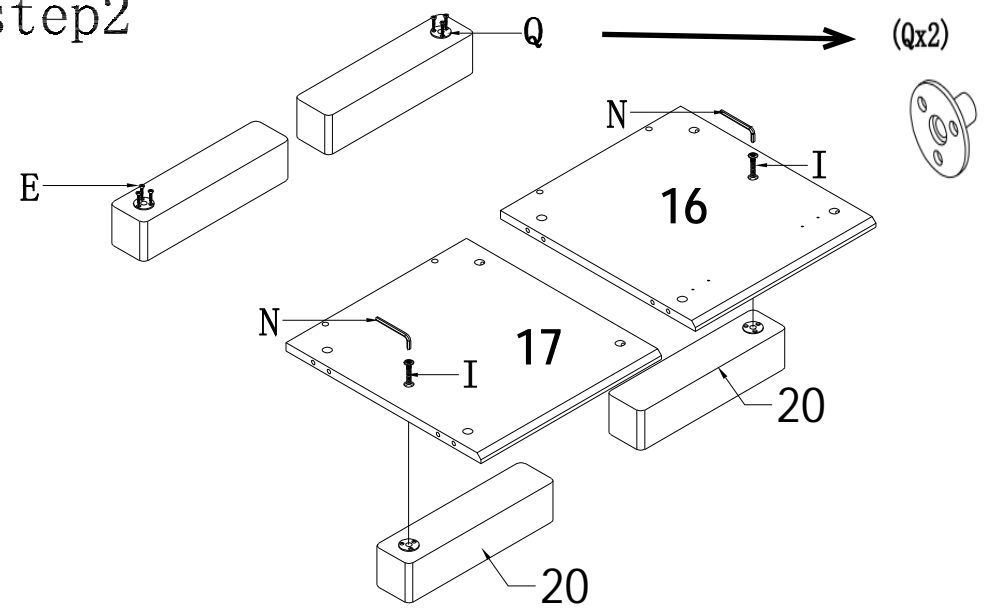

step3

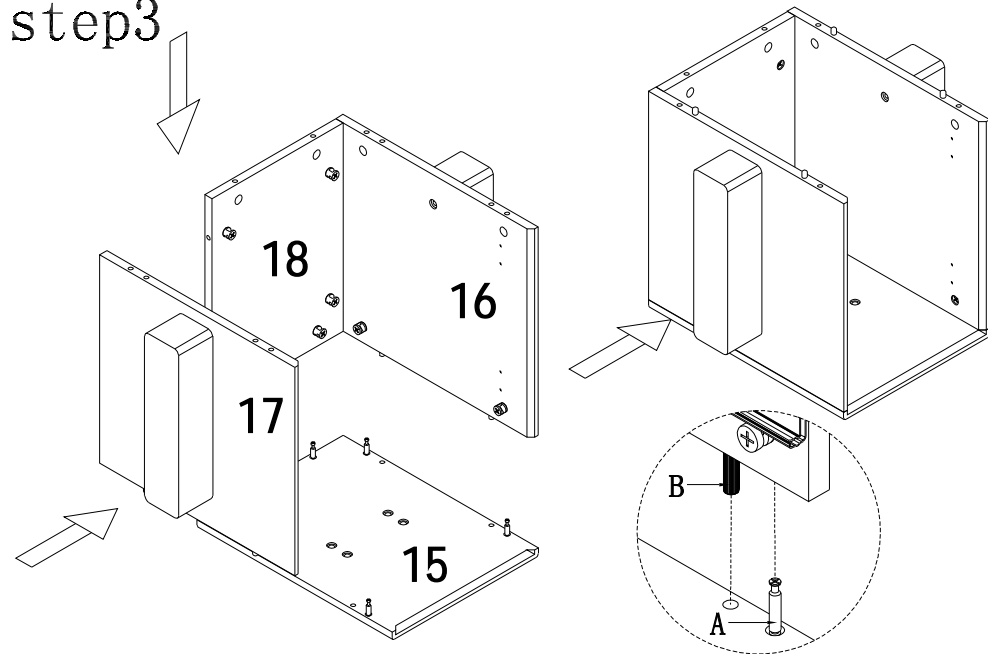

step4

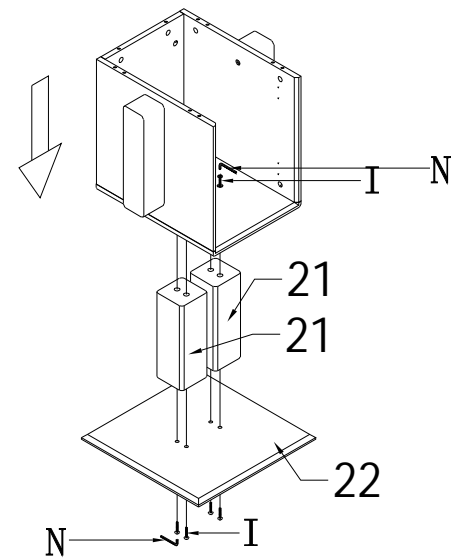

## step5

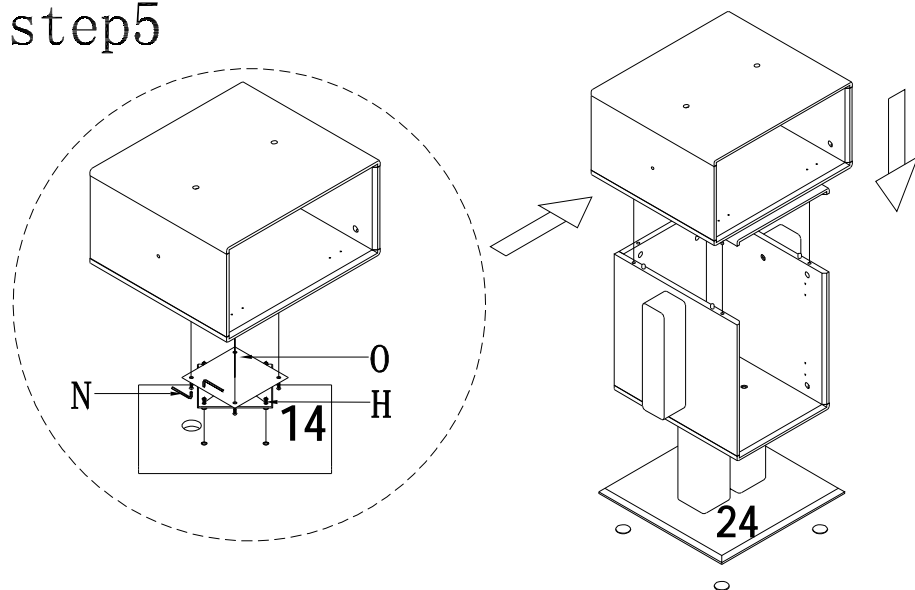

Use the H/O/N hardware to connect the No. 14 board with the Step 1 cabinet and tighten the screws. Then, use the A/B hardware to connect the head part with the Step 4 storage cabinet and tighten the screws. Finally, stick the R accessory onto the underside of the No. 24 board.

## step6

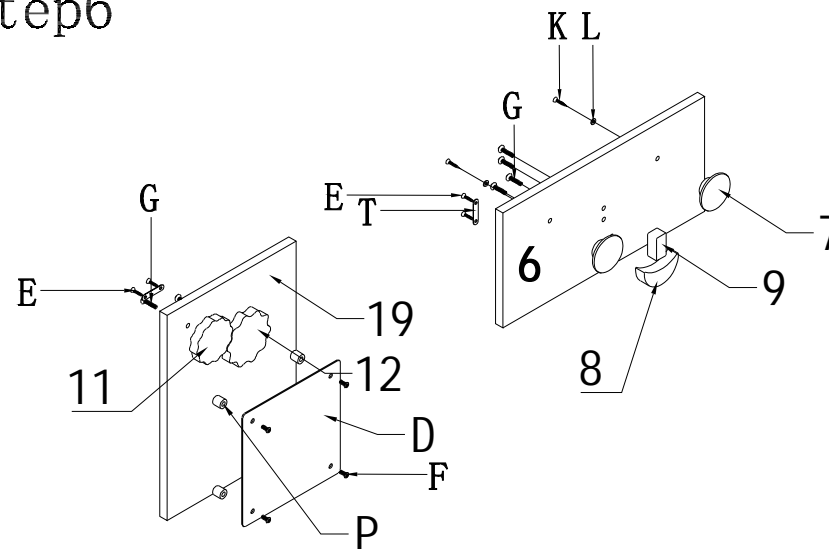

Use the M/P/F hardware to connect D with 19 and tighten the screws. Then, use the E hardware to lock T onto the No. 19/6 board. Next, use the M/G hardware to connect 11/12 with 19 and tighten the screws. After that, use the M/G hardware to connect 8/9 with 6 and tighten the screws. Finally, use the K/L hardware to connect 7 with the No. 6 board and tighten the screws.

## step7

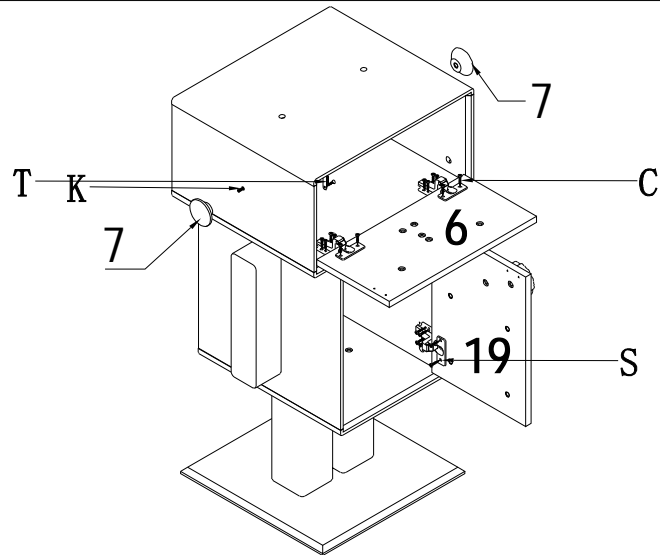

Use the S/C hardware to connect 6/19 with the storage cabinet below and tighten the screws. Then, use the K/L hardware to connect No. 7 with the storage cabinet above and tighten the screws. Finally, use the C hardware to connect the T hardware with the storage cabinet above and tighten the screws.

## step8

