

Assembly Picture

STEP 1:

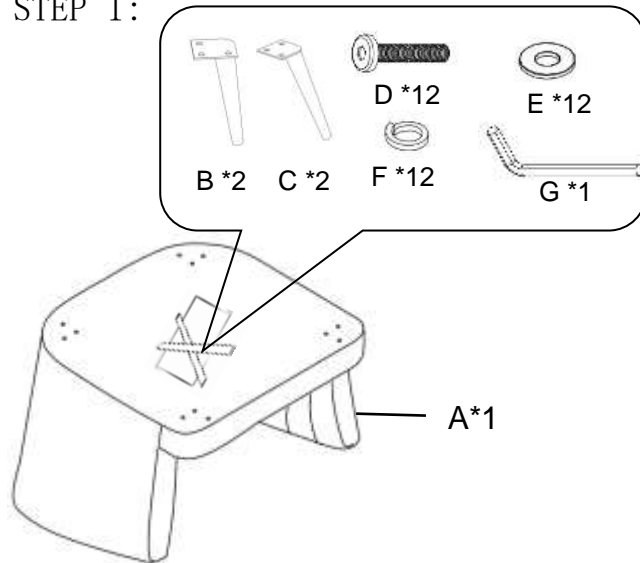

Parts:

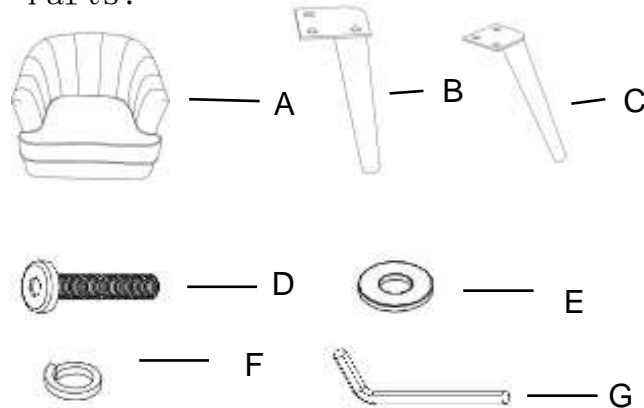

STEP 3:

STEP 2:

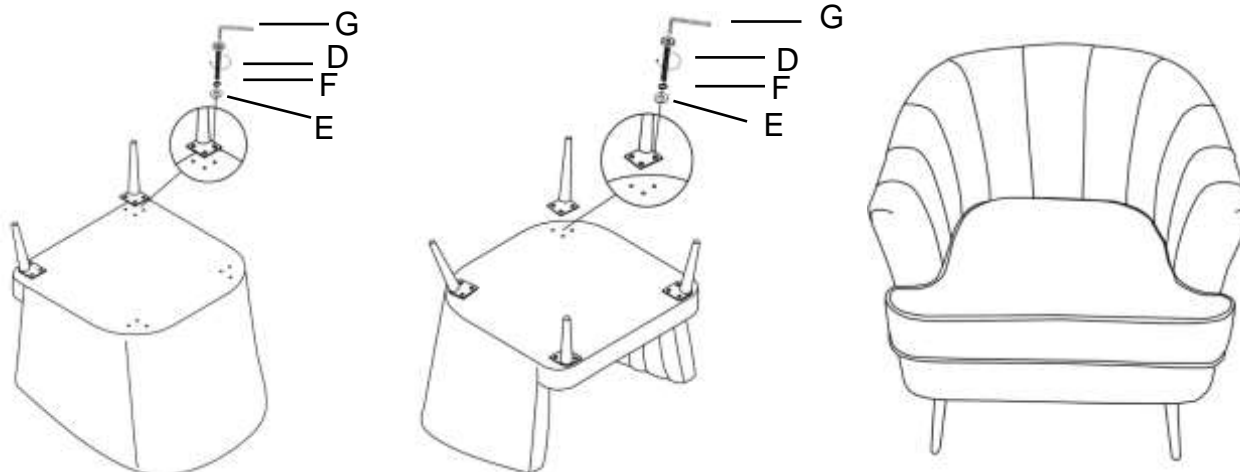

Assembly Instruction

Carefully unpack all parts before attempting to assemble.

STEP ONE Open the zipper bag of the bottom and take the parts pack out.

STEP TWO Take all parts out, Attach the front legs into the seat holes, by inserting the bolts into the leg holes, then tighten with the Allen key.

STEP THREE Attach the back legs into the seat holes, by inserting the bolts into the leg holes, then tighten with the Allen key.

Parts List

A - Chair basic	1
B - Front legs	2
C - Back legs	2
D - Bolt M8*1.25/3cm	12
E - Flat washer	12
F - Lock washer	12
G - Allen key	1
H - parts pack With two pairs of white gloves and blue plastic shoe's cover.	1