

# Bathtub Installation Instructions

(Acrylic bathtub)

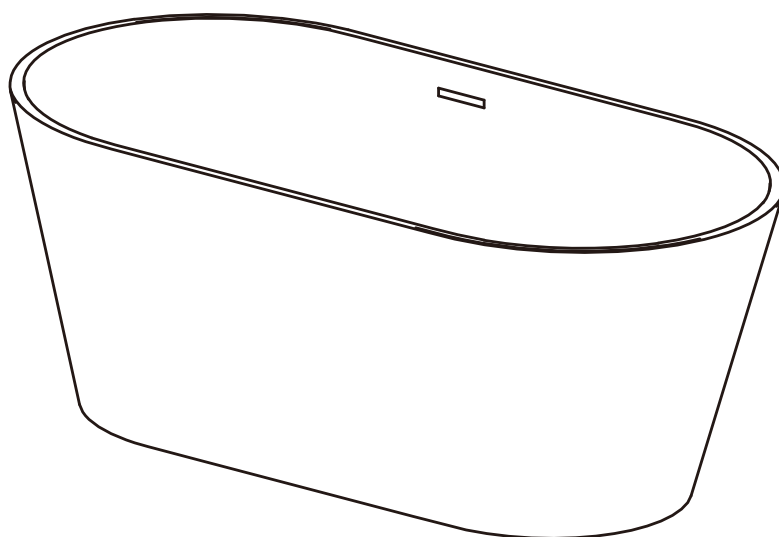

RX-A01-55, RX-A01-59, RX-A01-67, RX-A02-55, RX-A02-59, RX-A02-67, RX-A03-67



This bathtub manual must be given to the user along with the bathtub.  
This warranty is only valid if installed by a professional installer following the steps in the instructions.

# INDEX

1. cUPC Certification ..... P01-06
2. Installation ..... P07-12
3. Maintenance ..... P13

As the product style is continuously updated, the actual product may not match the illustration, but the basic principle is the same.  
After the installation is completed, this manual must be kept by the customer.

---

# IAPMO RESEARCH AND TESTING, INC.

5001 E. Philadelphia Street, Ontario, CA 91761 • Phone (909) 472-4100 • Fax (909) 472-4244 • www.iapmort.org



## CERTIFICATE OF LISTING



IAPMO Research and Testing, Inc. is a product certification body in which its product certification system includes inspection and testing of samples taken from the supplier's stock or from the market or a combination of both to verify compliance to the requirements of applicable codes and standards. This activity is coupled with periodic surveillance of the supplier's factory and/or warehouses as well as the assessment of the supplier's Quality Assurance System. This listing is subject to the conditions set forth in the characteristics below and is not to be construed as any recommendation, assurance or guarantee by IAPMO Research and Testing, Inc. of the product acceptance by Authorities Having Jurisdiction.

*Issued To:*

### ZHEJIANG TONA HOME CO., LTD.

TINGSHAN YANJIANG TOWN, 317000 TAIZHOU , ZHEJIANG, CHINA

*Product:*

#### Bathtubs (Plastic)

*Products are in compliance with the following code(s):*

**Uniform Plumbing Code (UPC®)  
National Plumbing Code of Canada**

*Products are certified to the following standard(s):*

**CSA B45.5-17/IAPMO Z124-2017**

**File Number:** 12054

**Revised Date:** November 1, 2022

**Effective Date:** December 2019

**Void After:** December 2024\*

  
Chairman, Product Certification Committee



  
Chief Technical Service Officer

\*This certificate is not evidence of current listing. To verify listing status, visit the IAPMO R&T Product Listing Directory at [pld.iapmo.org](http://pld.iapmo.org)

This listing period is based upon the last date of the month indicated on the Effective Date and Void After Date shown above. Any change in material, manufacturing process, marking or design without having first obtained the approval of the Product Certification Committee, or any evidence of non-compliance with applicable codes and standards or of inferior workmanship, may be deemed sufficient cause for revocation of this listing. Production of or reference to this form for advertising purposes may be made only by specific written permission of IAPMO Research and Testing, Inc. Any alteration of this certificate could be grounds for revocation of the listing. This document shall be reproduced in its entirety.

# IAPMO RESEARCH AND TESTING, INC.

## CERTIFICATE OF LISTING

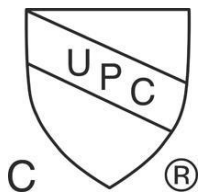

Issued To: ZHEJIANG TONA HOME CO., LTD.

Effective Date: December 2019

File Number: 12054

Revised Date: November 1, 2022

Product: Bathtubs (Plastic)

Void After: December 2024

This certificate is not evidence of current listing. To verify listing status, visit the IAPMO R&T Product Listing Directory at [pld.iapmo.org](http://pld.iapmo.org)

### Identification:

Product shall be marked with the manufacturer's name or registered trademark or, in the case of private labelling, the name of the customer for whom the fixture was manufactured. Markings shall be permanent, legible, and visible after installation. Fixtures that do not comply with one or more of the dimensional requirements shall be marked with an "N" to indicate the non-standard nature of the fixture. Bathtubs that use field-installed flanges shall have a non-permanent label stating "Do not install this fixture against a wall unless the appropriate flange is first installed". (The equivalent French wording is "Ne pas fixer cet appareil au mur a moins que la bride appropriée n'ait été préalablement installée"). The product shall also bear the cUPC® certification mark.

### Characteristics:

Plastic bathtubs with or without walls and with right or left hand or center outlets to be installed in accordance with the manufacturer's instructions affixed to the unit and the requirements of the latest edition of the Uniform Plumbing Code®. Bathtubs without factory applied nailing flanges are listed as drop-in units only (except for free-standing bathtubs), and are not to be installed against the wall. Bathtubs intended for installation against a wall shall incorporate an integral, factory applied or field applied nailing flange in accordance with CSA B45.5/IAPMO Z124. Whirlpool piping is not included in this listing. To be installed with other IAPMO R&T listed pipe and fittings.

Products listed on this certificate have been tested by an IAPMO R&T recognized laboratory. This recognition has been granted based upon the laboratory's compliance to the applicable requirements of ISO/IEC 17025.

# IAPMO RESEARCH AND TESTING, INC.

## CERTIFICATE OF LISTING



Issued To: ZHEJIANG TONA HOME CO., LTD.

Effective Date: December 2019

File Number: 12054

Revised Date: November 1, 2022

Product: Bathtubs (Plastic)

Void After: December 2024

This certificate is not evidence of current listing. To verify listing status, visit the IAPMO R&T Product Listing Directory at [pld.iapmo.org](http://pld.iapmo.org)

### Models

#### TONA

| Model Number  | Description              | Dimension     |
|---------------|--------------------------|---------------|
| 9A150002W     | Acrylic bathtub          | 1500*750*580  |
| 9A150005W     | Acrylic bathtub          | 1500*750*580  |
| 9A150007W     | Acrylic bathtub          | 1500*750*580  |
| 9A150021W     | Acrylic bathtub          | 1500*800*580  |
| 9A170001W     | Acrylic bathtub          | 1700*750*580  |
| 9A170002W     | Acrylic bathtub          | 1700*800*580  |
| 9A170005W     | Acrylic bathtub          | 1700*800*580  |
| 9A170007W     | Acrylic bathtub          | 1700*800*580  |
| 9A170008W     | Acrylic bathtub          | 1700*800*730  |
| 9A170016W     | Acrylic bathtub          | 1700*800*600  |
| 9A170016WB    | Acrylic bathtub          | 1700*800*600  |
| 9A170018W     | Acrylic bathtub          | 1700*800*600  |
| 9A170018W1-T1 | Acrylic bathtub          | 1700*800*600  |
| 9A170021W     | Acrylic bathtub          | 1700*800*580  |
| 9A180028W1-T1 | Acrylic bathtub          | 1800*830*600  |
| 9A180029W1-T1 | Acrylic bathtub          | 1800*850*600  |
| 9A180058W1-T1 | Acrylic bathtub          | 1800*800*600  |
| 9A150009W     | Acrylic bathtub          | 1500*740*680  |
| 9A170009W     | Acrylic bathtub          | 1700*800*680  |
| 9A170012W     | Acrylic bathtub          | 1700*800*580  |
| 9A180058W     | Acrylic bathtub          | 1800*800*600  |
| 9A150012W     | Acrylic bathtub          | 1500*750*580  |
| 99150004W     | Artificial stone bathtub | 1500*1500*540 |
| 99170002W     | Artificial stone bathtub | 1700*800*580  |
| 99170003W     | Artificial stone bathtub | 1700*850*590  |
| 9A168032W     |                          | 1680*750*580  |

# IAPMO RESEARCH AND TESTING, INC.

## CERTIFICATE OF LISTING



Issued To: ZHEJIANG TONA HOME CO., LTD.

Effective Date: December 2019

File Number: 12054

Revised Date: November 1, 2022

Product: Bathtubs (Plastic)

Void After: December 2024

This certificate is not evidence of current listing. To verify listing status, visit the IAPMO R&T Product Listing Directory at [pld.iapmo.org](http://pld.iapmo.org)

| Model Number | Description | Dimension    |
|--------------|-------------|--------------|
| 9A168032WB   |             | 1680*750*580 |
| 9A150032W    |             | 1500*750*580 |
| 9A150032WB   |             | 1500*750*580 |
| 9A168033W    |             | 1680*800*580 |
| 9A168033WB   |             | 1680*800*580 |
| 9A150033W    |             | 1500*780*580 |
| 9A150033WB   |             | 1500*780*580 |
| 9A150035W    |             | 1500*750*580 |
| 9A170035W    |             | 1700*800*580 |
| YM010-150004 |             | 1500*780*540 |
| YM010-170004 |             | 1700*850*550 |
| YM013-160004 |             | 1600*950*600 |
| YM011-150004 |             | 1500*750*550 |
| YM011-175004 |             | 1750*750*550 |
| YM012-165004 |             | 1650*750*550 |
| YM016-170004 |             | 1700*850*540 |
| YM018-170004 |             | 1700*750*550 |
| YM015-160004 |             | 1600*750*550 |
| YM015-170004 |             | 1700*750*550 |
| YM017-160004 |             | 1600*850*550 |
| YM017-170004 |             | 1700*850*550 |
| YY037-140001 |             | 1400*780*720 |
| YY037-150001 |             | 1500*780*720 |
| YY037-160001 |             | 1600*800*720 |
| YY037-170001 |             | 1700*800*720 |
| YY037-140002 |             | 1400*780*720 |
| YY037-150002 |             | 1500*780*720 |
| YY037-160002 |             | 1600*800*720 |
| YY037-170002 |             | 1700*800*720 |

# IAPMO RESEARCH AND TESTING, INC.

## CERTIFICATE OF LISTING

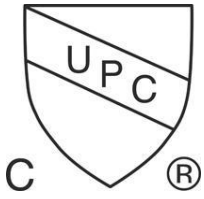

Issued To: ZHEJIANG TONA HOME CO., LTD.

File Number: 12054

Product: Bathtubs (Plastic)

Effective Date: December 2019

Revised Date: November 1, 2022

Void After: December 2024

This certificate is not evidence of current listing. To verify listing status, visit the IAPMO R&T Product Listing Directory at [pld.iapmo.org](http://pld.iapmo.org)

| Model Number | Description | Dimension    |
|--------------|-------------|--------------|
| YY038-150001 |             | 1500*790*590 |
| YY038-160001 |             | 1600*790*590 |
| YY038-170001 |             | 1700*790*590 |
| YY038-150002 |             | 1500*790*590 |
| YY038-160002 |             | 1600*790*590 |
| YY038-170002 |             | 1700*790*590 |
| YY061-140001 |             | 1400*720*580 |
| YY061-150001 |             | 1500*730*580 |
| YY061-160001 |             | 1600*730*580 |
| YY061-170001 |             | 1700*750*580 |
| YY061-140002 |             | 1400*720*580 |
| YY061-150002 |             | 1500*730*580 |
| YY061-160002 |             | 1600*730*580 |
| YY061-170002 |             | 1700*750*580 |
| YY036-150001 |             | 1500*750*580 |
| YY036-160001 |             | 1600*750*580 |
| YY036-170001 |             | 1700*750*580 |
| YY036-150002 |             | 1500*750*580 |
| YY036-160002 |             | 1600*750*580 |
| YY036-170002 |             | 1700*750*580 |
| YY034-150001 |             | 1500*780*680 |
| YY034-170001 |             | 1700*780*680 |
| YY034-150002 |             | 1500*780*680 |
| YY034-170002 |             | 1700*780*680 |
| YY041-150001 |             | 1500*800*580 |
| YY041-170001 |             | 1700*800*580 |
| YY041-150002 |             | 1500*800*580 |
| YY041-170002 |             | 1700*800*580 |

# IAPMO RESEARCH AND TESTING, INC.

## CERTIFICATE OF LISTING

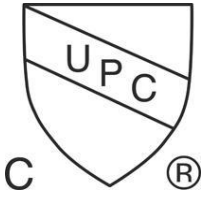

Issued To: ZHEJIANG TONA HOME CO., LTD.

Effective Date: December 2019

File Number: 12054

Revised Date: November 1, 2022

Product: Bathtubs (Plastic)

Void After: December 2024

This certificate is not evidence of current listing. To verify listing status, visit the IAPMO R&T Product Listing Directory at [pld.iapmo.org](http://pld.iapmo.org)

### Additional Company Information

## CANAC-MARQUIS GRENIER LTEE

Trade Mark: TASSILI®

| Model Number | Description  |
|--------------|--------------|
| 33002594     | 1680X750X580 |
| 33002503     | 1500X750X580 |



- Risk of personal injury. Bath tubs can be extremely heavy. Obtain sufficient help to carefully lift or move the bath tub.
- Risk of property damage. Make sure that a watertight seal exists on all bath drain connections.

## TOOLS

YOU MIGHT NEED

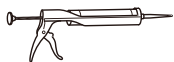

## BEFORE INSTALLATION

- Before installation check that all fittings have been supplied.
- Assembled bath on a mat to protect against damage to bath surface.
- This product requires a two person lift-use proper lifting techniques.
- This installation guide recommends a bath waste be fitted to the bath prior to installation - if any doubt about Installation and waste connection
- please consult a qualified tradesmen
- Follow each step in turn.

**IMPORTANT:**All installations must comply with council and local authority by-laws. It is the responsibility of the installer to ensure that the waste is made watertight by means of silicone sealant or caulking compound.

**NOTE:** Bath can be installed after the wall & floor tiling is completed. Bath drain supplies should be arranged preliminarily according to the selected bath.

## WARNING

Ensure the floor where the bath will sit is level.



CAUTION

The waste & overflow is supplied with the product, however other items required such as a waster trap and connectors are not supplied and must be purchased and must be purchased separately.

Because of the technical features of the product it should only be used with the waste & overflow supplied.

Handgrips for this product are not available.

The bathtub must be carried upside down, do not life or support the bath by the sides.

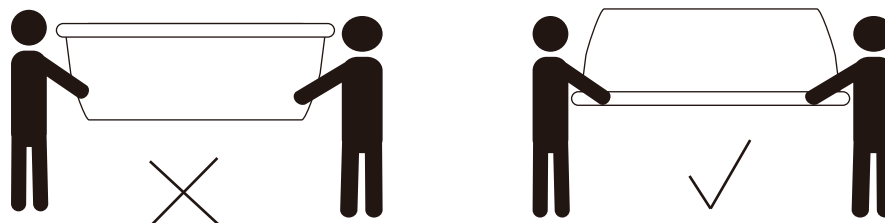

Prior to installing the bath should be checked for damage as we recommend all work is to be carried out by a qualified person.

# INSTALLATION PROCEDURE

1

Place the bath upside down on a dust sheet or soft cloth so not to scratch the surface. Level the feet on the base of the bath and lock them into place.

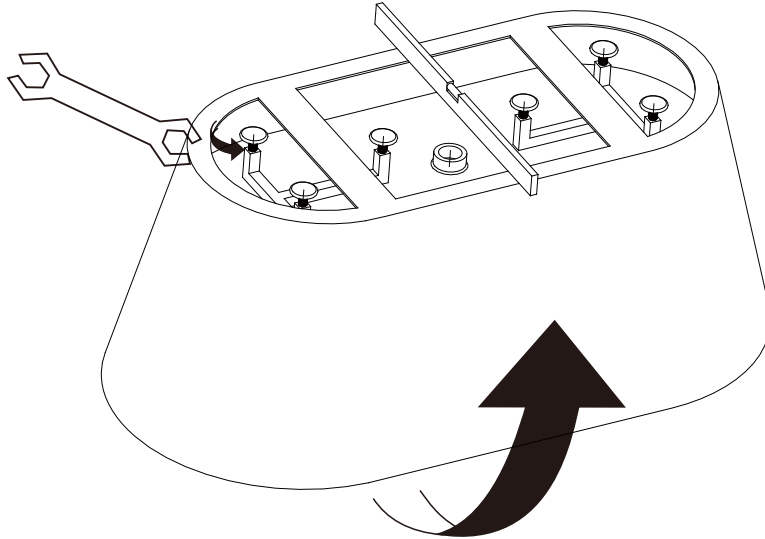

2

Turn the bath over and temporarily place in what will be final position in the bathroom. Check along the top of the bath using a spirit level and adjust the feet if necessary and lock into place.

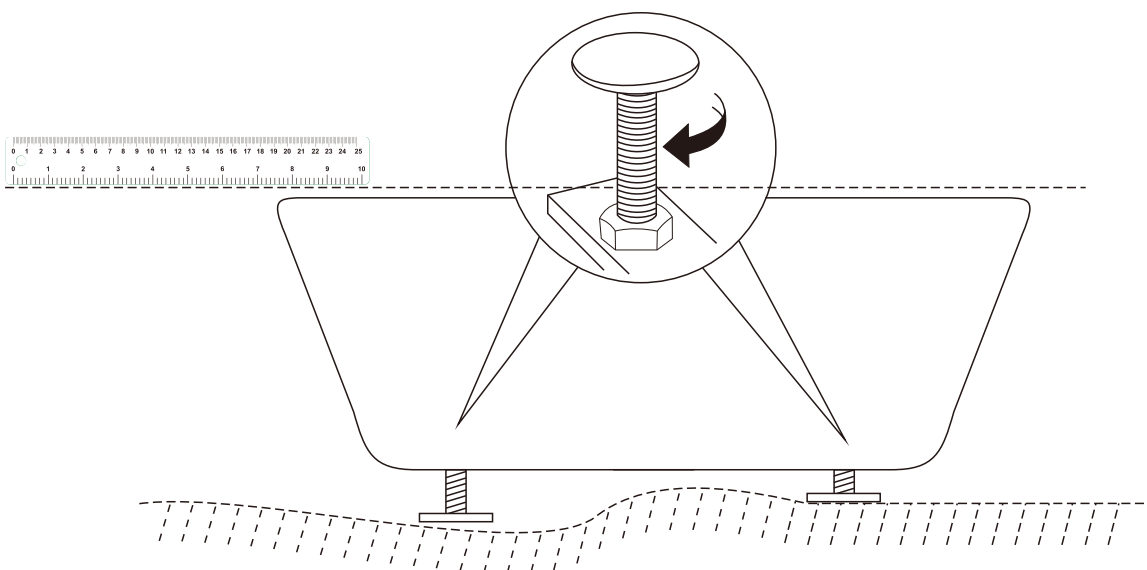

## INSTALLATION PROCEDURE

3

Turn the tub upside down and install a drain line in the tub according to your home's sewer configuration

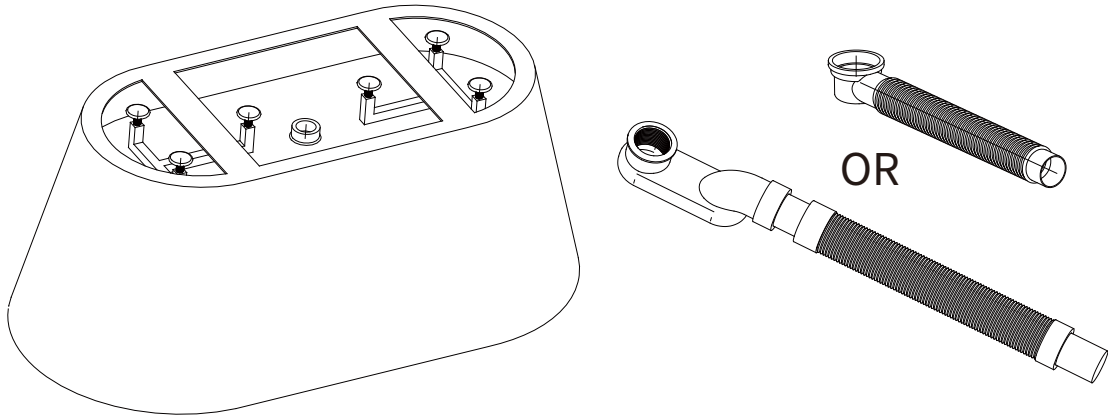

4

Turn the bath the right way up and rest on two blocks(ideally4" x4" )in position to gain access underneath to attach the household pipework.

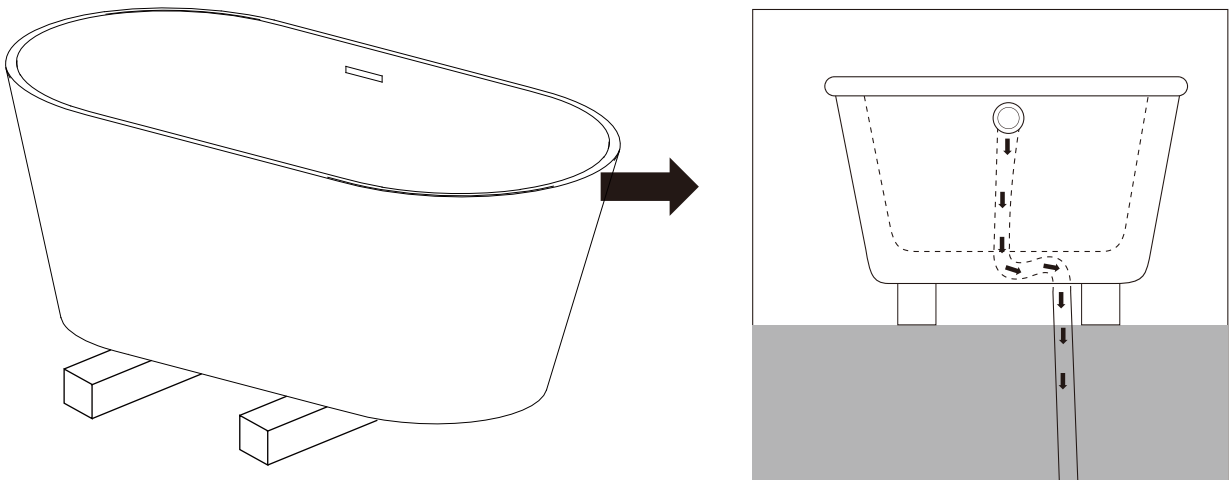

## INSTALLATION PROCEDURE

5

Once the waste option has been chosen and attached to the household pipework water should be poured through the waste to check for leaks. Once this has been done apply silicon to the underside of the bath to complete the look.

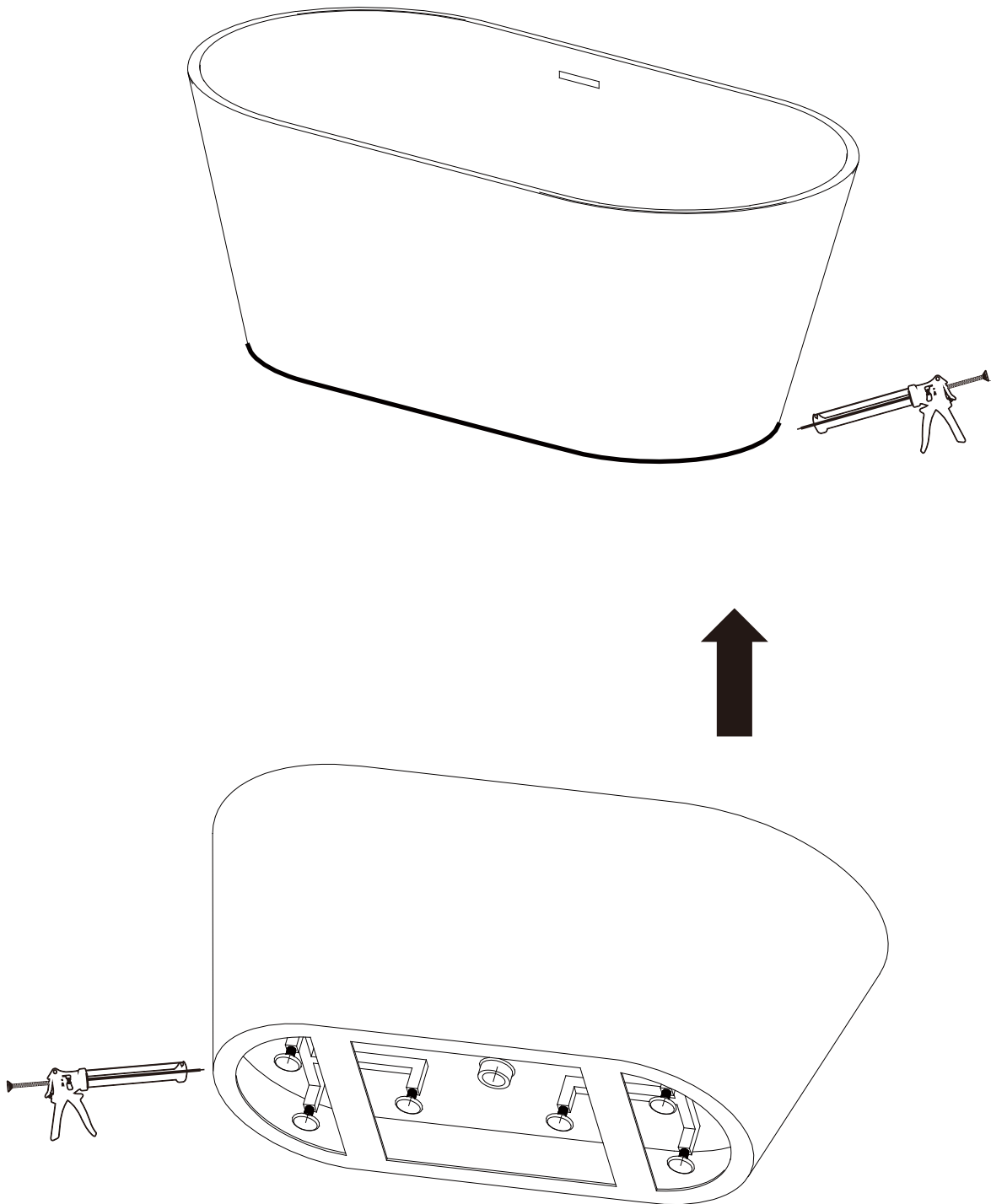

6

Please allow 24 hours for the silicon to dry off before use. The installation guide includes options for waste connection: The final decision about installation and waste connection should be taken by a qualified person.

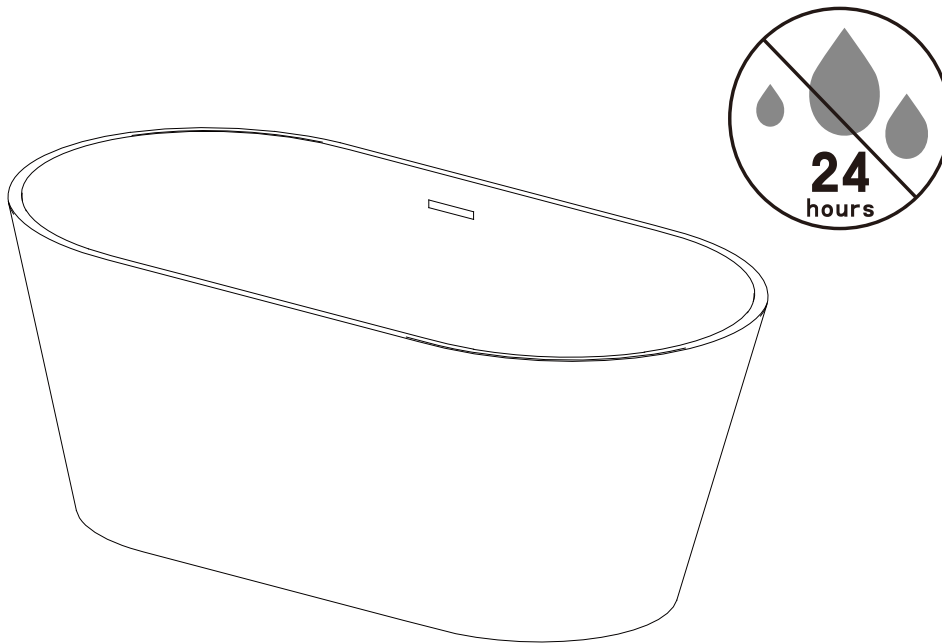

## AFTER INSTALLATION

Run water into the bath and check connections for leaks.

## CARE & CLEANING

- Use a soft cloth or sponge for cleaning. Don not use any scouring pads like pot cleaners etc. as this will dull the surface
- Use mild soap and water for everyday use.
- Do not use any abrasive cleaning materials.
- Do not use any disinfectants, aerosol cleaners, ammonia concentrates etc.
- Every few months give your bath a light polish with LIBRA acrylic polish to restore the original sheen.

## ALWAYS

- Clean every day by thoroughly rinsing with mild soap and warm water and wipe dry with a cloth.
- Keep the tub free of any standing water as this can cause a buildup of mineral deposit, which can affect the appearance of your sink.
- Always rinse the bathtub after using any cleaning agent and wipe dry with a cloth . Clean any mineral deposits built up over time with a mild solution of vinegar and water followed by thorough flushing with water.

## NEVER

- Use steel wool or a scouring pad as it damages the sink surface and causes discoloration.
- Let household cleaning agents or bleach sit in your bathtubs for a long period as this may ruin the finish of your sink.
- Leave rubber mats ,sponges , or cleaning pads in the bathtub for long periods as this may damage the finish of your tub.
- Use the inside of the tub as a cutting surface.

## NOTE

- The uneven surface --- To finish polishing a bathtub , we usually apply wax to make it shine and protect it from stains and scratches . However , the extra wax will eventually generate an uneven surface . Before using it , please use a clean cloth with warm water in circular motions to lightly wipe the surface to remove the extra wax.
- The water stain --- To finish testing the bathtub overflow, we usually inspect the bathtub overflow drains by running water down the drains to test if there is any leak at the overflow . Therefore, water stains may be found on the surface of the bathtub.