

Assembly Instructions for Model 21669037



STEP 1

Screw the lampshade into the lamp body.

STEP 2

Remove the mounting bracket from the lamp base.

Mark the drilling position on ceiling with the help of the mounting bracket.

Drill holes on the marks and stick the expansion anchors into the holes.

Mount the mounting bracket on the wall.

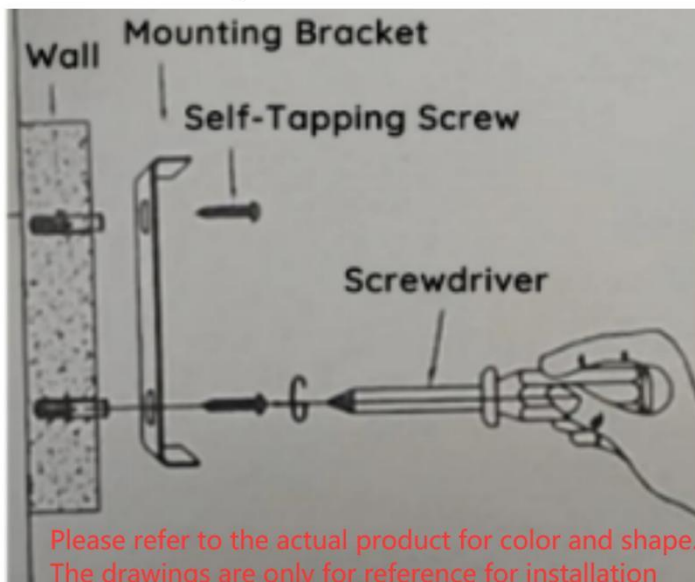

STEP 3

Hold the fixture close to ceiling.

Connect the wires of the lamp body to the reserved wires at home.

There is no need to distinguish between positive and negative poles when wiring.

STEP 4

Install the lamp base to the mounting bracket on the wall and fix it with screws.

Your fixture is now assembled and ready to use.