

- 3** Attach Backrest (A) to Seat Deck (B) by sliding the brackets on the Backrest (A) into the glides on the Seat Deck (B).

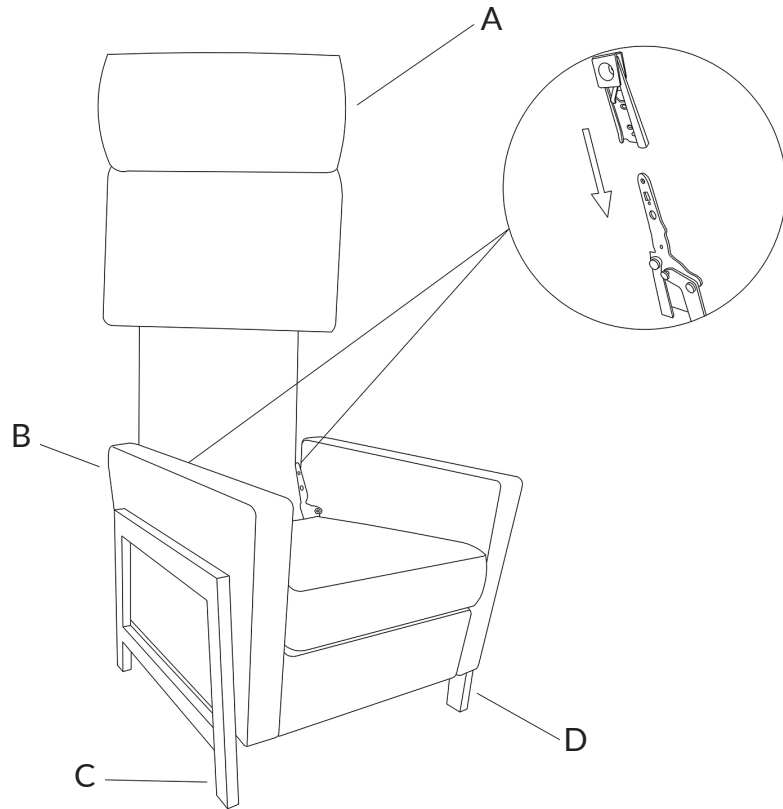

FAUX LEATHER PUSHBACK RECLINER

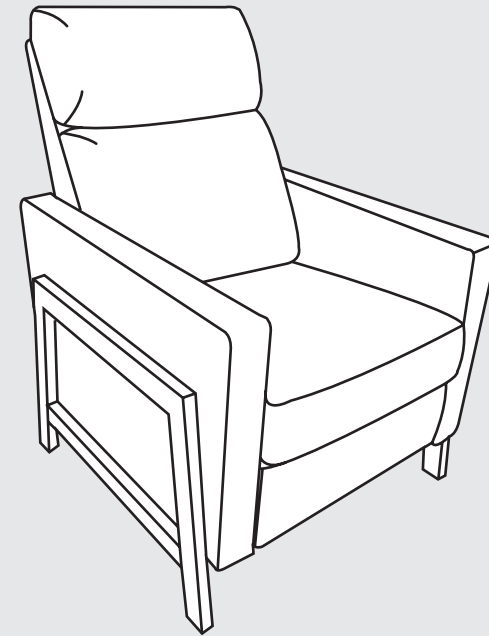

ADULT ASSEMBLY REQUIRED

If you are missing any parts or have any questions regarding assembly, do not return this item to the retailers store. Please call our toll-free, customer service number and have this assembly manual open to the parts list ready to provide the model name, number and part name or number.



WARNING: This product may contain small components, please ensure they are kept away from small children.

PARTS AND HARDWARE

Avoid using sharp objects such as a knife to cut open packing as you may accidentally damage the upholstery.

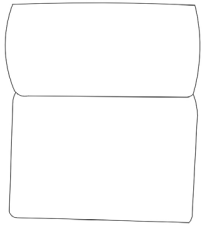

A. Backrest
1x

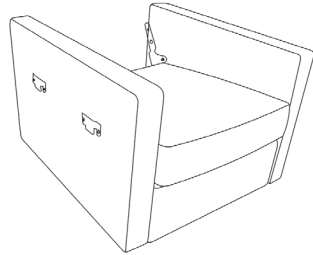

B. Seat Deck
1x

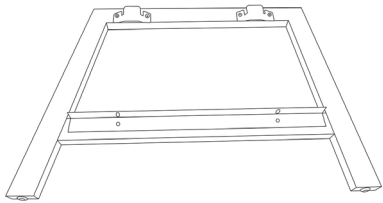

C. Left Leg
1x

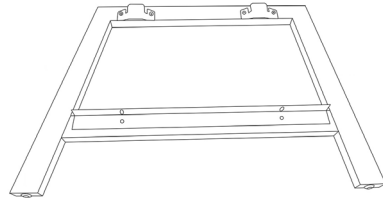

D. Right Leg
1x

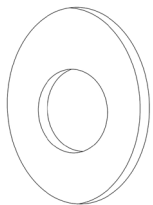

E. Washer
4x

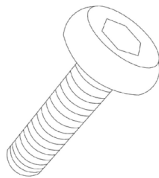

F. Bolt
4x

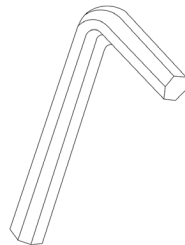

G. Allen Key
1x

ASSEMBLY INSTRUCTIONS

Do not fully tighten bolts until assembly is complete.

- 1** Attach Left Leg (C) to Seat Deck (B) by placing the two metal brackets on Left Leg (C) over the metal brackets on Seat Deck (B). Left Arm (C) will lock into place. Repeat for Right Leg (D).

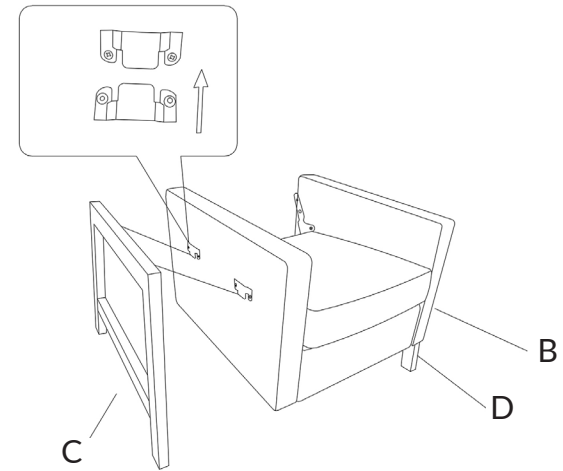

- 2** Secure Left Leg (C) and Right Leg (D) into place using Bolt (F) and Washer (E). Tighten using provided Allen Key (G).

