

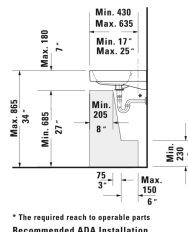

Happy D.2 Furniture washbasin # 2318100000 / 2318100030

|< 39 3/8" Inch >|

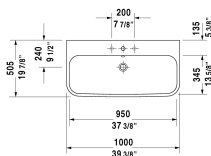
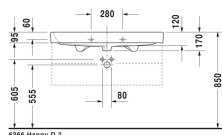

| Furniture washbasin | Dimension | Weight | Order number |
|--|------------------------|---------|---------------------------|
| with overflow, with faucet deck, overflow clip Chrome included, underside fully glazed, hardware included, wall-mounted, cUPC® listed*, 39 3/8" Inch | | | |
| Colors | | | |
| 00 White | | | |
| Variant | | | |
| ● | 39 3/8" x 19 7/8" Inch | 59.5 lb | 2318100000 |
| ● ● ● | 39 3/8" x 19 7/8" Inch | 59.5 lb | 2318100030 |
| Infobox | | | |
| * Complies with following standards: ASME A112.19.2/CSA B45.1, Washbasin is not ADA compliant in combination with pedestal, siphon cover or metal console | | | |
| Sanitary ceramics with the special WonderGliss surface finish will remain clean and attractive-looking for a long time to come. When ordering WonderGliss please add a "1" as eleventh digit to the model number. | | | |
| Space-saving siphon | | | 1 1/4" Inch 0.9 lb 005076 |
| Suitable products | | | |
| Vanity unit wall-mounted 2 drawers, upper drawer including cut-out for siphon and siphon cover, for Happy D.2 # 231810 (not ground), 38 3/8" x 18 7/8" Inch | 38 3/8" x 18 7/8" Inch | | H26366 |
| Metal console height adjustable +2", Chrome, for washbasin # 231810, | | | 003076 |
| Vanity unit floorstanding 2 drawers, upper drawer including cut-out for siphon and siphon cover, for Happy D.2 # 231810 (not ground), 38 3/8" x 18 7/8" Inch | 38 3/8" x 18 7/8" Inch | | H26374 |

Happy D.2 Furniture washbasin  # 2318100000 / 2318100030

|< 39 3/8" Inch >|

| | | |
|---|------------------------|--------|
| Vanity unit for console 2 drawers, upper drawer including cut-out for siphon and siphon cover, 39 3/8" x 21 5/8" Inch | 39 3/8" x 21 5/8" Inch | XL5419 |
| | | |

All drawings contain the necessary measurements which are subject to standard tolerances. They are stated in inch & mm and are non-binding. Exact measurements, in particular for customized installation scenarios, can only be taken from the finished ceramic piece.